

## How to remove water inside the hot water tank

### 1. Remove residual water pressure in the bidet toilet and water hose

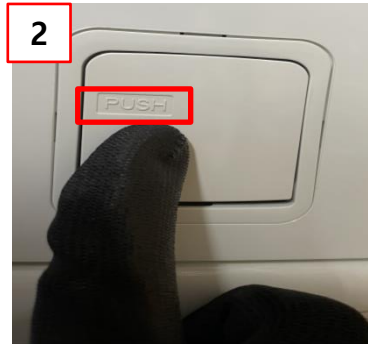

Close the water valve



Press the "PUSH" button located on the side of the bidet.

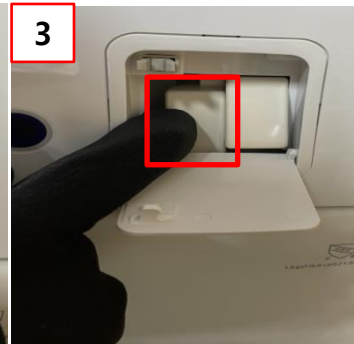

Press the rim manual operation button for 2 to 3 seconds.



Check the seat sensor label position.



Press the entire seat sensor label.

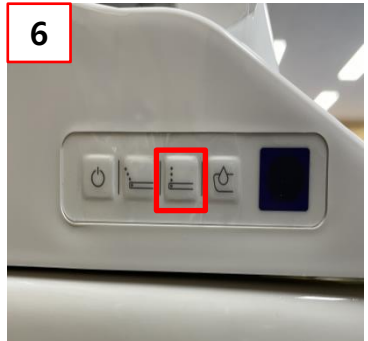

Press the bidet operation button on the side control while pressing the seat sensor.



Wait for the water to come out of the nozzle and stop.

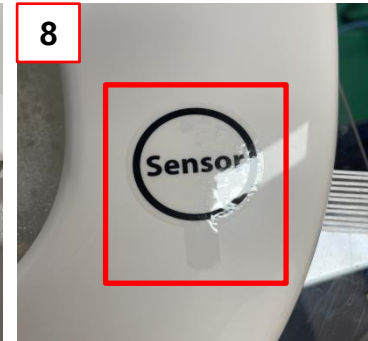

Remove the hand from the seat sensor. (Nozzle goes in)

## How to remove water inside the hot water tank

### 2. Removes water inside the hot water tank

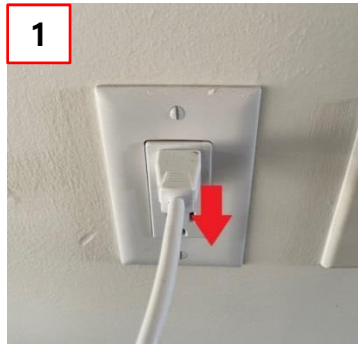

Unplug the power cord

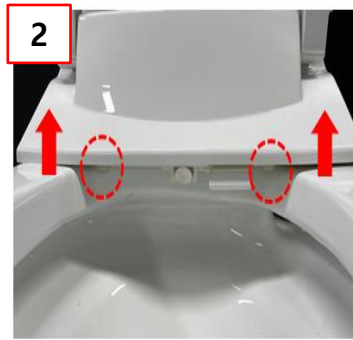

Pull the lever plate and lift the bidet up.

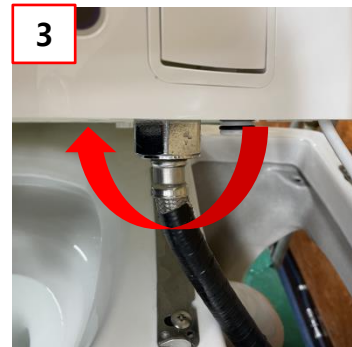

Loosen the water hose nut by turning it counterclockwise.



Remove the water hose by pulling it in the direction of the arrow.



Push the bidet back so that the bottom of the bidet is visible. (Angle: 45 degrees)

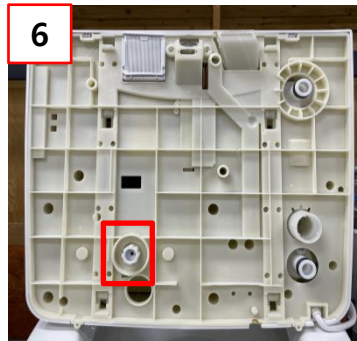

Check the drain cap

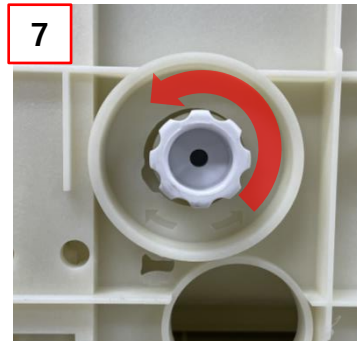

Remove the drain bolt by turning it in the direction of the arrow.



Wait until the water inside the tank is completely removed.

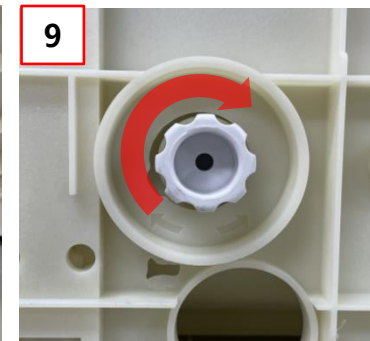

Tighten the drain bolt by turning it in the direction of the arrow.