

*Nellie's*®

**WOW TOO**

**WOW AUSSI**



## 2 CONTENTS

- 3 ... Components
- 4 ... Assembly
- 5 ... Instructions
- 7 ... Charging & Battery Replacement
- 8 ... Troubleshooting
- 10 ... Safety Instructions & Technical Parameters



THE IMPROVED  
DESIGN WILL MAKE YOU  
SAY WOW TOO!

# COMPONENTS

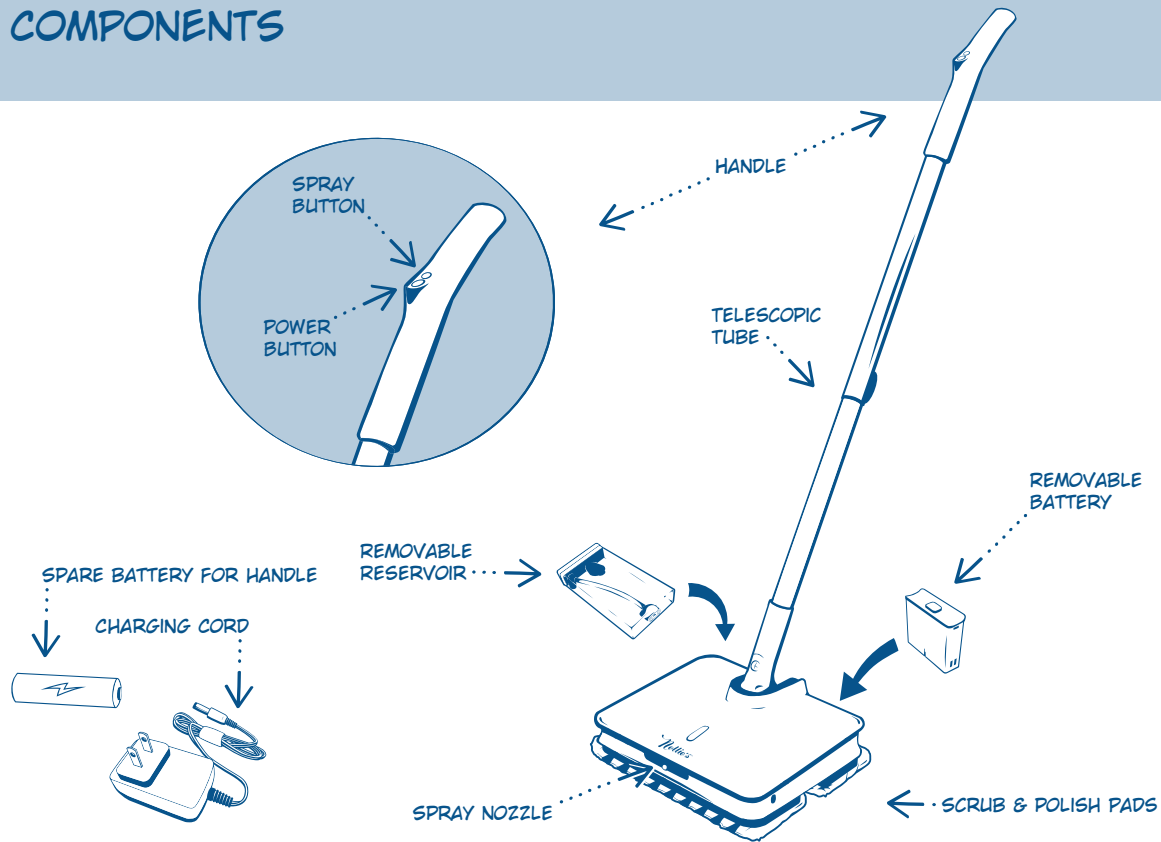

# 4 ASSEMBLY

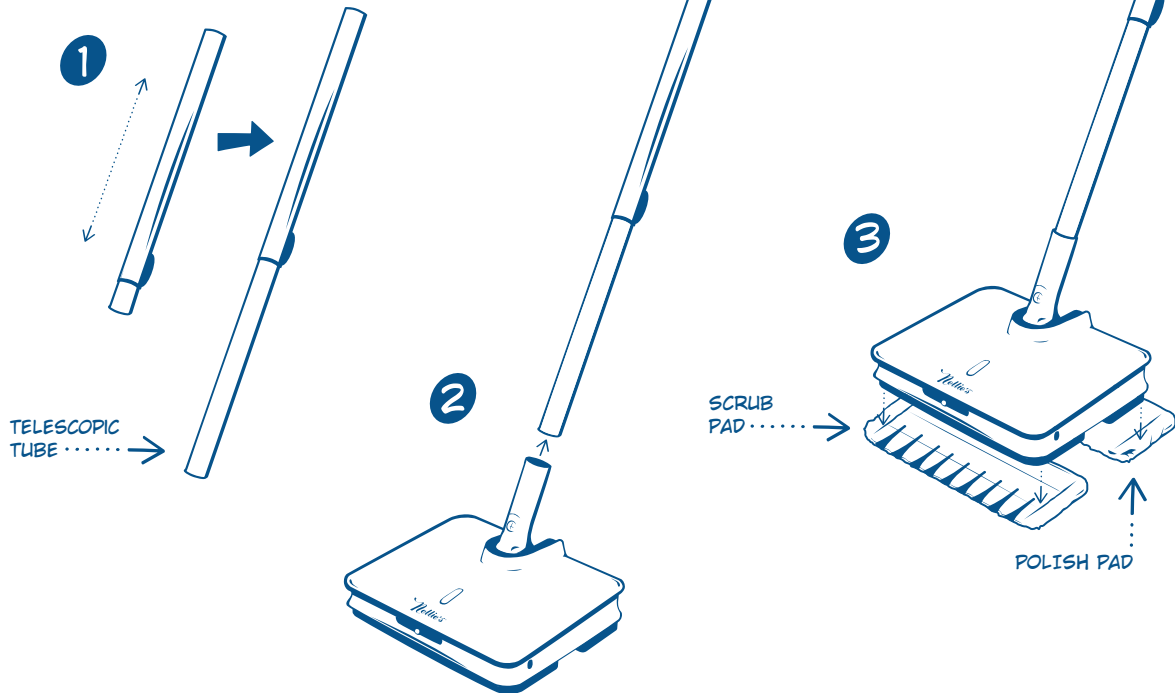

# INSTRUCTIONS

5

## Operating

Pull back the handle and press the power button to make the cleaning pads oscillate. Press power button to stop.

While the pads are oscillating, hold down the spray button to spray cleaning solution. Release button to stop.

### Notes:

- Do not operate while the mop is charging.
- The longest spray time is 3 seconds with one press.
- The machine will automatically turn into "sleep mode" after 2 minutes of no use and the breathing light will twinkle. It will then turn off after around 3 minutes.

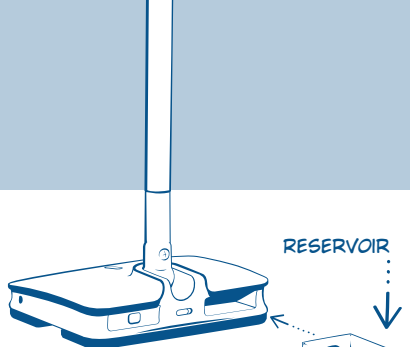
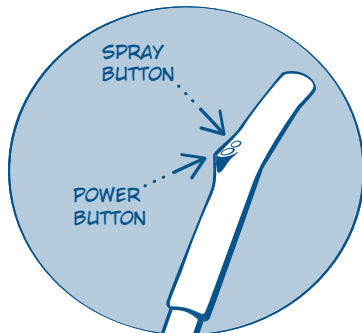

## Filling the reservoir

Press the release button to remove the liquid reservoir. Fill the reservoir with cleaning solution to the "MAX" line. Insert back into the base. Make sure reservoir is clicked in securely. It is installed properly when you hear 2 clicks.

For best results, use with **Nellie's Floor Care** on hardwood, laminate, vinyl, ceramic and tile.

### Note:

- Do not add hot water, vinegar, laundry powders or cleaners that contain oil or wax.
- To empty the reservoir, use the drain tab located at the bottom.

## Taking Care of Your Reservoir

For best results, use a 1:3 **Nellie's Floor Care** to water ratio. This will maintain good performance and extend the life of your mop. Do not leave any liquid for more than 24 hours in the reservoir. Clean reservoir after use.

## Spray Nozzle Cleaning

Unscrew the spray nozzle. Soak in hot water and vinegar until unclogged. Alternatively, use a pin to clean.

### Note:

- Make sure you screw the spray nozzle back on properly to avoid any leakage.

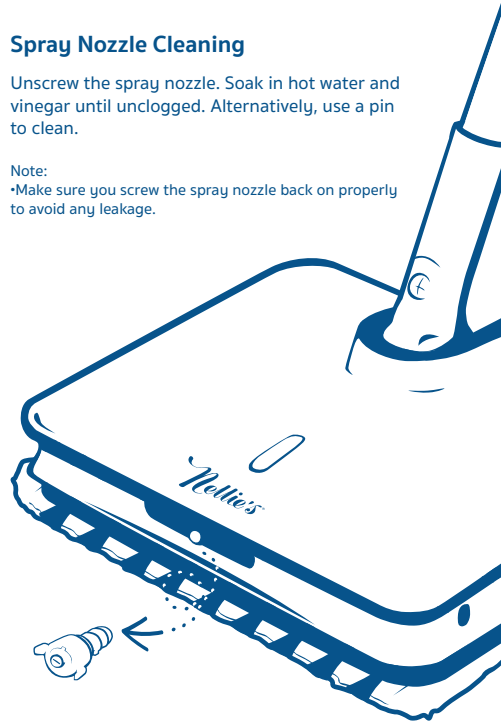

## Battery Lights

The battery lights will show the status of the battery. All the lights will flash when the battery is low, indicating to charge immediately.

Notes:

• 3 lights on	100%
• 2 lights on	65%
• 1 light on	30%
• 3 lights flashing	low battery

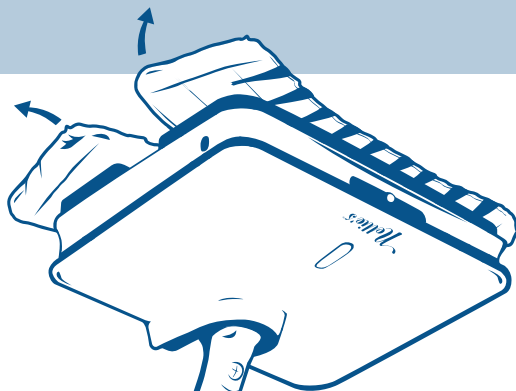
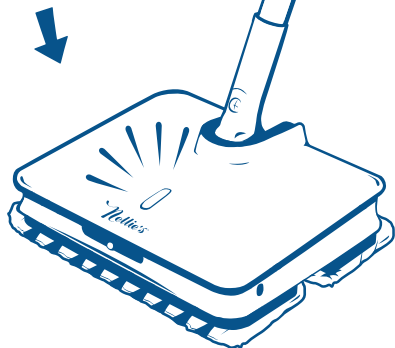

## Changing Pads

Unplug/turn off the machine and remove the pads from the bottom of the mop.

## Washing Pads

Machine wash pads with fragrance-free detergent. Do not use fabric softener.

FYI Nellie's Laundry Soda works great!



# CHARGING

## Charging

Pull out the rubber cap and turn it until the whole charging port is revealed. Plug the charger into the charging port.

Note:

- Overcharging the battery may cause damage.
- Avoid charging for more than 5 hours.
- Use the original adapter and battery.
- Fully charge mop prior to first use.

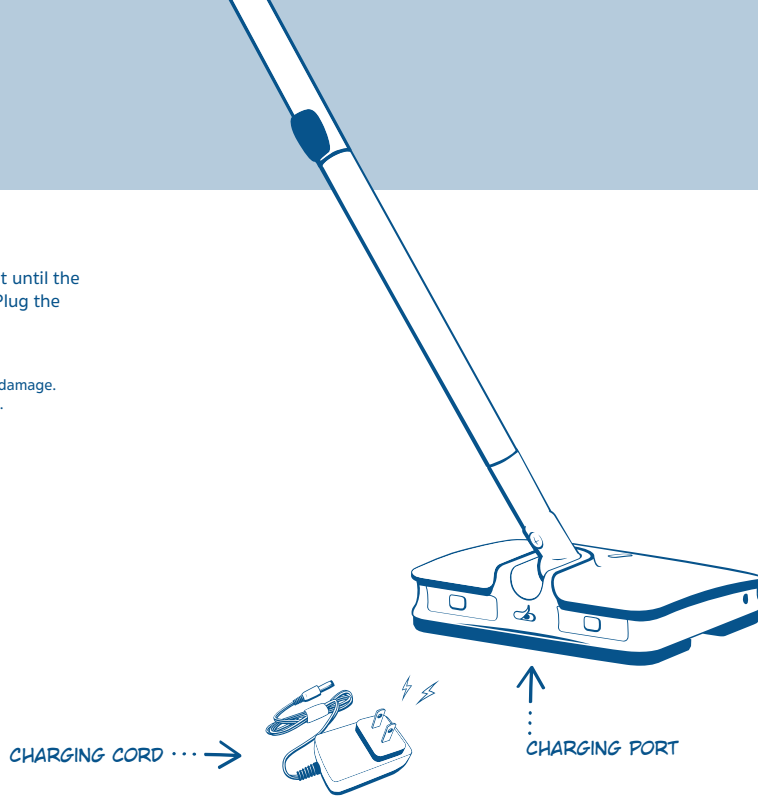

## 8 BATTERY REPLACEMENT

### Replacing the Handle Battery

There are three screws located underneath the handle. Remove the screws and the top panel. Replace the battery with the one provided.

The WOW Too requires a 23 A/12 V battery.

### Replacing the Base Battery

Batteries don't last forever. But, that doesn't mean you have to stop using your favourite cleaning device. Press the release button to remove the battery from the base. Please dispose of the old battery at your local recycling depot. New batteries are available at [nelliesclean.com](http://nelliesclean.com).

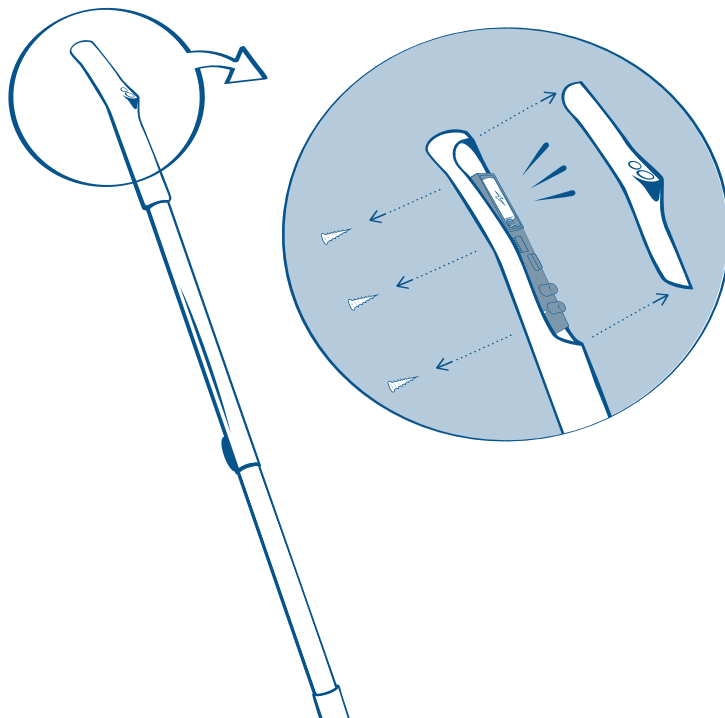
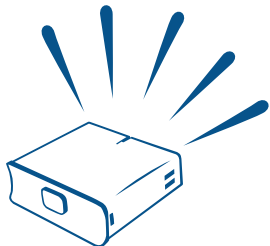



## Optional Charging Base

Your mop is compatible with an optional charging base. Insert the removable battery into the base, or vertically place the mop inside the larger opening.

The removable battery indicator light is red when charging and will turn green once fully charged.

The battery indicator on the mop will flash when charging and stay on when fully charged.

Note:

- Make sure you removed the cleaning pads prior charging.
- Both the mop and an extra removable battery can be charged at the same time.

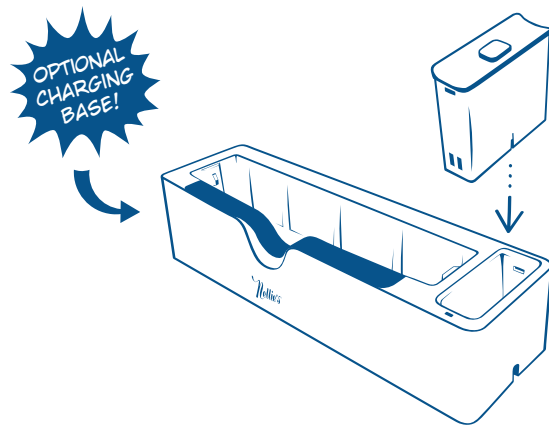

# 10 TROUBLESHOOTING

<b>Fault</b>	<b>Cause</b>	<b>Solution</b>
Unit is wobbling.	<ol style="list-style-type: none"><li>1. Mop pads are not installed properly.</li></ol>	<ol style="list-style-type: none"><li>1. Turn power "OFF" and replace mop pads.</li></ol>
Reduced spray or no spray.	<ol style="list-style-type: none"><li>1. Reservoir may be empty.</li><li>2. System isn't fully primed.</li><li>3. Spray nozzle is clogged.</li><li>4. Water Reservoir not securely in place.</li></ol>	<ol style="list-style-type: none"><li>1. Refill reservoir.</li><li>2. Spray for 10 to 15 seconds to make sure the solution has flowed through the unit.</li><li>3. Follow instructions on page 5 to clean the spray nozzle.</li><li>4. Ensure the water reservoir is pushed in and clicked securely into place.</li></ol>
No power.	<ol style="list-style-type: none"><li>1. Battery depleted.</li><li>2. Charging cord damaged.</li><li>3. Battery failure.</li><li>4. Battery is not installed properly.</li></ol>	<ol style="list-style-type: none"><li>1. Charge battery for approximately 3 hours. Avoid overcharging.</li><li>2. Do not use. Contact <a href="mailto:info@nelliesclean.com">info@nelliesclean.com</a>.</li><li>3. Do not use. Contact <a href="mailto:info@nelliesclean.com">info@nelliesclean.com</a>.</li><li>4. Follow instructions on page 7 to install again.</li></ol>

Fault	Cause	Solution
Machine is leaking.	<ol style="list-style-type: none"><li data-bbox="538 317 857 334">1. Reservoir cap is not closed properly.</li><li data-bbox="538 363 884 384">2. Spray nozzle isn't screwed on properly.</li></ol>	<ol style="list-style-type: none"><li data-bbox="976 317 1184 334">1. Close the cap properly.</li><li data-bbox="976 363 1277 384">2. Screw the spray nozzle on tightly.</li></ol>
Lights are on but unit won't oscillate or spray.	<ol style="list-style-type: none"><li data-bbox="538 436 817 453">1. The handle battery is depleted.</li></ol>	<ol style="list-style-type: none"><li data-bbox="976 436 1362 474">1. Follow instructions on page 8 to replace the battery in the handle.</li></ol>
No water spraying or no continuous water spraying.	<ol style="list-style-type: none"><li data-bbox="538 529 842 547">1. Reservoir is not installed properly.</li></ol>	<ol style="list-style-type: none"><li data-bbox="976 529 1374 547">1. Follow instructions on page 5 to install again.</li></ol>

# 12 SAFETY INSTRUCTIONS & TECHNICAL PARAMETERS

## Usage

For home use only.

Remove large particles or substances from the floor before using. This product is not a replacement for sweeping or vacuuming.

In case of jam caused by small objects, power off before removing the objects.

Do not let children use the mop as a toy.

Use a rag to clean the mop when it's powered off.

Do not leave any solution in the reservoir for more than 24 hours.

This product isn't waterproof. It is not meant to clean an excessive amount of water or heavy liquid spills.

Too much cleaning solution or water sprayed on the floor can leave marks or stains. Please dry any excess liquid.

## Additional Information

Do not disassemble or remodel the battery and/or charger.

Keep the charger away from heat sources such as radiators.

Do not get the charger wet or expose to water.

Recycle used batteries at your local participating recycling depot.

If there is any damage to the cable please stop using and contact Nellie's customer service.

If your mop is not used for an extended period of time, charge fully and store in a cool, dry place. To keep your battery healthy, recharge at least every three months.

Battery	2000 mAh
Rated Voltage	DC 11.1 V
Rated Power	35 W
Power Charger Voltage	12.6 V
Charging Time	3 h
Run Time	55 min
Reservoir Capacity	130 mL
Net Weight	3.9 kg (8.6 lb)

