

LED FLAT PANEL FIXTURE INSTRUCTIONS

CAUTION

TURN OFF THE MAIN POWER AT THE CIRCUIT BREAKER BEFORE INSTALLING THE FIXTURE, IN ORDER TO PREVENT POSSIBLE SHOCK.



GENERAL

- All electrical connections must be in accordance with local and National Electrical Code (N.E.C.) standards. If you are unfamiliar with proper electrical wiring connections obtain the services of a qualified electrician.
- Remove the fixture and the mounting package from the box and make sure that no parts are missing by referencing the illustrations on the installation instructions.

THIS PRODUCT MUST BE INSTALLED IN ACCORDANCE WITH THE APPLICABLE INSTALLATION CODE BY A PERSON FAMILIAR WITH THE CONSTRUCTION AND OPERATION OF THE PRODUCT AND THE HAZARDS INVOLVED.

PARTS INCLUDED:	QTY
1. Mounting Plate	1
2. 3/16 in. Toggle Bolts	4
3. Wire Nuts	3
4. Screws #8-32 x1in.	2

MOUNTING INSTRUCTIONS

READ IMPORTANT SAFETY INFORMATION FIRST ON REVERSE SIDE OF THIS SHEET

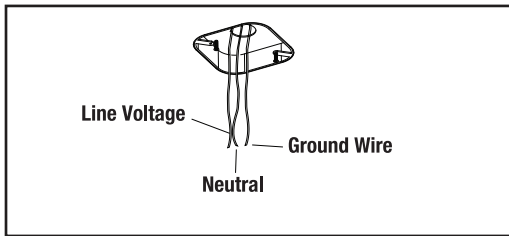

Step 1

- Turn OFF the main power at the circuit breaker before installing fixture.
- Following tools will be needed to complete this job:
 - 1) Philips Head Screw Driver
 - 2) Drill
 - 3) 1/2 in. Drill Bit
 - 4) Safety Glasses

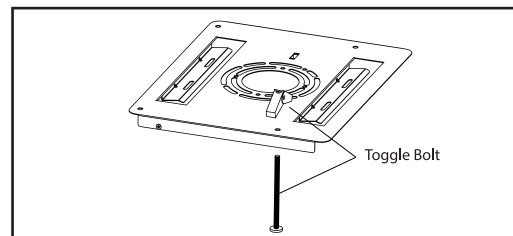

Step 4

- Remove the mounting plate (1) from the junction box
- Drill the marked holes using a 1/2 in. drill bit
- Remove the wings from the 3/16 in. toggle bolts (2)
- Insert screw (2) through front of the mounting plate (1) and then reattach the wing to the screw, do this for all toggle bolts

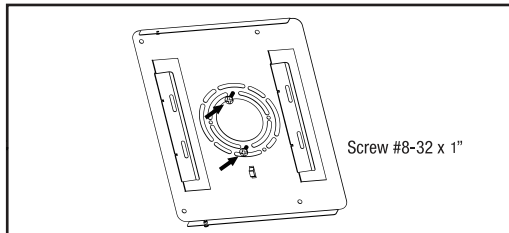

Step 2

- Install the mounting plate (1) to the junction box using the two #8-32 x 1in. screws (4) provided
- Align the mounting plate in the direction you want the fixture to be aligned

NOTE: Once the toggle bolts are installed, you cannot change the orientation of the LED Flat Panel. Take care to align the mounting plate properly in this step

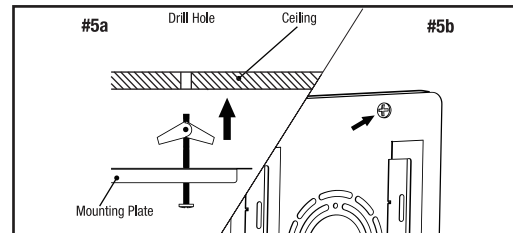

Step 5

- Feed the Junction box wires through the center of the mounting bracket plate hole
- Re-install the mounting plate onto the ceiling in the same orientation as in Step 3 by inserting the toggle bolts into the drilled holes
- Once the wings are through the drywall and have expanded, pull the screw downward to engage the wing on the backside of the ceiling. Once engaged, secure into place by tightening the screws

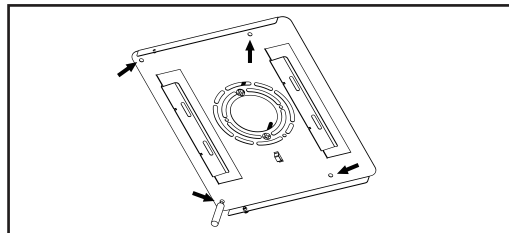

Step 3

- Using the mounting plate as a guide, mark the position of the holes on the ceiling or wall where the toggle bolts will be placed

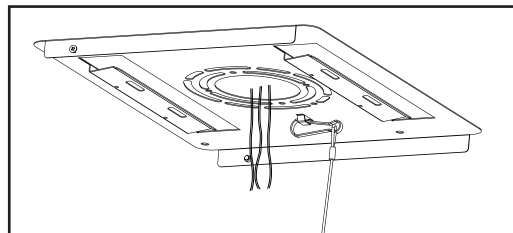

Step 6

Connecting the LED Flat Panel

- Hook the support wire from the fixture on the mounting bracket plate, as shown.

SAVE THESE INSTRUCTIONS

LED FLAT PANEL FIXTURE INSTRUCTIONS

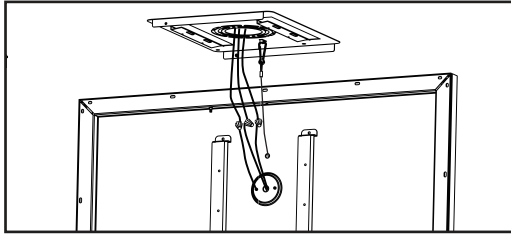

Step 7

- Connect the 3 wires coming from the fixture to the Junction box wires (black - line voltage, white - neutral and green - ground).

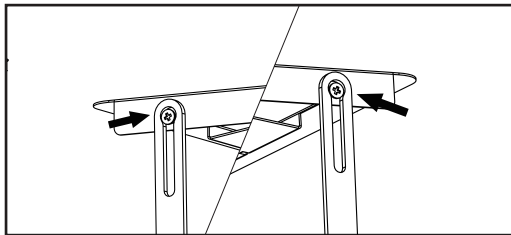

Step 8

- Insert swing arm's key hole slot into the mounting bracket plate's hanging screw, as shown.

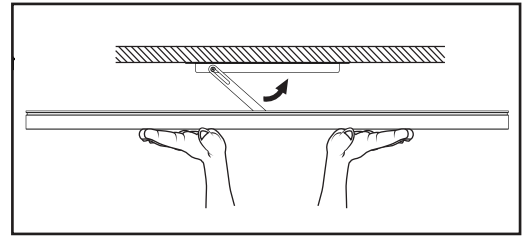

Step 9

- Feed the junction box and fixture wires through the mounting bracket plate's center hole.
- Raise the Fixture to the direction of the arrow on the swing arm.

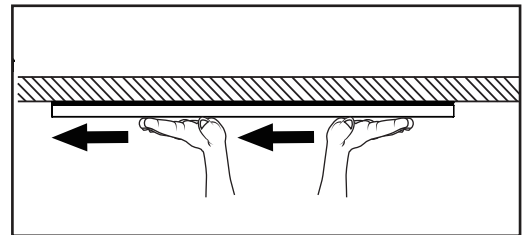

Step 10

- Once the fixture has been raised and is flush to the ceiling, as shown. Lock Fixture by moving it towards the opposite direction it was raised.

IMPORTANT SAFETY INFORMATION

- WARNING: RISK OF SHOCK** House electric current can cause painful shock or serious injury unless handled properly. For your safety, always remember to:
 - Turn off the power Supply at the fuse or circuit breaker box before you install the fixture.
 - Ground the fixture to avoid potential electric shocks and to ensure reliable starting.
 - Double-check all connections to be sure they are tight and correct.
 - Wear rubber soled shoes and work on a sturdy wooden ladder.
- This fixture is designed for use in a circuit protected by a fuse or circuit breaker. It is also designed to be installed in accordance with local electrical codes. If you are unsure about your wiring, consult a qualified electrician or local electrical inspector, and check your local electrical code.
- WARNING: RISK OF CUTS** Some metal parts in the fixture may have sharp edges. To prevent cuts and scrapes, wear gloves when handling the parts.
- Account for small parts and destroy packing material, as these may be hazardous to children.

LIGHTING DISTRIBUTION		
	Center Beam (Foot Candles)	Beam Diameter
3ft	145	10ft
5ft	52	17ft
8ft	20.4	27ft
15ft	5.8	50ft

Beam Angle = 118°

CAUTION

WARNING: Risk of fire. Use only on 120 volt 60Hz circuits. Suitable for damp locations. Before installing your lighting fixture, thoroughly review enclosed installation manual. If you do not have sufficient electrical wiring experience, please refer to a do-it-yourself wiring handbook or have your fixture installed by a qualified licensed electrician. All electrical connections must be in accordance with Local and National Electrical Code (NEC) Standards. Reliable operating temperature is 0°F –100°F. Access above ceiling required. Vapor barrier must be suitable for 90°C. If flickering occurs in low level dimming, increase light level. Compatible with most dimmers including Leviton 6681-IW, Lutron S-600P and Lutron DVCL-153. Dimmable to 10% with most dimmers. For more information including dimmer compatibility visit www.feit.com or call our toll free number 1-866-326-BULB.

This device complies with part 15 of the FCC Rules. Operation is subject to the following two conditions:
 (1) This device may not cause harmful interference, and
 (2) this device must accept any interference received, including interference that may cause undesired operation.
 Note: This equipment has been tested and found to comply with the limits for a Class B digital device, pursuant to part 15 of the FCC Rules. These limits are designed to provide reasonable protection against harmful interference in a residential installation. This equipment generates, uses and can radiate radio frequency energy and, if not installed and used in accordance with the instructions, may cause

harmful interference to radio communications. However, there is no guarantee that interference will not occur in a particular installation. If this equipment does cause harmful interference to radio or television reception, which can be determined by turning the equipment off and on, the user is encouraged to try to correct the interference by one or more of the following measures: Reorient or relocate the receiving antenna. Increase the separation between the equipment and receiver. Connect the equipment into an outlet on a circuit different from that to which the receiver is connected. Consult the dealer or an experienced radio/TV technician for help.

LIMITED WARRANTY

This product is warranted to be free from defects in workmanship and materials for up to 5 years from date of purchase. If it fails to do so, please contact Feit Electric at info@feit.com or call 1-866-326-BULB (2852) for instructions on replacement. Do not return the product to the store.

For comments please write to:
 FEIT ELECTRIC
 Customer Service Department
 4901 Gregg Road, Pico Rivera, CA 90660