

Love Swirls

8" x 8"

Cutting Instructions:

	Color	Fabric	Quantity	Size
	White	A	16	1 3/4" x 1 1/4" rectangles
	White	B	16	1 1/4" squares
	White	C	8	1 1/2" squares
	Pink	D	16	1 1/4" squares
	Pink	E	8	1 1/2" squares
	Dark Pink	F	8	1 1/2" squares
	Red	G	16	1 3/4" x 1 1/4" rectangles
	Red	H	8	1 1/2" squares
	Dark Red	I	8	1 1/2" squares

Deb Tucker's Studio 180 Designs

- Tucker Trimmer® 1
- Wing Clipper® 1

Notes: Please read all instructions before starting.

This pattern requires the use of the following Studio 180 Design's tools:

- Tucker Trimmer® 1
- Wing Clipper® 1

If you don't have them, please visit your local quilt shop or order them directly from Studio180Design.net.

If you need more details or left handed cutting instructions on using these tools please refer to your the general directions that came with your tools or visit Studio 180 design's website for videos.

For best results: Use a 1/4" seam allowance and press as indicated by arrows. Also, press your fabrics thoroughly using your favorite spray starch before starting your project.

Abbreviations

WOF= Width of the Fabric based on 42" selvage to selvage HST = Half Square Triangle FG = Flying Geese

Half Square Triangles (HST)

Ruler: Tucker Trimmer® 1

1. **Draw** two diagonal lines 1/4" on either side of the center diagonal line on the wrong side of the (2) **Fabric C** square.
2. With right sides facing, **layer** a **Fabric E** square with a **Fabric B** square.
3. **Stitch** on the drawn lines, then **cut** down the middle.
4. **Press** seam in the direction indicated by arrows.
5. **Trim** to 1 1/2" using the **Tucker Trimmer® 1**.
6. Repeat the steps 1-5 above to make **make 4 C/E HST Units**.
7. Repeat the steps above to make the following HST combinations.

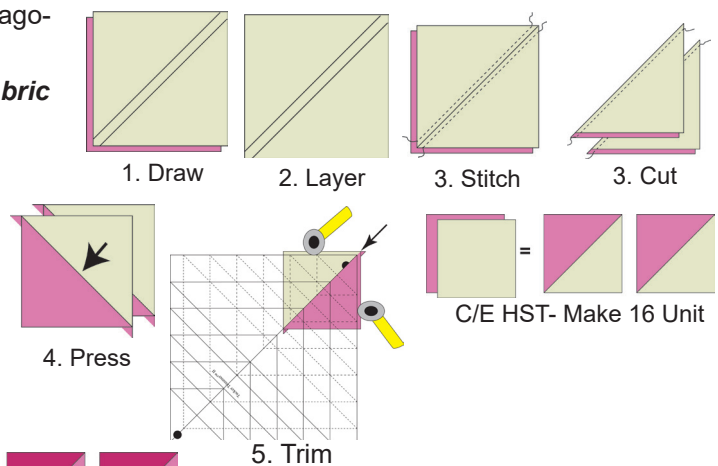

Make 16 C/I Units

Make 16 E/F Units

Make 16 F/H Units

Make 16 F/I Units

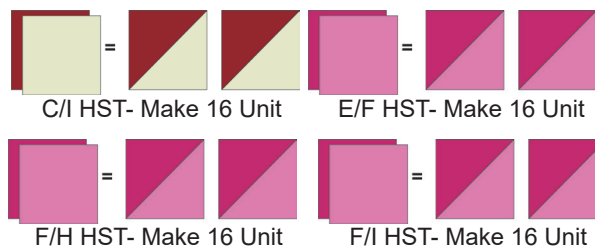

Note: Please remember to read your ruler instructions thoroughly before using them.

1. **Mark** a diagonal lines, on the wrong side of (4) **Fabric D** squares.
2. **Position Fabric D** square on top of a **Fabric A** rectangle as shown.
3. **Stitch** on the drawn lines, **then trim 1/4" from the stitched line** on the center diagonal.
4. **Press** seams in the direction indicated by arrows.
5. **Trim** unit to 1" x 1 1/2" using the **Wing Clipper® 1 ruler**. You will have **16 A/D units**.
6. Repeats Steps 1-4 t make 4 B/G Units. **Note: Step 2 (B/G units) make sure your Fabric B square is going in the current direction as shown.**

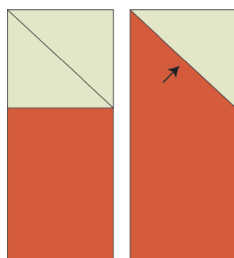
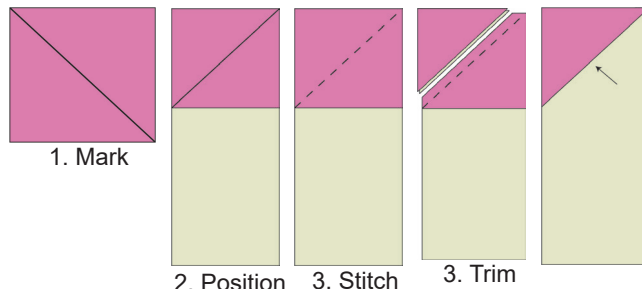

6. B/E Units Make 4

Block Assembly Instructions - Make 4

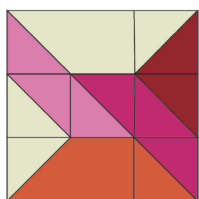

Make 4

1. Stitch (1) **A/D unit**, and (1) **C/I HST unit** as shown. Repeat 15 more times. **Make 16 rows.**

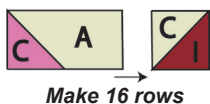

Make 16 rows

2. Stitch (1) **C/E**, (1) **E/F** and (1) **F/I** HST units as shown. Repeat 15 more times. **Make 16 rows.**



Make 16 rows

3. Stitch (1) **B/G** and (1) **F/H HST** units as shown.



Make 16 rows

4. Stich Block as shown. Block should measure 2" x 2". Repeat 15 more times. **Make 16 blocks.**

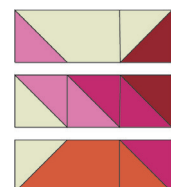

Make 16 Blocks

5. Assemble (4) quilt blocks as shown. Block should measure 3 1/2" x 3 1/2". Repeat 3 more times. **Make 4 blocks.**

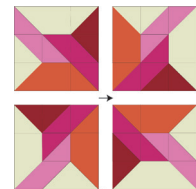

Make 4 Blocks

Finishing Instructions

1. Assemble the quilt blocks as shown.

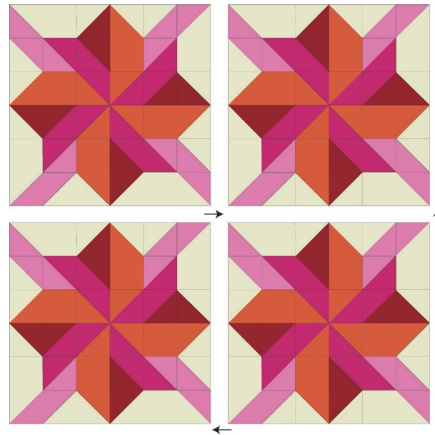

Borders

Border 1 (Pink)

Cut 2 strips at 1" x Width of Fabrics

subcut into:

2 - 1" x 6 1/2" (Left and Right)

2 - 1" x 7 1/2" (Top and Bottom)

Attach left and right borders. Press outwards.

Attach top and bottom borders. Press outwards.

Border 2

Cut 2 strips at 1 1/2" x Width of Fabrics

subcut into:

4 - 1 1/2" x 7 1/2" (Left and Right)

3 - 1 1/2" x 8 1/2" (Top and Bottom)

Attach left and right borders. Press outwards.

Attach top and bottom inner borders. Press outwards.

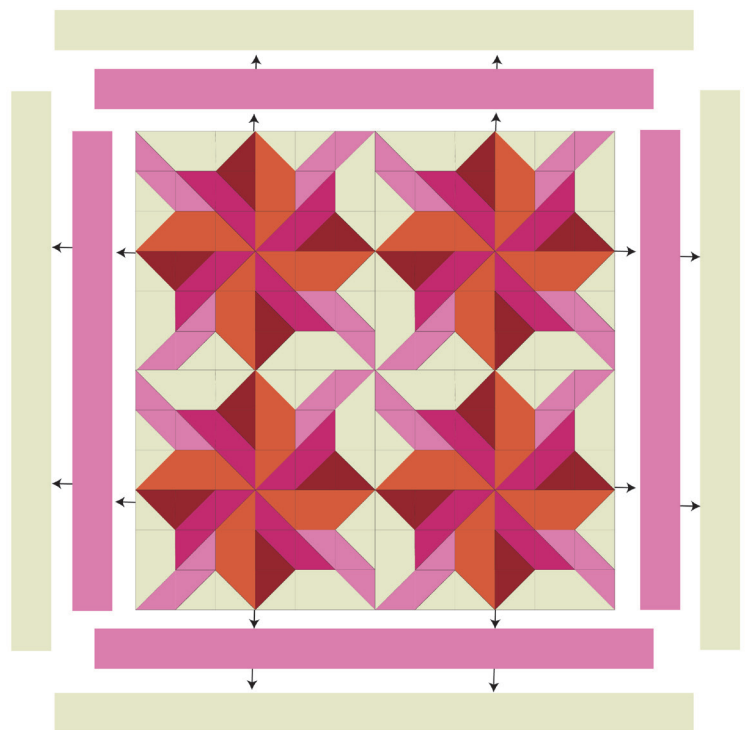

Finishing: Quilt and bind as desired.

Love Swirls



Finished Size 8" x 8"

MATERIALS LIST

Fat Quarter of the Following Fabrics:

**White or Cream
Pink
Dark Pink
Red
Dark Red**

Optional:

Tucker® Trimmer 1, WingClipper® 1 and Picket & Quicket Technical Sheet