

USER MANUAL FOR MONITOR

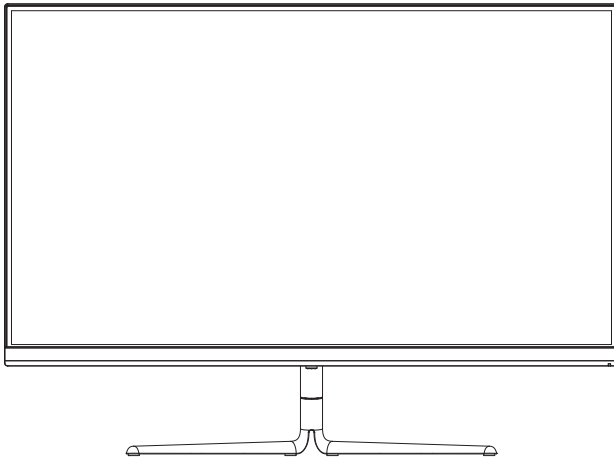

P25A2H

Precautions

Before using this product, please read this User Manual carefully and keep it well

- Keep the monitor away from water sources or damp places, such as bath rooms, kitchens, basements and swimming pools.
- Make sure the monitor is placed on a flat surface. If the monitor falls down, it may cause human injury or device damage.
- Store and use the monitor in a cool, dry and well ventilated place, and keep it away from emission and heat sources.
- Do not cover or block the vent hole in the rear casing, and do not use the product on a bed, sofa, blanket or similar objects.
- The range of the supply voltage of the monitor is printed on the label on the rear casing. If it is impossible to determine the supply voltage, please consult the distributor or local power company.
- If the monitor will not be used for a long period, please cut off the power supply to avoid electric shock in rainy days and damage due to abnormal supply voltage.
- Please use a reliable grounded socket, Do not overload the socket, or it may cause fire or electric shock.
- Do not put foreign matters into the monitor, or it may cause short circuits resulting fire or electric shock.
- Do not disassemble or repair this product by self to avoid electric shock. If faults occur, please contact the after-sales service directly.
- Do not pull or twist the power cable forcedly.
- There is a polarizer layer (not a protective film) on the surface of the screen. Do not peel it off, or the product may be damaged and the warranty will be invalid.

Package Content

Packing list

- Please check that the package of the monitor contains all parts. If any part is lost, please contact the distributor.
- The color and shape of parts may vary with models. Figures in this User Manual are for reference only.
- Cables supplied may vary with purchased products. Figures in this User Manual are for reference only.

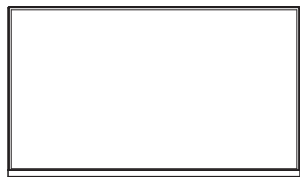

Monitor



Stand



Base

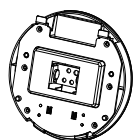

Rotary shaft component



① M4 10mm x 3
(Fixed Stand)



② M4 12mm x 2
(Fixed Base)

Screws

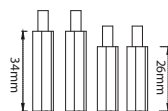

Mount Screws x 4

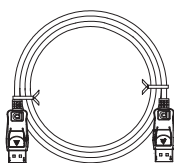

DP signal cable

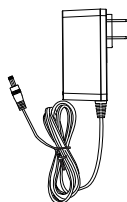

Power adapter



User manual

- Redundant screws can be used as spare screws.

Installation

Installation of base

1. Open the package, take out the product with foam still attached, and gently place it on a desktop or table.

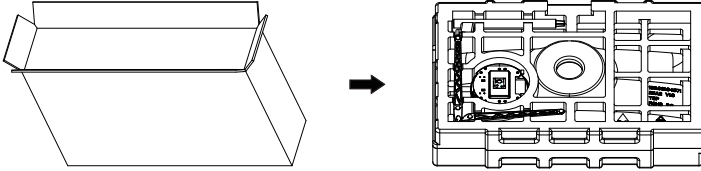

2. Take out the stand and the rotary shaft component, and lock them with 2 M4*10mm screws as shown below.

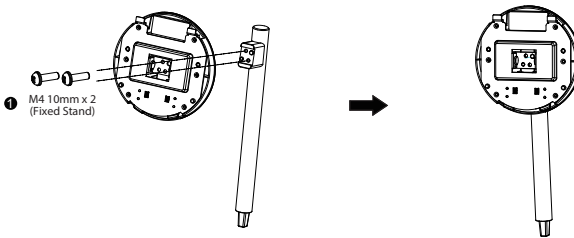

3. Take out the stand and the base, tighten them with 1 M4 x 12 screws as shown below.

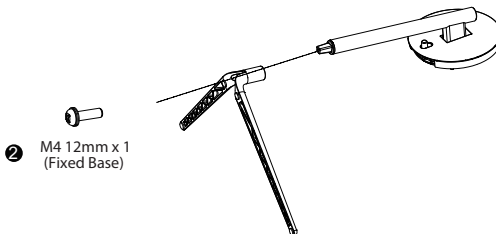

4. Put the assembled base components into the slot of the rear casing, slightly press the stand to clip the rotary shaft component into position, and hold the middle of the stand with hand to lightly lift the monitor twice to ensure that the monitor can not loose and the clip can lock the base component firmly; during disassembly, perform these steps reversely.

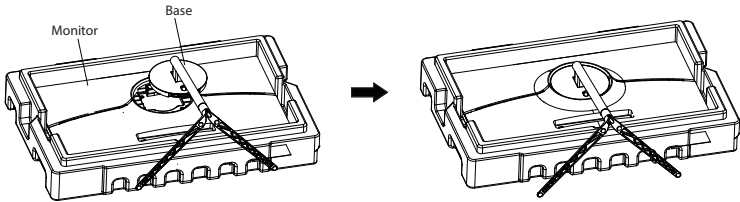

5. After assembly, simply hold the stand with hand to stand the monitor upright.

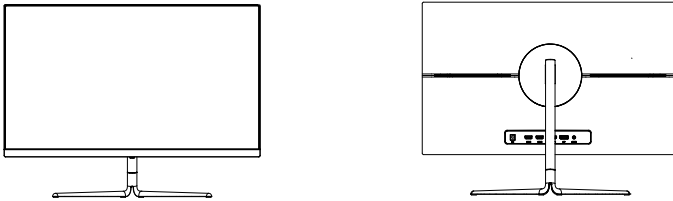

 Note: During standing of the whole monitor, do not press the liquid crystal screen with hand to avoid damage to the screen.

Installation of mount

1. Open the package, take out the product with foam still attached, and gently place it on a desktop or table. Remove the upper foam cover and put it aside, take out the monitor film bag and put the monitor in the lower foam cover.

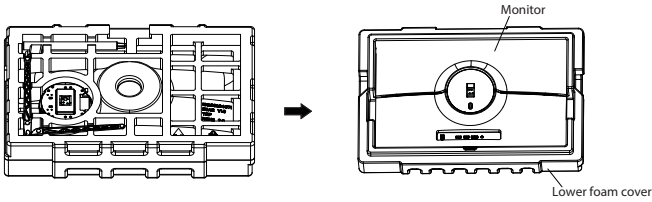

2. Toggle the quick-disassembly button upwards and take out the rotary shaft component.

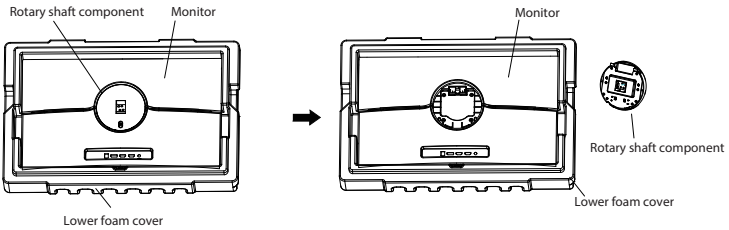

3. Take out four studs for hexagon irons from the accessory bag to and lock them on the rear casing.

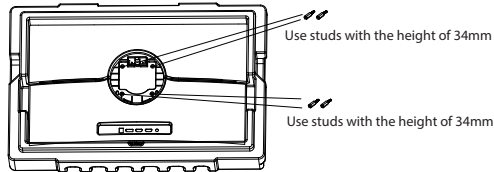

4. Note: Hang the assembled product on a hard wall. Do not pinch the screen with your hands during the hanging process to avoid damaging the screen.

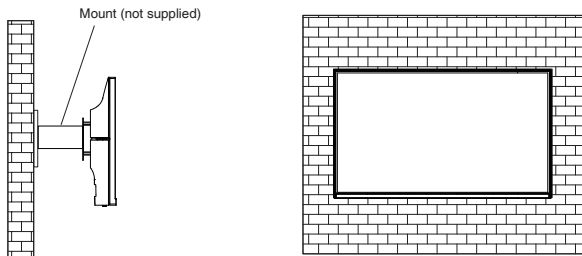

Note: In order to prevent the monitor from falling when it is used on the wall, please install it properly and do safety protection. Do not place or hang any objects on the wall bracket, and the wall height should be within 2 meters.

Adjustment of monitor

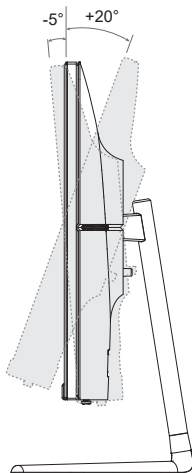

Tilting angle
 $-5.0^\circ(\pm 2.0^\circ)$ - $+20^\circ(\pm 2.0^\circ)$

Instructions

Description of buttons

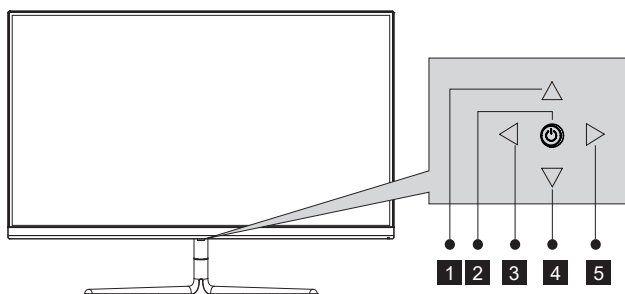

Button	Function
1	Down rocker button: Quickly enter the Game Crosshair menu.textual mode.
2	Rocker switch button: press to turn on/off the monitor.
3	Left rocker button: Quickly enter the Input Signal or go back to the previous menu/exit.
4	Up rocker button: The rocker is used to quick enter the con
5	Right rocker button: Press to enter sub-menus/ quickly enter the main menu.

Explanation of indicators

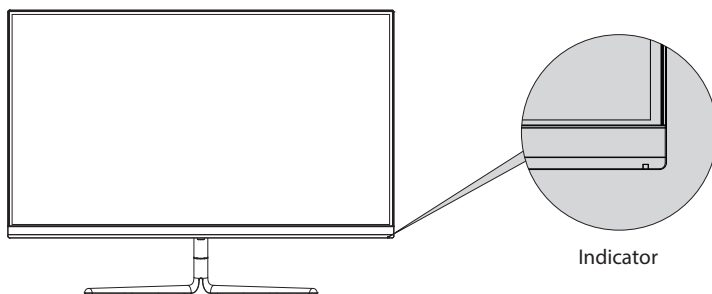

Indicator: Steady blue light indicates the power is on and the monitor runs normally. Red light to indicate no video source and no horizontal or vertical signal detected or low voltage. Please make sure that your computer is turned on and all video cables are fully plugged in and/or connected.

Cable connection :

* The bottom interface configuration at the back of the monitor varies with products.

* Note: If the power cable or signal cable is damaged, you must replace it with special soft cables or special components purchased from the manufacture or maintenance department.

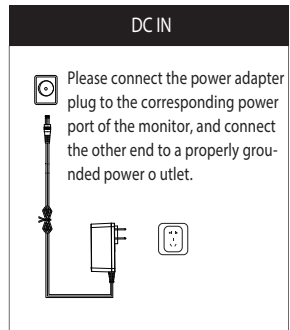
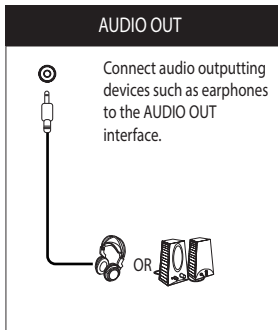
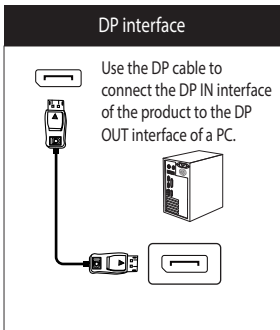
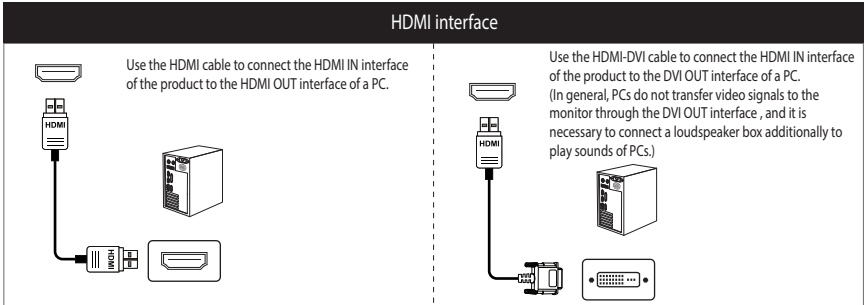

OSD menu

Menu description

- The color and shape of the OSD menu of the actual computer may be slightly different from them shown in the figure.
- Specifications of the OSD menu may change with improvements of functions without prior notice.

Press the menu button on the control panel to access the monitor menu. The detailed information of each menu can be found in the following sections.

1. Rocker key (Right) to enter the OSD main menu or enter sub-menus.

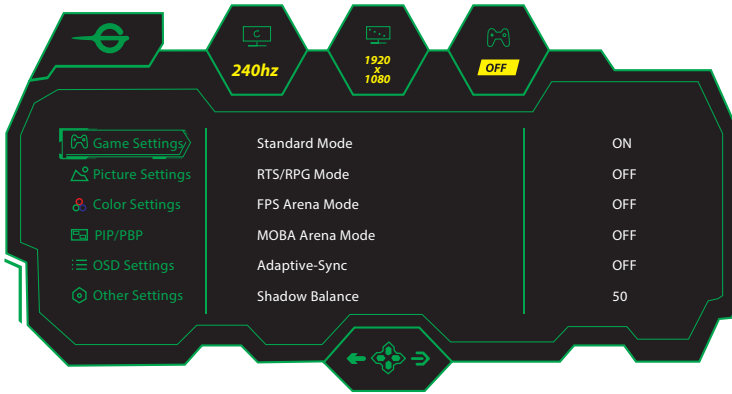

2. Rocker key (Up) to enter the Contextual Model or move up in the menu.

3. Rocker key (Down) to enter the GamePlus Switching or move down in the menu.

4. Rocker key (Left) to enter the Input Signal or exit the current screen.

* Functions of the monitor vary with models, and the functions in this manual are for reference only.

Game Settings	Standard Mode	Off/On
	RTS/RPG Mode	Off/On
	FPS Arena Mode	Off/On
	MOBA Arena Mode	Off/On
	Adaptive-Sync	Off/On
	Shadow Balance	0-100
	Response Time	Off/Normal/Fast/Ultrafast
	Refresh Rate	Off/On
		Position: Top Right/Top Left/Bottom Right/Bottom Left
	Game Crosshair	Off
		On: Crosshair 1/Crosshair 2/Crosshair 3/Crosshair 4/Crosshair 5/Crosshair 6
	Game Time	Off
		On: 15:00/30:00/45:00/60:00
	Dynamic Brightness	Off/Normal/Expert/Elaboration
MPRT	Off/On	
Ambient Lighting	Off/On	
Picture Settings	Brightness	0-100
	Contrast	0-100
	DCR	Off/On
	Contextual Model	Off
		On : Movie Mode/Reading Mode/Night Mode
	Low Blue Light	0-100
	Sharpness	0-5
	Gamma	1.8/2.0/2.2/2.4/2.6/ S.curve
	Aspect Ratio	Wide Screen/4:3/1:1/Auto
Warm	Off/On	
Color Settings	Natural	Off/On
	Cool	Off/On
	User1	Off/On
	User2	Off/On
	User3	Off/On
	Hue	R/G/B/C/M/Y: 0-100
	Saturation	R/G/B/C/M/Y: 0-100

* Functions of the monitor vary with models, and the functions in this manual are for reference only.

PIP/PBP	PIP/PBP mode	Off/PIP Mode/PBP 2Win 1:1
	Sub-Signal Source	DP1/DP2/HDMI1/HDMI2
	Audio Source	Auto/DP1/DP2/HDMI1/HDMI2
	PIP Position	Top Right/Top Left/Bottom Right/Bottom Left
	PIP Size	Small/Medium/Large
	Window Swap	Off/On
OSD Settings	Language	简体中文/English/한국어/عربي/Portugues do Brasilazil/Deutsch/Nederland/Suomi/Français/Ελληνικά/Indonesia/Italiano/日本語/Malaysia/Polskie/Português/Русский/Español/ไทย/Українська/Tiếng Việt/繁体中文/Türkçe
	OSD Time Out	5-60
	OSD H-Position	0-100
	OSD V-Position	0-100
	OSD Transparency	0-5
	Hotkey1 Setting	Brightness/Contrast/Volume/Mute/Shadow Balance/Game Crosshair/Refresh Rate/Game Time /Contextual Model/PIP/PBP Mode/Input Signal/Dynamic Brightness
	Hotkey2 Setting	Brightness/Contrast/Volume/Mute/Shadow Balance/Game Crosshair/Refresh Rate/Game Time /Contextual Model/PIP/PBP Mode/Input Signal/Dynamic Brightness
	Hotkey3 Setting	Brightness/Contrast/Volume/Mute/Shadow Balance/Game Crosshair/Refresh Rate/Game Time /Contextual Model/PIP/PBP Mode/Input Signal/Dynamic Brightness
OSD Lock	Off/On	
Other Settings	Input Signal	Auto/DP1/DP2/HDMI1/HDMI2
	Volume	0-100
	Mute	Off/On
	Auto Power	Off/On
	Eyeshield Remind	Off/On
	Reset	No/Yes
	Information	Input Source/Resolution/Mode

Basic parameters

Product model		P25A2H
Screen Size		24.5"
Aspect Ratio		16:9
Viewing Angle		178°(H) / 178°(V)
Pixel pitch		0.2832 (H) × 0.2802 (V) mm
Contrast ratio		3000:1 (TYP)
Colors		16.7M
Resolution		1920 x1080
Maximum refresh rate		240Hz
Power supply		12V===4.0 A
Ports		HDMI2.0 x 2, DP1.4 x 2, Audio Output x 1
Product Dimensions Lifting base	Without base	556.4 x 328.4 x 67.2 mm
	With base	556.4 x 409.6 x 184.8 mm
Tilting angle		Forward tilting : 5° ± 2°; Backward tilting: 20° ± 2°
Height range		N/A
Rotation angle		N/A
Vertical angle		N/A
speaker		N/A
Net Weight		4.05 kg
Gross Weight		5.49 kg
Environmental conditions	Action	Temperature: 0°C~ 40°C (32°F ~ 104°F) Humidity: 10%~90% RH (non-condensing)
	Storage	Temperature: -20°~ 60° (-4°F ~ 140°F) Humidity: 5%~95% RH (non-condensing)



The terms HDMI and HDMI High-Definition Multimedia Interface, and the HDMI Logo are trademarks or registered trademarks of HDMI Licensing Administrator, Inc. in the United States and other countries.



*This device complies with Part 15 of the FCC rules.
Operation is subject to the following two conditions:
(1) this device may not cause harmful interference, and
(2) this device must accept any interference received,
including interference that may cause undesired operation.*