

USER MANUAL FOR MONITOR

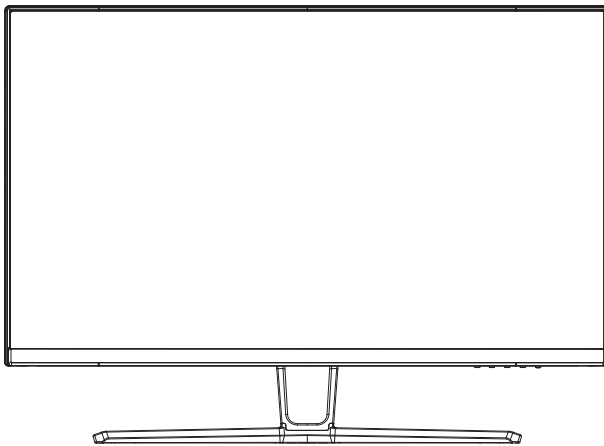

C32C1S

Precautions

Before using this product, please read this User Manual carefully and keep it well

- Keep the monitor away from water sources or damp places, such as bath rooms, kitchens, basements and swimming pools.
- Make sure the monitor is placed on a flat surface. If the monitor falls down, it may cause human injury or device damage.
- Store and use the monitor in a cool, dry and well ventilated place, and keep it away from emission and heat sources.
- Do not cover or block the vent hole in the rear casing, and do not use the product on a bed, sofa, blanket or similar objects.
- The range of the supply voltage of the monitor is printed on the label on the rear casing. If it is impossible to determine the supply voltage, please consult the distributor or local power company.
- If the monitor will not be used for a long period, please cut off the power supply to avoid electric shock in rainy days and damage due to abnormal supply voltage.
- Please use a reliable grounded socket, Do not overload the socket, or it may cause fire or electric shock.
- Do not put foreign matters into the monitor, or it may cause short circuits resulting fire or electric shock.
- Do not disassemble or repair this product by self to avoid electric shock. If faults occur, please contact the after-sales service directly.
- Do not pull or twist the power cable forcedly.
- There is a polarizer layer (not a protective film) on the surface of the screen. Do not peel it off, or the product may be damaged and the warranty will be invalid.

Package Content

Packing list

- Please check that the package of the monitor contains all parts. If any part is lost, please contact the distributor.
- The color and shape of parts may vary with models. Figures in this User Manual are for reference only.
- Cables supplied may vary with purchased products. Figures in this User Manual are for reference only.



Monitor



Stand Stem



Base

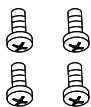

Screws x 4

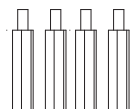

Mount Screws x 4

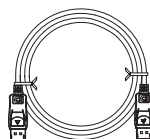

DP signal cable

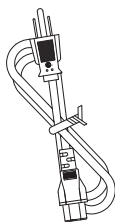

Power Cable

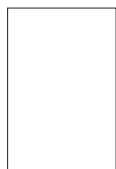

User manual

- Redundant screws can be used as spare screws.

Installation

Installation of base

1. Open the package, take out the product with foam still attached, and gently place it on a desktop or table.

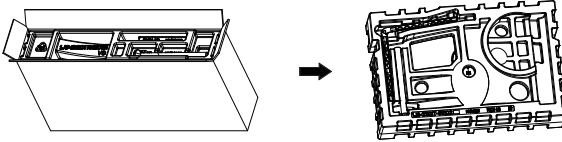

2. Take out the stand stem and base. As pictures shows, use a screws to fasten stand stem and base together.

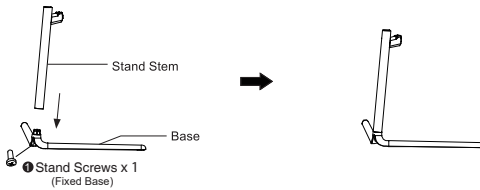

3. Remove the foam covering the bottom of the monitor, then remove the adapter from the back of monitor. Use two screws to fasten the adapter onto the stand stem.

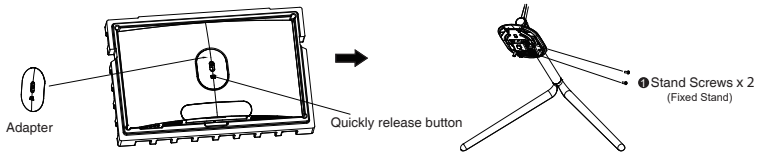

4. Align the stand stem's bracket with the opening on the back of the monitor, and carefully insert bracket. The pieces should click into place. Slide up the quick release button if you need to remove the stand.

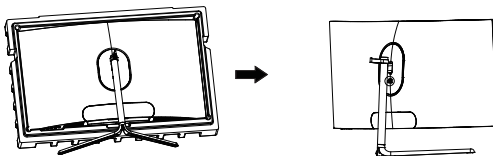

5. After assembly, simply hold the stand with hand to stand the monitor upright.

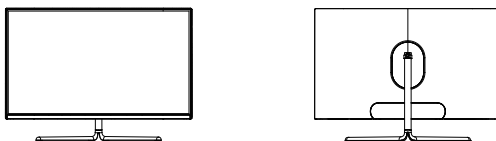

Note: During standing of the whole monitor, do not press the liquid crystal screen with hand to avoid damage to the screen.

Installation of mount

1. Open the package, take out the product with foam still attached, and gently place it on a desktop or table. Remove the extra parts and the foam covering the monitor. Slide up the quickly release button to remove the adapter from the monitor.

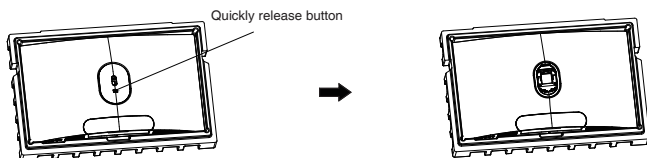

2. Remove the original screws x 4 from the opening in the back of the monitor. Follow the directions received with your mount, stand, or accessory and install the monitor on the wall or fixture as desired. Remember to use the included Mount screws when attaching anything to the back of the monitor. Refer to the image as follow for correct screw placement.

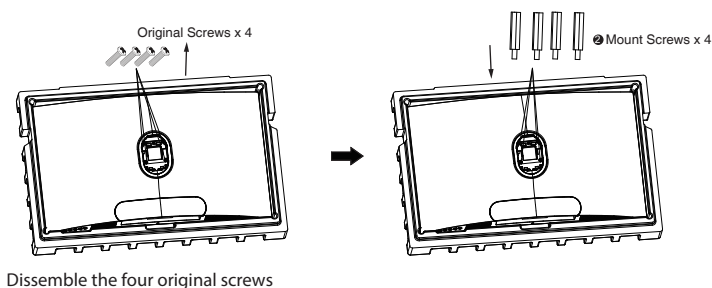

Disassemble the four original screws

3. Note: Hang the assembled product on a hard wall. Do not pinch the screen with your hands during the hanging process to avoid damaging the screen.

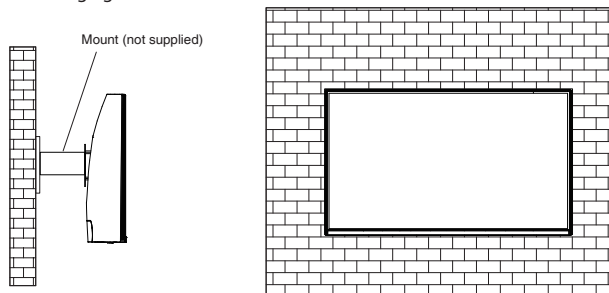

Note: In order to prevent the monitor from falling when it is used on the wall, please install it properly and do safety protection. Do not place or hang any objects on the wall bracket, and the wall height should be within 2 meters.

Adjustment of monitor

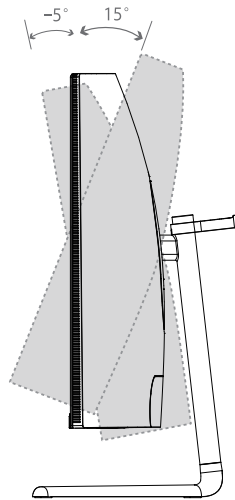

Tilting angle:

$-5^{\circ}(\pm 2^{\circ}) \sim +15^{\circ}(\pm 2^{\circ})$

Instructions

Description of buttons

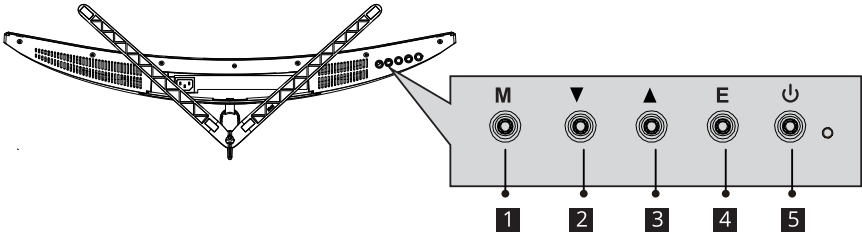

| Button | Function |
|--------|---|
| 1 | Menu button: Press to enter sub-menus/ quickly enter the main menu. |
| 2 | Down button: Press to move down in the menu/quickly adjust the Game Crosshair. |
| 3 | Up button: Press to move up in the menu/quickly adjust the Contextual Model. |
| 4 | Exit/hot key: Press to return to the previous menu/quickly adjust the Input Signal. |
| 5 | Power button: Press to turn on/off the monitor. |

Explanation of indicators

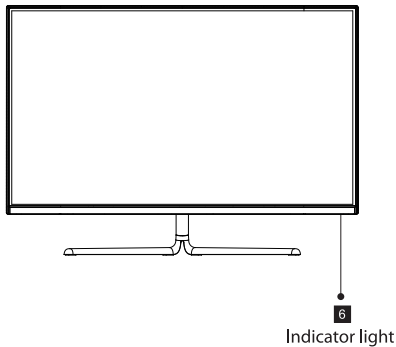

Indicator: Solid blue light indicates power is on and the monitor is operating normally. Flashing blue light indicates no video source has been detected. Please ensure your computer is on and all video cables are fully inserted and connected.

Cable connection:

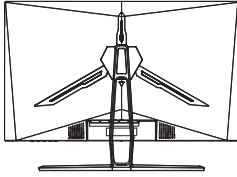

* The bottom interface configuration at the back of the monitor varies with products.

* Note: If the power cable or signal cable is damaged, you must replace it with special soft cables or special components purchased from the manufacture or maintenance department.

HDMI interface



Use the HDMI cable to connect the HDMI IN interface of the product to the HDMI OUT interface of a PC.

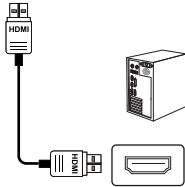

Use the HDMI-DVI cable to connect the HDMI IN interface of the product to the DVI OUT interface of a PC. (In general, PCs do not transfer video signals to the monitor through the DVI OUT interface, and it is necessary to connect a loudspeaker box additionally to play sounds of PCs.)

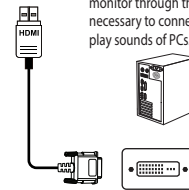

DP interface



Use the DP cable to connect the DP IN interface of the product to the DP OUT interface of a PC.

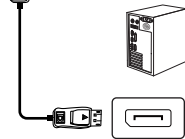

AUDIO OUT



Connect audio outputting devices such as earphones to the AUDIO OUT interface.



AC IN



Please connect the power cable plug to the corresponding port of the monitor, and connect the other end to a properly grounded power outlet.

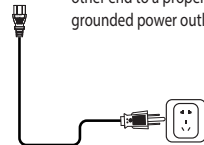

OSD menu

Menu description

- The color and shape of the OSD menu of the actual computer may be slightly different from them shown in the figure.
- Specifications of the OSD menu may change with improvements of functions without prior notice.

The screen display (OSD) menu can be used to adjust settings of the monitor and is shown on the screen after the monitor is powered on and the **M** button is pressed.

1. Press the button **M** to activate the browser screen.

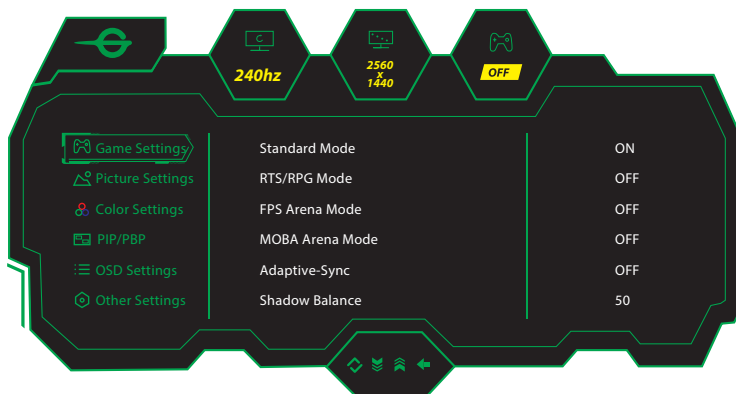

2. Press **▼** or **▲** to scroll through the functions.

- Select the desired function, and press **M** to enter the sub-menu.
- Press **▼** or **▲** to scroll through sub-menus, and press **M** key to select and confirm the desired function.
- Press **▼** or **▲** to select one option, and press **M** to confirm settings and exit from the current menu.

3. Press **E** to exit from the menu screen

* Functions of the monitor vary with models, and the functions in this manual are for reference only.

| | | |
|------------------|--------------------------|---|
| Game Settings | Standard Mode | Off/On |
| | RTS/RPG Mode | Off/On |
| | FPS Arena Mode | Off/On |
| | MOBA Arena Mode | Off/On |
| | Adaptive-Sync | Off/On |
| | Shadow Balance | 0-100 |
| | Response Time | Off/Standard/Fast/Ultrafast |
| | Refresh Rate | Off/On |
| | | Position: Top Right/Top Left/Bottom Right/Bottom Left |
| | Game Crosshair | Off |
| | | On: Crosshair 1/Crosshair 2/Crosshair 3/Crosshair 4/Crosshair 5/Crosshair 6 |
| | Game Time | Off |
| | | On: 15:00/30:00/45:00/60:00 |
| | Dynamic Brightness | Off/Standard/Expert/Elaboration |
| HDR | Off/HDR Standard | |
| MPRT | Off/On | |
| Ambient Lighting | Off/On | |
| Picture Settings | Brightness | 0-100 |
| | Contrast | 0-100 |
| | DCR | Off/On |
| | Contextual Model | Off |
| | | On: Movie Mode/Reading Mode/Night Mode |
| | Low Blue Light | 0-100 |
| | Sharpness | 0-5 |
| | Gamma | 1.8/2.0/2.2/2.4/2.6/ S.curve |
| Aspect Ratio | Wide Screen/4:3/1:1/Auto | |
| Color Settings | Warm | Off/On |
| | Natural | Off/On |
| | Cool | Off/On |
| | User1 | Off/On |
| | User2 | Off/On |
| | User3 | Off/On |
| | Hue | R/G/B/C/M/Y: 0-100 |
| | Saturation | R/G/B/C/M/Y: 0-100 |

* Functions of the monitor vary with models, and the functions in this manual are for reference only.

| | | |
|----------------|--------------------------------------|--|
| PIP/PBP | PIP/PBP mode | Off/PIP Mode/PBP 2Win 1:1 |
| | Sub-Signal Source | DP1/DP2/HDMI1/HDMI2 |
| | Audio Source | Auto/DP1/DP2/HDMI1/HDMI2 |
| | PIP Position | Top Right/Top Left/Bottom Right/Bottom Left |
| | PIP Size | Small/Medium/Large |
| | Window Swap | Off/On |
| OSD Settings | Language | 简体中文/English/한국어/العربية/Portugues do Brasilazil/Deutsch/Nederland/Suomi/Français/Ελληνικά/Indonesia/Italiano/日本語/Malaysia/Polskie/Português/Русский/Español/ไทย/Українська/Tiếng Việt/繁体中文/Türkçe |
| | OSD Time Out | 5-60 |
| | OSD H-Position | 0-100 |
| | OSD V-Position | 0-100 |
| | OSD Transparency | 0-5 |
| | Hotkey1 Setting | Brightness/Contrast/Volume/Mute/Shadow Balance/Game Crosshair/ Refresh Rate/Game Time /Contextual Model/PIP/PBP Mode/Input Signal/ Dynamic Brightness/HDR |
| | Hotkey2 Setting | Brightness/Contrast/Volume/Mute/Shadow Balance/Game Crosshair/ Refresh Rate/Game Time /Contextual Model/PIP/PBP Mode/Input Signal/ Dynamic Brightness/HDR |
| | Hotkey3 Setting | Brightness/Contrast/Volume/Mute/Shadow Balance/Game Crosshair/ Refresh Rate/Game Time /Contextual Model/PIP/PBP Mode/Input Signal/ Dynamic Brightness/HDR |
| Other Settings | OSD Lock | Off/On |
| | Input Signal | Auto/DP1/DP2/HDMI1/HDMI2 |
| | Volume | 0-100 |
| | Mute | Off/On |
| | Auto Power | Off/On |
| | Eyeshield Remind | Off/On |
| | Reset | No/Yes |
| Information | Input Source/Resolution/Mode/HDR Ver | |

Basic parameters

| | | |
|-----------------------------------|---|---|
| Product Name | LCD Monitor | |
| Product model | C32C1S | |
| Screen Size | 31.5" | |
| Aspect Ratio | 16:9 | |
| Viewing Angle | 178°(H) / 178°(V) | |
| Pixel pitch | 0.091 (H) * 0.272(V) mm | |
| Contrast ratio | 3000:1(Typ) | |
| Colors | 16.7M | |
| Resolution | 2560x1440 | |
| Maximum refresh rate | 240Hz | |
| Power specifications | 100-240V~ 50/60Hz 2.0A The standard voltage and current may vary with countries, please refer to the label at the back of the product. | |
| Product Dimensions Normal base | Without base | 712.5 x 422.8 x 113.3mm |
| | With base | 712.5 x 505.6 x 226.5mm |
| Tilting angle | Forward titling: -5°±2° ;Backward tilting : 15°±2° | |
| Rotation angle | NA | |
| Height angle | NA | |
| Pivot angle | NA | |
| Environmental conditions | Action | Temperature: 0°C~ 40°C (32°F ~ 104°F) Humidity: 10%~90% RH (non-condensing) |
| | Storage | Temperature: -20°~ 60° (-4°F ~ 140°F) Humidity: 5%~95% RH (non-condensing) |



The terms HDMI and HDMI High-Definition Multimedia Interface, and the HDMI Logo are trademarks or registered trademarks of HDMI Licensing Administrator, Inc. in the United States and other countries.



"This device complies with Part 15 of the FCC rules. Operation is subject to the following two conditions:
(1) this device may not cause harmful interference, and
(2) this device must accept any interference received, including interference that may cause undesired operation."