

ELECTRONIC TOILET

Instructions

Table of contents

Specifications	1
Cautions and Warnings	2
Part List	6
Control Description	7
Installation Instructions	8
Confirmation before use	9
Battery Installation	9
Packing List.....	10
Maintenance and Cleaning	11
Troubleshooting.....	12

Specifications

Technical Specification

Product Name	ELECTRONIC TOILET	Heated Seat Temp.	4 levels (Room Temperature- 104°F)
Rated Voltage	110-120V~	Environment Temp.	41-104°F
Rated Frequency	60Hz	Waterproof Level	IPX4
Rated Power	41W	Flush volume	1.28gpm(4.8Lpm)
Supply Water Pressure	26-73 PSI (0.18MPa-0.5MPa)		
Minimum Water Pressure	26PSI, and the minimum water flow should be 5.3gpm		
Codes/ Standards	ASME A112.19.2-2018/CSA B45.1-18 ASME A112.4.2-2021/CSA B45.16:21		

- Max temperature of the water supplied by the product for hygiene: 107°F
- There will be no further notice if any technical specification changed due to product improvement and technical update, all real technical specification should be subject to the final product.

CAUTIONS AND WARNINGS

This appliance is not intended for use by persons (including children) with reduced physical, sensory or mental capabilities, or lack of experience and knowledge, unless they have been given supervision or instruction concerning use of the appliance by a person responsible for their safety.



SAVE THESE INSTRUCTIONS

Please read this statement completely and correctly use it.
Please strictly comply with written cautions and warnings.





- Meaning of the Marks:

⊘DON'T: This symbol indicates a prohibited use of the product.





ⓘMUST: This symbol is used to indicate a required step in the use of this product.

 Don' t disassemble	<p>Never disassemble, repair or alter. Do not use tools in places other than designated.</p> <ul style="list-style-type: none"> ● Doing so may cause fire, electrical shock, overheating, short circuit or breakdown.
 Don' t splash water	<p>Do not get any water or cleaning solution on the main unit or connection of power cord.</p> <ul style="list-style-type: none"> ● Doing so may cause fire, electrical shock, heat or short circuit. ● Doing so may cause the product to crack resulting in injury or water damage.
 DON' T	<p>Do not use the product if a malfunction occurs.</p> <ul style="list-style-type: none"> ● In case of breakdown or other problems, be sure to cut off power by flipping the power switch to OFF. Close the water shutoff valve to stop water supply. <p>Possible malfunctions:</p> <ul style="list-style-type: none"> -Water is leaking from a pipe or the main unit. -The product is cracked or broken. -The product makes a strange noise or emits a strange odor. -The product emits smoke. -The product is abnormally hot. -The toilet seat cushion is out of place. - Continued use after malfunction could cause a fire, electric shock, heat, short circuit, injury or water damage. <ul style="list-style-type: none"> ● Continued use after malfunction could cause a fire, electric shock, heat, short circuit, injury or water damage. Please contact to the professionals. ● The recommended service life of smart toilet is 7 years. Please pay attention to the toilet working conditions after 7 years <p>Use tap water only Doing so may cause irritation to the skin and malfunction.</p>

CAUTIONS AND WARNINGS

 STOP	Do not use a loose and unstable power socket. Doing so may cause fire or electrical shock.
	Please insert the power plug into the AC 110V to 60Hz and 15A or above socket. Failure to do so may result in fire or electric shock. When the power exceeds the socket specification, it will cause the socket to heat and cause a fire.
	Do not do anything that may damage the power plug. Do not strike, yank, twist, excessively bend, damage, alter, or heat the power cords. Also, do not place anything heavy on, bind or pinch the power cords. <ul style="list-style-type: none"> Using a damaged power cord may result in a fire, electrical shock, heat or short.
 MUST	This is an electrical product. Do not install it anywhere water is likely to get on the product or anywhere with humidity high enough that water is likely to form on the surface of this product. When using the product in a bathroom, install a fan or ventilation port and ensure good air flow through the bathroom. <ul style="list-style-type: none"> Failure to do so may cause fire or electrical shock. If the power cord is damaged, avoid danger by having the manufacturer's repair department or equivalent specialist replace it.
	If the supply cord is damaged, it must be replaced by the manufacturer, its service agent or similarly qualified persons in order to avoid a hazard.
	Children being supervised not to play with the appliance. the appliance is not to be used by persons (including children) with reduced physical, sensory or mental capabilities, or lack of experience and knowledge, unless they have been given supervision or instruction. To prevent from low-temperature burns, please do not sitting on the toilet for a long time.
 Ground wire	This appliance must be earthed. Connect this product to a properly grounded the power supply unit (device) only. <ul style="list-style-type: none"> if not connect well may cause electric shock.
 Must obey	<ul style="list-style-type: none"> Do not raise the toilet seat or lid while objects are resting on top of the unit. Doing so may cause the main unit to come loose and fall, resulting in injury. Do not lean on cover when use this device to prevent product from damage.

CAUTIONS AND WARNINGS

 NO Fire	Keep cigarettes and other open flames away from the product. <ul style="list-style-type: none"> Failure to do so may cause fire.
 Stop	Do not apply strong force, mechanical shock, step on or stand on the toilet seat, toilet lid or main unit. Also do not place any heavy object on the toilet seat, toilet lid or main unit. <ul style="list-style-type: none"> Doing so may cause cracking or cause the main unit to come loose and fall, resulting in injury. Doing so may damage the product and cause injury or water damage.
	Never block the warm air openings of the product by human finger or others. Keep the warm air opening free, otherwise may cause electric shock, personal injury or the damage of product.
 Must obey	Do not fold or crush the water supply hose; do not damage by cutting with a sharp object. <ul style="list-style-type: none"> Doing so may cause water leaks. When maintaining the plastic parts (main unit etc.) or the water supply hose, use a neutral kitchen detergent diluted with water. Do not use any of the following. Toilet cleaner, household cleaner, benzene, paint thinner, powdered cleanser or nylon scrubbing brush. <ul style="list-style-type: none"> These items may damage or crack the plastic and cause injury or malfunction. These items could damage the water supply hose and cause a water leak. To prevent a sudden water leak, do not remove the water filter drain valve when the shutoff valve is open. <ul style="list-style-type: none"> Doing so will cause water to spurt out.
	When installing the water filter drain valve, make sure that it is securely tightened in its proper position. <ul style="list-style-type: none"> Failure to securely tighten it may cause a water leak.
	If a water leak should occur, always close the shutoff valve.
 Must obey	When the ambient temperature is likely to drop to 0°C or lower, prevent damage to the pipes and hoses due to freezing. <ul style="list-style-type: none"> Frozen water pipes could cause the main unit and the pipes to break, resulting in a water leak. Regulate the room temperature to prevent the pipes and hoses from freezing during cold months. Drain the water.

CAUTIONS AND WARNINGS

<p style="text-align: center;">!</p> <p style="text-align: center;">Must obey</p>	<ul style="list-style-type: none"> • Do not expose to direct sunlight. Doing so may cause changes in color or the product malfunction. • Do not urinate on the main unit, toilet seat or wand. Doing so may cause a failure or discoloration. • Loose the connection of power cord during thunderstorms. • When not using the product for a long time, close the shutoff valve, and then turn off the power of the product.
<p style="text-align: center;">!</p> <p style="text-align: center;">Must obey</p>	<ul style="list-style-type: none"> • The requirement of water pressure should be 0.14MPa-0.5MPa • Use a water supply hose wich is equipped by the product, old water supply hose can not be used again.
<p style="text-align: center;">!</p> <p style="text-align: center;">Must obey</p>	<ul style="list-style-type: none"> • During the daily use of the remote control, keep it away from water to prevent water goes inside of the remote control And please put it back on the holder after every use. • When the product is used for a long time, change the batteries of the remote control.

Part List

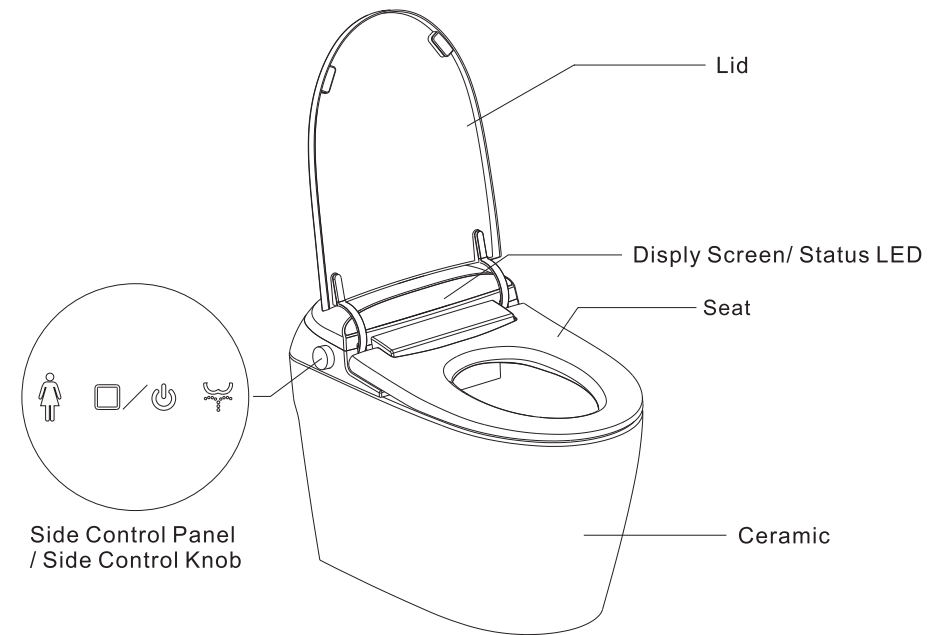

Note: Sketches in above is for reference only, specific appearance shall be subject to the actual object.

Control Description

Side Control Panel Style:

There are 2 functions of the side control knob: [Flush], [Seat temperature adjustment].

- Short press the "Flush" button to activate the flushing function.
- Short press the "Seat Temperature" button to adjust the seat ring temperature.
- Press and hold the 'Seat Temperature' button for 5 seconds to turn on or off the night light.
- When no one is seated, press and hold the "flush" button for 5 seconds to turn on or off the wall wetting function.

Flush water

1. Off Seat Flushing

When the human body is seated for 10 seconds, it will automatically undergo a flush after leaving the seat.

2. Foot feel flushing (this function is only applicable to foot feel flushing toilets)

Reach your foot within about 10cm of the sensing area, and the sensation of the foot will initiate flushing.

3. Kick flush (this function is only applicable to kick flush toilets)

Simply touch the kick switch with your toes to achieve flushing function.

Installation instruction

Preparation before installation

Tools prepared by user: Monkey Spanner, Teflon Tape, Glass Cement Gun, Glass Cement, Tapeline.

Parts included in the package: flange ring, water shutoff valve (Please use the parts included in the package, otherwise may cause product malfunction).

Installation method

1. Install the water supply hose (as the following picture).
2. Install flange on the ceramic base sewage outlet. Then align the ceramic which equipped with flange to the water drain pipe
3. Install the ceramic correctly to the ground, and use glass cement gun to fix. The solidification time of the glass cement is about 24 hours.
4. Install the shutoff valve (Before installing appliances, be sure to completely wash out any dirt, sand, etc. from inside the water supply pipe)
5. Connect water supply hose with the shutoff valve.
6. Leakage protection plug should be well connected on the wall power socket.
7. Please make sure there is no water leakage in any part of the connection. The power supply function well and the glass cement totally solidification. Then open the shutoff valve and the power button to start using this product.

Notes: Please make sure product is installed by the professionals.

And carefully check if every part is well installed.

Only the water pipes of DN15 approved with valid WaterMark can be used following local plumbing code.

Installation of components

Unit: mm

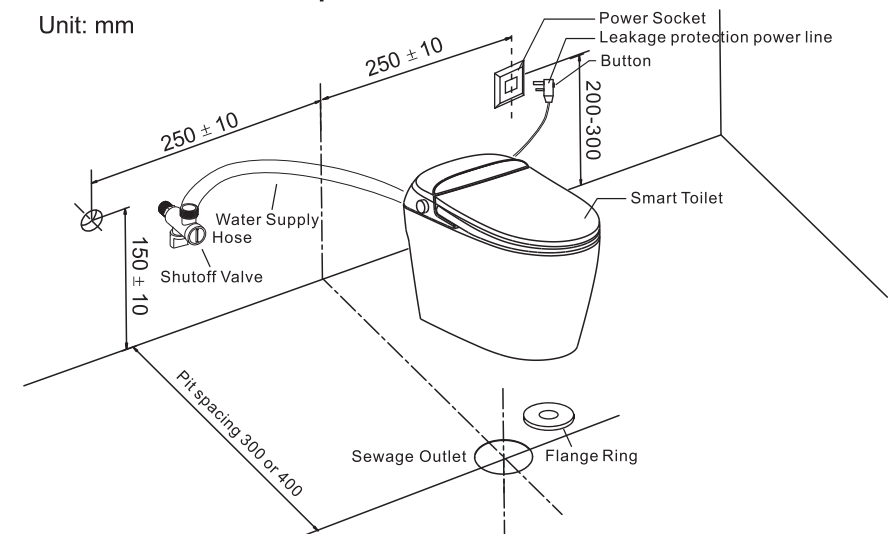

Battery Installation

Battery replacement method (only for external battery box toilet bowl)

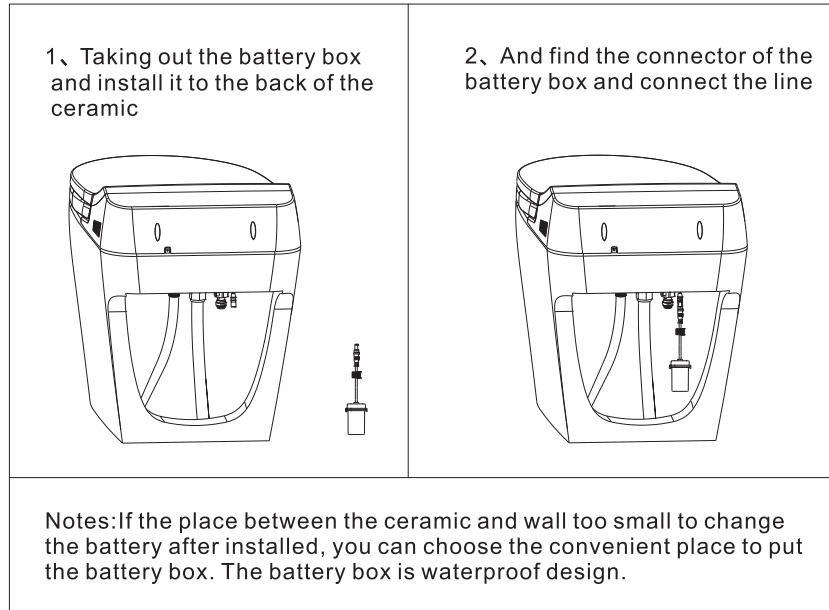

Note: The draft diagram is only used for refer, and the specific appearance is based on the physical object.

Confirmation before use/Packing list

turn on electricity

Insert the power plug into the socket.

Connect to the water source

Open the angle valve to ensure smooth water flow.

Confirmation of indicator light information

- Confirm whether the power indicator light of the toilet is on. If it is not, press the leakage protection plug button to turn on the power.
- Confirm whether the seat heating indicator light is on. If not, adjust the "seat temperature" button to turn on seat heating.

If water pressure lower than 0.15MPa, best add a booster pump.

NO.	Name	Quantity	Remark
1	Smart Toilet	1	
2	Water Shutoff Valve	1	
3	Flange Ring	1	
4	Instruction	1	

- There will be no further notice if any change due to product improvement and technical update. The company reserves the right of final interpretation.

Maintenance and Cleaning

To prevent product damage, please do as following:

- Always test your cleaning solution on an inconspicuous area before applying to the entire surface.
- Wipe surfaces clean and rinse completely with water immediately after applying cleaner. Rinse and dry any over spray that lands on nearby surfaces.
- Do not allow cleaners to soak on surfaces.
- Use a soft, dampened sponge or cloth. Never use an abrasive material such as a brush or scouring pad to clean surfaces.

Clean the filter(When the flushing system doesn't function well)

- 1、 Close water shutoff valve to stop the water supply.
- 2、 Remove the filter by coin.
- 3、 Clean the filter:
 - To clean the filter by running water after disassemble it.
 - To remove any residue by toothbrush.
- 4、 Install the filter back:
 - Tightly assemble the filter, and open the water shutoff valve to check if any leakage.
- 5、 Open the water shutoff valve to work.

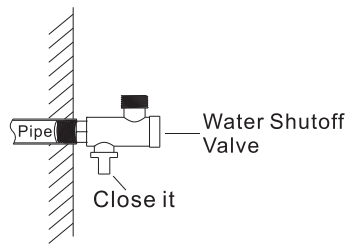

1. Close the water shutoff valve

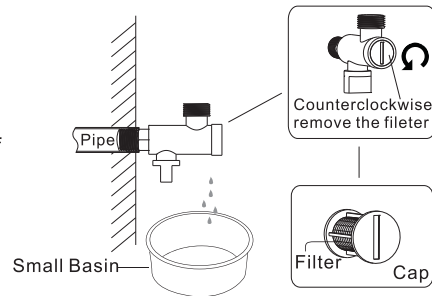

2. Gently remove the filter

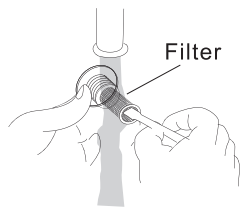

3. Clean the dirty

Troubleshooting

Use following way to check the abnormal status, if it still does not work, please call professionals

fault	Fault cause	resolvent
No temperature on the seat ring	Seat temperature not set at appropriate temperature	Press the seat temperature key to adjust to the appropriate temperature
Not working at all	The power is not turned on	Please turn on the power
	The power plug is not properly plugged in power failure	Please reinsert the power plug Recheck after restoring power supply
Seat temperature indicator light flashing	Unplug the power plug and reconnect the power supply. If the fault persists, please cut off the power supply, Contact the manufacturer's designated maintenance department	
Body leakage	Close the corner valve to stop water supply, check if the water supply pipeline is damaged, and contact the manufacturer Designated Maintenance Department	