

***GARAGE  
SMART***

# ***POWER ADAPTER***

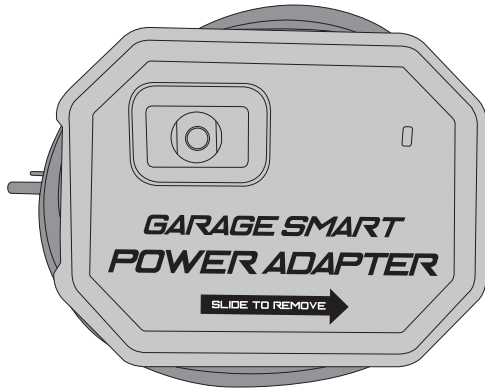

## **User Manual**

Please save this manual for future reference.

For a digital version of this manual, visit:

[www.garagesmart.com/manuals](http://www.garagesmart.com/manuals)





---

# TABLE OF CONTENTS

SAFETY INFORMATION	2
ABOUT THE POWER ADAPTER	4
PARTS IDENTIFIER	5
INSTALLATION	
1. WALL INSTALLATION	6
2. TRACK INSTALLATION	8
3. WIRE MANAGEMENT	9
4. POWER ADAPTER	10
TROUBLESHOOTING	12
LIMITED WARRANTY	13
SCREW TEMPLATE	15

# SAFETY INFORMATION

- For indoor use only.
- For use with information technology equipment.
- DO NOT open product case to avoid risk of electrical shock.



## CAUTION

To reduce the risk of electric shock or injury, use indoors only.

### FCC STATEMENT:

This device complies with Part 15 of the FCC Rules. Operation is subject to the following two conditions: 1. This device may not cause harmful interference, and 2. This device must accept any interference received, including interference that may cause undesired operation.

**Warning:** Changes or modifications not expressly approved by the party responsible for compliance could void the user's authority to operate the equipment.

**NOTE:** This equipment has been tested and found to comply with the limits for a Class B digital device, pursuant to Part 15 of the FCC Rules. These limits are designed to provide reasonable protection against harmful interference in a residential installation. This equipment generates uses and can radiate radio frequency energy and, if not installed and used in accordance with the instructions, may cause harmful interference to radio communications. However, there is no guarantee that interference will not occur in a particular installation. If this equipment does cause harmful interference to radio or television reception, which can be determined by turning the equipment off and on, the user is encouraged to try to correct the interference by one or more of the following measures:

- Reorient or relocate the receiving antenna.
- Increase the separation between the equipment and receiver.
- Connect the equipment into an outlet on a circuit different from that to which the receiver is connected.
- Consult the dealer or an experienced radio/TV technician for help.

---



## ABOUT THE POWER ADAPTER

The Power Adapter must be used to provide power to all DC powered Garage Smart products. AC power may also be passed through the Power Adapter to power additional AC powered Garage Smart products.

Model: TPZ-1400500

Input: 100-120VAC 50/60Hz 12A Max

AC Output: 100-120VAC 50/60Hz 10A Max

DC Output: 14V  5.0A   

Made in China, Shenzhen Top Power Co., LTD.

## PARTS IDENTIFIER

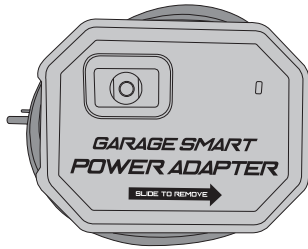

Power Adapter (x1)

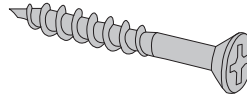

Wall Mount Screw (x2)

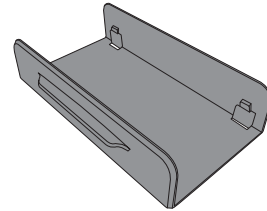

Universal Mount (x1)  
(attached to power adapter)

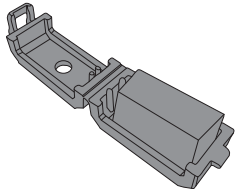

Cable Management Clip (x4)

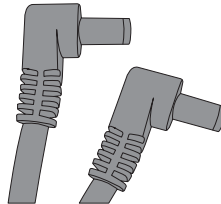

DC Power Cable (x1)

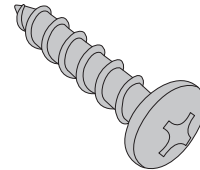

Cable Management Screw (x4)



# INSTALLATION

1. Find a suitable location to mount the power adapter to the wall. Confirm that the AC cable will reach a power outlet, and the DC cable will reach your Garage Smart product(s).

2. Screw the two wall mount screws into the chosen location exactly 2 inches apart (50.8 mm). Leave the screw heads about 1/4" (6.35 mm) away from the wall. Use the template on page 15 of this manual.

## WALL MOUNT

### ! NOTE

It is best to mount this product into a stud, but with caution, placing the screws into drywall is sufficient.

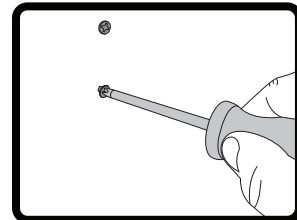
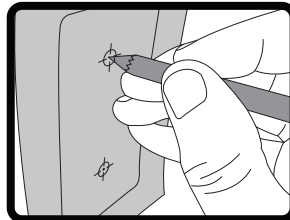

7

## INSTALLATION

## WALL MOUNT

3. Line up the product mounting holes with the screws as shown. Slip the product over the screws and slide downwards to lock into place.

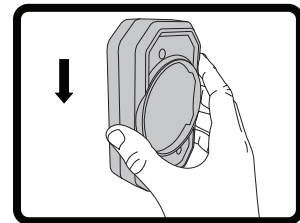
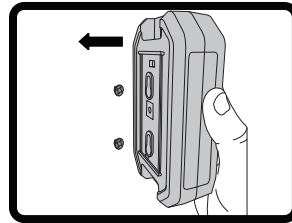

### NOTE

The power adapter may be removed and the screws tightened for a tighter fit.



### NOTE

The Universal Mount is not used for wall mounting.

# INSTALLATION

## TRACK MOUNT

1. Clip the connector onto track.  
The nubs should snap into place.

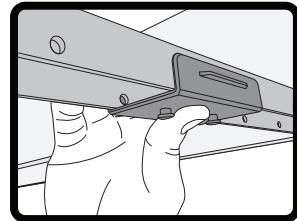
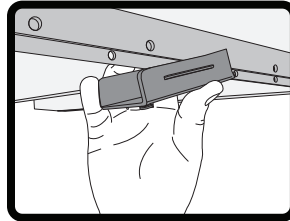

2. Align the pins with the holes in the product.  
Press on and slide to lock in place.

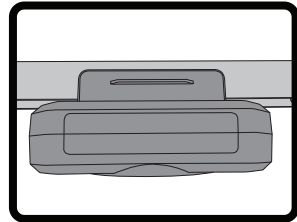
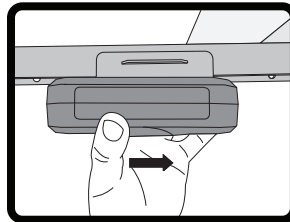
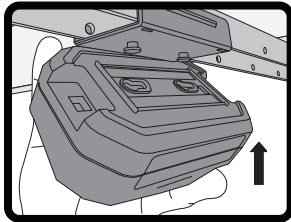

# INSTALLATION

# WIRE MANAGEMENT

1. Peel off sticker backing.



2. Stick the clip where you want it.

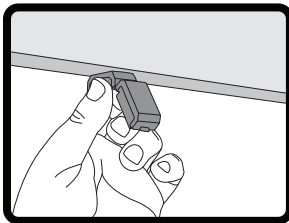

3. Install screw through the hole in the center.

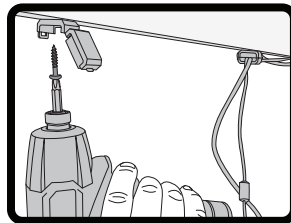

4. Place all wires into the clip. 5. Securely close the clip.

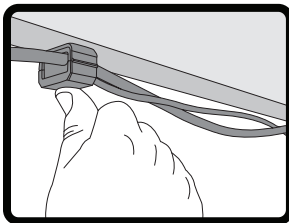
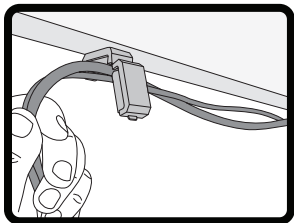

## ! NOTE

Clip can hold both AC and DC cables.

Screw can be placed in either drywall or a stud.

# INSTALLATION

1. Plug the AC cable into a power source. This may be a previously installed AC Garage Smart product, or an AC outlet.

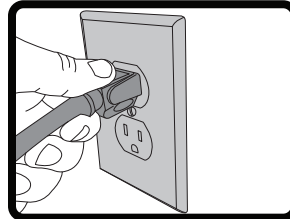

2. The LED on the Power Adapter will glow when powered on.

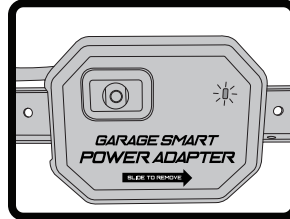

3. Additional AC Garage Smart products may be powered by connecting their AC cable to the AC outlet on the Power Adapter.

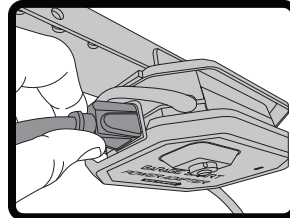

# INSTALLATION

4. DC Garage Smart products may be powered by connecting a DC cable to the DC port on the Power Adapter.

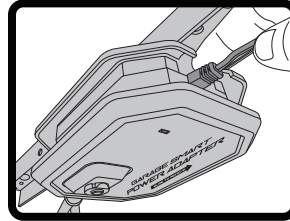

5. Organize the cables by winding excess around the Power Adapter housing.

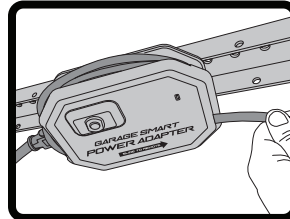

6. Use track covers to support and organize cables.

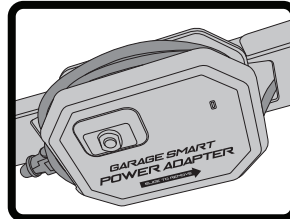

# TROUBLESHOOTING

**1. The AC Garage Smart products do not have power:** If too many Garage Smart products are receiving power through a single Power Adapter, the on-board breaker will trip, powering down all AC Garage Smart products plugged into the Power Adapter. Remove one or more AC Garage Smart products and reset the breaker by pressing the reset button.

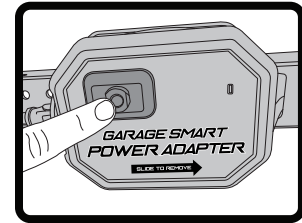

**2. All AC and DC Garage Smart products do not have power:** If no Garage Smart products have power, the main breaker for the outlet may have been tripped. If so, remove an AC Garage Smart product from that circuit and reset the breaker.

**3. The DC Garage Smart products do not have power:** If too many DC Garage Smart products are receiving power through a single Power Adapter, the Power Adapter will shut down. Remove DC Garage Smart products from that line until power is restored. If additional DC Garage Smart products need power, add a Power Adapter for these products.

---

# LIMITED WARRANTY

## Limited Three-Year Warranty on Hardware

Garage Smart offers a limited three-year warranty on the hardware components of its lifting systems. If a defect in the hardware, or any component thereof, appears at any time during the first three years after purchase, Garage Smart will repair or replace (at its option) the system or the defective component at no cost to you beyond the cost of shipping the defective item to us.

## Who Makes This Warranty

This warranty is made by

Garage Smart

P.O. Box 50180

Provo, UT 84605

## Who Is Covered

This warranty extends only to the original purchaser of the product. This warranty is intended for natural persons only and does not extend to any corporation, limited liability company, or commercial entity.

## What Is Covered

The limited three-year warranty on hardware covers manufacturing defects and includes parts, labor, and the cost of shipping the repaired (or replacement) product from Garage Smart to you. The warranty does not cover installation of repaired or replacement items. If we send replacement parts, we may use new or reconditioned parts. If we send a replacement unit, we may use a new or reconditioned unit.



### **Where and How to Obtain Warranty Service**

You can obtain warranty service from Garage Smart at the address indicated below. It is your responsibility to deliver or ship the defective product to us at your expense, together with a copy of your receipt showing date of purchase and a description of the claimed defect, prior to the expiration of the warranty period. To obtain information regarding this warranty, you may contact us by mail, e-mail, or phone.

Garage Smart

3000 S Vista Way

Provo, UT 84606

Support@GarageSmart.com

### **Exceptions and Exclusions**

This warranty does not include damage or defects resulting from misuse, accident, failure to maintain, or any other causes following your purchase of the product.

Use of the Lifter system with any other system or components ( including affixing non Garage Smart attachments or accessories) voids this warranty. Failure to follow the owner's manual in installation or use of the Lifter system voids the warranty. Unauthorized repair or modification voids the warranty.

The Lifter system is intended for personal, indoor, home use. Garage Smart does not warrant its lift system for commercial use, and any such use voids the warranty.

TO THE GREATEST EXTENT PERMITTED BY LAW, THIS WARRANTY IS IN LIEU OF AND EXCLUDES ALL OTHER WARRANTIES NOT EXPRESSLY SET FORTH HEREIN, WHETHER EXPRESS OR IMPLIED, INCLUDING BUT NOT LIMITED TO ANY WARRANTIES OF MERCHANTABILITY AND FITNESS FOR A PARTICULAR PURPOSE.



# SCREW TEMPLATE

