

Golf Cart Cup Holder

We are striving to build a reliable brand of golf carts parts and accessories.

Hope this manual can assist you to easier install.

For more technical support, please reach us via

Website : www.10101.com

Email : sale_service@10101.com

Facebook : zhong zaiyang

Youtube : 10L0L

Contents	Qty	Installation Tools	Qty
Plastic Main Bracket.....	1	2.8 mm Hex Wrench.....	1
Aluminum Alloy Fixation Bracket.....	1	3.7 mm Hex Wrench.....	1
Aluminum Alloy Connector.....	1		
Anti-friction Plastic Shim	2		
Hex Wrench.....	2		
Screw.....	5		

See Figure 1



Installation Tools

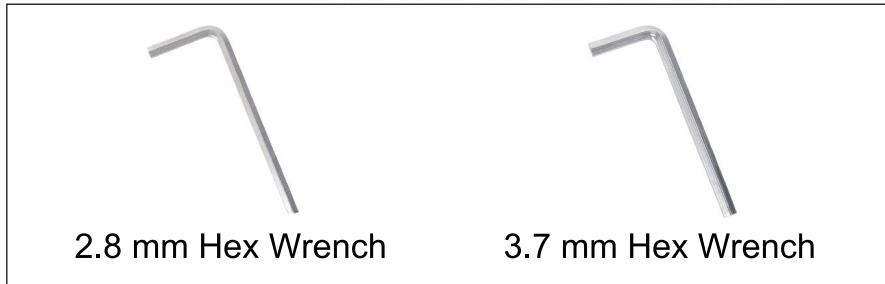

Installation Steps

1. Rotatable bracket can be adjusted along with installation position.

See figure 1

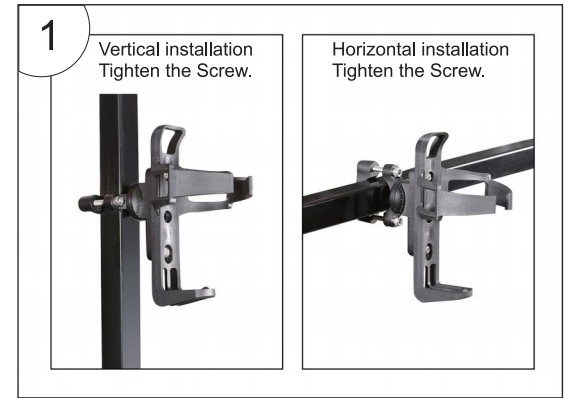

2. Adjust the bracket position that connecting the cup.

See figure 2



3. Tighten the 34.4mm screw with the 3.7mm diameter hex wrench.

See figure 3



4. Adjust the bracket position that connecting the cup.

See figure 4

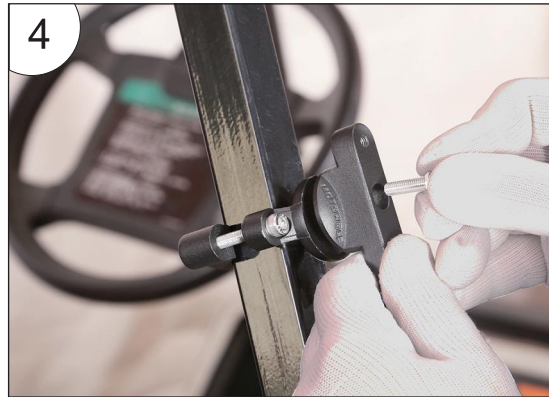

5. Tighten the 24.3mm screw of the aluminum alloy connector with the 3.7mm diameter hex wrench.

See figure 5



6. Tighten the 10.6mm screw of the plastic main bracket with the 2.8mm diameter hex wrench.

See figure 6

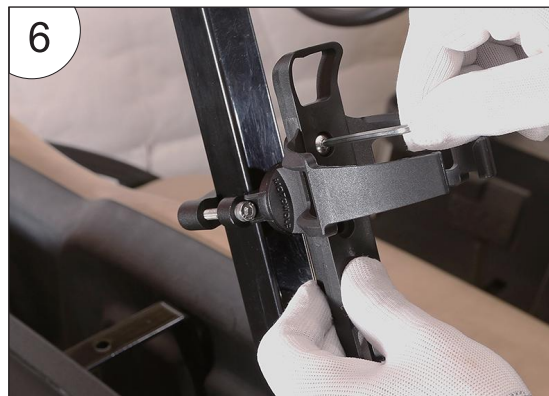

7. Installation completed.

See figure 7



8. Recommended installation position 1.

See figure 8



9. Recommended installation position 2.

See figure 9

