

Golf Cart Ball Washer Installation Diagram

We are striving to build a reliable brand of golf carts parts and accessories.

Hope this manual can assist you to easier install.

For more technical support, please reach us via

Website : www.10LOL.com

Email : sale_service@10LOL.com

Facebook : zhong zaiyang

Youtube : 10LOL

Contents	Qty	Installation Tools	Qty
Golf Ball Washer.....	1	Cross Screwdriver.....	1
Removable Base Bracket.....	2	Drill.....	1
Self-Tapping Screw.....	8	4-5 mm bit.....	1
Long Screw.....	4	Pen.....	1
Nut	8	5/16inch(8mm).....	1
Shim	8		
Base Bracket for Club Car Precedent....	1		
Hexagonal screw.....	4		

See Figure 1



Installation Tools



1. Select a suitable position.

See figure 1



2. Take out the two bases.
(Install Base A on the cart,
Install Base B on the ball
washer)

See figure 2

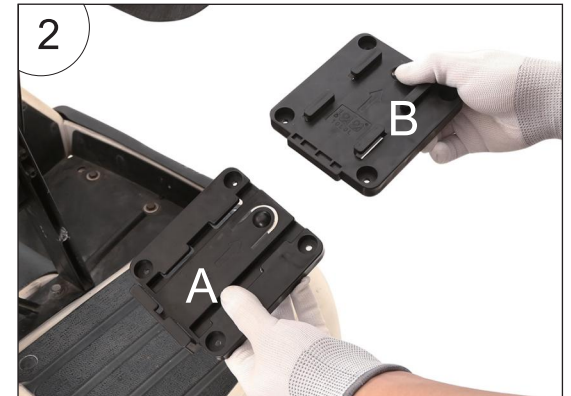

3. Make sure the same direction of
the two plastic snaps.

See figure 3

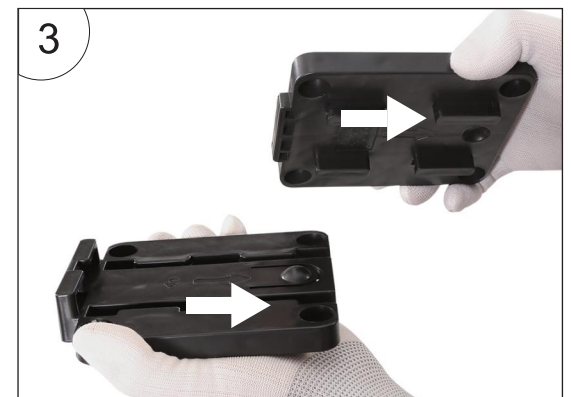

4. Align the plastic snaps, press down while pushing inside until heard a clicking sound.

See figure 4



Installation Method I of Base A

5. Screw base A onto the cart with self-tapping screws.

See figure 1



6. See figure.

See figure 6



1. Put the base A onto the installation position, and then mark the four points for drilling holes.

See figure 1

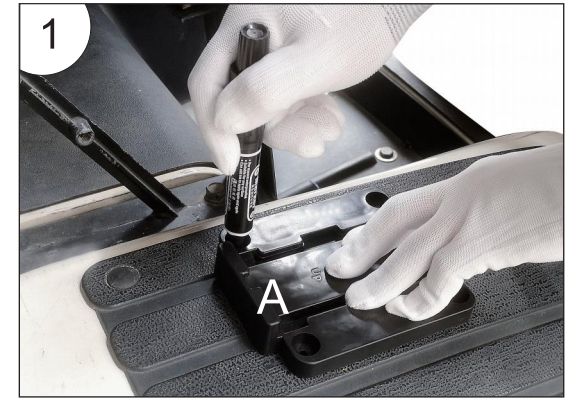

2. Drill with a 4mm-5.2mm bit for 3.7mm diameter screws.

See figure 2



3. Place on the nuts and tighten with the long screws by a cross screwdriver.

See figure 3



7. Screw Base B onto the ball washer.

See figure 7

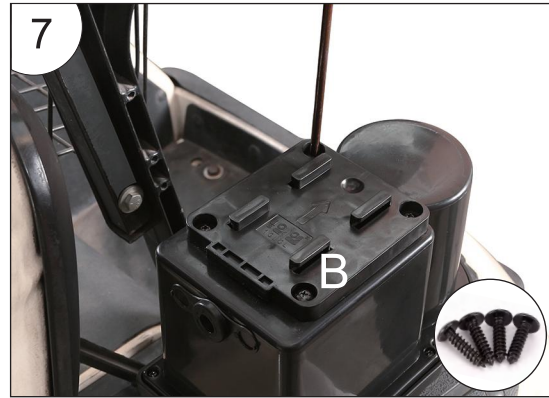

8. After installing the bases, align the plastic snaps, press down while pushing inside until heard a clicking sound.

See figure 8



9. Installation completed, see figure.

See figure 9



Recommended installation position.

1. Position 1

See figure 1



2. Position 2

See figure 2

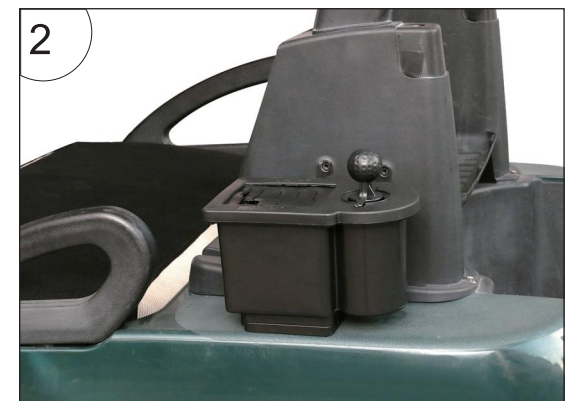

12. Position 3

See figure 3t



Special Base Bracket for Club Car Precedent Installation Instruction.

1. Install the bracket.

See figure 1



2. Tighten the base with
a screwdriver.

See figure 2



3. Complete the bracket
base installation.

See figure 3



4. Install the ball washer
to the seat back support.

See figure 4



5. Installation completed.

See figure 5

