

Instructions:

Golf Car Enclosures



⚠ WARNING

1. Make sure your enclosure is on properly and securely fastened before operating your golf car.
2. When your golf car is at idle with your enclosure installed, make sure to open a side door to ensure proper ventilation against carbon monoxide.
3. Enclosures do NOT protect against noise, engine exhaust, chemicals, collision, roll-over or other accidents.

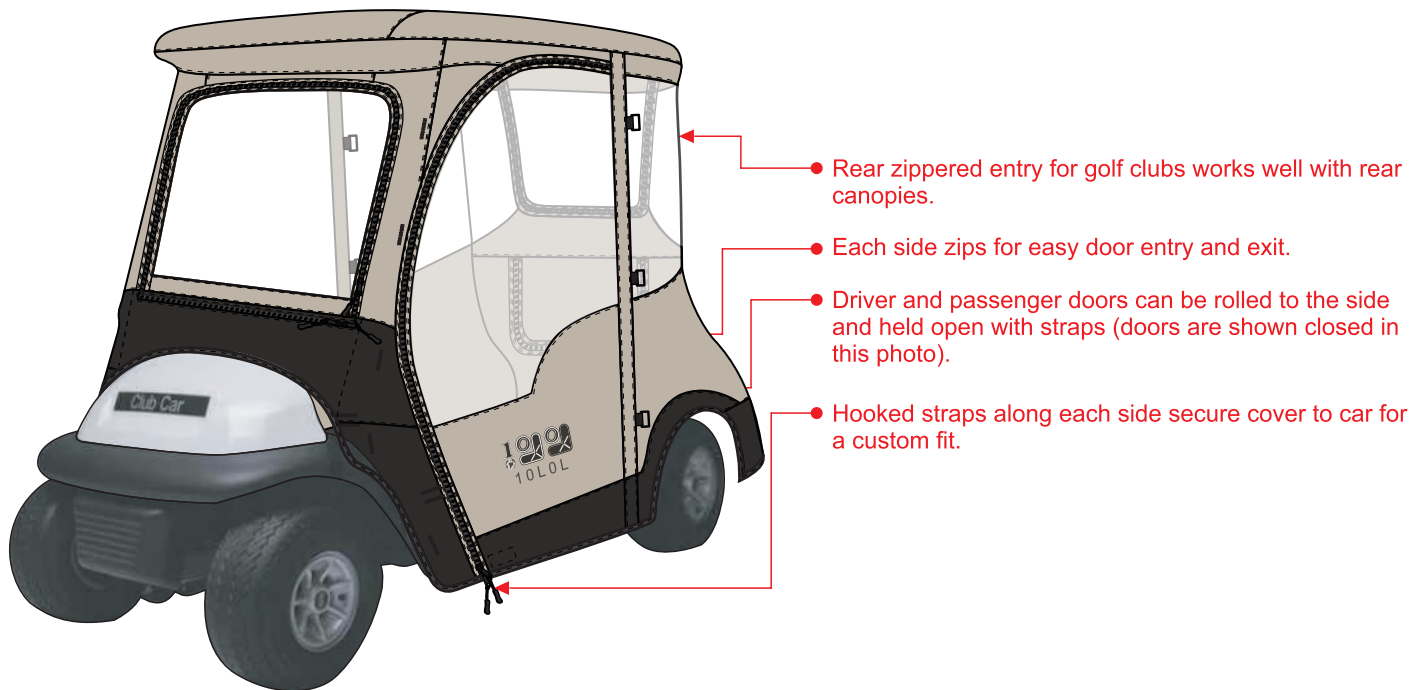

⚙ Installation

1. Identify the front of your Golf Car enclosure by locating the interior yellow tag which reads "FRONT". Drape the enclosure over the roof of your golf car with the zippered panel at the back.
2. Pull the cover from front to back onto the roof. Make sure the roof edges line up with the seams.
3. Zip the side and rear panels down over the car.
4. Attach the elastic hooked straps along the sides of the golf car. See figure 1
5. If your enclosure has removable doors (all but the travel enclosure), hold zipper and door and firmly pull horizontally apart as shown in figure 2.
6. There is a zippered opening in the back so you can easily load and unload your golf clubs. If your enclosure has a zippered rear panel it can be rolled all the way up to the roof and secured with rip-and-grip straps. Club Car Precedent® 2000-current models exclusively model specific enclosures can be secured at the halfway point as well.
7. If your enclosure has a removable windshield you can completely unzip the windshield. The Club Car Precedent® 2000-current models exclusively model specific enclosures have a front hideaway pocket where you can store your windshield when not in use. See figure 3.

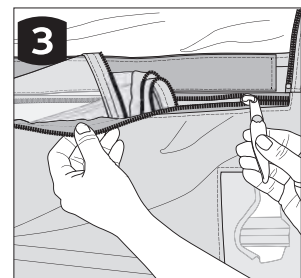
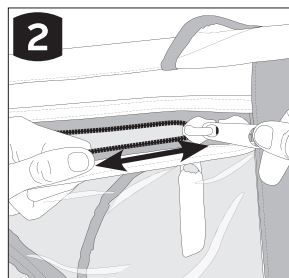
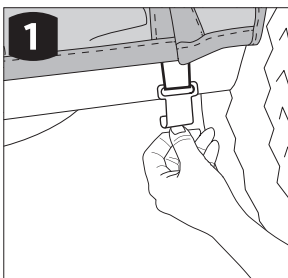

Storage

A handy storage bag is provided to store your enclosure in. To avoid mildew, be sure the enclosure is completely dry before you store it in the storage bag.



NO TOOLS
REQUIRED



LINE DRY



DO NOT
MACHINE
WASH



MILD SOAP
FOR
WINDOWS
ONLY



DO NOT
PACK WET

Cleaning

Clean your enclosure with a soft brush and lukewarm water. **DO NOT USE SOAP** as it may remove the protective coatings. Line dry.

Tip: If the clear vinyl windows on your cover are wrinkled from storage you can smooth them out with a hair dryer. Be sure to set the dryer on low and hold it at an appropriate distance.

Tip: Clean clear vinyl windows with mild soap using your hands or a soft cloth to avoid scratching the surface.

Repacking Instructions

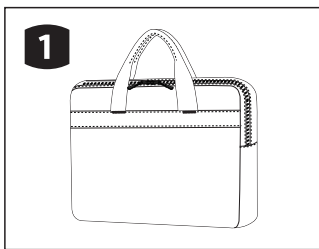

Zip the storage bag closed.

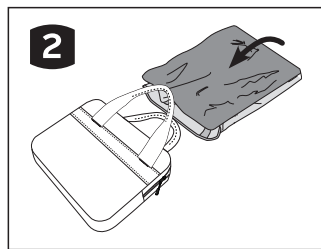

Insert enclosure into the bag as shown.

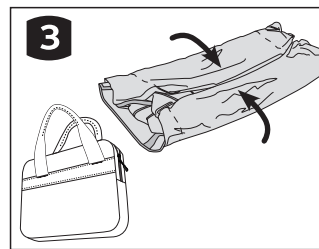

Fold the sides into the center to match the length of the bag.

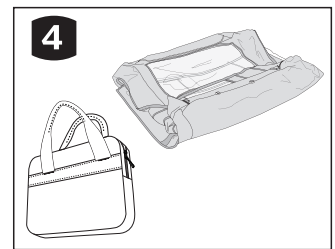

Lay bag next to the enclosure.

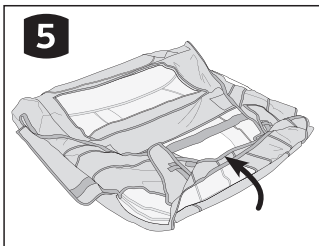

Tuck in any loose ends.

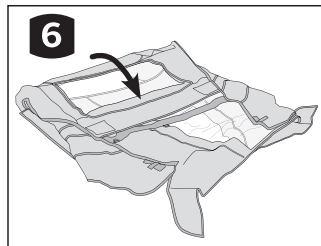

Fold the front panel into the center.

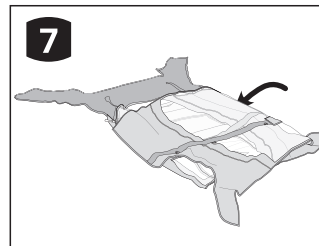

Fold the other side panel into the center.

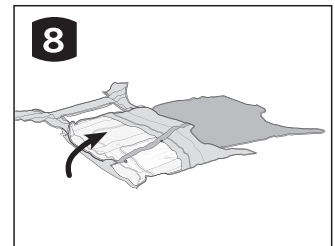

Fold one side panel into the center.

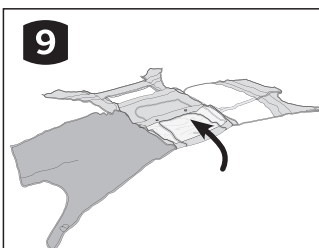

Fold rear panel in towards the center. Fold one side panel into the center.

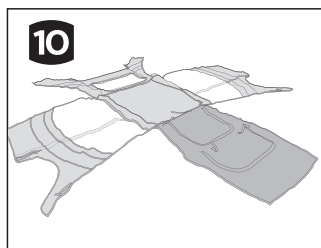

Start with enclosure layed out flat.

Note:

If you have any question about our 10L0L Golf Cart Cover, please contact us via

 Email: sale_service@10I0I.com

 Web: <https://www.10I0I.com>