

REV	DESCRIPTION	DATE	BY	APPROVED
A	PROTOTYPE	-	-	-
B	UPDATED ARMATURE ASSY TO PREVENT LAMINATION STACK MOVEMENT	12/11/18	SLC	-
C	REVISED ARMATURE ASSY TO PREVENT LAMINATION STACK MOVEMENT	1/18/19	SLC	-

24) MOTOR LEADS 13"±1" LONG  
 MEASURED FROM TOP OF STRAIN RELIEF  
 12 AWG TEFLON  
 (+) POSITIVE: RED  
 (-) NEGATIVE: BLACK  
 STRIP BACK LEADS 1"±.5"  
 TWIST LIKE COLORS TOGETHER  
 AND SOLDER ENDS

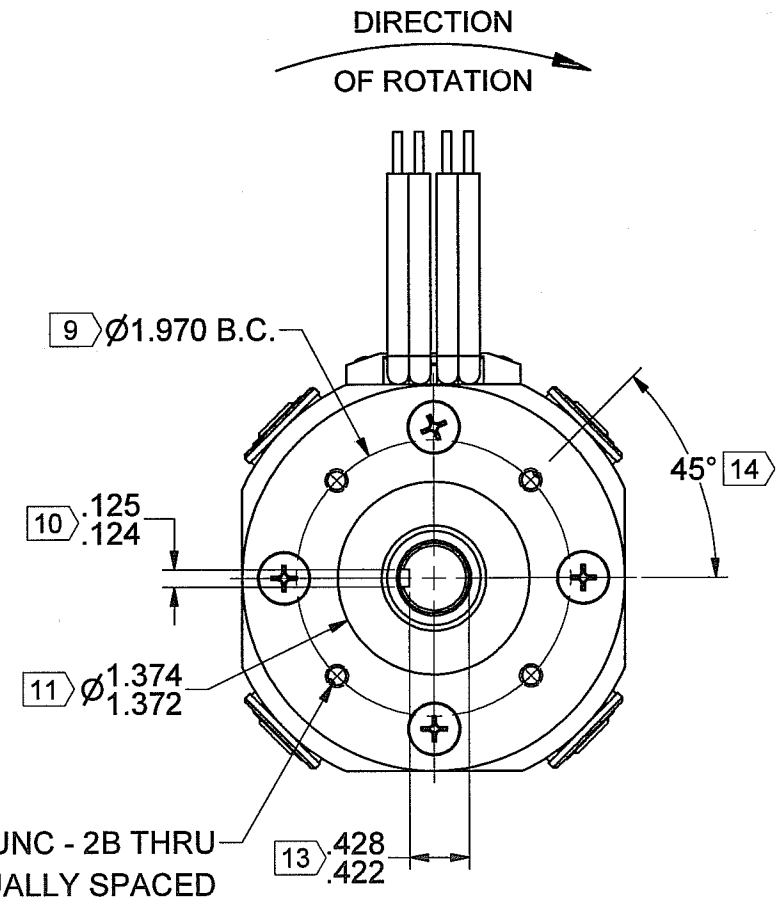
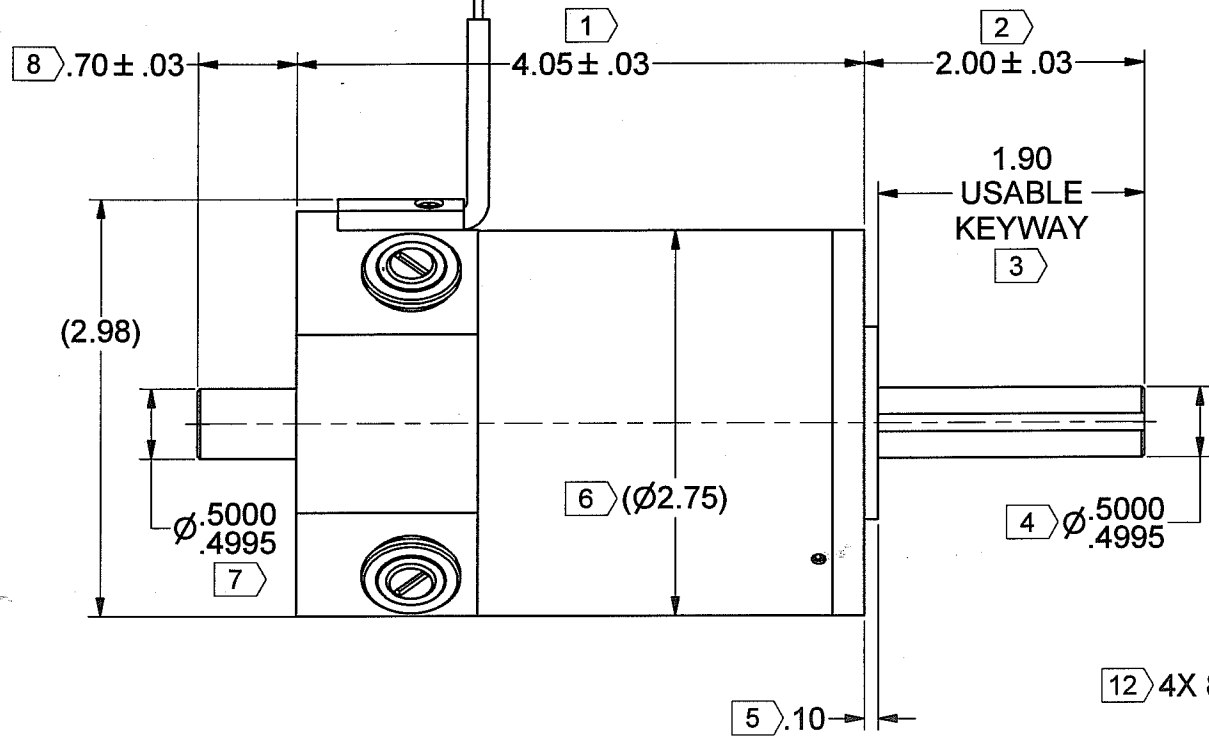
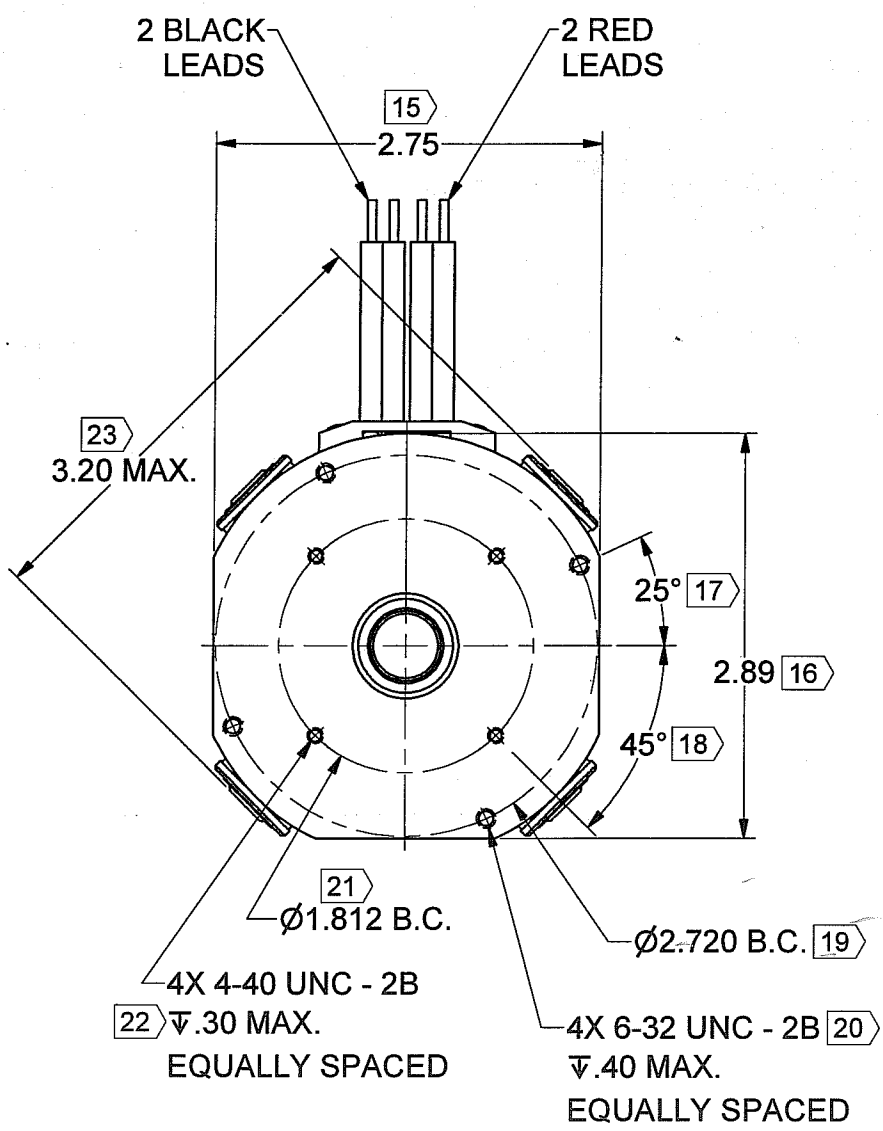

**MOTOR SPECIFICATIONS:**

TORQUE CONSTANT (Kt) = 5.41 ± 10% OZ-IN/AMP  
 VOLTAGE CONSTANT (Ke) = 4.00 ± 10% VOLTS/KRPM

**NOTES:**

- MOTOR ROTATION IS CLOCKWISE WHEN VIEWED FROM OUTPUT SHAFT WITH POSITIVE VOLTAGE APPLIED TO RED LEAD.
- RUNNING MOTOR WITH ONLY ONE BLACK AND ONE RED LEAD WILL DAMAGE MOTOR.
- SCREW PENETRATION NOT TO EXCEED SPECIFIED THREAD DEPTH.
- X IDENTIFIES INSPECTION DIMENSIONS.

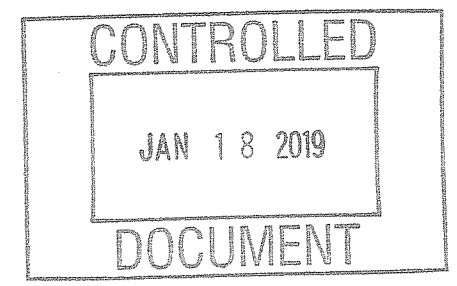

UNLESS OTHERWISE SPECIFIED DIMENSIONS ARE IN INCHES & [mm]		THIRD ANGLE PROJECTION DO NOT SCALE DRAWING		THE INFORMATION CONTAINED IN THIS DRAWING IS THE SOLE PROPERTY OF MAGMOTOR TECHNOLOGIES. ANY REPRODUCTION OR DISCLOSURE OF THE INFORMATION CONTAINED THEREIN IN PART OR AS A WHOLE WITHOUT THE WRITTEN PERMISSION FROM MAGMOTOR TECHNOLOGIES IS PROHIBITED.		<b>Magnmotor</b>	
TOLERANCES ON: ANGLES = ± 1/2° X.XX [X.X] = ± .01 [0.25] X.XXX [X.XX] = ± .005 [0.12]		SIGNATURES		DATE		TITLE	
MATERIAL		DRAWN SLC		8/31/2016		MOTOR ASSEMBLY, S28-F4-150X	
SPEC		CHECKED [Signature]		1/18/19		SIZE D NUMBER 500280444	
FINISH NONE		ENG APPR. [Signature]		1/18/19		REV C	
SPEC		MFG APPR. BT		1/18/19		SCALE: - WEIGHT: - LB. SHEET 1 OF 3	
		UNLESS OTHERWISE SPECIFIED REMOVE ALL BURRS & SHARP EDGES, COUNTERSINK TAPPED HOLES TO BODY SIZE FILLETS: .03 MAX. / EXTERNAL CORNERS: .015 MAX.					

Model	S28-F4-150X
Part Number	500280444
Nominal Voltage	24
Ke (V/Krpm)	4
Kt (oz-in/amp)	5.4
Resisitance (Ohms)	0.007
No Load Amps	4
RPM @ 24 Vdc	6100
Peak HP	3.5
Stall Torque (oz-in)	2000
Efficiency	88
Capacitors	Yes
Magnet Type	Neodymium
Weight (pounds)	3.5