

Assemble Instructions

Muzi Series

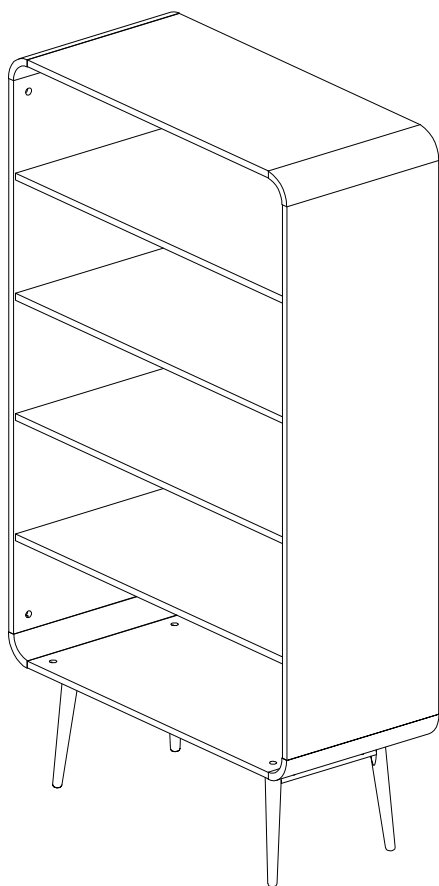

Lifely*

Product Code

MZI-DS1640-WOK

Muzi Display

Dimensions(W x D x H)

900*400*1600mm

Important

Please read through instructions carefully
Before assembly and keep for future reference.

For our full catalogue of assembly instructions,
Visit:lifely.com.au/assembly.

Important Tips and Maintenance

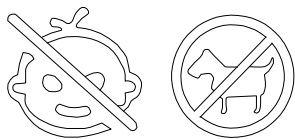

1. Keep children and animals away from working area as smaller parts may cause choking if swallowed



2. Never place liquids or anything damp upon furniture as it will mark. Ensure a coaster or running is beneath.



3. Never use ammonia based cleaning products as it will damage the finish.

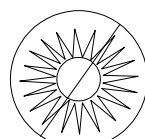

4. To avoid fading, keep furniture out of direct sunlight.



5. Use a soft or damp cloth (dry cloth) when wiping or cleaning surface.

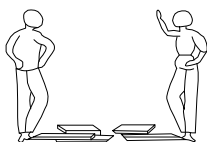

6. Two people are required

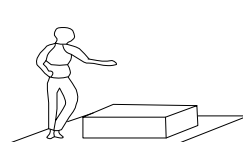

7. Lay a soft mat down to protect the furniture pieces before and during assembly.

So your relationship is strong. But is it flat-pack furniture strong? Unless you're an aerospace engineer, assembling furniture can be slightly stressful. We recommend meditating quietly, pouring yourself a herbal tea (or slightly less herbal wine) and tackling things one step at a time. If you feel a passive aggressive remark coming on, try a compliment instead. E.g. "You're so good looking".

This 16-Step assembly should take around 55 minutes with an Allen Key-or 40 minutes with an electric drill. Godspeed.

Designed for everyday

Components Hardware

Please check you have all the fittings
part or tools are listed in below.

No.A
Quantity:36Pcs
Dowel



No.B
Quantity:42Pcs
Cam Bolt



No.B
Quantity:42Pcs
Cam Nut



No.C
Quantity:3Pcs
Cam Bolt



No.C
Quantity:3Pcs
Cam Nut



No.D
Quantity:20Pcs
Screw M4*40mm

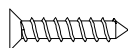

No.K
Quantity:2Pcs
Anti Collapse

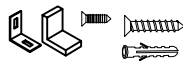

Components Panels & Part List

Please check you have all the panels are listed below.

1. Arc Edge	_____	x4	CTN 1/2	5. Bottom Panel	_____	x1	CTN 1/2
2. Legs	_____	x2	CTN 1/2	6. Side Panel	_____	x2	CTN 2/2
3. Brace Panel	_____	x2	CTN 1/2	7. Shelf Panel	_____	x4	CTN 1/2
4. Top Panel	_____	x1	CTN 1/2	8. Back Panel	_____	x2	CTN 2/2

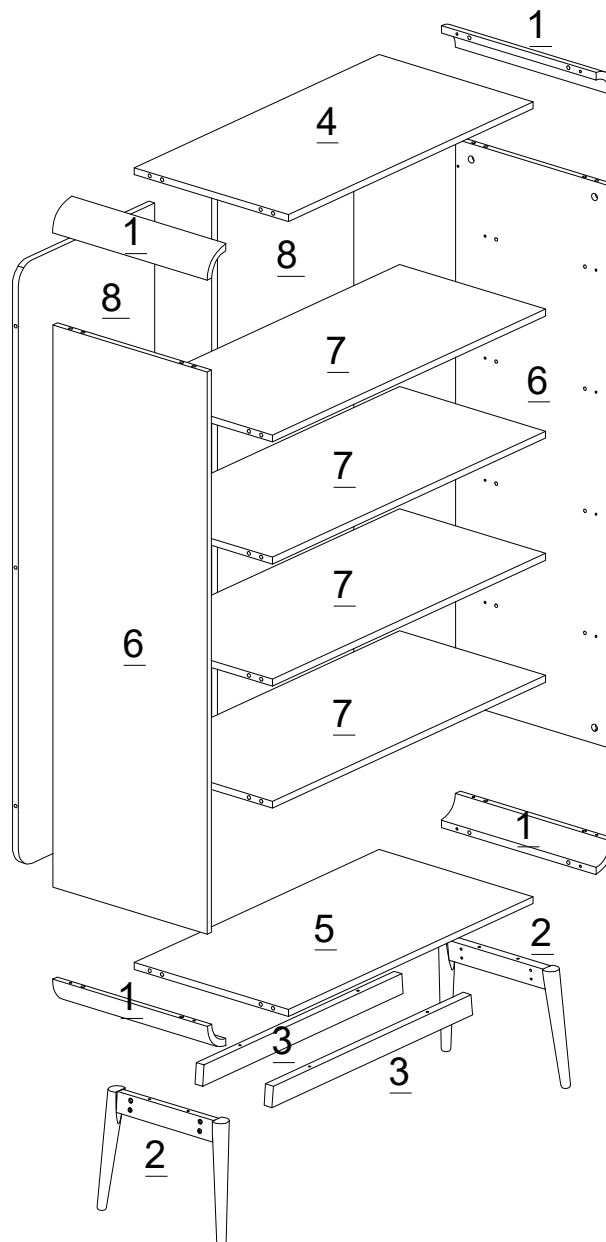

STEP 1

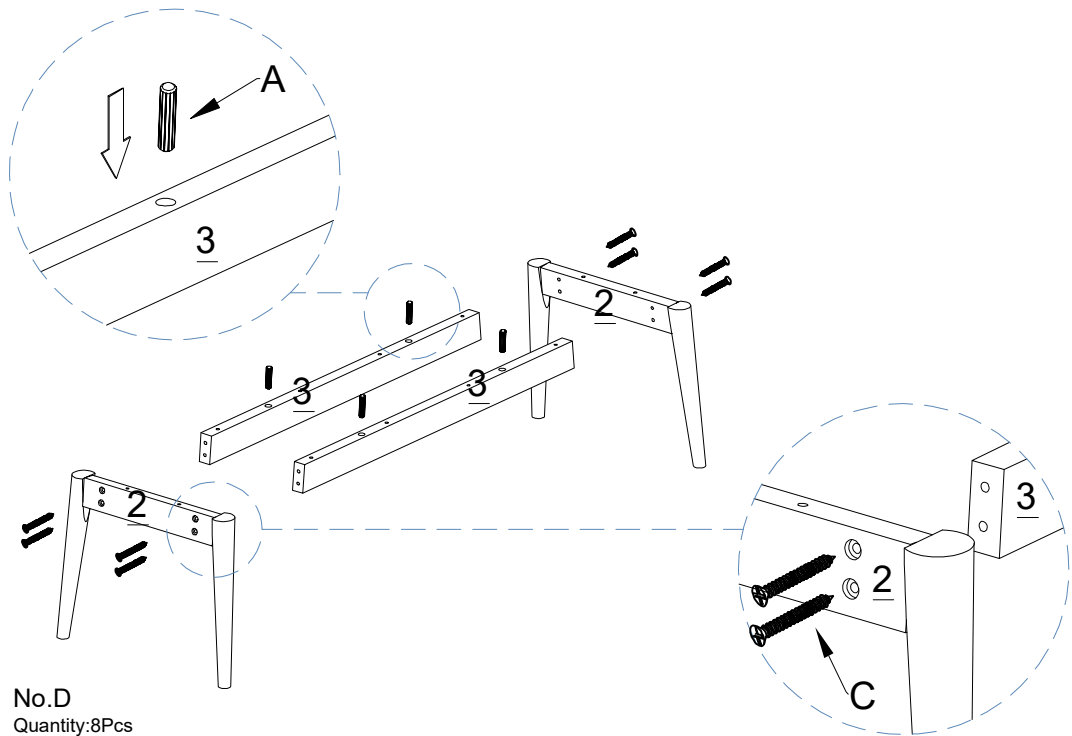

No.A
Quantity:4Pcs
Dowel



No.D
Quantity:8Pcs
Screw M4*40mm

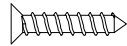

STEP 2

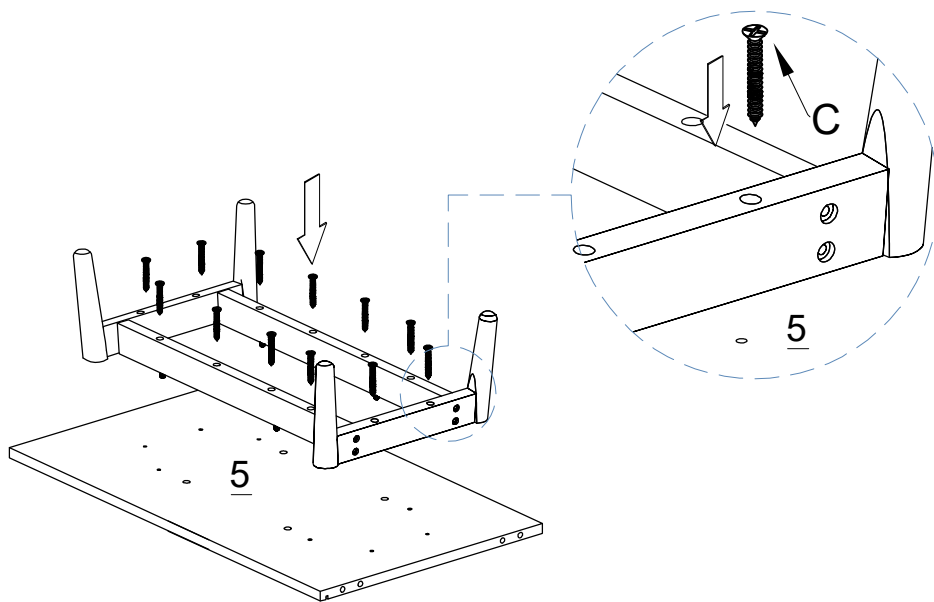

No.D
Quantity:8Pcs
Screw M4*40mm

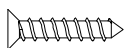

STEP 3

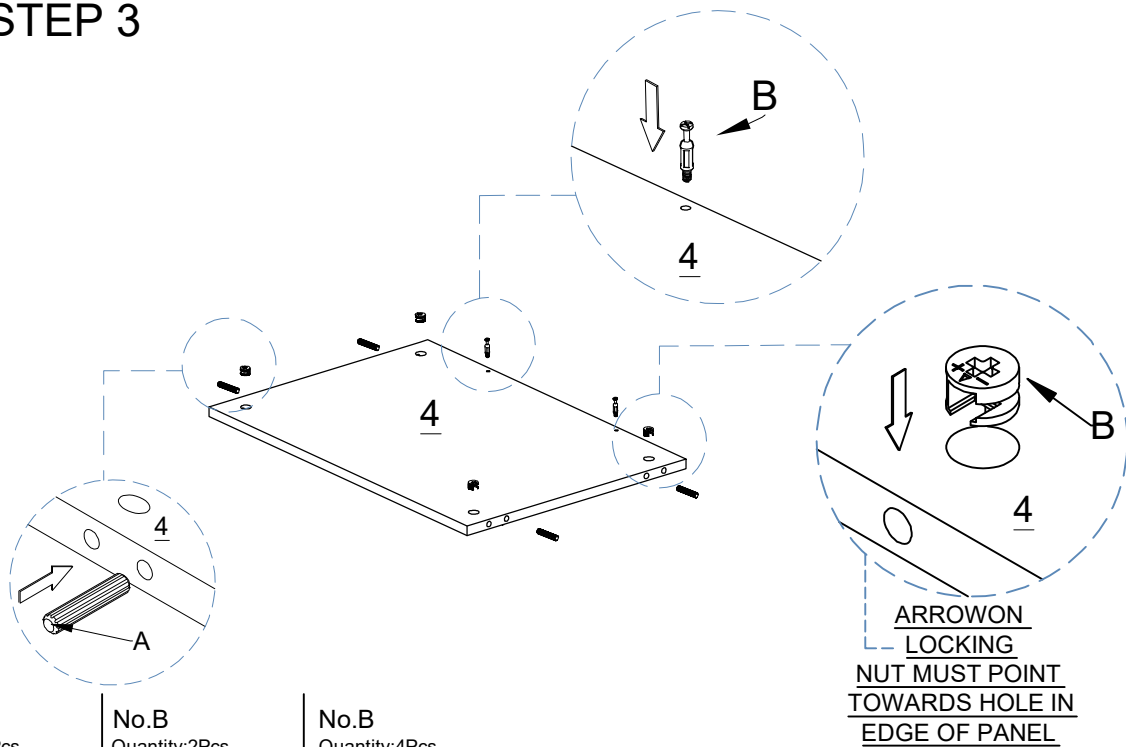

No.A
Quantity:4Pcs
Dowel



No.B
Quantity:2Pcs
Cam Bolt



No.B
Quantity:4Pcs
Cam Nut



ARROW ON
LOCKING
NUT MUST POINT
TOWARDS HOLE IN
EDGE OF PANEL

STEP 4

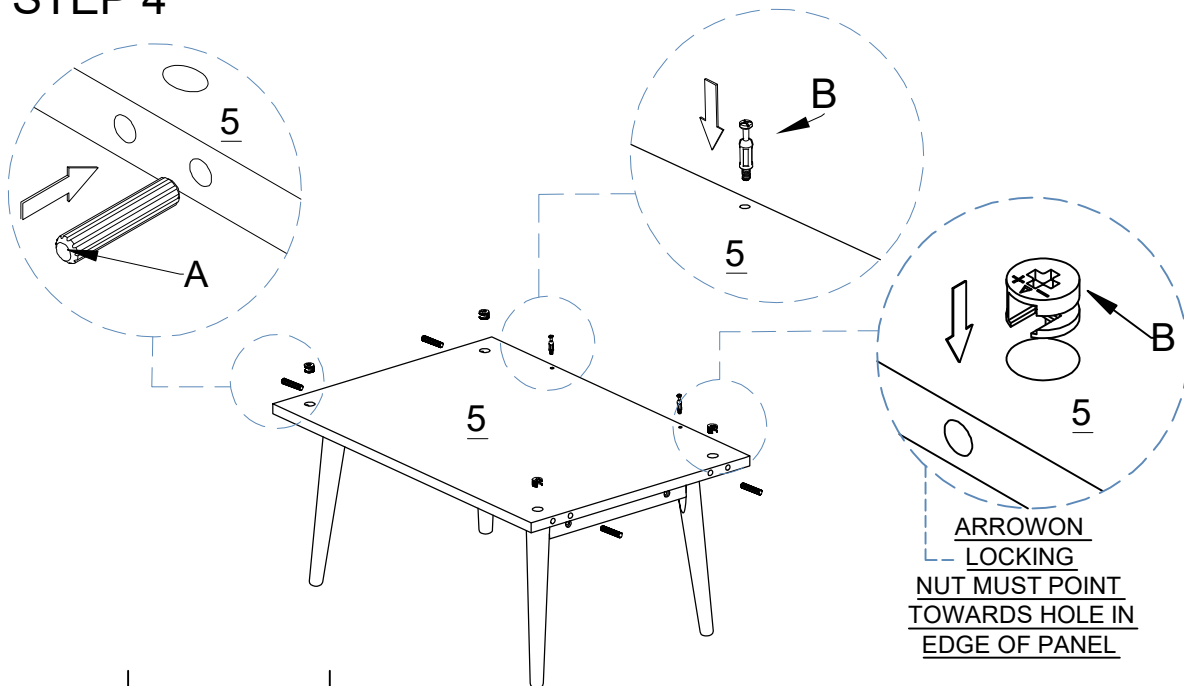

No.A
Quantity:4Pcs
Dowel



No.B
Quantity:2Pcs
Cam Bolt



No.B
Quantity:4Pcs
Cam Nut



ARROW ON
LOCKING
NUT MUST POINT
TOWARDS HOLE IN
EDGE OF PANEL

STEP 5

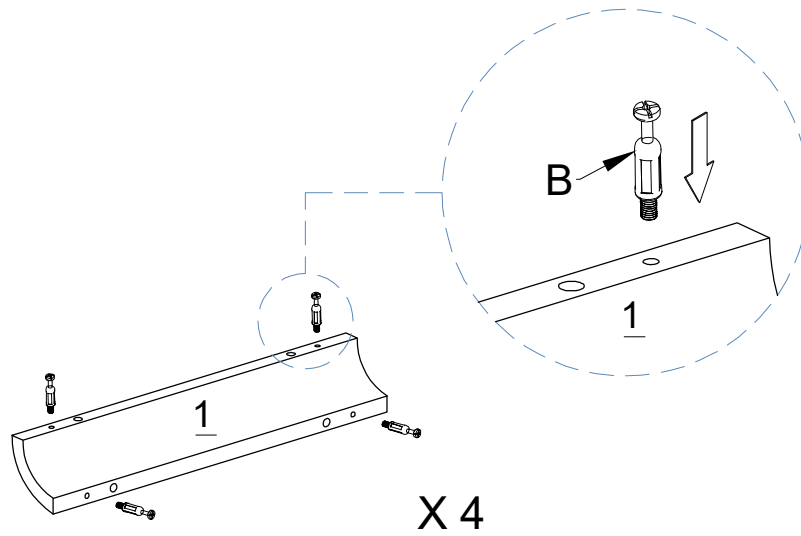

No.B
Quantity: 16Pcs
Cam Bolt



STEP 6

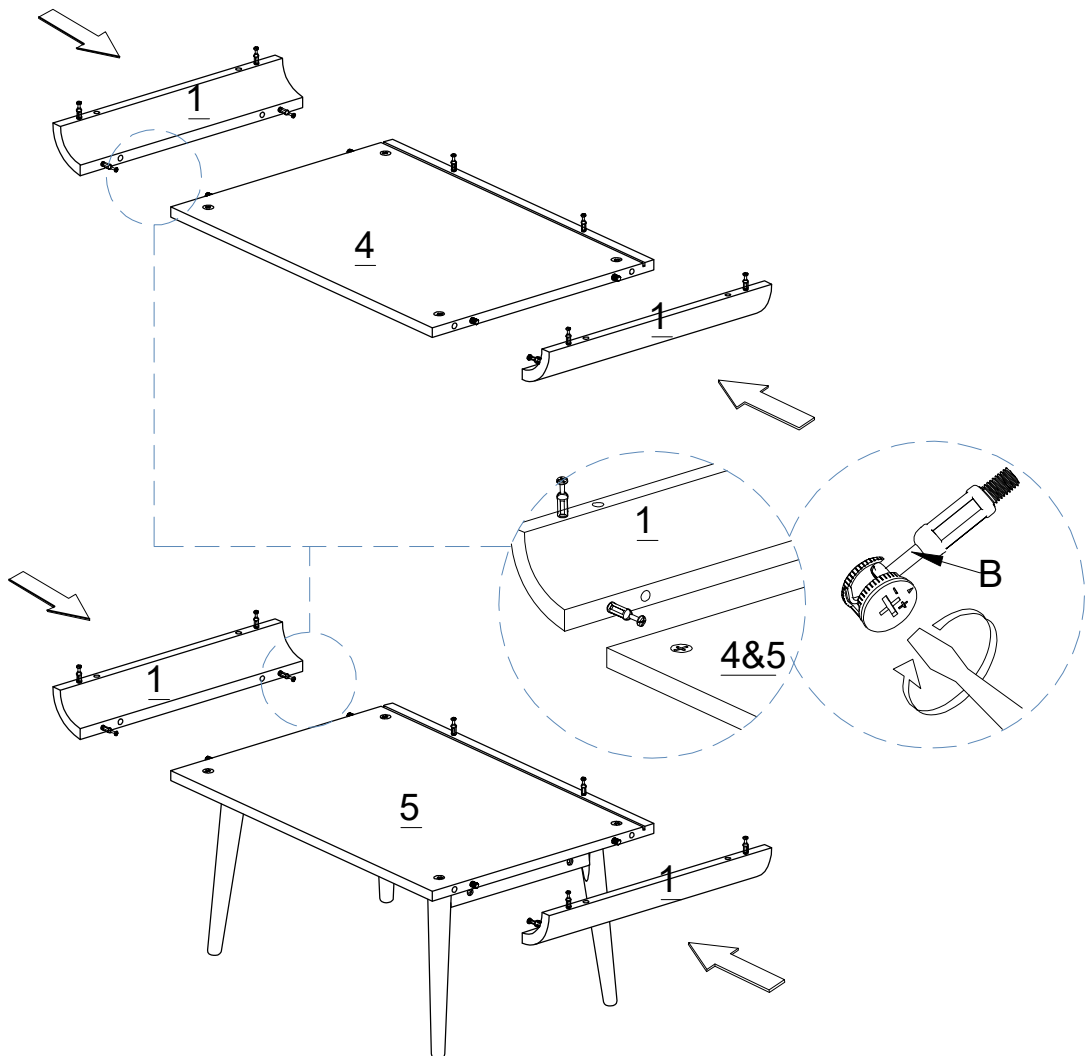

STEP 7

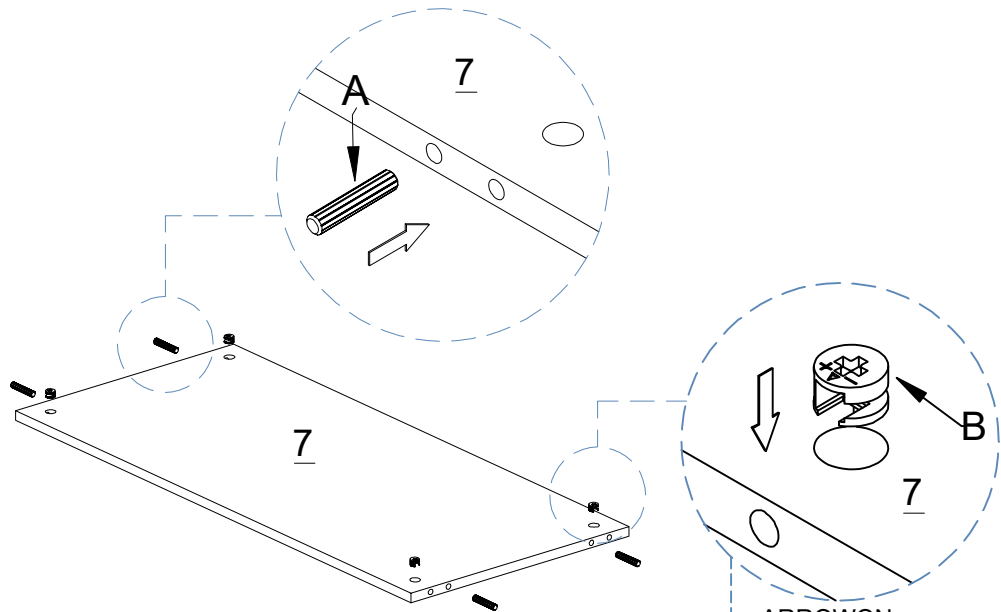

No.A
Quantity:16Pcs
Dowel



No.B
Quantity:16Pcs
Cam Nut



X 4

ARROWON
LOCKING
NUT MUST POINT
TOWARDS HOLE IN
EDGE OF PANEL

STEP 8

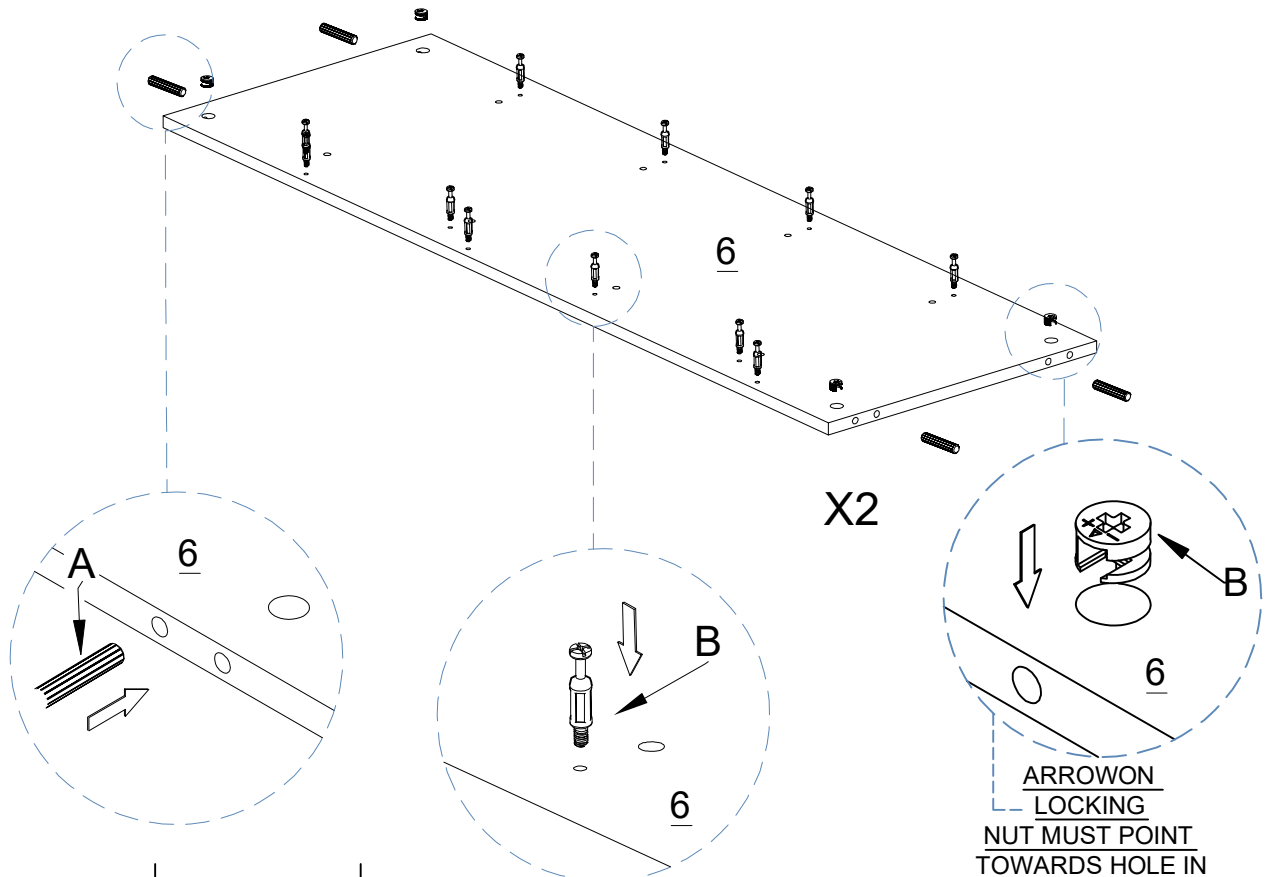

X2

ARROWON
LOCKING
NUT MUST POINT
TOWARDS HOLE IN
EDGE OF PANEL

No.A
Quantity:8Pcs
Dowel



No.B
Quantity:22Pcs
Cam Bolt



No.B
Quantity:8Pcs
Cam Nut



STEP 9

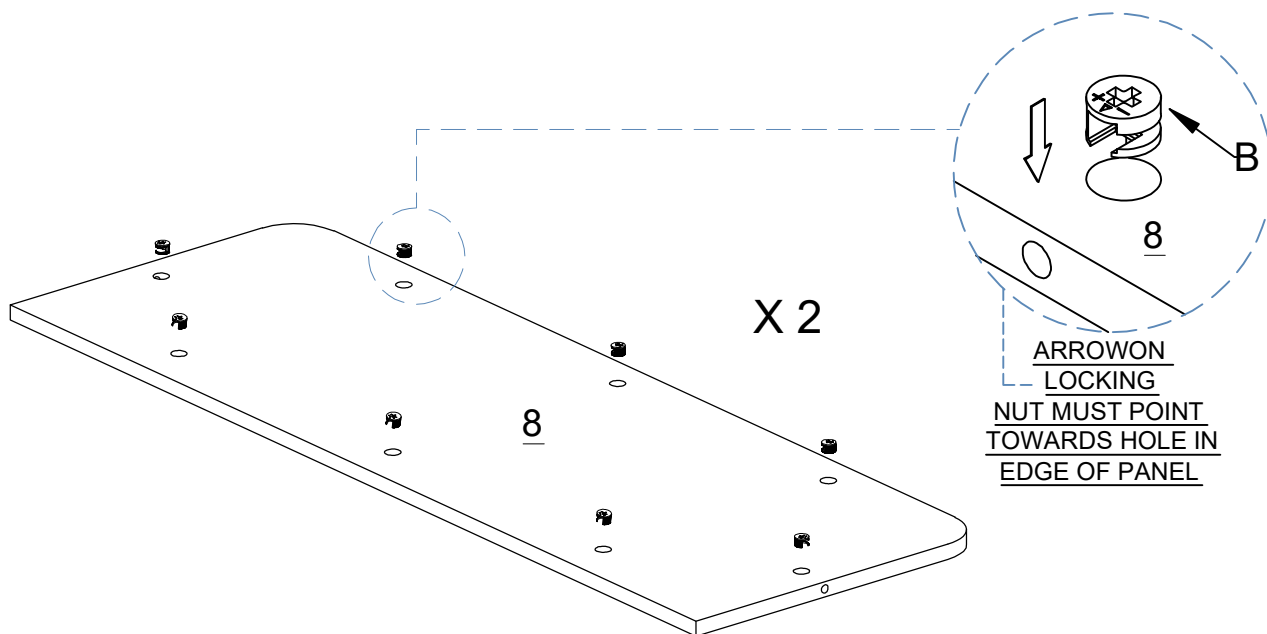

No.B
Quantity: 16Pcs
Cam Nut



STEP 10

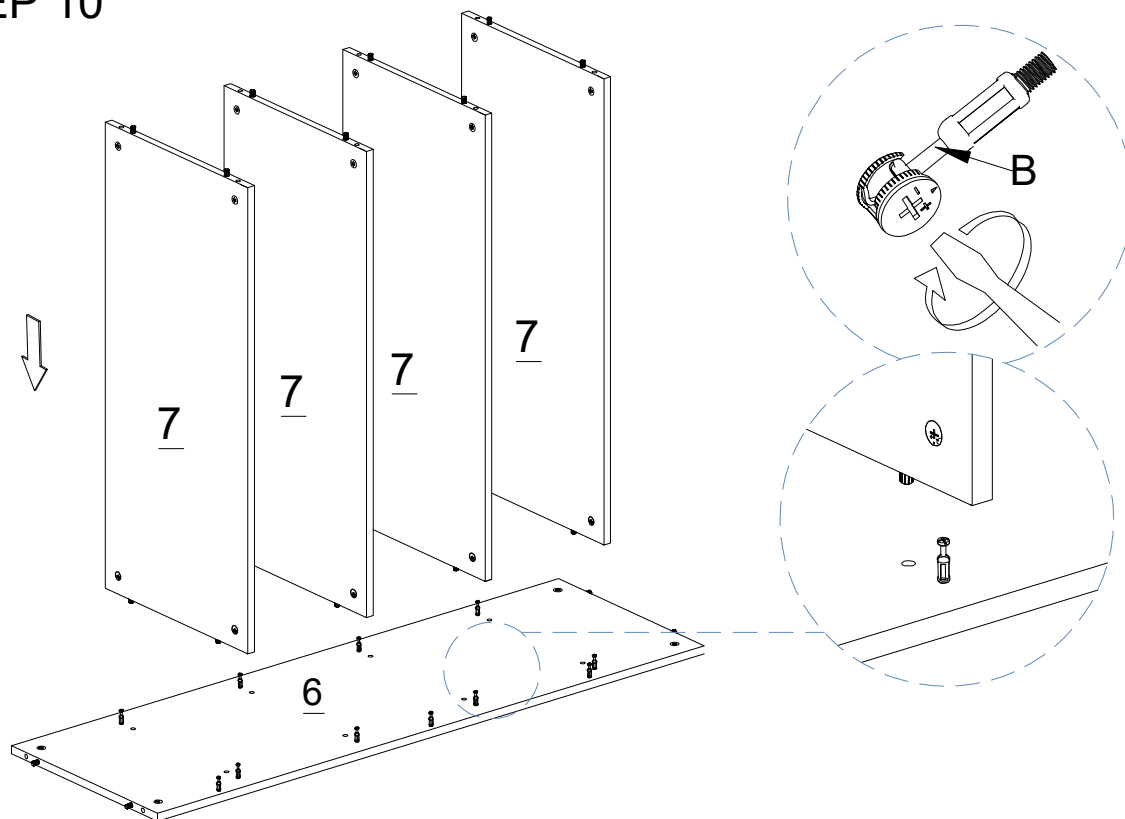

STEP 11

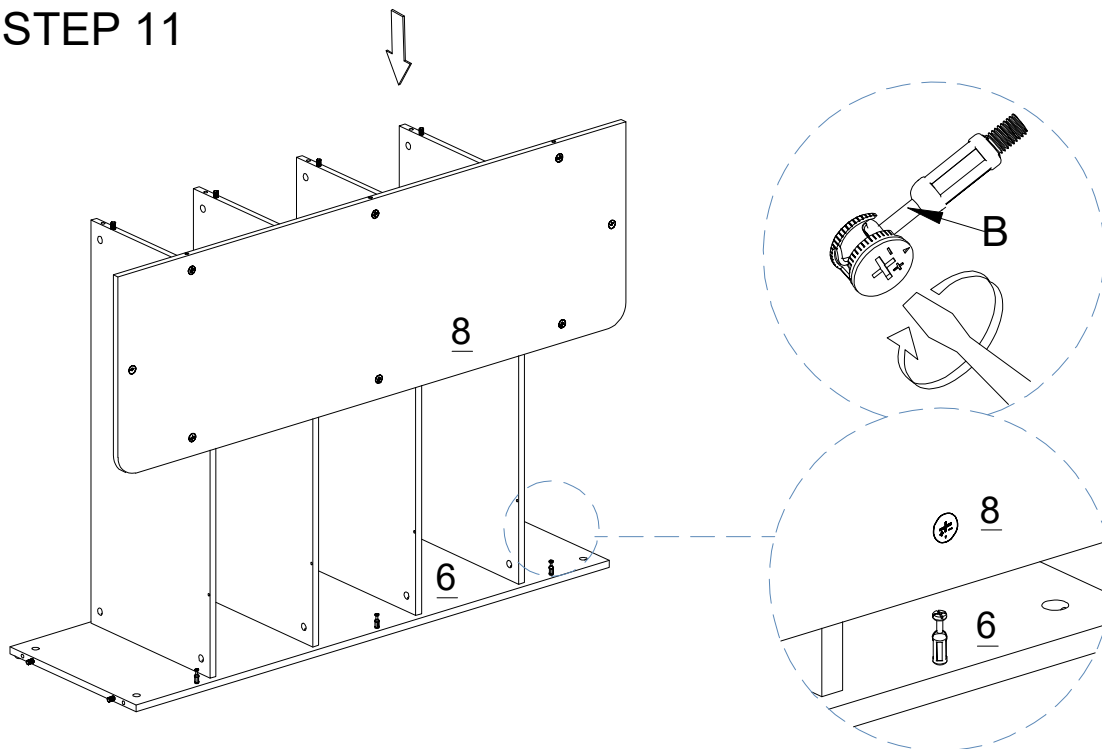

STEP 12

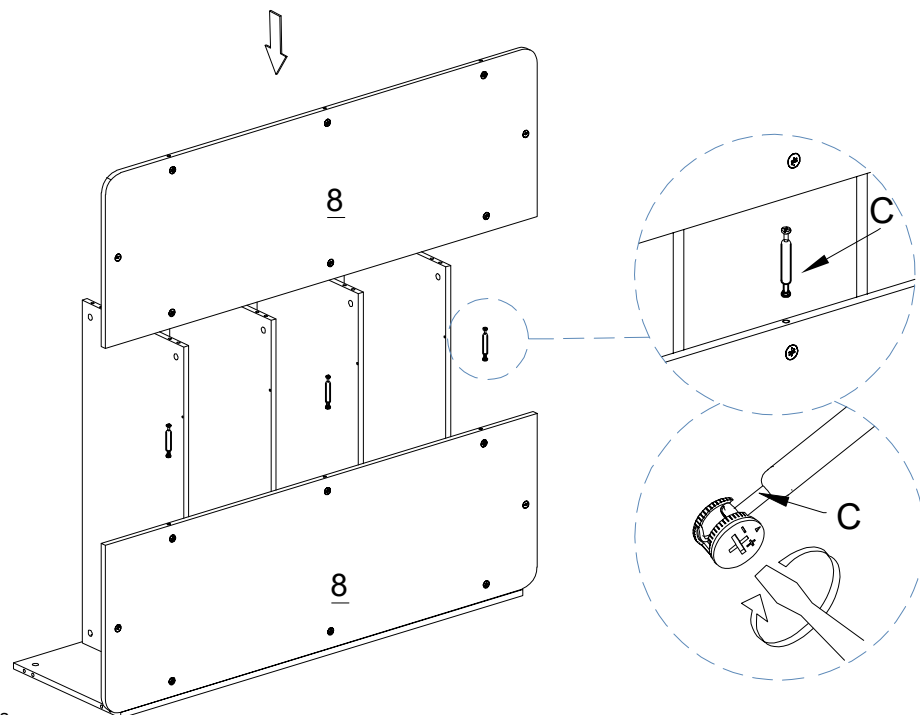

No.C
Quantity:3Pcs
Cam Bolt



No.C
Quantity:3Pcs
Cam Nut



STEP 13

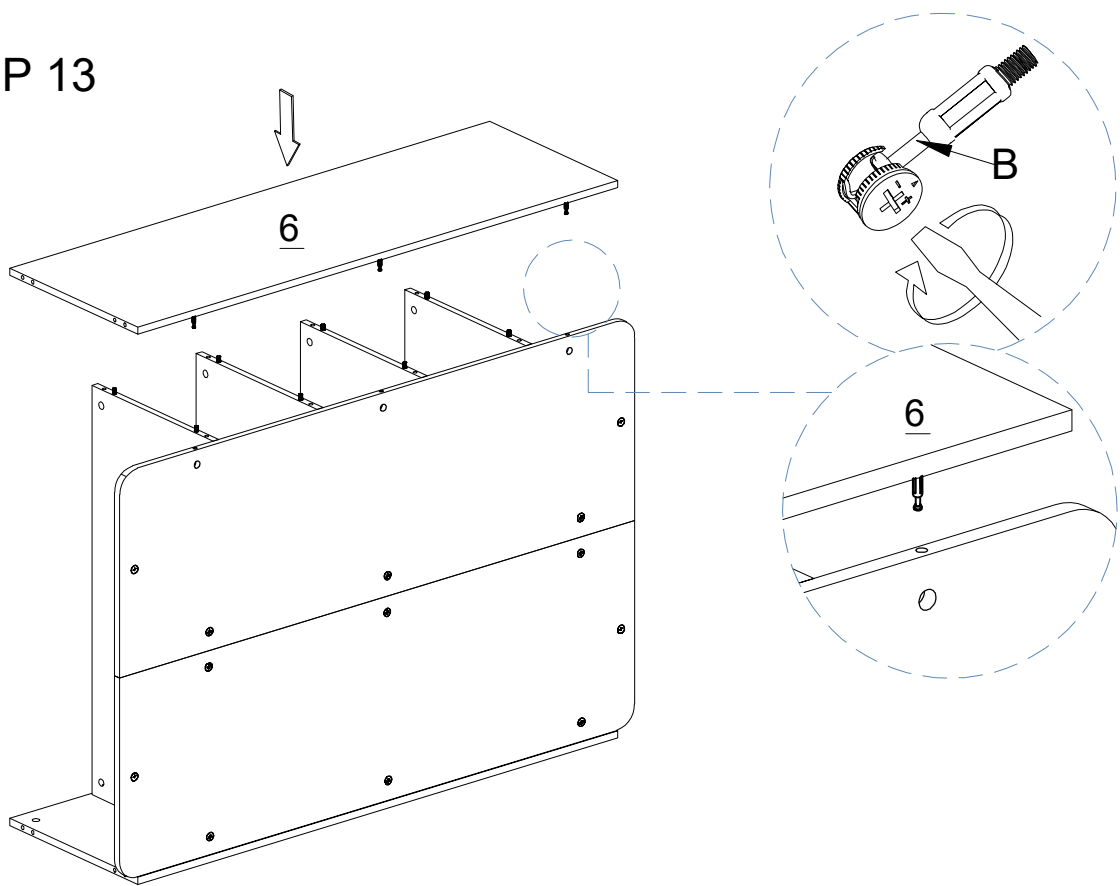

STEP 14

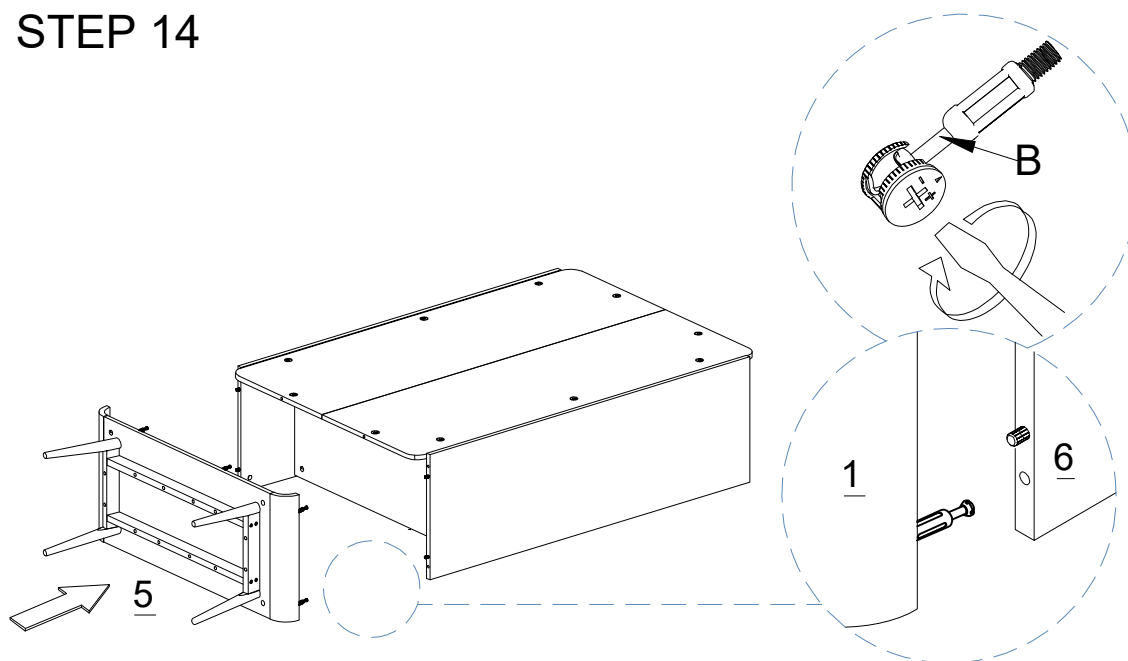

STEP 15

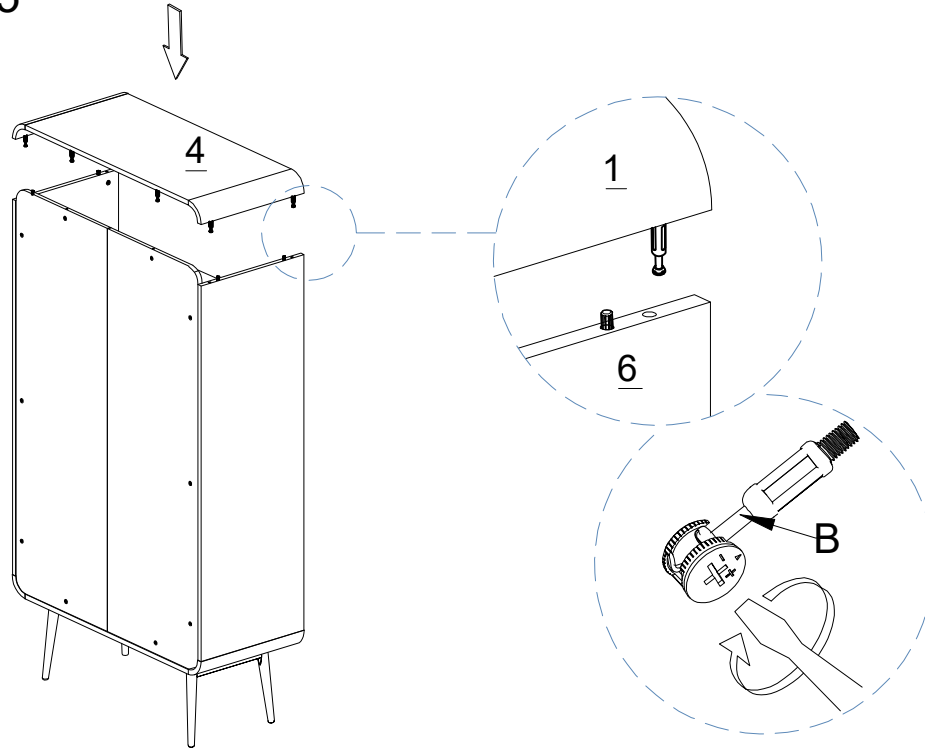

STEP 16

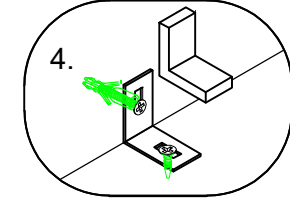
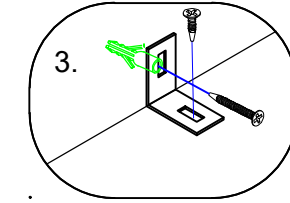
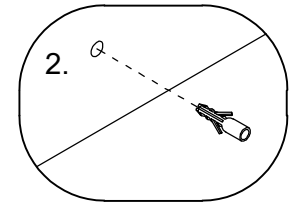
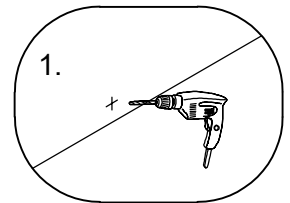
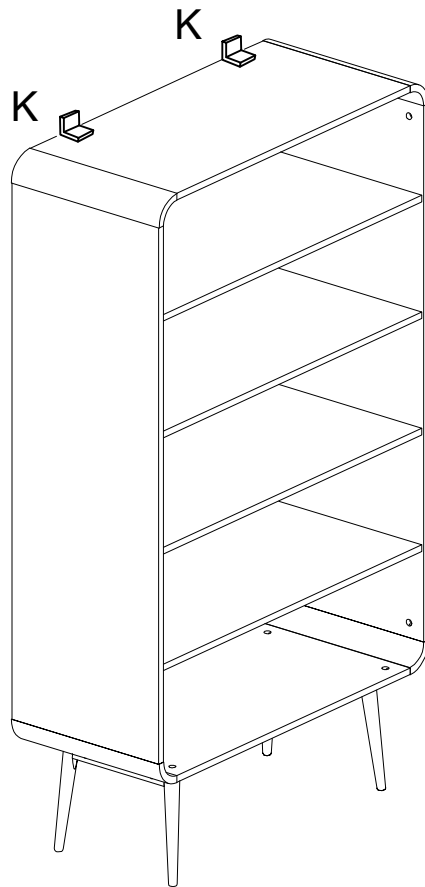

No.K
Quantity:2Pcs
Anti Collapse

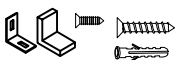

lifely.com.au

Great Job, You're done!

Don't forget to share how it looks in
your space and tag us on Instagram.

[@lifelyhome](#) [#homewithlifely!](#)