

Assembly Instructions

Cuppa Series

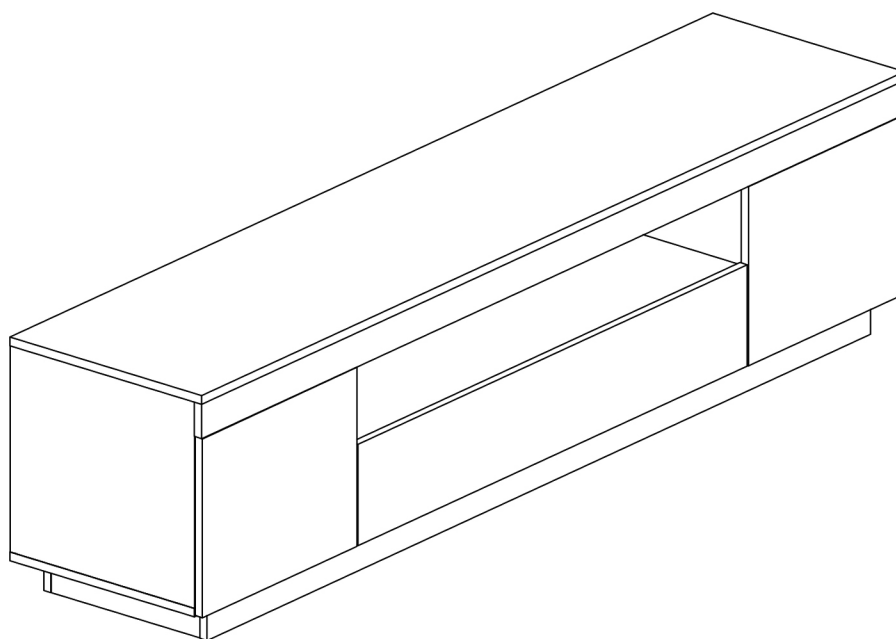

Lifely*

Product Code

CPA-V2-TV180-WOK Cuppa Tv Stand

Dimensions(Wx DxH)

1800x400x450mm

Important

Please read through instruction carefully
Before assembly and keep for future reference.

For our full catalogue of assembly instructions,
Visit: lifely.com.au/assembly.

Important Tips and Maintenance



1. Keep children and animals away from working area as smaller parts may cause choking if swallowed.

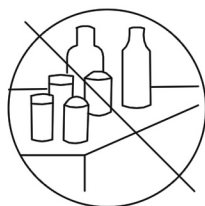

2. Never place liquids or anything damp upon furniture as it will mark. Ensure a coaster or running is beneath.



3. Never use ammonia based cleaning products as it will damage the finish.

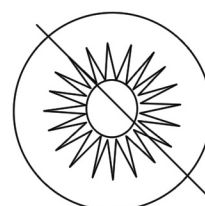

4. To avoid fading, keep furniture out of direct sunlight.

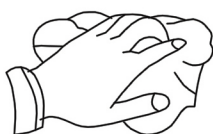

5. Use a soft or damp cloth (dry cloth) when wiping or cleaning surfaces.



6. Two person are required.



7. Lay a soft matt down to protect the furniture piece before and during assembly.

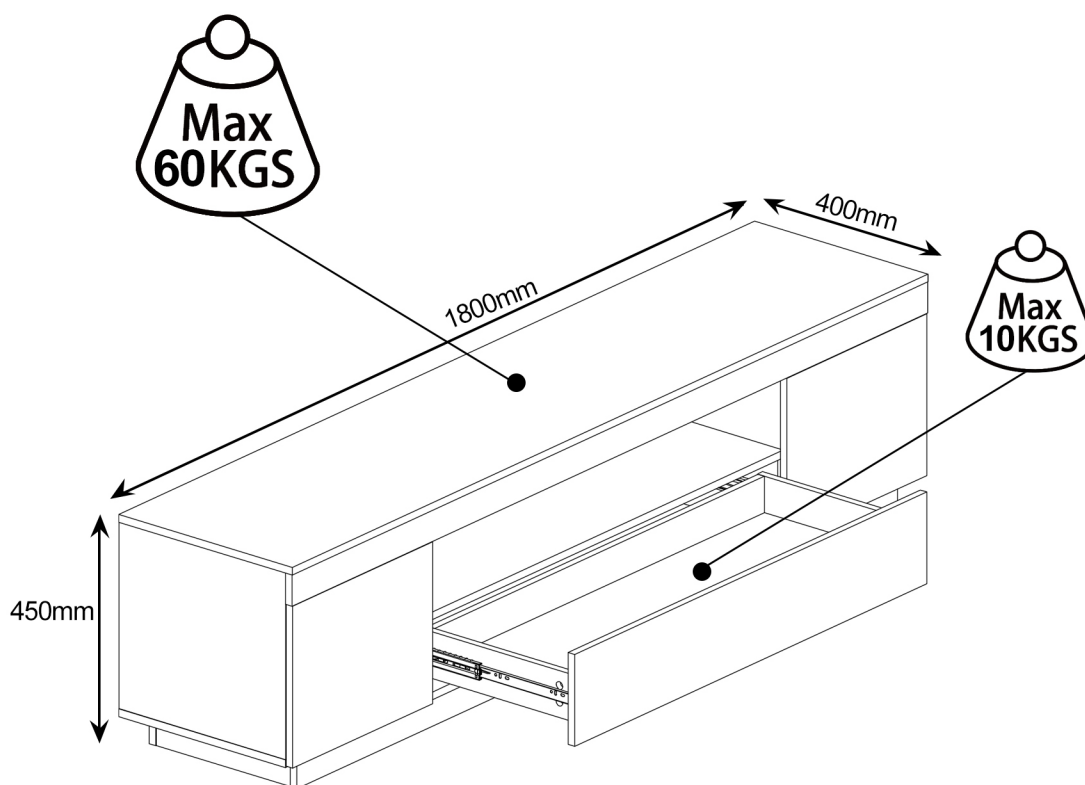

So your relationship is strong. But is it flat-pack furniture strong? Unless you're an aerospace engineer, assembling furniture can be slightly stressful. We recommend meditating quietly, pouring yourself a herbal tea (or slightly less herbal wine) and tackling things one step at a time. If you feel a passive aggressive remark coming on, try a compliment instead. E.g. "You're so good looking".

This 35-Step assembly should take around 65 minutes with an Allen Key-or 45 minutes with an electric drill. Godspeed.

Designed for everyday

Component Hardware

Please check you have all the fittings
part or tools are listed in below.

No. A
Quantity: 22Pcs
Dowel



No. B
Quantity: 62Pcs
Cam Bolt

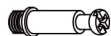

No. C
Quantity: 62Pcs
Cam Nut



No. D
Quantity: 46Pcs
Screw M3.5*14mm



No. E
Quantity: 2Pcs
Guide

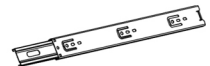

No.F
Quantity: 4Pcs
Hinges



No.G
Quantity: 12Pcs
Back Plate Clamp



No. H
Quantity: 1Pc
Allen Key



Component Panels & part List

Please check you have all the panels
are listed below.

- | | | | |
|------------------------------|---------------|----------------------------|---------------|
| 1. BASE ----- | x2 Carton 2/2 | 12. SIDE BACK PANEL ----- | x2 Carton 1/2 |
| 2. BASE SIDE ----- | x3 Carton 2/2 | 13. TOP PANEL ----- | x1 Carton 2/2 |
| 3. BOTTOM PANEL ----- | x1 Carton 2/2 | 14. STIFFENING PLATE ----- | x1 Carton 1/2 |
| 4. SMALL SIDE PANEL- R ----- | x1 Carton 2/2 | 15. SKIRT PANEL ----- | x1 Carton 2/2 |
| 5. SMALL SIDE PANEL- L ----- | x1 Carton 2/2 | 16. DRAWER BACK ----- | x1 Carton 1/2 |
| 6. MIDDLE PANEL ----- | x1 Carton 1/2 | 17. DRAWER FRONT ----- | x1 Carton 2/2 |
| 7. MIDDLE BACK PANEL ----- | x1 Carton 2/2 | 18. DRAWER SIDE- L ----- | x1 Carton 1/2 |
| 8. CENTRE PANEL- L ----- | x1 Carton 1/2 | 19. DRAWER SIDE- R ----- | x1 Carton 1/2 |
| 9. CENTRE PANEL- R ----- | x1 Carton 1/2 | 20. BASE SUPPORT ----- | x2 Carton 1/2 |
| 10. SIDE PANEL- L ----- | x1 Carton 1/2 | 21. DRAWER BASE ----- | x1 Carton 1/2 |
| 11. SIDE PANEL- R ----- | x1 Carton 1/2 | 22. DOOR ----- | x2 Carton 1/2 |

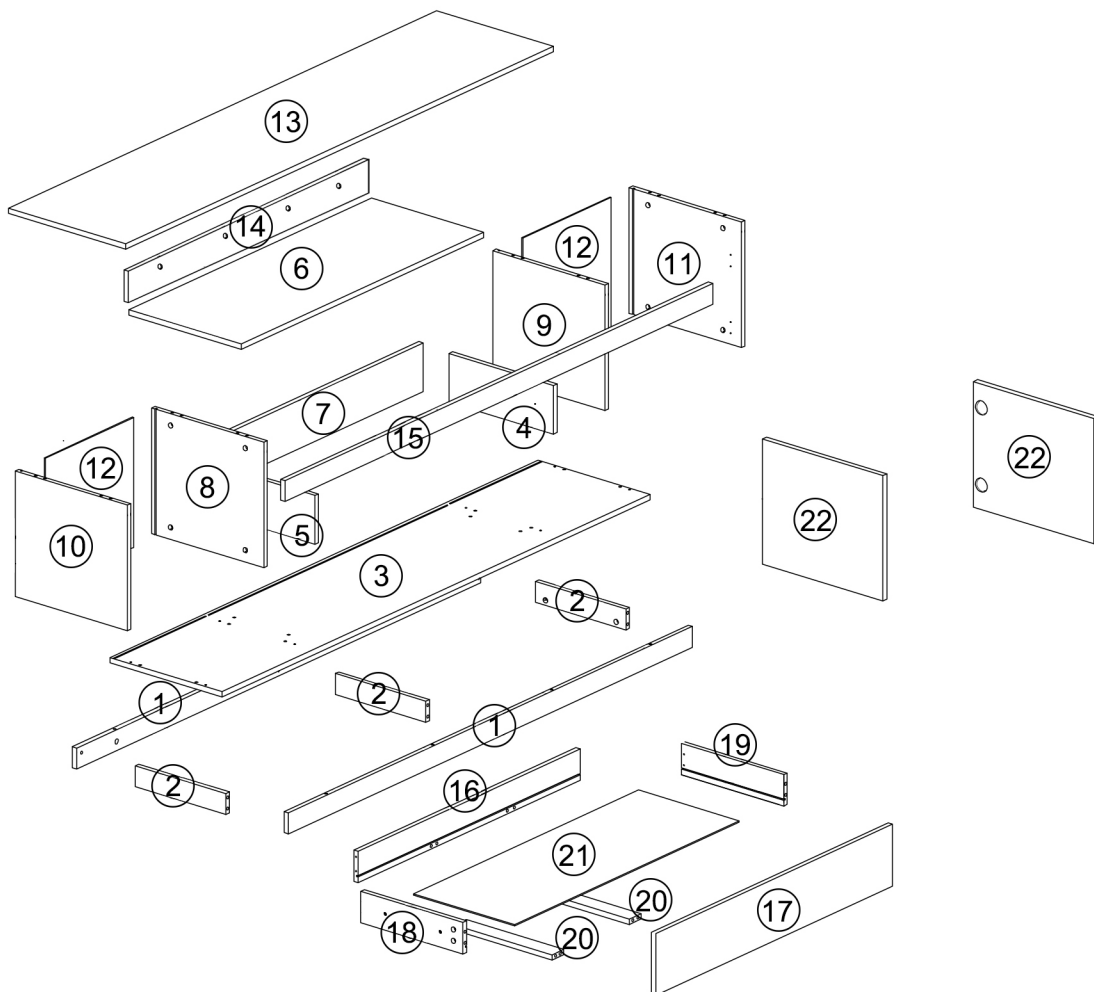

STEP 1

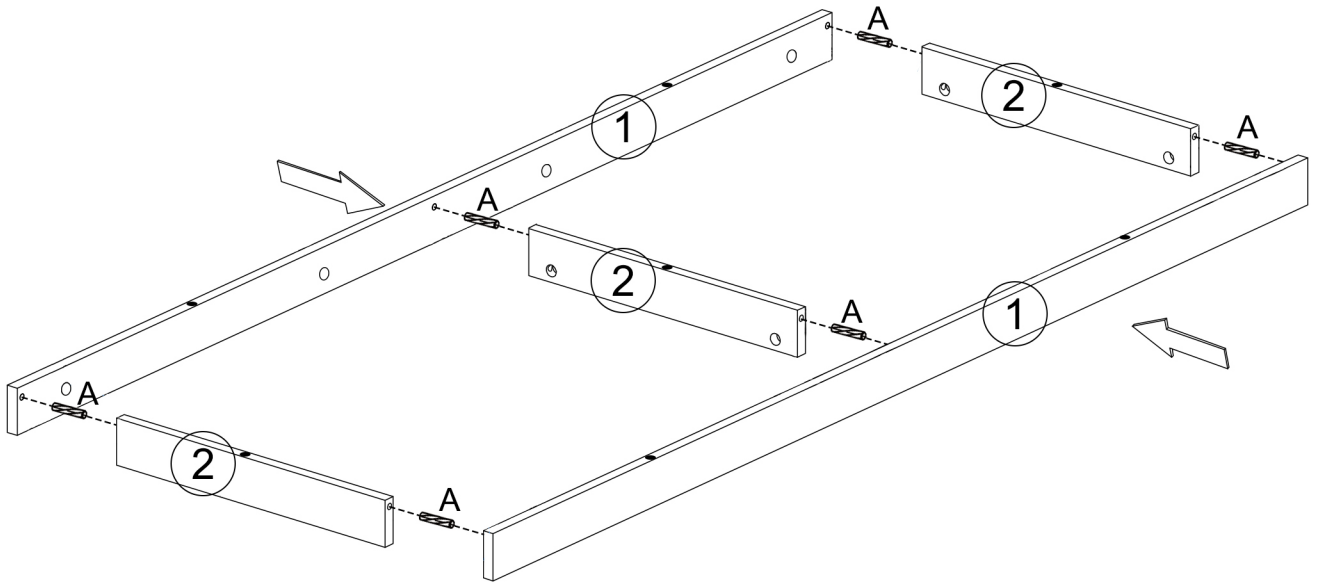

No. A
Quantity: 6 Pcs
Dowel



STEP 2

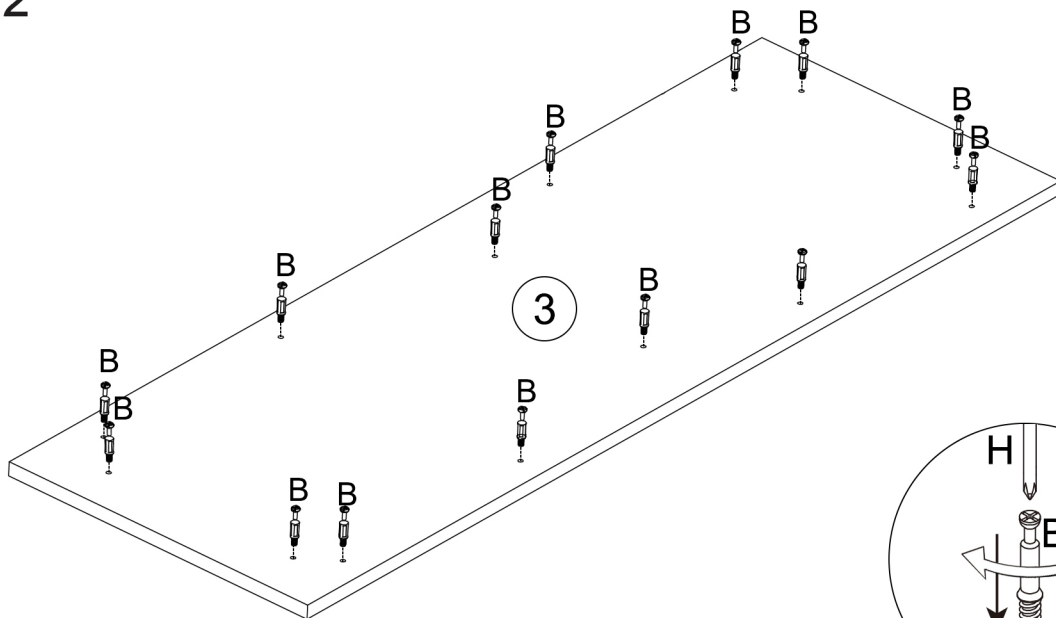

No. B
Quantity: 14Pcs
Cam Bolt

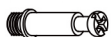

No. H
Quantity: 1Pc
Allen Key



STEP 3

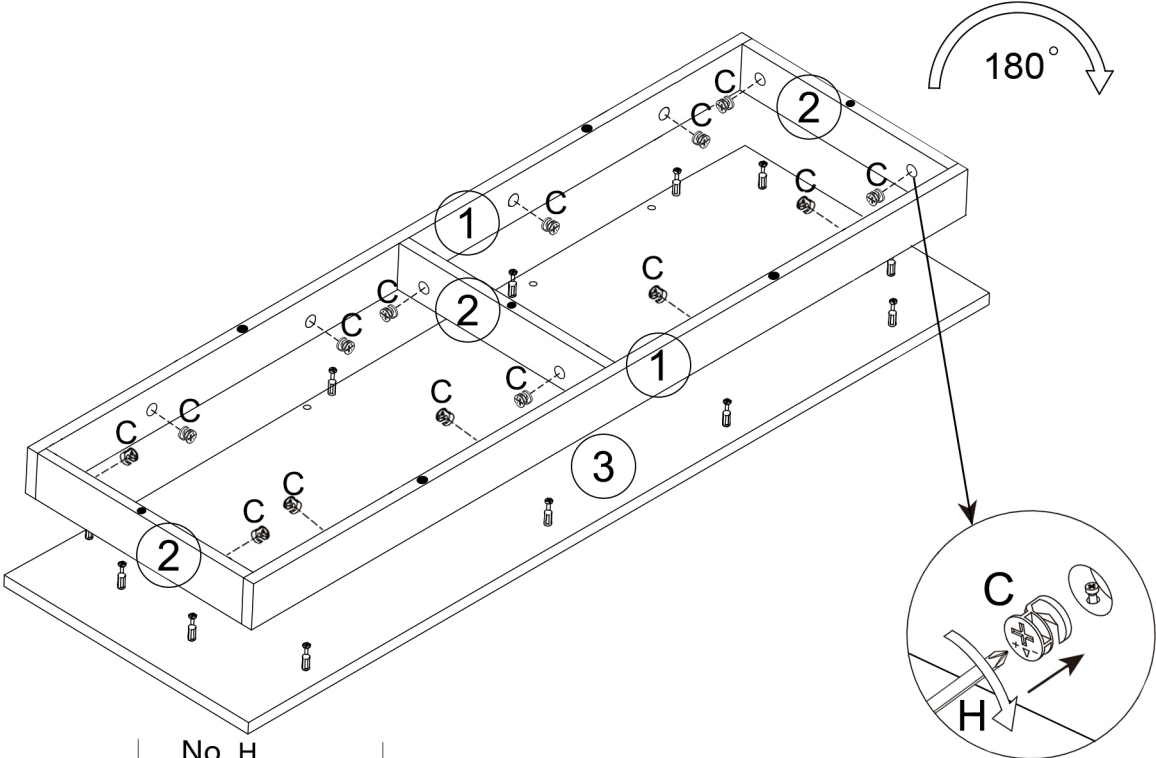

C
Quantity: 14 Pcs
Cam Nut



No. H
Quantity: 1Pc
Allen Key



STEP 4

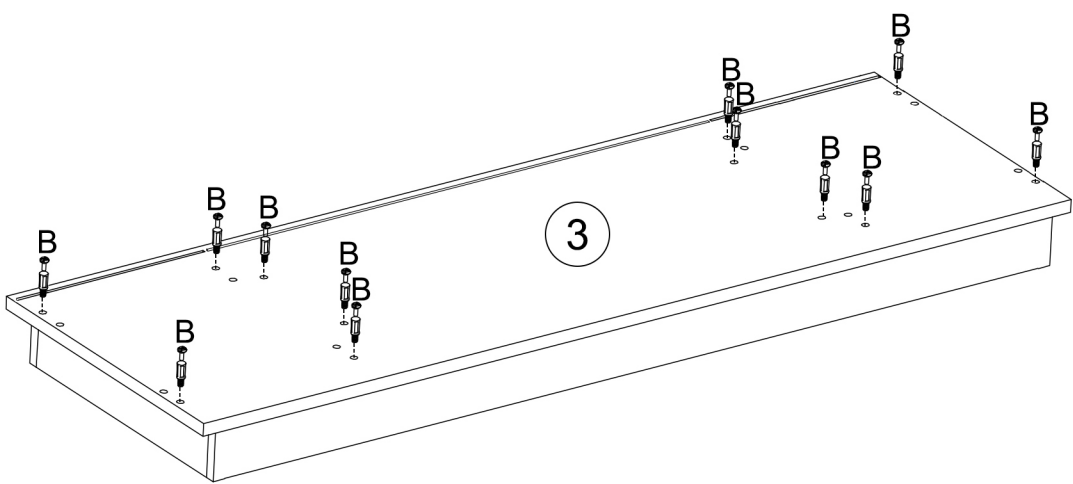

No. B
Quantity: 12 Pcs
Cam Bolt

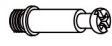

No. H
Quantity: 1Pc
Allen Key



STEP 5

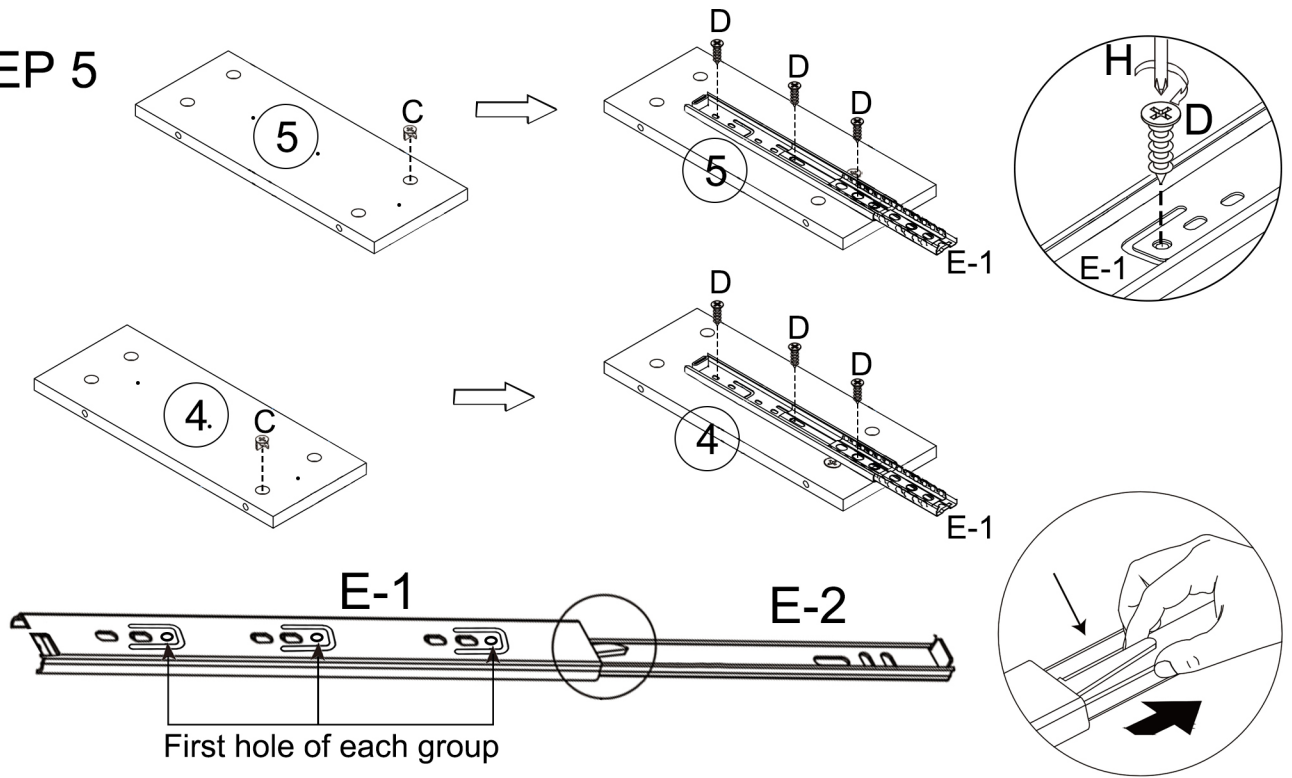

No. C
Quantity: 2Pcs
Cam Nut



No. D
Quantity: 6Pcs
Screw M3.5*14mm



No. E-1
Quantity: 2Pcs
Guide

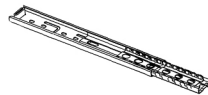

No. H
Quantity: 1Pc
Allen Key



STEP 6

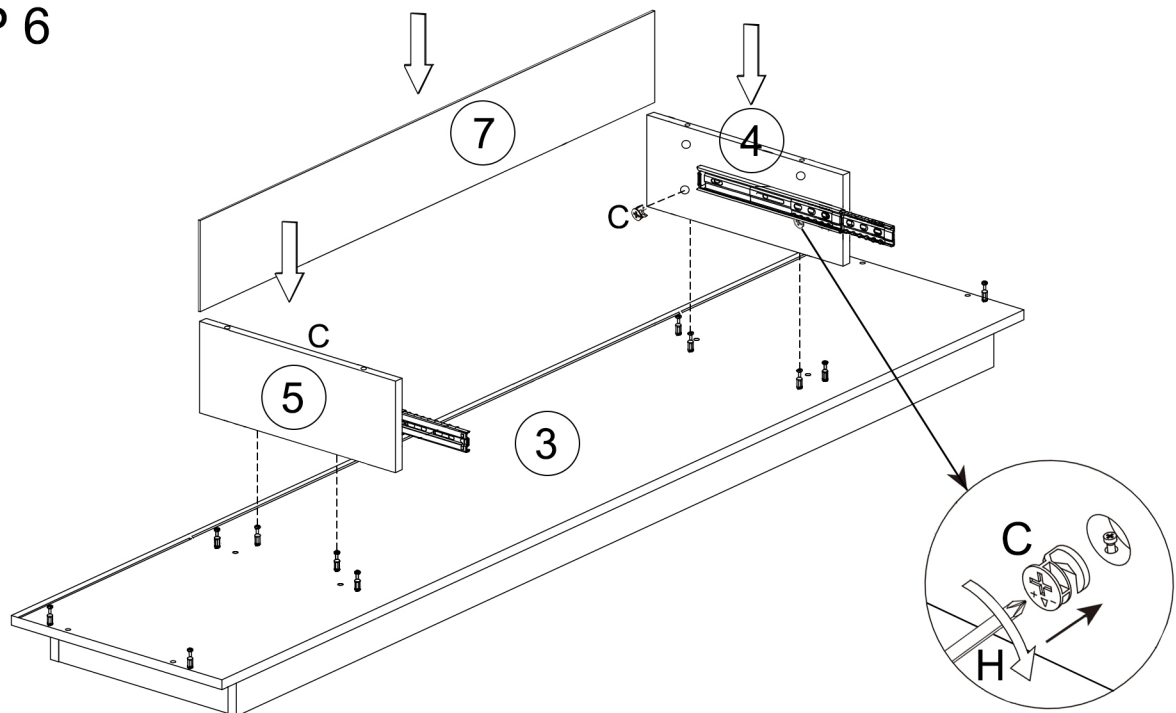

No. C
Quantity: 2Pcs
Cam Nut



No. H
Quantity: 1Pc
Allen Key



STEP 7

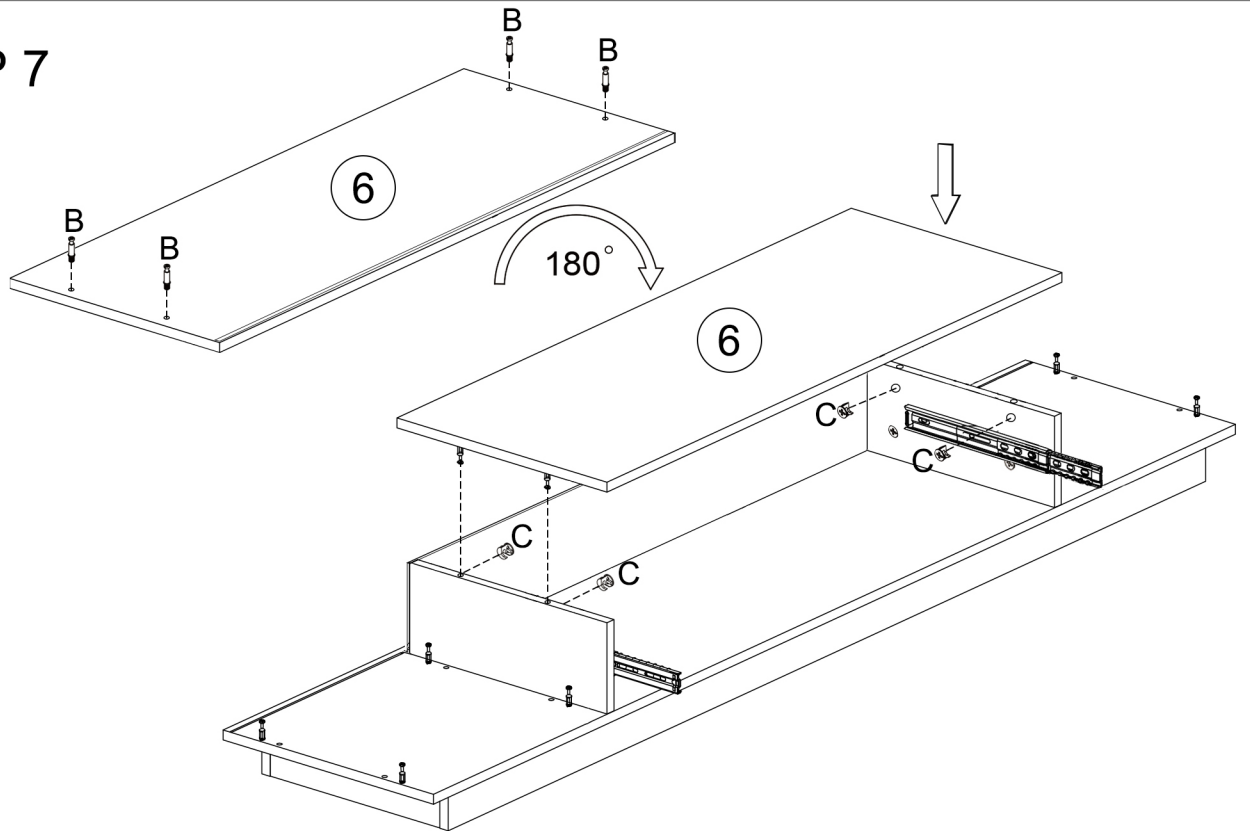

No. B
Quantity: 4Pcs
Cam Bolt

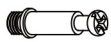

No. C
Quantity: 4Pcs
Cam Nut



No. H
Quantity: 1Pc
Allen Key



STEP 8

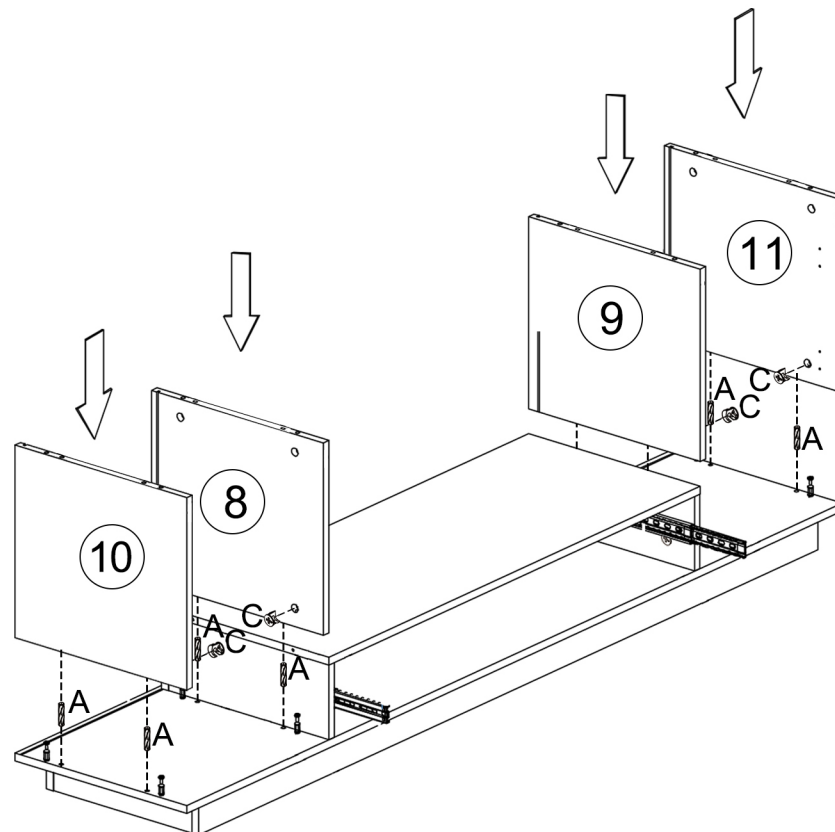

No. A
Quantity: 8Pcs
Dowel



No. C
Quantity: 8Pcs
Cam Nut



No. H
Quantity: 1Pc
Allen Key



STEP 9

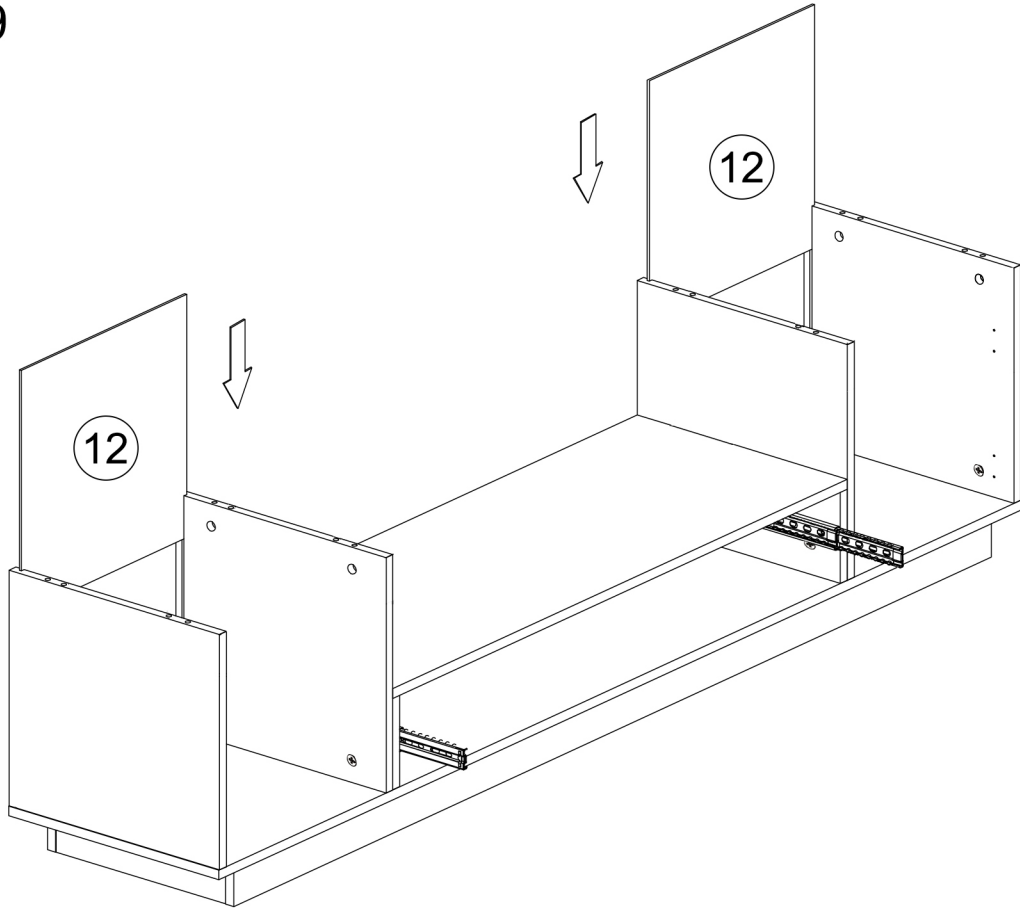

STEP 10

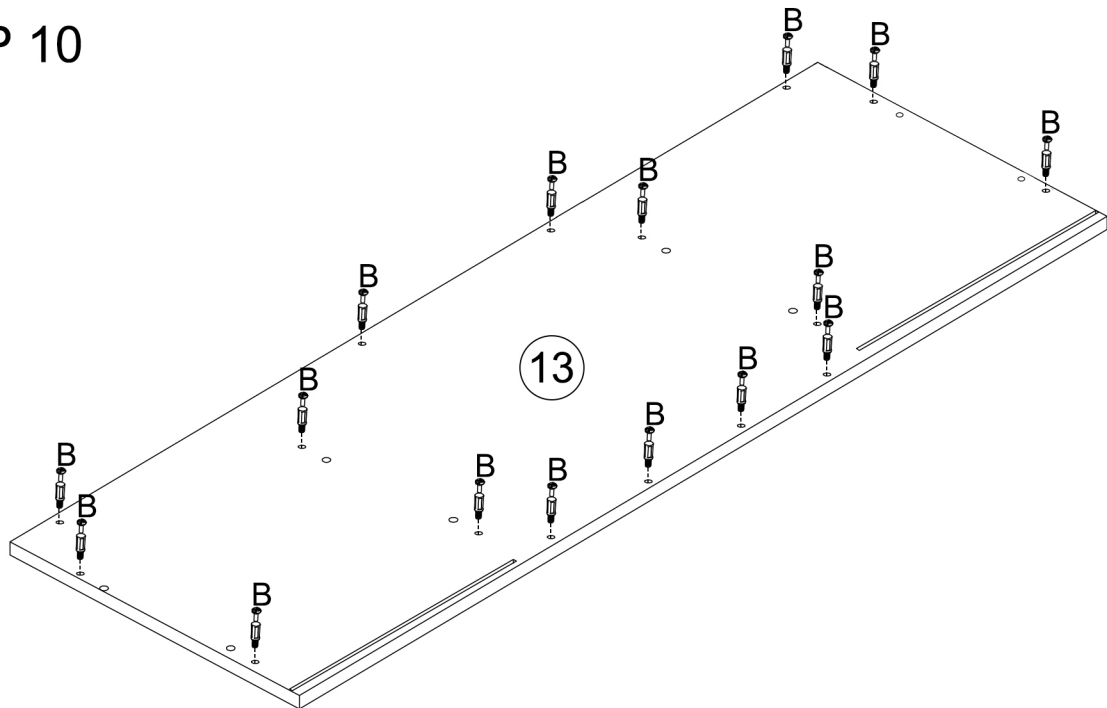

No. B
Quantity: 16Pcs
Cam Bolt

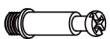

No. H
Quantity: 1Pc
Allen Key



STEP 11

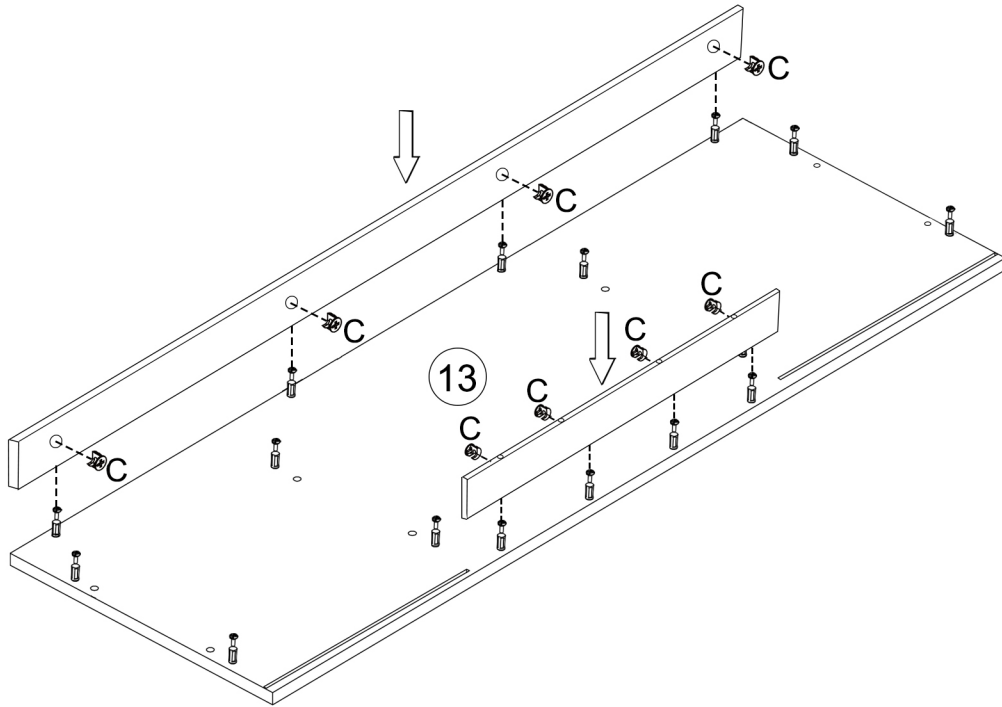

No. C
Quantity: 8Pcs
Cam Nut



No. H
Quantity: 1Pc
Allen Key



STEP 12

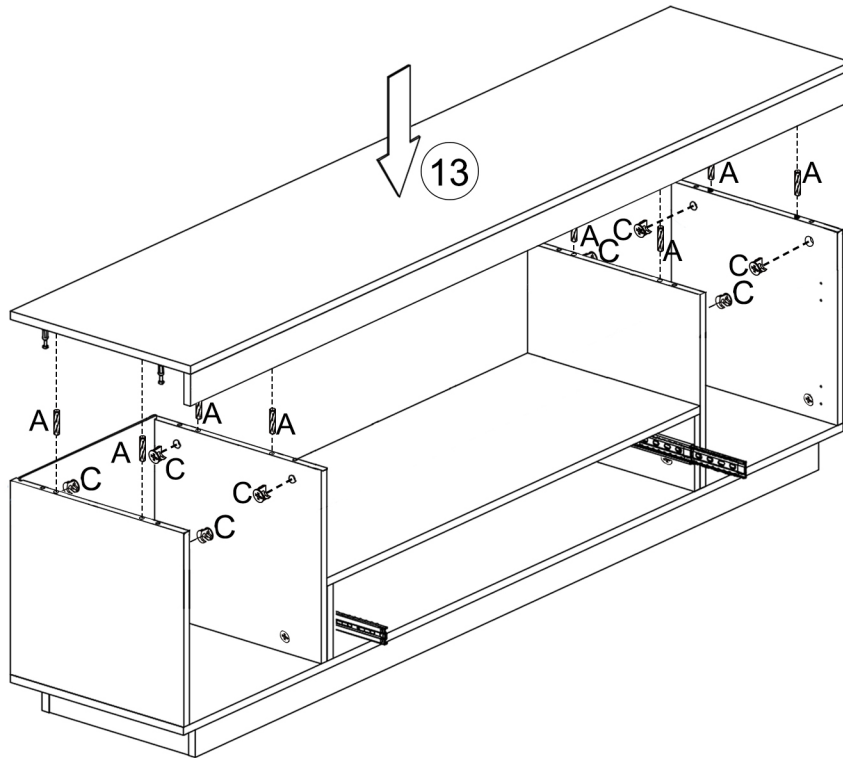

No. A
Quantity: 8Pcs
Dowel

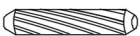

No. C
Quantity: 8Pcs
Cam Nut



No. H
Quantity: 1Pc
Allen Key



STEP 13

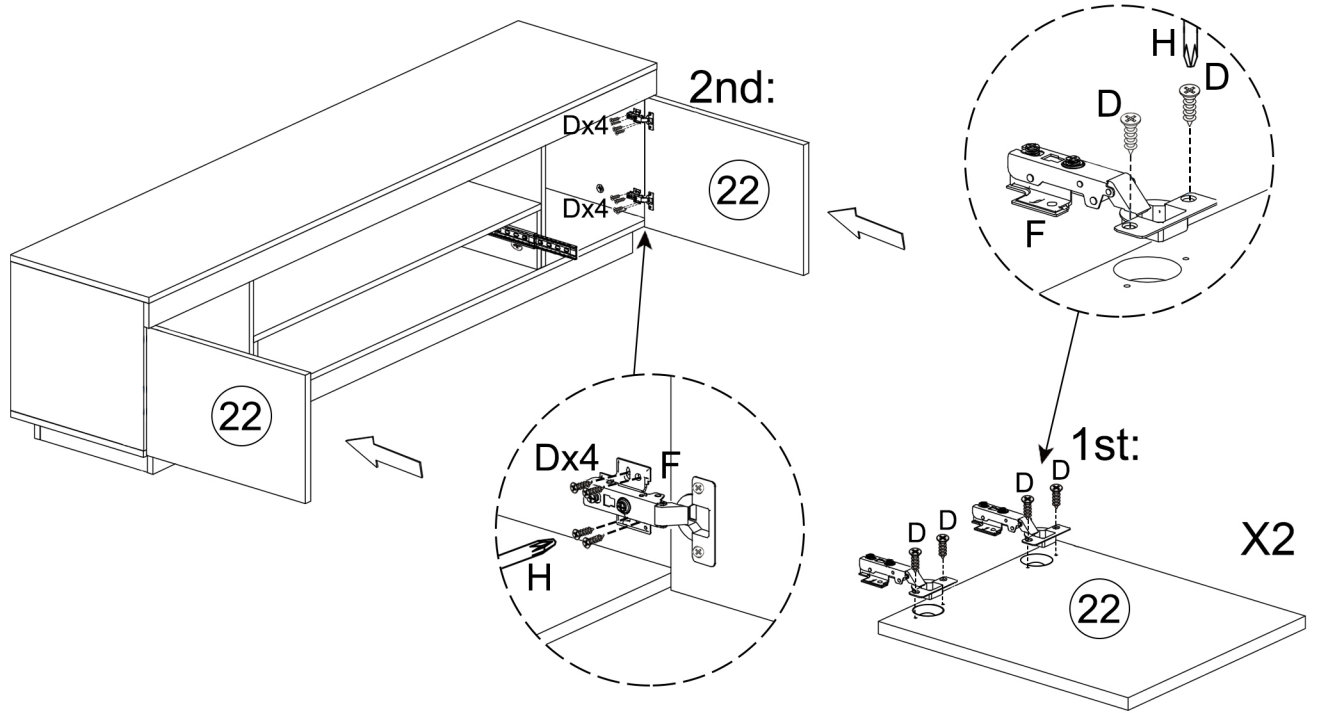

No. D
Quantity: 24Pcs
Screw M3.5*14mm



No. F
Quantity: 4Pcs
Hinges



No. H
Quantity: 1Pc
Allen Key



STEP 14

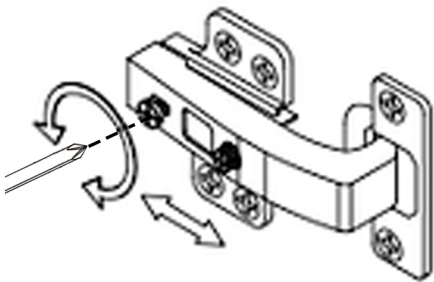

How to adjust the door gap at side with screw adjustment?

Turn left or right the adjuster properly until door is balanced.

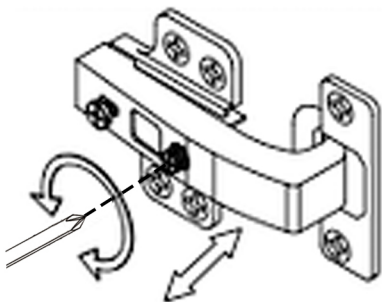

How to adjust the door gap at front with screw adjustment?

Turn left or right middle bolt adjuster properly until door is balanced.

STEP 15

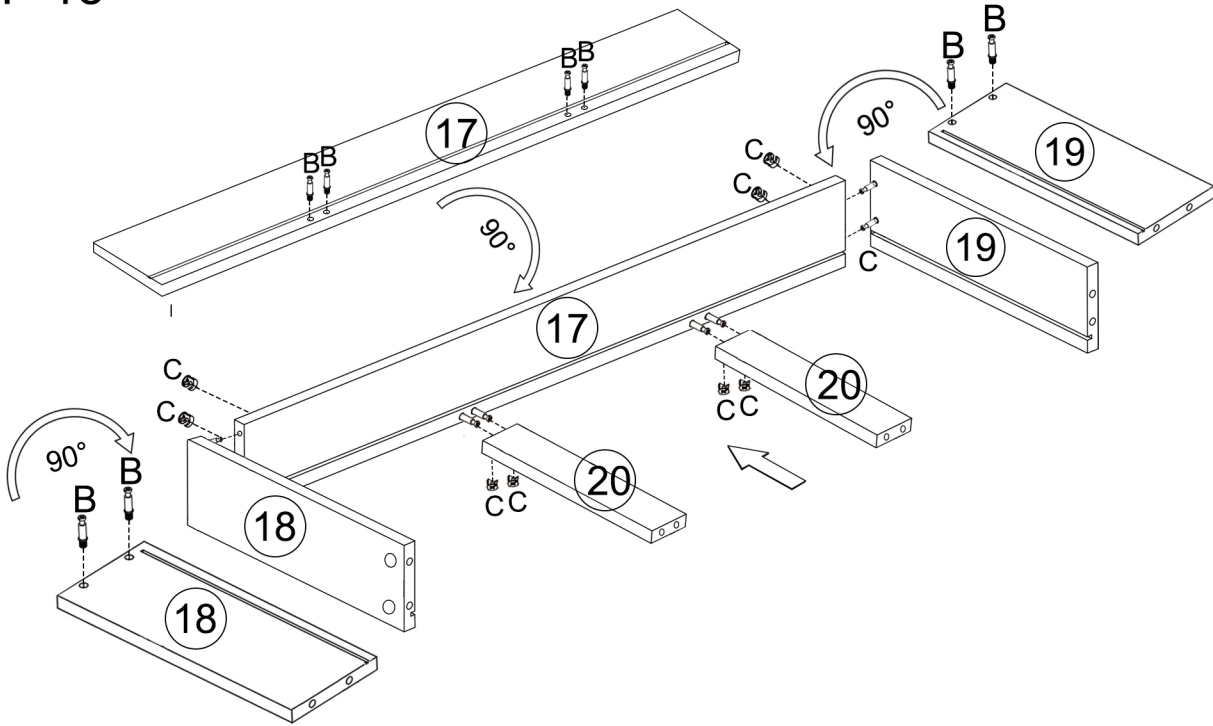

No. B
Quantity: 8Pcs
Cam Bolt

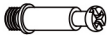

No. C
Quantity: 8Pcs
Cam Nut



No. H
Quantity: 1Pc
Allen Key



STEP 16

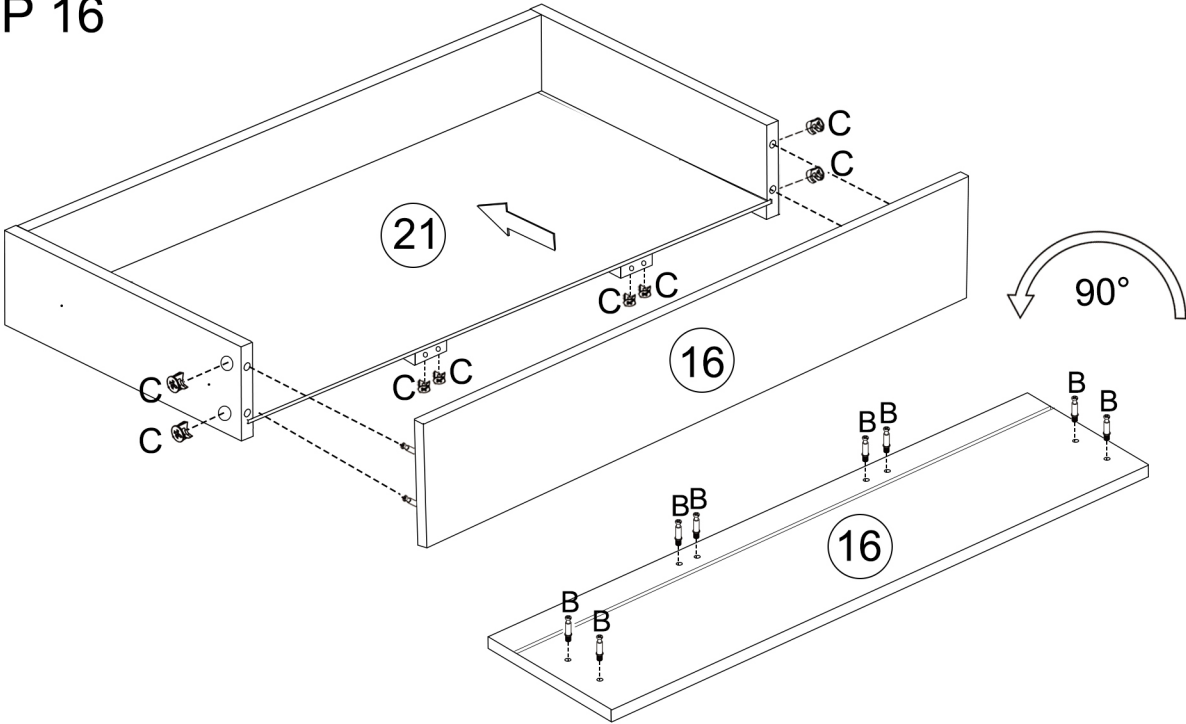

No. B
Quantity: 8Pcs
Cam Bolt

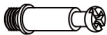

No. C
Quantity: 8Pcs
Cam Nut



No. H
Quantity: 1Pc
Allen Key



STEP 17

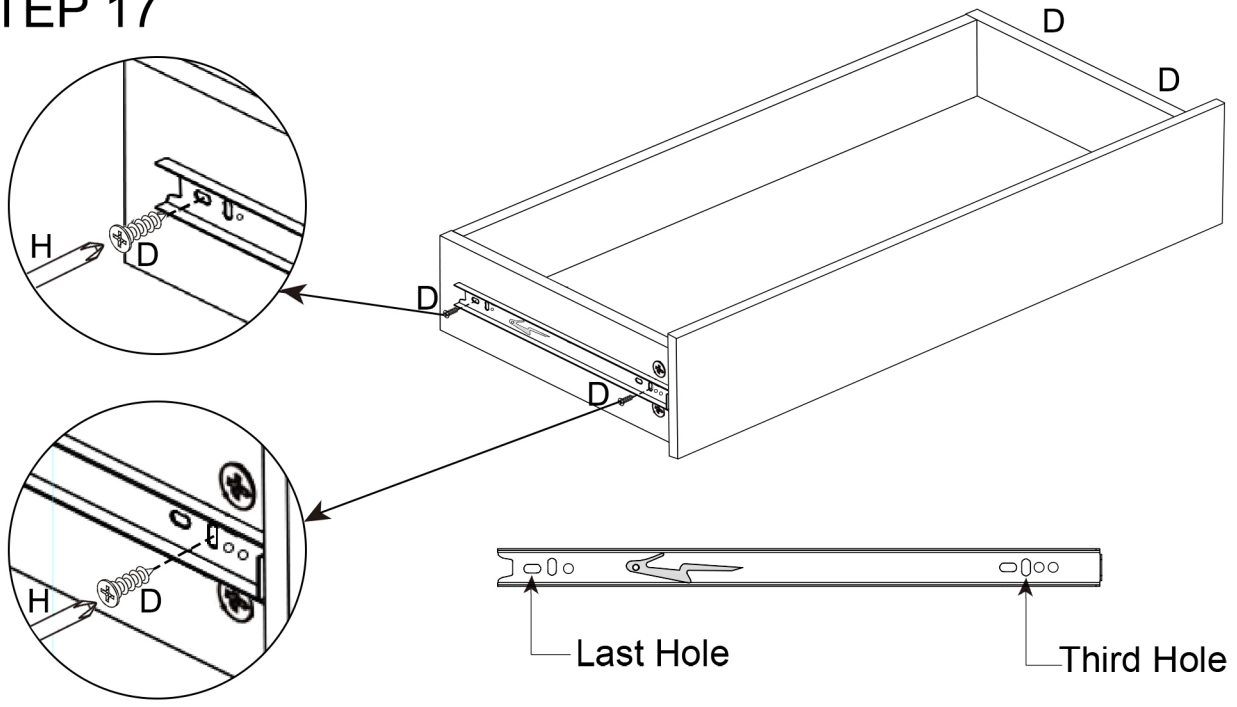

No. D
Quantity: 4Pcs
Screw M3.5*14mm



No. H
Quantity: 1Pc
Allen Key



STEP 18

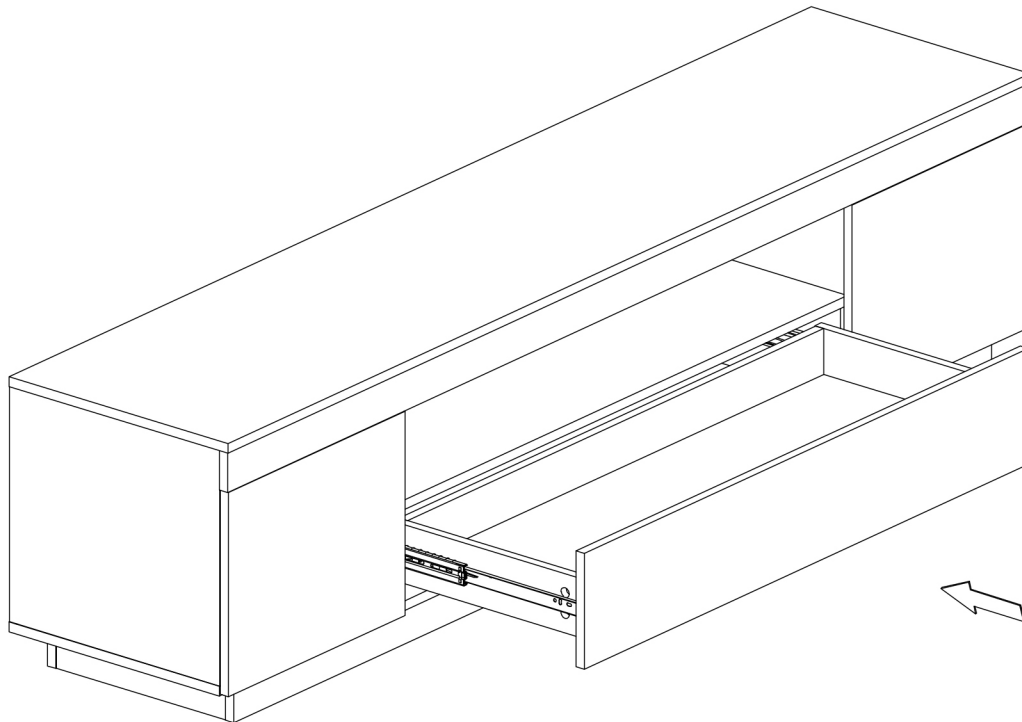

STEP 19

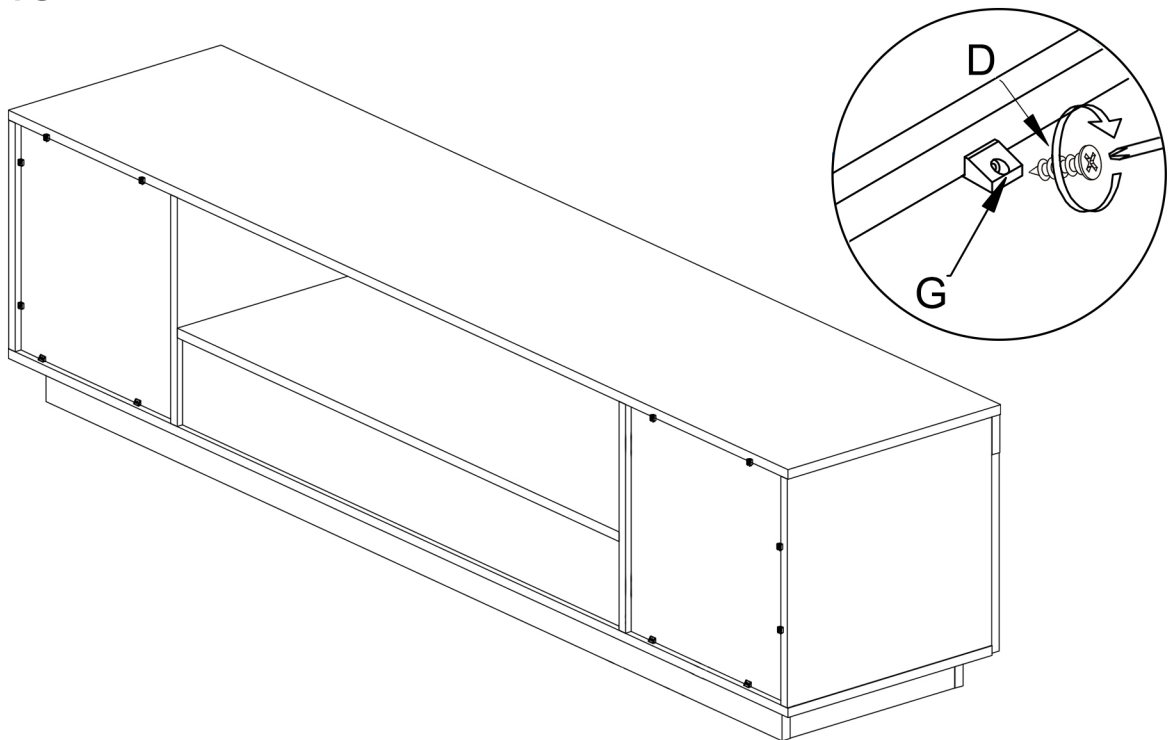

No. D
Quantity: 12Pcs
Screw M3.5*14mm



No. G
Quantity: 12Pcs
Back Plate Clamp



No. H
Quantity: 1Pc
Allen Key



STEP 20

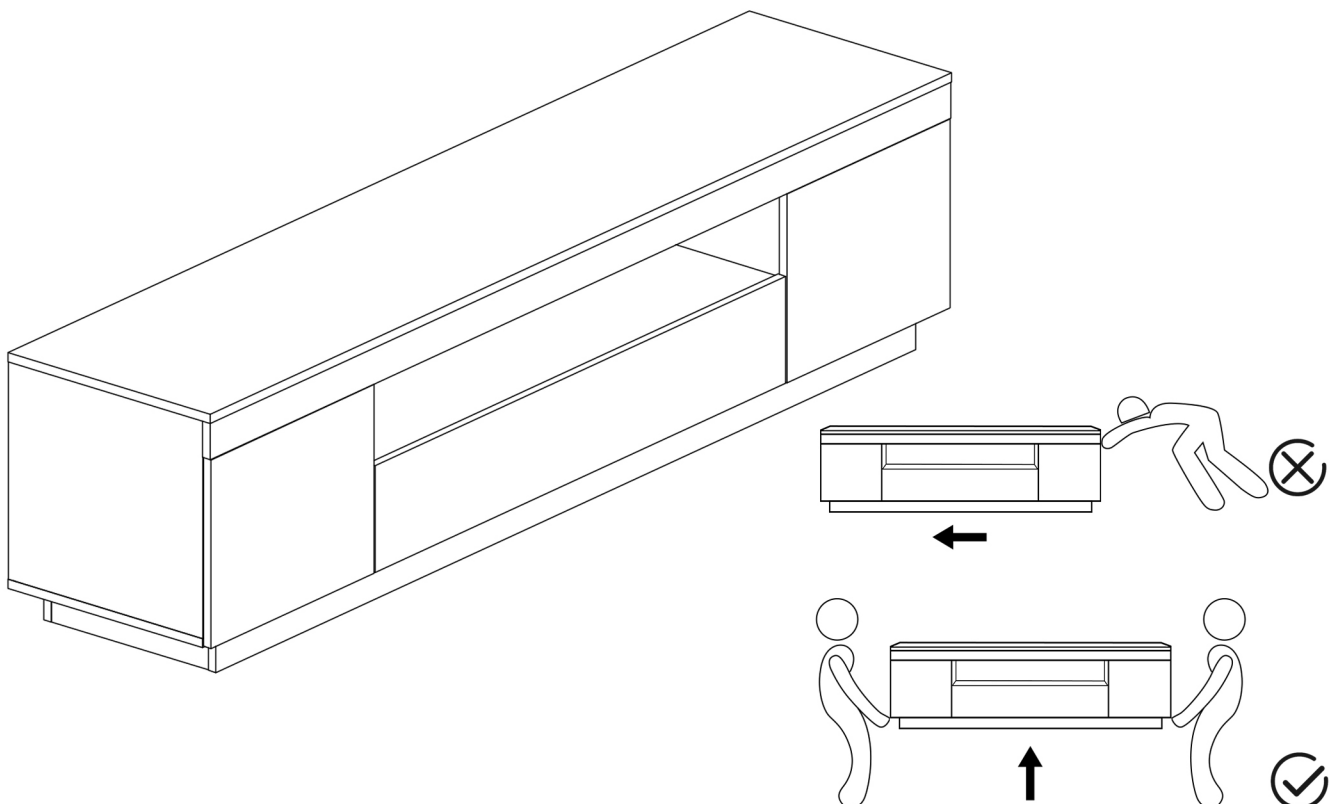

lifely.com.au

Great Job, You're done!

Don't forget to share how it looks in
your space and tag us on Instagram.

[@lifelyhome#homewithlifely!](#)