

For more information visit <https://broncbustertx.com/>

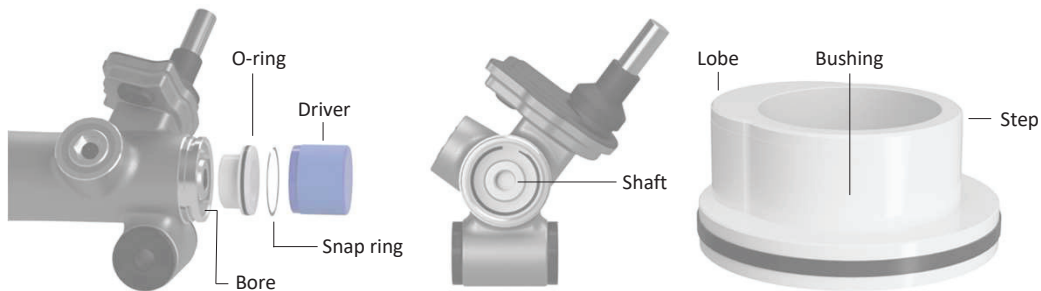

1. Remove the driver's side tie rod assembly according to the manufacturer's recommendations.
2. Remove the boot from the rack and pinion housing.
3. Turn the steering wheel fully to the right so that the steering rack (shaft) retracts into the (bore).
4. Remove the black plastic retainer from the inner bore and discard.
5. Lubricate the bushing (O-ring) and inner tapered portion of the (bore).
6. Align the (lobe) portion of the Bronc bushing with the housing and insert into the bore by hand, making sure to engage the $.100'' / 2.5 \text{ mm}$ (step) of the bushing into the housing. The (lobe) should be oriented to the 10 o'clock position with the part number facing out.
7. Using the blue installation (driver), tap the bushing slightly into the bore about $.125'' / 7 \text{ mm}$.
8. Using the rack shaft as an alignment guide, drive the bushing in using the blue installation driver.
9. Install the (snap ring) and make sure that it is seated into the bore. Use the installation driver if necessary.
10. Reinstall the tie rod assembly according to the manufacture's recommendations.



For more information visit <https://broncbustertx.com/>



1. Remove the driver's side tie rod assembly according to the manufacturer's recommendations.
2. Remove the boot from the rack and pinion housing.
3. Turn the steering wheel fully to the right so that the steering rack (shaft) retracts into the (bore).
4. Remove the black plastic retainer from the inner bore and discard.
5. Lubricate the bushing (O-ring) and inner tapered portion of the (bore).
6. Align the (lobe) portion of the Bronc bushing with the housing and insert into the bore by hand, making sure to engage the $.100'' / 2.5 \text{ mm}$ (step) of the bushing into the housing. The (lobe) should be oriented to the 10 o'clock position with the part number facing out.
7. Using the blue installation (driver), tap the bushing slightly into the bore about $.125'' / 7 \text{ mm}$.
8. Using the rack shaft as an alignment guide, drive the bushing in using the blue installation driver.
9. Install the (snap ring) and make sure that it is seated into the bore. Use the installation driver if necessary.
10. Reinstall the tie rod assembly according to the manufacture's recommendations.

