

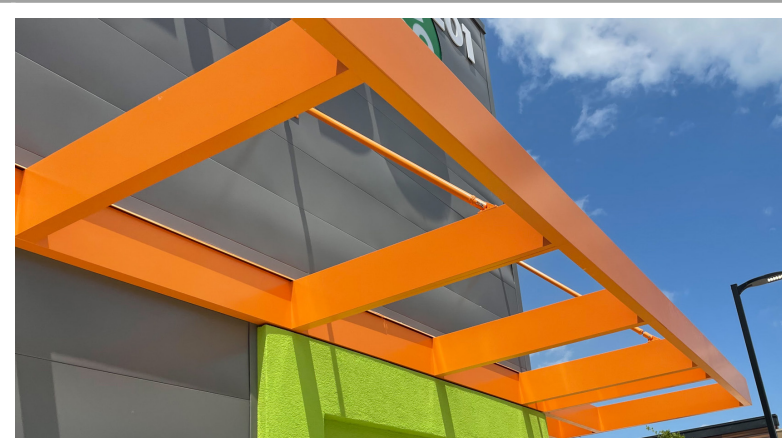

PHOENIX

CANOPY SYSTEM

The Phoenix Trellis is our beautifully designed open frame canopy system that provides sun and rain protection with optional in-fill panels. This trellis gives any building an ultra-modern look. With a powder coated finish and all aluminum construction, there are many ways to configure this product. The Phoenix Trellis system is easy to install and can be field fitted if necessary. Phoenix systems are available with an 8", 10" and 12" flat or open channel face.

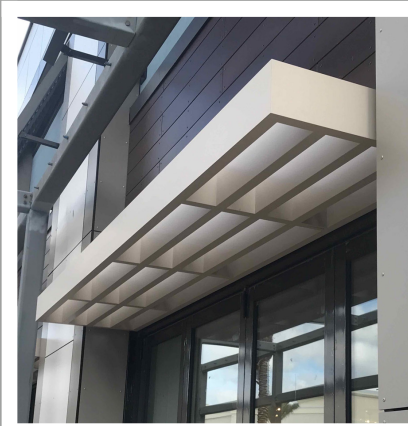

TIE-BACK OPTIONS

- Projection: up to 72"
- Frame Width: 48" - 176"
- Tie-Back Spacing: 88"
- Tie-Back Height: Flexible

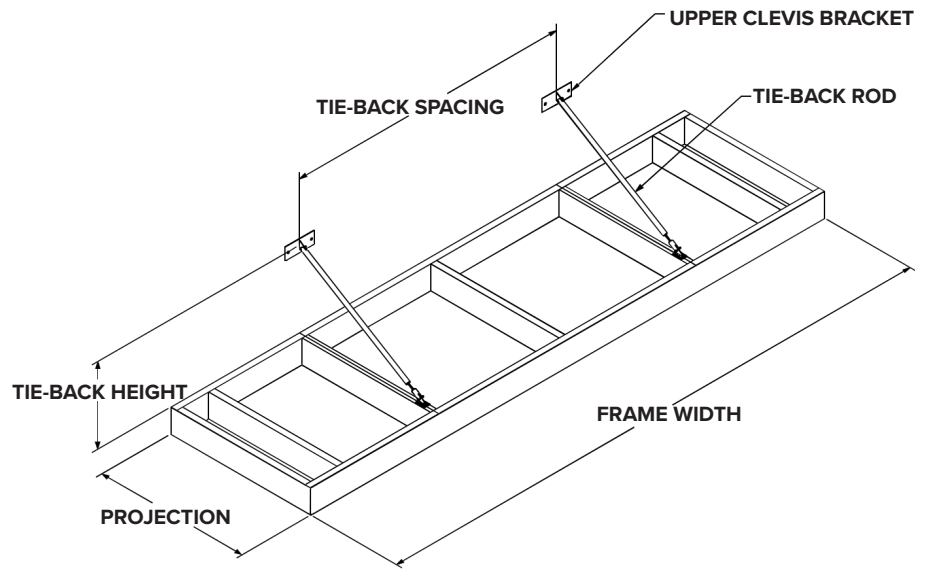

CANTILEVERED OPTIONS

- Projection: up to 48"
- Frame Width: 48" - 176"
- Outrigger arm spacing: 70"

HIGH WIND/SNOW LOAD

- Capable of high wind and high snow loads

IN-FILL PANELS

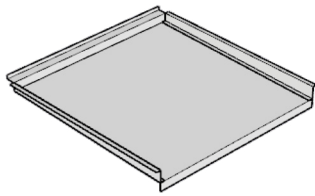

RAIN PAN

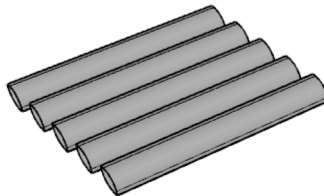

SUN SHADE

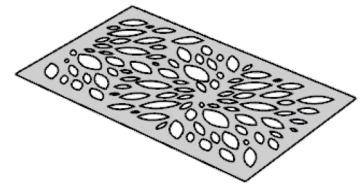

DECORATIVE PAN

FACE OPTIONS

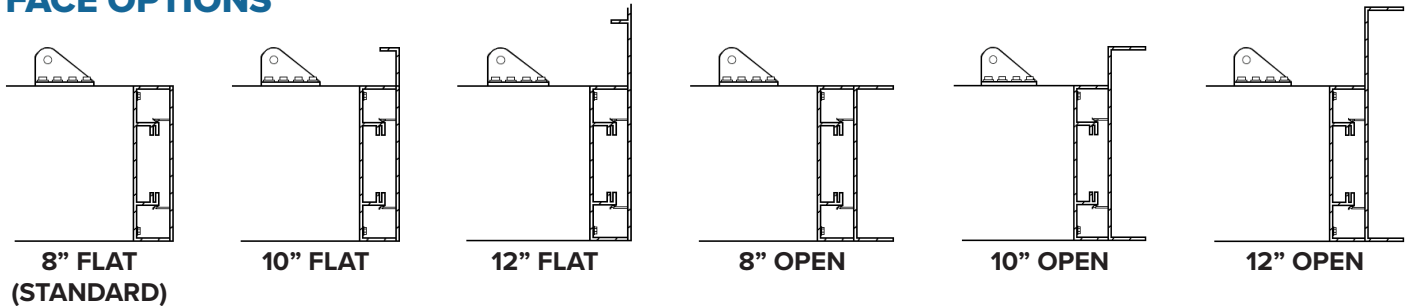

PHOENIX CONFIGURATIONS



PHOENIX WITH RAIN PAN



PHOENIX WITH SUN SHADE



LIGHTING OPTIONS

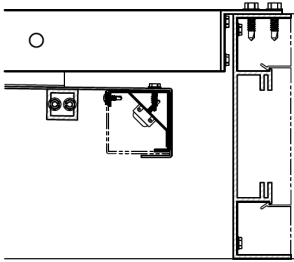

RAIN PAN STRIP LIGHTING

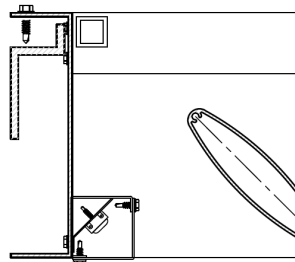

AIR FOIL WITH REAR STRIP LIGHTING

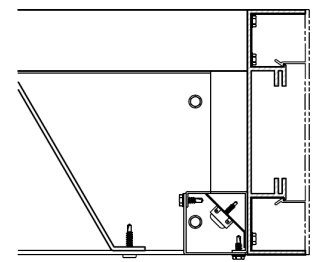

Z-BLADE WITH FRONT STRIP LIGHTING

BLOCKING EXAMPLE

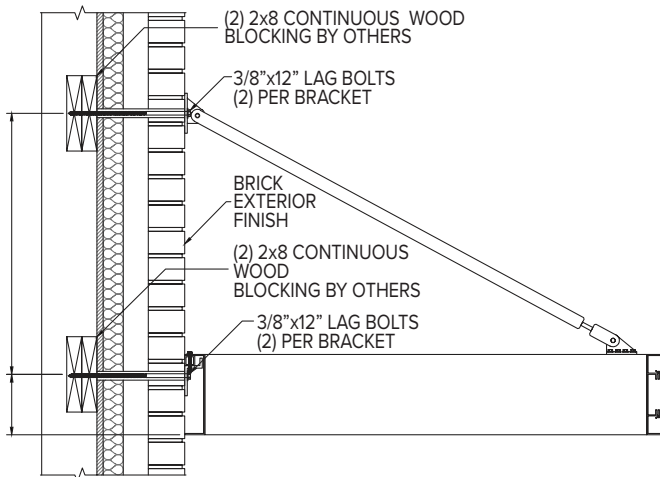

BRICK WITH INSULATION OVER WOOD BLOCKING

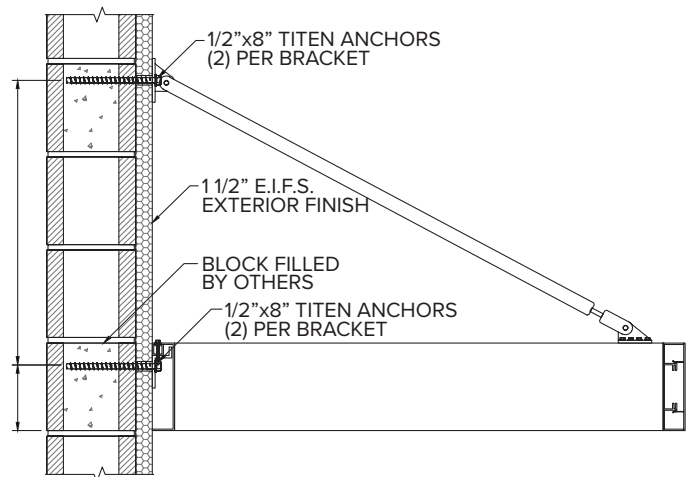

E.F.I.S. OVER CMU BLOCK WALL

*Blocking details for other wall types are available upon request

CANTILEVERED OPTION

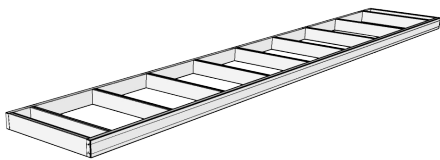

STANDARD VIEW

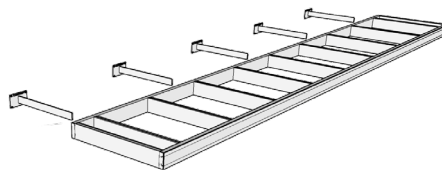

EXPLODED VIEW

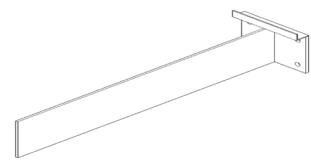

FLAT BAR CANTILEVERED BRACKET

Made out of steel construction and can support up to a 48" projection. Max spacing is 60" between 2 cantilevered brackets.

***Lighting is not available for cantilevered options.**