

## Space Maintainer Kit Refills

Refilling your kit is easy! Orders can be placed online at [www.denovodental.com](http://www.denovodental.com) or over the phone by calling (800) 854-7949.

Space Maintainer Bands and Crowns are sold individually to easily refill the sizes from your kit that you use most.

Have additional questions about product or re-orders? Contact our Customer Representative team: (626) 604-6103

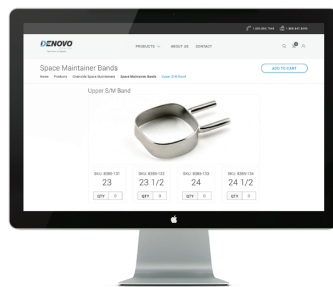

All Denovo products available to order at [www.denovodental.com](http://www.denovodental.com)

### SPACE MAINTAINER BANDS & CROWNS

Bands and Crowns are sold individually by size:



#### Space Maintainer Band Refills

TYPE:	SIZE:
MAXILLARY	23-42
MANDIBULAR	23-42

#### Space Maintainer Crown Refills

TYPE:	SIZE:
1ST PRIMARY	1-7, by Quadrant
2ND PRIMARY	1-7, by Quadrant

### SPACE MAINTAINER WIRES

Wires are sold separately in boxes of 10, specified by size: Narrow or Wide:



#### Plain Wires

NARROW	383-001
WIDE	383-003

#### Occlusal Rest Wires

NARROW	384-001
WIDE	384-003

#### Drop Wires

NARROW	380-001
WIDE	380-003

#### Distal Shoe Wires

NARROW	381-001
WIDE	381-003

# DENOVO®

 [denovodental.com](http://denovodental.com)

ISO  
Certified

CE  
Certified

FDA  
Registered

Autoclavable

Surgical  
Stainless Steel

★  
Made in  
the USA



## Chairside Space Maintainer System Application Procedures

**FREE Ground Shipping on Orders Over \$300**

Continental US only, certain restrictions apply, see website for full details

 [denovodental.com](http://denovodental.com)

 1.800.854.7949

 1.800.847.8599

 [info@denovodental.com](mailto:info@denovodental.com)

CE  
2195

Denovo Dental Inc.  
5130 Commerce Dr.  
Baldwin Park, CA, USA

EC REP  
KinderDent, Gutenbergstrasse 7  
D - 28844 Weyhe, Germany

 Denovo Space Maintainers are made from surgical grade stainless steel, which contains nickel (9.58%). Nickel has been shown to cause allergic reactions in some patients.

 Do not reuse. Appliances are designed and priced to be disposable. If appliance is used for a trial fit only, sterilize for future use.

 Aspiration/Ingestion possibility. Use rubber dam on installation and educate patient to avoid hard or chewy substances which could dislodge appliance.

Denovo products are sold clean but not sterile; sterilization prior to use is recommended for patients with compromised immune systems.

REV | 4 |



Responsibly Printed  
& Packaged

Made and assembled in the USA  
DENOVO Dental Inc, Baldwin Park, CA 91706



## Space Maintainer Band & Crown Application

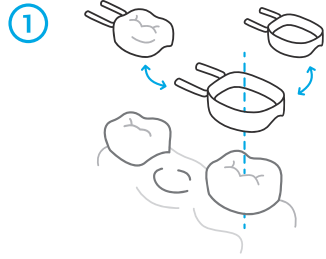

**TRIAL FIT:** Select an approximate band or crown and trial fit to tooth. A properly seated band will be difficult to dislodge or push gingivally. Do not apply pressure to the space maintainer tube section.

If trial fit is incorrect, *sterilize the band for future use\**.

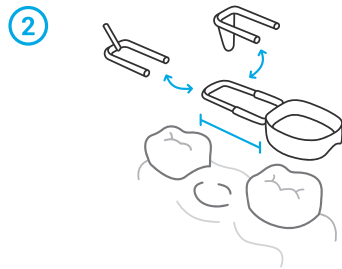

**INSERT WIRE & ADJUST LENGTH:** Choose a Space Maintainer wire and insert into pre-welded tubes. Trial fit assembly in mouth & slide wire to desired length.

**NOTE:** There are two widths for each wire, narrow and wide, which correspond with the smaller and larger band and crown sizes. The insert trays in this kit have color-coded sizes on each well to indicate which bands or crowns require which sizes: **Green = Narrow**, and **Blue = Wide**.

If the wire is too long, trim the wire with Denovo Wire Shears or any ortho cutter. In applications involving very small spaces, the tube can be trimmed using a slow-speed hand piece and diamond disk.



With the Denovo Tube Crimping Plier, lightly crimp tube over wire to hold the position.



**CRIMP:** Remove the appliance from mouth. Crimp both tubes firmly, making sure the crimps are over the inserted wire. Check appliance for stability. Wire should not move. More than one crimp may be made on each tube.

**SEAT:** Re-seat appliance on the tooth. The entire appliance should be free of occlusal contact with the opposing arch. Cement band or crown with your preferred glass ionomer.

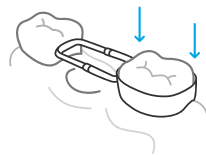

## Space Maintainer Wire Types & Application

### Plain Wires

Highly customizable, with the ability to adapt to most clinical situations.



### Drop Wires

Used to seat against an erupted permanent tooth after the loss of a primary second molar (application details below).



### Occlusal Rest Wires

Provides more stability, support and strength to the appliance by bending the occlusal wire over the occlusal ridge (application details below).



### Distal Shoe Wires

Used to seat sub-gingivally when a patient's 2nd Primary Molar has been lost prematurely and the 1st Permanent Molar hasn't erupted yet (application details below).

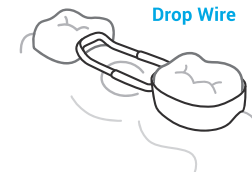

**USING THE DROP WIRE:** A drop wire can be used when the patient's permanent tooth has erupted, and they've already lost their primary second molar. A straight wire could potentially go down into the gum-line. A better option is to use the curved drop wire, which meets the mid-crown surface of the adjacent tooth.

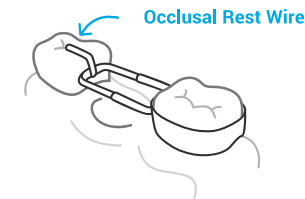

**USING THE OCCLUSAL REST:** An occlusal rest wire can be used for added strength of the appliance. The occlusal rest is seated in a groove cut into the distal marginal ridge of the tooth adjacent to the space. For added stability, a small amount of cement may be placed over the occlusal rest after seating.

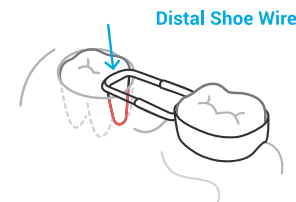

**USING THE DISTAL SHOE:** The distal shoe provides support when the opposing tooth has yet to erupt. If used after extraction, the distal shoe is placed down the distal wall of the extracted socket. If used on a healed edentulous space an incision is made with a sterile scalpel. The position of the incision should be determined by examining x-rays of the area. Prior to cementation, x-ray the appliance in the mouth to insure proper fit.

\* Used parts that are to be re-used need to be cleaned, disinfected, and sterilized prior to next use. Automatic procedures for washer/disinfecting unit and the sterilizing unit should be used when possible.

To see an in-depth Chairside Space Maintainer application demonstration video, visit: [www.denodontal.com/resources](http://www.denodontal.com/resources)

Have any additional questions about application? Talk to the experts!  
1 (800) 854-7949