

90 Series

Exit Device



Table of Contents

90 Series Exit Devices

SARGENT®

ASSA ABLOY

Features, Applications and UL Fire Door Ratings	3
9800 Series Rim Exit Device	4
9800 Functions and Trims	5
9700 Series Surface Vertical Rod Exit Device	6
9700 Functions and Trims	7
9900 Series Mortise Lock Exit Device	8
9900 Functions and Trims	9
9400 Series Narrow Stile Concealed Vertical Rod Exit Device	10
9898 Reversible Rim Exit and Trim for the 9898 Rim Exit Device	11
ET Trim, Levers and Pulls	12
Studio Collection Levers	13-14
Ordering Gramercy Series Levers	15
Coastal Series Levers and Thumb Piece Pulls	16
Electromechanical Functions and Accessories	17
Mullions: Aluminum, Steel and Electrified	18
Mullion Accessories, Stabilizers and Door Coordinators	19
Mechanical Options and Descriptions	20
Cylinder Options and Descriptions	21-22
How to Order	23
Finishes and Finish Care	24

MicroShield®

ASSA ABLOY Group companies offer MicroShield®, an antimicrobial coating for door hardware. MicroShield uses proven silver ion-based technology from Agion®, a leading provider of antimicrobial solutions, to stem the spread of bacteria and other microbes.

MicroShield® is a registered trademark of ASSA ABLOY Access and Egress Hardware Group, Inc.



The Agion antimicrobial is not intended as a substitute for good hygiene. Coated products must still be cleaned to ensure the surfaces will be free of destructive microbes.

ASSA ABLOY makes no representations or warranties, express or implied, as to the efficacy of the Agion antimicrobial. A copy of the Agion warranty is available upon request. Agion is a registered trademark of Agion Technologies, Inc., Wakefield, MA, USA.

EcoFlex®



- Reduces energy consumption up to 95% for exit trim, as certified by Green Circle, which lowers operating costs; assists with load reduction in optimizing energy performance credit in LEED, and reduces the number of power supplies requires.
- Field configurable to fail-safe or fail-secure, and operates from 12-24VDC, offering greater flexibility in system design.
- Innovative actuator design provides superior reliability through higher performance and reduced maintenance; the ability to have longer cable runs without negatively impacting lock function. It reduces the risk of voltage drops and eliminates inductive kickback, and lowers the total cost of owner ship.

Copyright © 2006-2021, Sargent Manufacturing Company, an ASSA ABLOY Group company. All rights reserved. Reproduction in whole or in part without the express written permission of Sargent Manufacturing Company is prohibited.

Features, Applications and UL Fire Door Ratings

90 Series Exit Devices

Features

- Full line of exit devices offering a selection of both wide and narrow stile exit devices, including concealed and surface vertical rods, rim and mortise
- Maximum 4-1/2" (114mm) projection, minimum 2-3/4" (70mm) dogged
- All SARGENT exit devices can be masterkeyed or grand masterkeyed with any other SARGENT product
- All crossbar assemblies are brass, bronze, stainless steel, or steel (see specific device)
- Stainless steel springs throughout
- Trim is through-bolted
- UL Listed
- UL Listed to Canadian safety standards
- All fire exit hardware for hollow metal door applications listed up to 3 hours (A label) (Double doors require astragal)
- All fire exit hardware for wood door applications listed up to 1-1/2 hour (B label) except where noted

Applications

Single Door

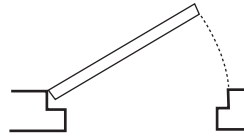

Rim Type 9800
Surface application.

Pairs of Doors without Mullion

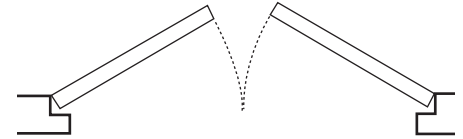

Surface Vertical Rod Type 9700 or Concealed Vertical Rod Type 9400 - 2 Each
2 point locking both doors. Each door active. Do not use an overlapping astragal.

Pairs of Doors with 980 Mullion

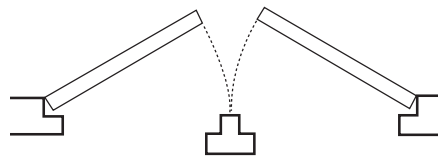

Rim Type 9800 - 2 Each
980 Mullion - 1 Each
Two independent active doors with full double door opening when required.

Pairs of Doors without Mullion

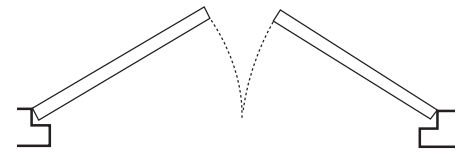

Vertical Rod Type 9700 - 1 Each
Rim Type 9800 - 1 Each
Both devices are surface applied. A coordinator is recommended.

● = Available				UL Fire Door Rating				
Application	Type Of Device	Series Device	Maximum Door Opening	(A) 3 Hour	(B) 1-1/2 Hour	(C) 3/4 Hour	(D) 1-1/2 Hour	(E) 3/4 Hour
Single Doors	Mortise	12-9900	4'0" X 10'0" (1219 X 3048)	●	●	●	●	●
	Rim	12-9800 **	4'0" X 8'0" (1219 X 2438)	●	●	●	●	●
	Concealed	12-9400	4'0" x 7'2" (1219 X 2184)	●	●	●	●	●
Pair of Doors Swinging in the same direction	Mortise and Surface Vertical Rod	12-9900 X 12-9700	8'0" X 8'0" (2438 X 2438)	●	●	●	●	●
	Two Rim With Mullion (12-980 available)	12-9800 X 12-9800	8'0" X 8'0" (2438 X 2438)	●	●	●	●	●
	*Two Surface Vertical Rod No astragal No coordinator	12-9700 X 12-9700	8'0" X 8'0" (2438 X 2438)		●	●	●	●
	Two Concealed Vertical Rod No overlapping astragal	12-9400 X 12-9400	8'0" x 7'2" (2438 X 2184)		●	●	●	●
Double Egress Pair of Doors Swinging in opposite directions	*Two Surface Vertical Rod	12-9700 X 12-9700	8'0" X 8'0" (2438 X 2438)	●	●	●	●	●
	*Two Concealed Vertical Rod	12-9400	8'0" X 7'2" (2438 X 2184)	●	●	●	●	●

* Limited for Fire Doors listed by UL for this use. NFPA requires an astragal on 3 hour applications

** 75 and 76 functions are not available with 12- fire rated 9800 devices

Vertical rod applications will not work with astragal

Note: Please contact door manufacturer for specifications regarding fire door construction

Any retrofit or other field modification to a fire rated opening can potentially impact the fire rating of the opening, and Sargent Manufacturing Company makes no representations or warranties concerning what such impact may be in any specific situation. When retrofitting any portion of an existing fire rated opening, or specifying and installing a new fire-rated opening, please consult with a code specialist or local code official (Authority Having Jurisdiction) to ensure compliance with all applicable codes and ratings.

Experience a safer
and more open world

9900 Series Mortise Lock Exit Device

90 Series Exit Devices

SARGENT®

ASSA ABLOY



9900 Mortise Lock Exit Device

The 9900 Series exit devices are ordered with trim and shipped complete with the strike, screw packs and cylinder as required in one carton. The cross bars are cut to the correct length, based on door width.

Specifications

For Doors	Wood or metal. 1-3/4" (44.5mm) thick standard. Other door thickness, consult factory. 4-1/2" (114mm) minimum stile
Mounting	Supplied standard with wood and machine screws. Through-bolts available on order.
Chassis Cover	Brass, bronze or stainless steel
Chassis	Nonferrous alloy
Crossbar	1" brass, bronze and stainless steel tubing. Specify 42- for reinforced cross bar.
Hand	Handed, please specify hand when ordering
Mortise Lock	900 Series Mortise Lock, non-reversible
Dogging	Standard Allen key dogging (Not available on fire rated devices)
Strike	C908 standard for panic and fire rated
Fire Exit Hardware	See chart page 3
Certification/Compliance	ANSI/BHMA156.3 - 2014 Grade 1
ANSI	

Copyright © 2006-2021, Sargent Manufacturing Company, an ASSA ABLOY Group company. All rights reserved. Reproduction in whole or in part without the express written permission of Sargent Manufacturing Company is prohibited.

C908 Strike

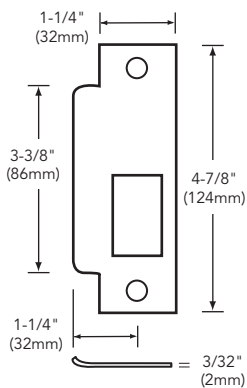

- Curved lip ANSI A115.1
- Handed. 1-1/4" lip standard
- Longer, lips in increments of 1/4" through 2-7/8" available
- Black nylon coated

815 Open Back Strike

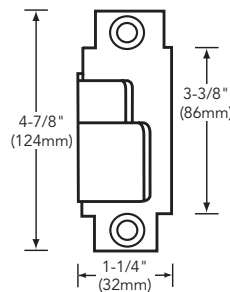

- ANSI A115.14 Open Back
- Beveled 1/8" in 2"
- Specify hand of active door
- "B" label
- Required for pairs of doors with 9700 and 9900 on pair
- Black nylon coated

Single Door

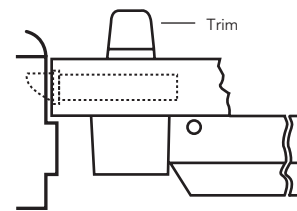

Pair of Doors

