

# Auxiliary Locks

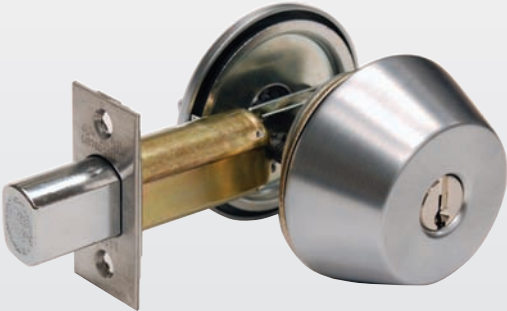

# Table of Contents

## Auxiliary Locks

SSL1 Spring Latch For Security SideLight Applications . . . . .	3
8200 Series Deadbolt Mortise Locks . . . . .	4
4870 Series Mortise Deadbolts . . . . .	5
480 Series Grade 1 Deadbolts . . . . .	6
470 Series Grade 2 Deadbolts . . . . .	7
Padlocks . . . . .	8
Cabinet Locks . . . . .	9
Cylinder Options . . . . .	10-12

### MicroShield®

As part of their promise to provide innovative solutions to their customers, certain ASSA ABLOY Group brands offer the MicroShield® technology, a silver-based antimicrobial coating designed to inhibit the growth of bacteria. MicroShield® is a registered trademark of ASSA ABLOY Access and Egress Hardware Group, Inc.

### MicroShield® Coating

- Revolutionary finish coating available on all SARGENT product lines, utilizes a silver-based antimicrobial compound from Agion Technologies
- As an integral part of the finish coating, MicroShield® lasts for the life of the hardware
- MicroShield® coating permanently suppresses the growth of bacteria, algae, fungus, mold and mildew. It is effective against a broad spectrum of bacteria.
- Non-toxic and completely safe. The Agion antimicrobial compound is EPA and NSF approved and FDA listed for use in medical and food preparation equipment.
- Applications: Anywhere there is need for a clean environment (hospitals, laboratories, schools, medical centers, daycare, food processing etc.)



The Agion antimicrobial is not intended as a substitute for good hygiene. Coated products must still be cleaned to ensure the surfaces will be free of destructive microbes. ASSA ABLOY makes no representations or warranties, express or implied, as to the efficacy of the Agion antimicrobial. A copy of the Agion warranty is available upon request. Agion is a registered trademark of Agion Technologies, Inc., Wakefield, MA, USA.

# 4870 Series Deadbolts

## Auxiliary Locks

### Specifications

For Doors	Door thickness 1-3/4" (44mm) standard (For thicker doors, consult factory)
Backset	2-3/4" (70mm) only
Strike	# 480 Strike Standard: 3-1/2" (89mm) x 1-1/8" (29mm); For Strike Box, specify WBS when ordering
Bolt	Laminated Stacked Steel Deadbolt with Hardened Pin and a 1" throw
Cylinder	Brass 6 pin. Two nickel silver keys per lock (Control key must be ordered separately, when required)
Cylinder Ring	97 Rosette (standard with #41 Cylinder), 1KB rosette optional (specify on order) <b>NOTE:</b> See 8200 Mortise Lock catalog for details on cylinder collar kit.
Case	Heavy wrought steel, .093 thick, protected with a zinc dichromate finish
Outside	Brass, bronze, stainless steel. 4-5/8" (117mm) x 1-1/8" (29mm) Front Plate Adjustable for flat or beveled doors (bevel adjustment 1/8" (3mm) in 2" (51mm))
Hand	Non handed, field reversible (except for 74-)
Thumb Turn	130W ADA Thumb turn (standard); optional larger thumb turn (specify LB-)
UL/cUL Listed	4870 series deadlocks, when used in conjunction with the primary latching device, are UL/cUL listed for use on fire doors having a rating up to and including 3 hours. In addition, the 4870 series are cUL listed for use on wood doors having a rating up to and including 90 minutes.
Mechanical Options	Cylinder Options see pages 11-12 28- 7710 Flat Lip Strike 4-7/8" (124mm) x 1-1/4" (32mm) ANSI A115-1 36- Torx® security screws 37- Spanner head security screws 74- Lock case wrapped in lead (specify hand) LB- Larger size ADA thumbturn SG- MicroShield® antimicrobial clear powder coat (only available with 32D) WBS- Wrought Box Strike
Finishes	03, 04, 09, 10, 10B, 10BE, 10BL, 14, 15, 20D, 26, 26D, 32, 32D, BSP, WSP



4870 Series Deadlock

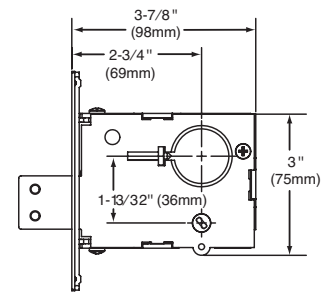

Any retrofit or other field modification to a fire rated opening can potentially impact the fire rating of the opening, and Sargent Manufacturing Company makes no representations or warranties concerning what such impact may be in any specific situation. When retrofitting any portion of an existing fire rated opening, or specifying and installing a new fire-rated opening, please consult with a code specialist or local code official (Authority Having Jurisdiction) to ensure compliance with all applicable codes and ratings.

### How To Order

10-28-	4874	26D
Options	Series x Function	Finish
Mechanical Options this page	4874	03, 04, 09, 10, 10B, 10BE, 10BL, 14, 15, 20D, 26, 26D, 32, 32D, BSP, WSP
Cylinder Options page 11-12	4875	
	4876	
	4877	
	4878	
	4879	

480 Strike ANSI A115.5 (Standard)

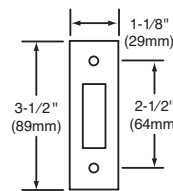

7710 Strike (28- Option)

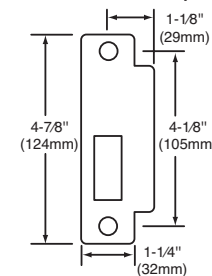

7730 Strike (Ordered separately)

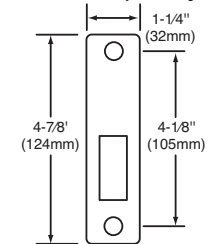

### Functions

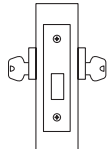
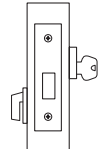
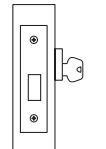
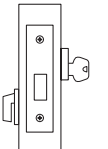
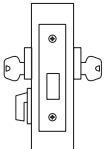
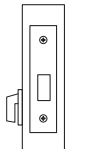
4874 Double Cylinder	4875 Single Cylinder x Turn Lever	4876 Single Cylinder	4877 Classroom x Turn Lever	4878 Public Toilet	4879 Exit Lock
 <ul style="list-style-type: none"> <li>• Key from either side operates deadbolt</li> <li>• <b>ANSI E06061</b></li> </ul>	 <ul style="list-style-type: none"> <li>• Key outside operates deadbolt</li> <li>• Thumb turn inside operates deadbolt</li> <li>• <b>ANSI E06071</b></li> </ul>	 <ul style="list-style-type: none"> <li>• Key outside operates deadbolt</li> <li>• No inside operation</li> <li>• <b>ANSI E06081</b></li> </ul>	 <ul style="list-style-type: none"> <li>• Key outside operates deadbolt</li> <li>• Thumb turn inside retracts deadbolt, but will not project it</li> <li>• <b>ANSI E06091</b></li> </ul>	 <ul style="list-style-type: none"> <li>• Key from either side operates deadbolt</li> <li>• Thumb turn inside retracts deadbolt, but will not project it</li> </ul>	 <ul style="list-style-type: none"> <li>• Thumb turn inside operates deadbolt</li> <li>• No outside operation</li> </ul>

\*\*\* For use only on rooms with more than one exit

Experience a safer and more open world

# Cylinder Options by Product Line

## Auxiliary Locks

Cylinder Type	Option	Description	8200 & 4870 Dead Bolt	480 Dead Bolt	470 Dead Bolt	758 & 858 Padlocks	856 & 857 Padlocks	1655 Locker Lock	4141-4143 Utility & Cabinet Locks	4152 Utility Locks
Conventional Cylinder	Std	SARGENT Conventional Cylinders	Yes	Yes	Yes	Yes	N/A	N/A	N/A	N/A
Degree Key System	DG1-	SARGENT Degree Key System Level 1	Yes	Yes	Yes	Yes	N/A	N/A	N/A	N/A
	DG1-21-	Degree Level 1 Construction Master Keying	Yes	Yes	Yes	Yes	N/A	N/A	N/A	N/A
	DG1-60-	Degree Level 1 Removable Disposable Construction Core	Yes	Yes	N/A	Yes	N/A	N/A	N/A	N/A
	DG1-63-	Degree Level 1 Removable Core	Yes	Yes	N/A	Yes	N/A	N/A	N/A	N/A
	DG1-64-	Degree Level 1 Removable Construction Keyed LFIC	Yes	Yes	N/A	Yes	N/A	N/A	N/A	N/A
	DG1-65-	Degree Level 1 Unassembled/Uncombined Core	Yes	Yes	N/A	Yes	N/A	N/A	N/A	N/A
	DG2-	SARGENT Degree Key System Level 2	Yes	Yes	Yes	Yes	N/A	N/A	N/A	N/A
	DG2-21-	Degree Level 2 Construction Master Keying	Yes	Yes	Yes	Yes	N/A	N/A	N/A	N/A
	DG2-60-	Degree Level 2 Removable Disposable Construction Core	Yes	Yes	N/A	Yes	N/A	N/A	N/A	N/A
	DG2-63-	Degree Level 2 Removable Core	Yes	Yes	N/A	Yes	N/A	N/A	N/A	N/A
	DG2-64-	Degree Level 2 Removable Construction Keyed LFIC	Yes	Yes	N/A	Yes	N/A	N/A	N/A	N/A
	DG2-65-	Degree Level 2 Unassembled/Uncombined Core	Yes	Yes	N/A	Yes	N/A	N/A	N/A	N/A
	DG3-	SARGENT Degree Key System Level 3	Yes	Yes	Yes	Yes	N/A	N/A	N/A	N/A
	DG3-21-	Degree Level 3 Construction Master Keying	Yes	Yes	Yes	Yes	N/A	N/A	N/A	N/A
	DG3-60-	Degree Level 3 Removable Disposable Construction Core	Yes	Yes	N/A	Yes	N/A	N/A	N/A	N/A
DG3-63-	Degree Level 3 Removable Core	Yes	Yes	N/A	Yes	N/A	N/A	N/A	N/A	
DG3-64-	Degree Level 3 Removable Construction Keyed LFIC	Yes	Yes	N/A	Yes	N/A	N/A	N/A	N/A	
Signature Key System	10-	SARGENT Signature Key System (Not Available with other Key Systems)	Yes	Yes	Yes	Yes	N/A	Yes	N/A	N/A
	10-21-	SARGENT Signature Construction Key System (Lost Ball)	Yes	Yes	Yes	Yes	N/A	Yes	N/A	N/A
Signature: Large Format Interchangeable Core (Removable Core)	10-63-	SARGENT Signature LFIC (Removable Core) Cylinder	Yes	Yes	N/A	Yes	N/A	N/A	N/A	N/A
XC- Key System	11-	XC Key System (Not Available with other Key Systems, Unless specified)	Yes	Yes	Yes	Yes	N/A	Yes	N/A	N/A
	11-21-	XC- Construction Key System (Lost Ball)	Yes	Yes	Yes	Yes	N/A	Yes	Yes	N/A
XC- Large Format Interchangeable Core + (Removable Core)	11-60-	Hardware to accept XC- Permanent LFIC (Removable Core), Disposable plastic Core- provided	Yes	Yes	N/A	Yes	N/A	N/A	N/A	N/A
	11-63-	Hardware provided with XC- LFIC (Removable Core) Cylinder - (Includes masterkeying, grand masterkeying)	Yes	Yes	N/A	Yes	N/A	N/A	N/A	N/A
	11-64-	Hardware provided with Keyed construction core to accept XC- LFIC (Removable) Permanent Core (ordered Separately)	Yes	Yes	N/A	Yes	N/A	N/A	N/A	N/A
XC- Small Format Interchangeable Cores+	11-70-7P-	Hardware to accept XC- SFIC (7 pin) XC- Permanent Cores, plastic disposable core provided	Yes	Yes	N/A	N/A	N/A	N/A	N/A	N/A
	11-72-7P-	Hardware to accept XC- SFIC (7 pin Keyed Construction Core provided) cylinder, Permanent core ordered separately	Yes	Yes	N/A	N/A	N/A	N/A	N/A	N/A
	11-73-7P-	Hardware supplied with XC- Small Format 7 pin interchangeable core (Includes masterkeying, grand masterkeying)	Yes	Yes	N/A	N/A	N/A	N/A	N/A	N/A
	11-65-73-7P-	Hardware to accept XC- Uncombined 7 pin SFIC (Permanent) Core - (Packed Loose)	Yes	Yes	N/A	N/A	N/A	N/A	N/A	N/A
Construction Key Systems	21-	SARGENT Lost Ball Construction Keying for Conventional, XC and Signature Series (N/A with 63-, 73-, 82-, SC- & SE-)	Yes	Yes	Yes	Yes	N/A	Yes	Yes	N/A
	22-	SARGENT Construction Split Key System for Conventional Cylinders (Existing Systems) (N/A with 10-, 11-, 63-, 73-, 82-, SC- & SE-)	Yes	Yes	Yes	Yes	N/A	Yes	Yes	N/A
Old Style Removable Core	51-	Removable Core Cylinder (Old Style) provided (Existing systems only)	Yes	N/A	N/A	Yes	N/A	N/A	N/A	N/A
	52-	Removable Construction Core (Old Style) Permanent core ordered separately ( existing systems only)	Yes	N/A	N/A	Yes	N/A	N/A	N/A	N/A

**NOTE:** For V-10 Cylinder and information, contact ASSA  
**NOTE:** When tying into existing key systems contact Key Records for compatibility  
 + For use in SARGENT hardware ordered to accept XC- option

# Cylinder Options by Product Line

## Auxiliary Locks



Cylinder Type	Option	Description	8200 & 4870 Deadbolt	480 Dead Bolt	470 Dead Bolt	758 & 858 Padlocks	856 & 857 Padlocks	1655 Cabinet Lock	4141-4143 Cabinet Locks	4152, 4153, 4253 Locks
Large Format Interchangeable Core (Removable Core)	60-	Hardware to accept Permanent LFIC (Removable Core), Disposable plastic Core provided (Permanent Cores Ordered Separately)	Yes	Yes	N/A	Yes	N/A	N/A	N/A	N/A
	63-	6 pin LFIC permanent core provided	Yes	Yes	N/A	Yes	N/A	N/A	N/A	N/A
	64-	Hardware supplied with Keyed LFIC construction core to accept Permanent LFIC Core (ordered Separately)	Yes	Yes	N/A	Yes	N/A	N/A	N/A	N/A
Small Format Interchangeable Cores	70-	Hardware to accept 6 or 7 Pin SFIC Permanent Cores (ordered separately), plastic disposable core provided	Yes	Yes	N/A	N/A	N/A	N/A	N/A	N/A
	72-	Hardware to accept 6 or 7 Pin SFIC supplied with Keyed Construction Core. (Permanent Core Ordered separately)	Yes	Yes	N/A	N/A	N/A	N/A	N/A	N/A
	73-	Hardware supplied with 6 pin SFIC (Includes masterkeying, grand masterkeying)	Yes	Yes	N/A	N/A	N/A	N/A	N/A	N/A
	65-73-	Hardware provided to accept Uncombined 6 pin SFIC (Permanent) Core - (Packed Loose for field keying)	Yes	Yes	N/A	N/A	N/A	N/A	N/A	N/A
	65-73-7P-	Hardware provided to accept Uncombined 7 pin SFIC (Permanent) Core - (Packed Loose for field keying)	Yes	Yes	N/A	N/A	N/A	N/A	N/A	N/A
	73-7P-	Hardware supplied with Small Format 7 Pin Interchangeable Core (Includes masterkeying, grand masterkeying)	Yes	Yes	N/A	N/A	N/A	N/A	N/A	N/A
Keso F1 & Keso	81-	Hardware provided with housings to accept Keso (83) & Keso F1 (F1-83-) removable cores. (Permanent Cores Ordered Separately)	Yes	N/A	N/A	N/A	N/A	N/A	N/A	Std.
	82-	Hardware provided with standard Keso Security Cylinder	Yes	N/A	N/A	N/A	Std	N/A	N/A	N/A
	F1-82-	Hardware provided with standard Keso F1 Security Cylinder (Patented)	Yes	N/A	N/A	N/A	Specify F1-	N/A	N/A	Specify F1-
	83-	Hardware supplied with SARGENT Keso Security Removable Core cylinder	Yes	N/A	N/A	N/A	N/A	N/A	N/A	N/A
	F1-83-	Hardware supplied with SARGENT Keso F1 Security Removable Core cylinder (Patented)	Yes	N/A	N/A	N/A	N/A	N/A	N/A	N/A
	84-	Hardware provided with SARGENT Keso Construction Cores (Permanent Removable Cores ordered separately)	Yes	N/A	N/A	N/A	N/A	N/A	N/A	N/A
Bump Resistant	BR-	Bump Resistant Cylinder (Available with Conventional & Conventional XC Cylinders Only)	Yes	Yes	Yes	Yes	N/A	N/A	N/A	N/A
Less Cylinder	LC-	Less Cylinder	Yes	Yes	Yes	N/A	N/A	N/A	N/A	N/A
Schlage Keyways	SC-	Schlage C keyway cylinder, 0 bitted	Yes	Yes	Yes	Yes	N/A	N/A	N/A	N/A
	SE-	Schlage E keyway cylinder, 0 bitted	Yes	Yes	Yes	Yes	N/A	N/A	N/A	N/A

**NOTE:** For V-10 Cylinder and information, contact ASSA

**NOTE:** When tying into existing key systems contact Key Records for compatibility

+ For use in SARGENT hardware ordered to accept XC- option

Copyright © 2007-2021, SARGENT Manufacturing Company. All rights reserved. Reproduction in whole or in part without the express written permission of SARGENT Manufacturing Company is prohibited. Patent pending and/or patent www.assaabloydss.com/patents.

# Finishes

## Auxiliary Locks

### Finishes

Standard Levers and Knobs	Description
03	Polished brass, clear coated
04	Satin brass, clear coated
09	Polished bronze, clear coated
10	Satin bronze, clear coated
10B	Oxidized bronze, oil rubbed
10BE	oxidized satin bronze, equivalent
10BL	Oxidized satin, bronze, clear coated
14	Polished nickel, clear coated
15	Satin nickel, clear coated
20D	Statuary dark bronze, clear coated
26	Polished chrome
26D	Satin chrome
32	Polished stainless steel
32D	Satin stainless steel
BSP	Black Suede Powder Coat
WSP	White Suede Powder Coat