

R25/RETAILER SPRING ASSIST INSTALLATION INSTRUCTIONS

STEP 1) EXISTING DOOR REMOVAL

IMPORTANT: THIS SPRING ASSIST ASSEMBLY WILL ONLY OPERATE CORRECTLY WITH THE STAINLESS STEEL LOWER HINGE GUARD. YOU MUST REPLACE YOUR ALUMINUM LOWER HINGE GUARD WITH THE STAINLESS STEEL PART BEFORE YOU PROCEED! IF YOU DO NOT HAVE A STAINLESS STEEL LOWER HINGE GUARD "DO NOT PROCEED", CONTACT OUR FACTORY IMMEDIATELY!

Follow the "R25 INSTALLATION INSTRUCTIONS" in reverse order for door removal. We have provided a set of instructions for you. It is recommended that 2 persons remove the door to prevent personal injury and/or property damage.

STEP 2) LOADING SPRING ASSEMBLY

Refer to Figure 1 and Figure 2. Place components in the exact orientation and order as shown. Failure to load spring assembly correctly may result in damage to hardware and panel.

STEP 3) INSERT 3/16" X 1-1/2" ROLL PIN

Set the base of the lower retainer FLUSH with the base of the hinge post, See Figure 3. Use the 3/16" drill bit provided and drill completely through both sides of the lower retainer and the hinge post. Tap the 3/16" roll pin into the hole until the pin is flush with the side of the lower spring retainer.

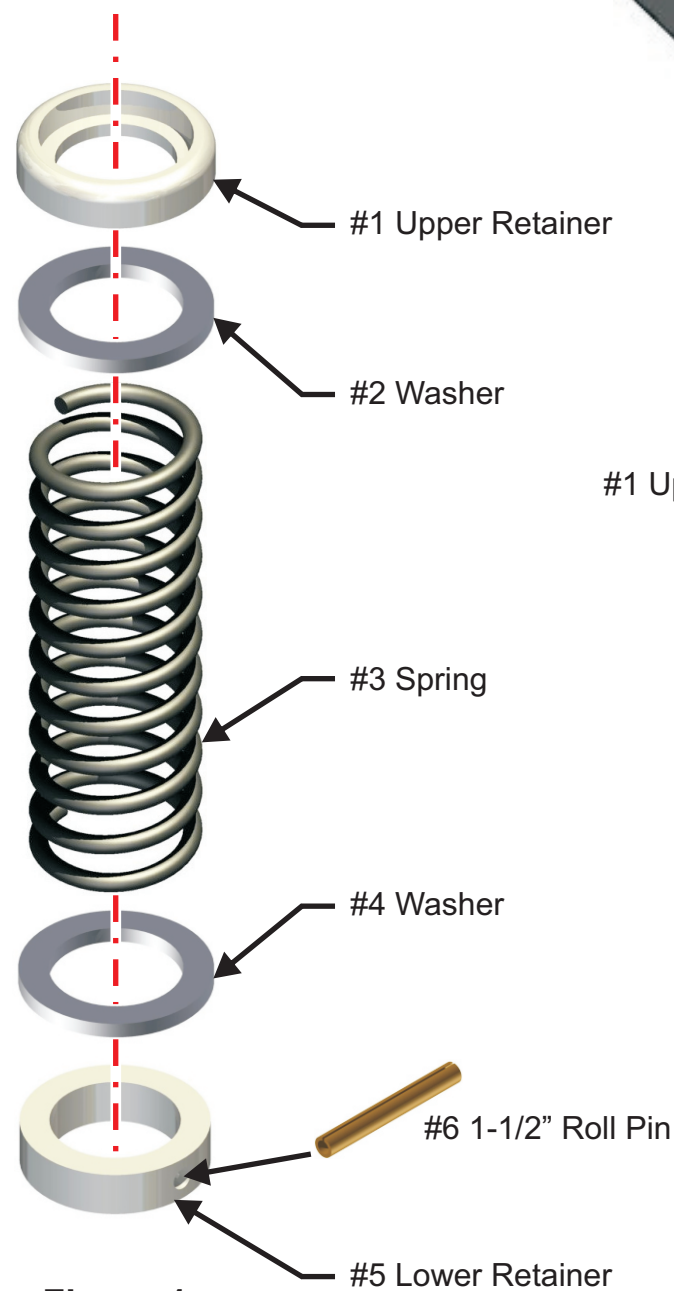

Figure 1

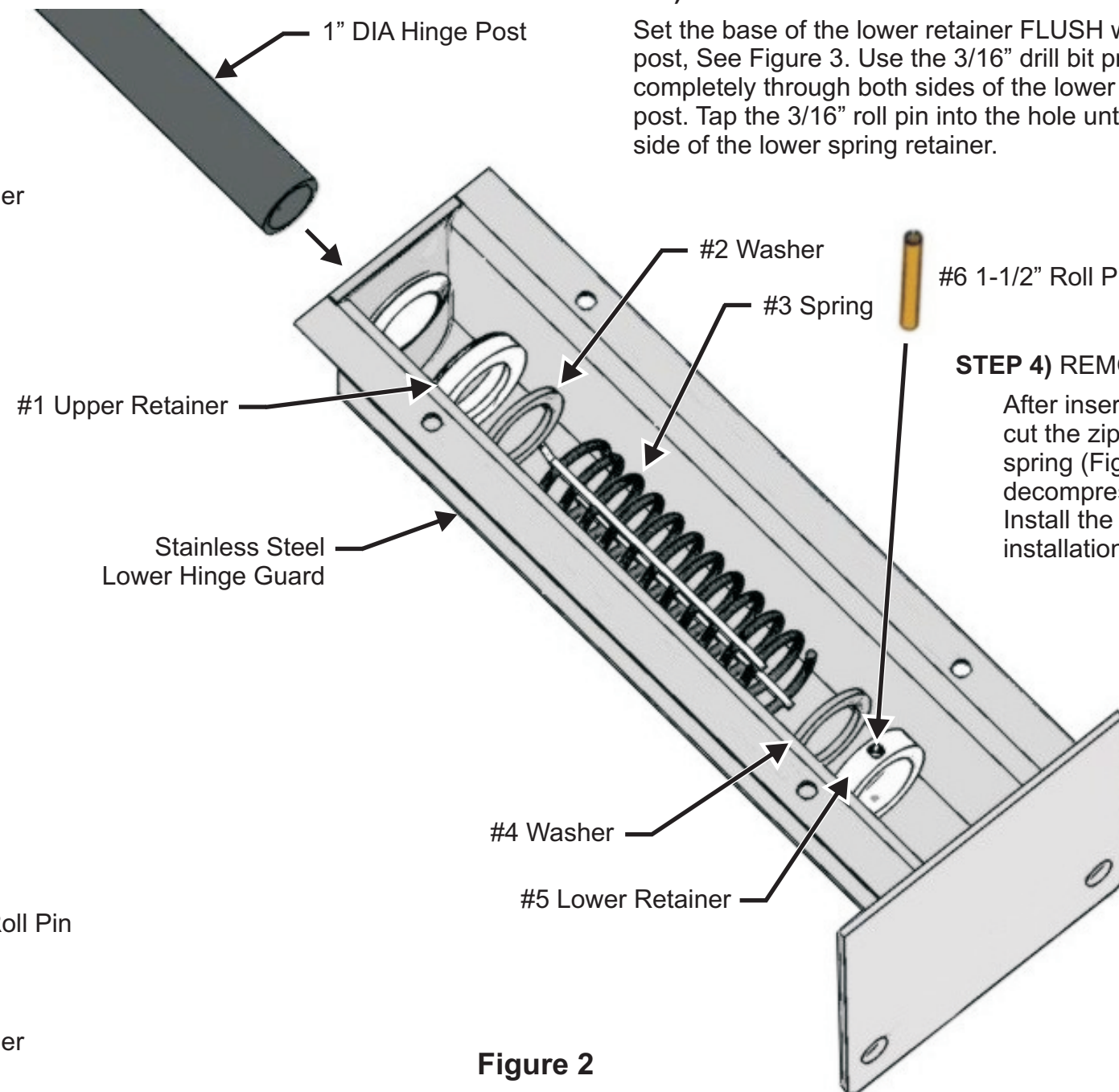

Figure 2

STEP 4) REMOVE ZIP TIES

After inserting the roll pin completely, cut the zip ties on each side of the spring (Figure 4). The spring will decompress and is ready for operation. Install the panel according to the installation instructions.

Cut Each Zip Tie to Decompress Spring

Flush at Base

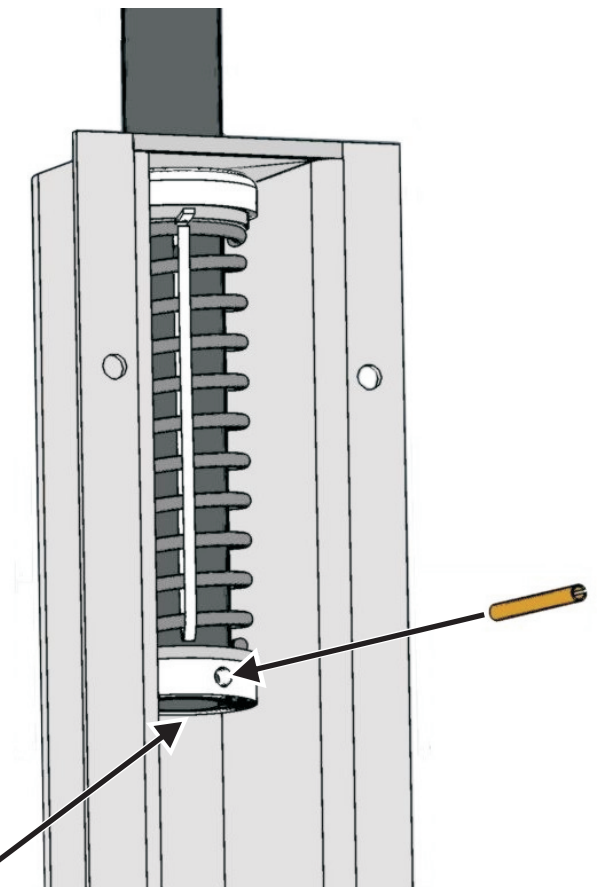

Figure 3

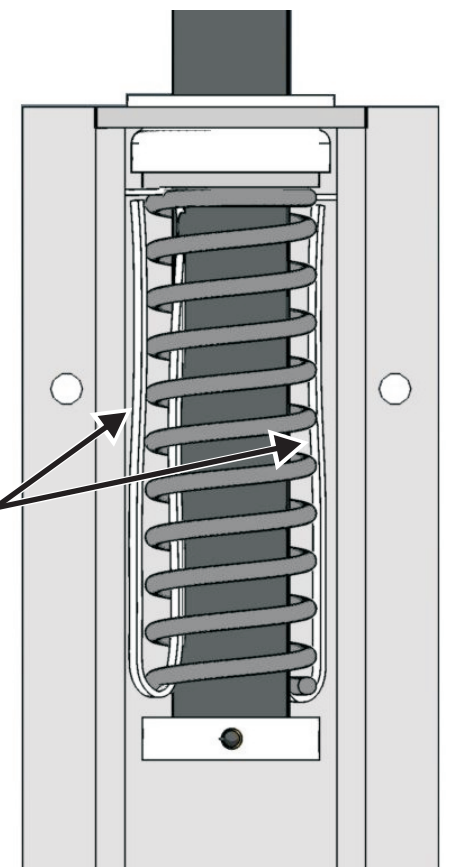

Figure 4