

Trim designs

Control trim

SP28, SP313 and US-32D.

K-control



911K
BE
NL

L-control



L-Control-Dane
912L
BE
L-DT
NL



L-Control-Sutro
912L
BE
L-DT
NL



L-Control-Quantum
912L
BE
L-DT
NL

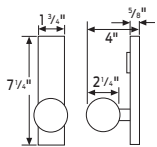

Key locks or unlocks trim. Knob retracts trim. Knob retracts latchbolt when trim is unlocked.

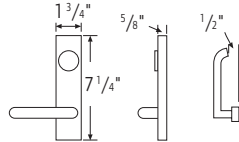

Lever Projection: Quantum = 3"
Sutro = 2 7/8"
Dane = 2 7/8"

Key locks or unlocks trim. Lever retracts latchbolt when trim is unlocked. Dane, Quantum and Sutro levers return to within 1/2" of door.

DT-control



918 DT
Pull when dogged.

NL-control



918NL
Key retracts latchbolt.

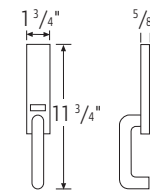

9970
Can be used with all devices (not for use on wood doors).

9 1/4" center to center
2 7/8" projection
1 3/4" clearance

Cover plates



4167
3 1/4" x 15" x .050
Used with TP control & DT control
Covers 161 & 86 cutouts



4168
3 1/4" x 7 1/2" x .050
Used with EO device to cover No. 86 cutout for mortise lock



4170
3 1/4" x 7 1/2" x .050
Used with K control, DT/K control, L control, or DT/L control
Covers 161 & 86 cutouts

Key-in-lever



914KIL



914-KIL-IC

For 1-3/4" thick doors only

Centron trim

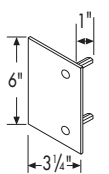

930 EO

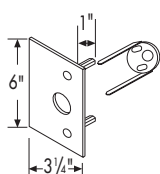

930 C

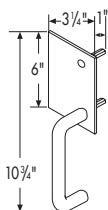

930 DT

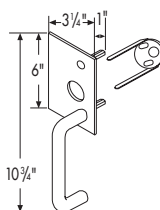

930 NL



Pull only 917 DT
CTC - 5 1/2" round - 3/4" dia.
Pull when dogged.

Trident trim

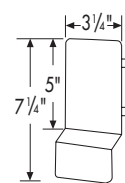

920 DT

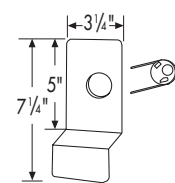

920 NL

Trim chart

Control

Device	DT	NL	T-BE	K	K-BE	K-DT
19-R/19-V	918	918	910	911	911	911
Cylinder type	—	rim	—	1 1/8" Mortise	—	—

Device	Dane*			Sutro*			Quantum*					
	L	L-BE	L-DT	L	L-BE	L-DT	L	L-BE	L-DT	L	L-BE	L-DT
19-R/19-V	912	912	912	912	912	912	912	912	912	912	912	912
Cylinder type	1 1/8" Mortise	—	—	1 1/8" Mortise	—	—	1 1/8" Mortise	—	—	1 1/8" Mortise	—	—

KIL

Device	KIL*	KIL-LS/LK'	KIL-NL*	KIL-IC*
19-R/19-V	914	914	914	914
	Falcon "C" keyway A23160	—	Falcon "C" keyway A23160	Small format

Trident trim

Device	Trident trim		Centron		
	NL	DT	C	DT	NL
19-R/19-V	920	920	930	930	930
Cylinder type	Rim	—	Rim	—	Rim

* Specify hand.

Note: For "NL" night latch function on K and L add "NL" after trim number.
All locking trim except KIL furnished less cylinder.

Type and functions

These pages list all functions available for the 19 Series devices.

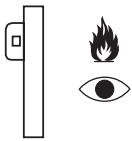
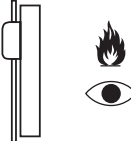
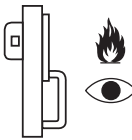
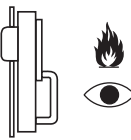
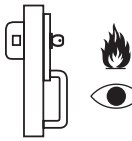
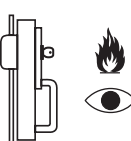
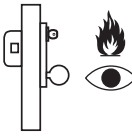
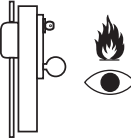
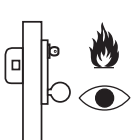
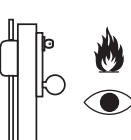
	Rim devices ANSI type 1 and 4.	Vertical rod devices ANSI type 2 and 5.
Functions (ANSI)	(F)-19-R	(F)-19-V
EO or N (01) Exit only, no trim.	 19-R-EO	 19-V-EO
DT (02) Entrance by trim when actuating bar is dogged down.*	 19-R-DT	 19-V-DT
NL (03) Entrance by trim when latchbolt is retracted by key. Key removable only when locked.	 19-R-NL	 19-V-NL
K or L or KIL(08) Entrance by knob or lever. Key locks or unlocks knob.	 19-R-K or L or KIK or KIL	 19-V-K or L or KIK or KIL
K(NL) or L(NL) (09) or KIL (NL) Entrance by knob or lever only when released by key. Key removable only when locked.	 19-R-K (NL) or L(NL) or KIK(NL) or KIL(NL)	 19-V-K (NL) or L(NL) or KIK(NL) or KIL(NL)



Fire exit hardware

Use "F" prefix for fire exit hardware.



Security monitor



Electric function

*Latch, device, and authorize degress monitors. (See electrified hardware catalog.)

*Fire exit devices cannot be dogged down. Some codes permit electric dogging with fail secure circuitry.

Type and functions

Double doors

Device & trim	Length	Top strike	Bottom strike	Min. stile	Door opening width
(F) 19-V	3'0"	3788	2130	3 1/2"	2' 5 1/4" to 3'0"
(F) 19-V	4'0"	3788	2130	3 1/2"	3'0" to 4'0"

Note: For (F-) 19-V-LBR use "V" information less bottom strike. F-19-V-LBR requires use of auxiliary fire latch.

Single doors with 5/8" stop

Device & trim	Length	Strike	Min. stile	Door opening width
19-R	3'0"	F570	3 1/2"	2'5 1/4" to 3'0"
		565	1 3/4"*	2' 4 3/4" to 2' 9 1/4"
F-19-R	3'0"	F570	3 1/2"	2'5 1/4" to 3'0"
19-R	4'0"	F570	3 1/4"	3'0" to 4'0"
		565	1 3/4"*	3'0" to 3'9 3/4"
F-19-R	4'0"	F570	3 1/4"	3'0" to 4'0"

*For EO and NL functions only. 2- 1/4" minimum stile required for control trim.

Dimensions:

- Recommended height from finished floor - 40 5/16" at CL.
- Touchbar projections: neutral - 2 1/2" depressed - 1 7/8"
- Extension rods or longer top rods available upon request.
- Specify door height.
- Dummy touchbar available. Specify 190 DT 3' or 4'.
- Overall length: 3' 30 1/2"- 4' 42 5/8"
- Changes for minimum door size for charts on left:
- For cylinder dogging, add 2 1/4" to minimum door size.
- For exit alarm, add 4 1/2" to minimum door size.
- To fit on smaller door consult factory

Double doors with Mullion

Device & trim	Length	Strike	Min. stile	Door opening width	Fire	Panic
19-R	3'0"	F570	3 1/2"	2'5 1/4" to 3'0"	-	29231
		565	3 3/4"	2'4 3/4" to 2'9 1/4"	-	4023/ KR4-23
			3 1/8"		-	29231
19-R	4'0"	F570	3 3/8"	3'0" to 4'0"	-	4023/ KR4-23
			3 1/8"		-	29231
F-19-R	4'0"	F-570	3 3/4"	3'0" to 4'0"	(F)4023	-
			3 3/8"		KR(F)4023	-
19-R	4'0"	F570	3 1/2"	3'0" to 3'9 3/4"	-	29231
			3 3/4"		-	4023/ KR4-23
			3 1/8"		-	29231
F-19-R	4'0"	F-570	3 3/8"	3'0" to 4'0"	-	4023/KR4023
			3 3/4"		(F)4023	-
					KR(F)4023	-

¹ To cover 161 cutout on double door installation, specify 2923 mullion with 565 strike.

