

VALUE SERIES®

OUTSIDE PULL & PLATE TRIM DESIGNS

Assorted outside trims provide security for all types of installations. Built to be as durable as the panic devices, these heavy-duty trims will stand up to heavy use and abuse. The versatile design of the trims, combined with the device mounting plate, makes changing functions as simple as replacing the outside trim. This can easily be done without removing the exit device from the door. These trims can be used on V40 Series Rim and V50 Series Surface Vertical Rods. Detex uses the BHMA functions/descriptions for all trims.

03 function trims include cylinder bracket kit with spring loaded tailpiece that self-adjusts to door thickness.

A and AN TRIM

NOTE: 02A/02AN available in 689 693, or 695 finishes

03A/03AN available in 689, 693 or 695 finishes

A Trim Covers 161 Prep

AN Trim Does Not Cover 161 Prep

Rim cylinder required for 03A and 03AN

*Cylinder sold separately

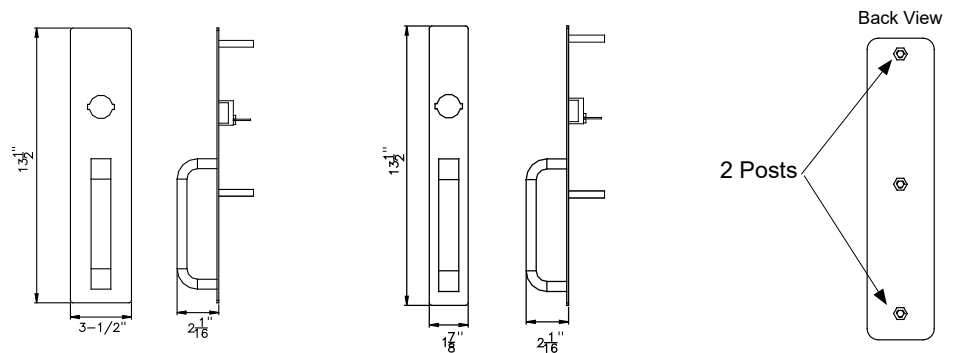
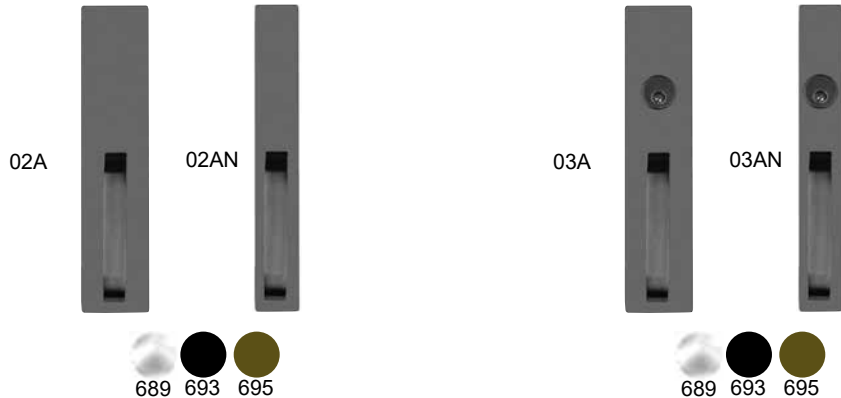

WS Trim

Available in 605, 606, 611, 612, 613, 629 and 630 finishes



03WS

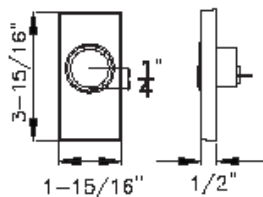
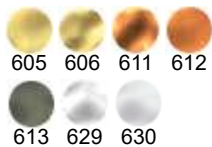

WP Trim

Available in 628 finish



02WP

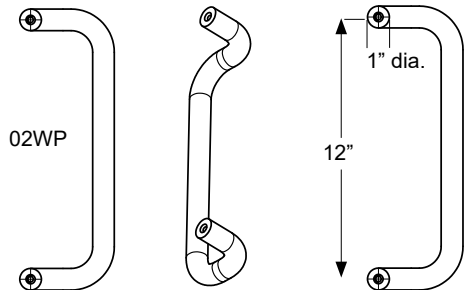

P and PN Trim

01P/01PN available in
628 & 711 finishes

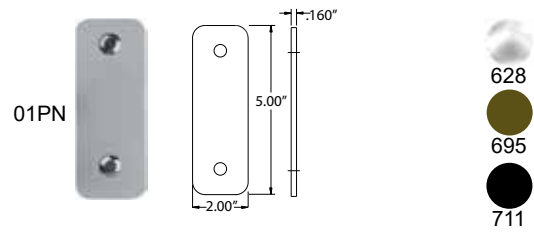
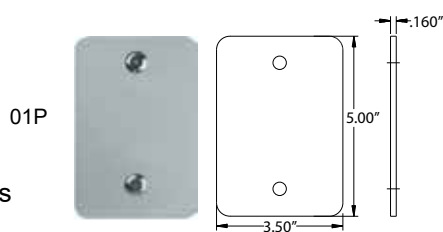

03P/03PN available in
628, 695 & 711 finishes

P Trim covers
161 Prep

Rim cylinder required for
03P/03PN trims

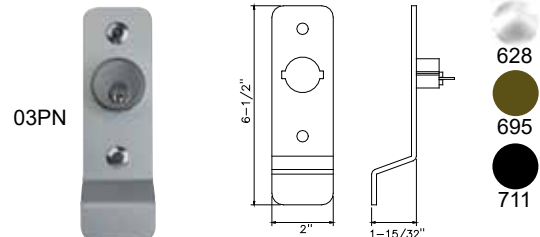
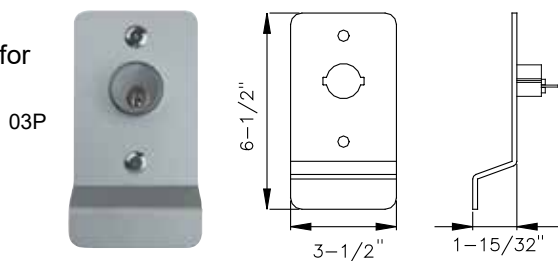

BHMA Function/Description

- 01 - Exit only, no trim or blank escutcheon
- 02 - Entrance by trim when actuating bar is locked down (dummy trim)
- 03 - Entrance by trim when latch bolt is released by key. Key removable only when locked.

Finishes

605 / US3	Polished Brass	628 / US28	Satin Aluminum	689 / SP28	Aluminum Painted
606 / US4	Brushed Brass	629 / US32	Polished Stainless Steel	693 / SPBLK	Black Painted
611 / US9	Polished Bronze			695 / SP313	Dark Bronze Painted
612 / US10	Brushed Bronze	630 / US32D	Brushed Stainless Steel	711 / DC35	Black Anodized
613 / US10B	Oil Rubbed Bronze				

Technical Information

- A/AN Trims are Steel Stampings
- WS Trims are forged Brass
- When ordered with device, trims will match mounting plate specified
- P/PN Trims are Aluminum Stampings
- Value Series trims configured for use with BP2 and BP8 (standard)

DETEX[®]
A Century of Security
1923-2023

Detex Corporation
302 Detex Drive
New Braunfels, Texas 78130-3045 USA
PH. (830) 629-2900
(800) 729-3839
FAX (800) 653-3839
<http://www.detex.com>
USA Sales:
marketing@detex.com
International Sales:
export@detex.com

 Cancer & Reproductive Harm - www.detex.com/prop65