

ASSA ABLOY

1-3/4" 450° MEDALLION

TEMPERATURE RISE RATED DOORS, POSITIVE PRESSURE
VERTICALLY STEEL STIFFENED, CENTER SEAM
BEVELED LOCK, HANDED

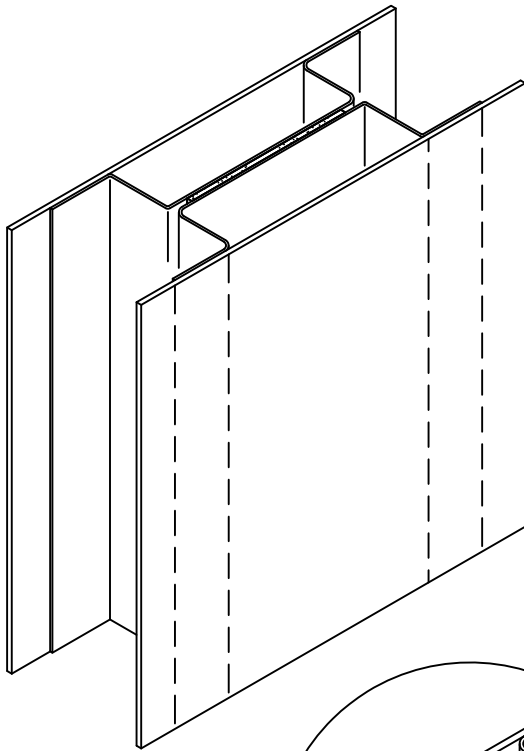

*Designed to Take Extreme
People punishment...*

*Complies with NAAMM Specifications.
22 gage steel stiffeners placed 6" apart
and welded every 5" along their length.
Center seam edges. Rock wool
insulated. An inorganic thermal barrier
bonded to stiffeners.*

Suggested Use:

Stairwells...

- Schools/Training Centers*
- Institutional Facilities*
- Public Utility Stations*
- Government Buildings*
- Warehouses/Factories*
- Manufacturing Plants*
- Transportation Terminals*
- Vehicle Service Facilities*

8 lb. DENSITY ROCK WOOL
BETWEEN STIFFENERS

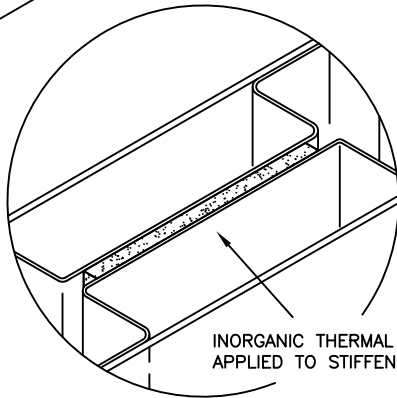

INORGANIC THERMAL BARRIER
APPLIED TO STIFFENERS

FLUSH DESIGNS



F

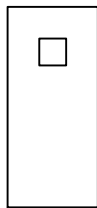

V

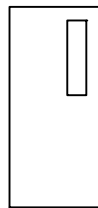

N ---

D5A-1

08/20/19

D5A-2

Hardware locations shown match Ceco standard frames.

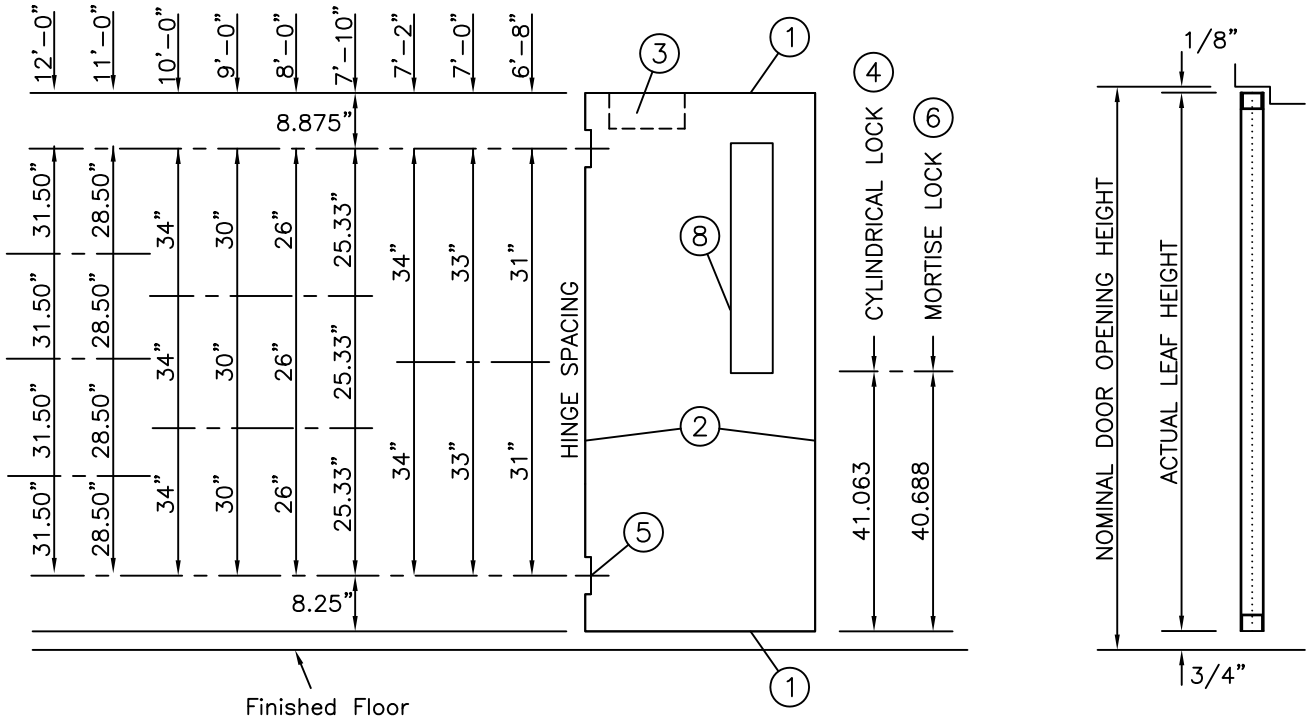

DOOR ELEVATION

VERTICAL SECTION

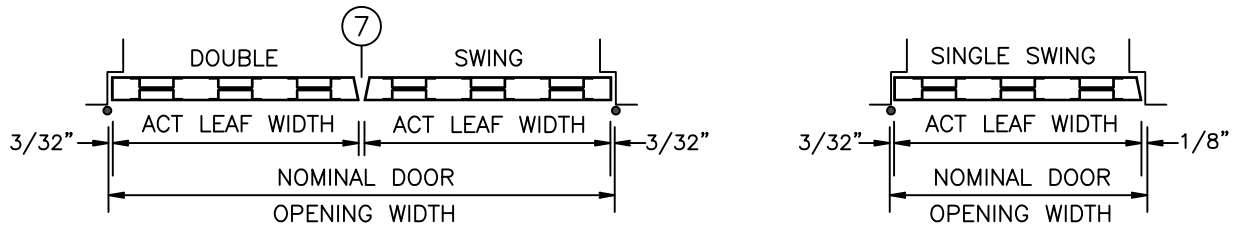

HORIZONTAL SECTIONS

(Conversion: 1" = 25.4 mm, e.g., 1-3/4" = 44.4 mm)

OVERLAPPING ASTRAGAL 4441 (7)
FOR 1-3/4" THICK DOORS

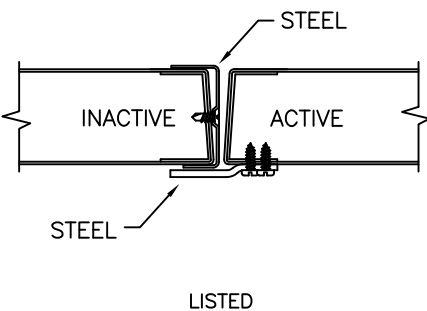

OVERLAPPING ASTRAGAL 4471 (7)
FOR 1-3/4" THICK DOORS

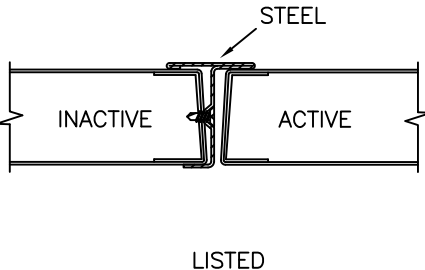

OVERLAPPING ASTRAGAL 4491 (OPTIONAL) (7)
FOR 1-3/4" THICK DOORS

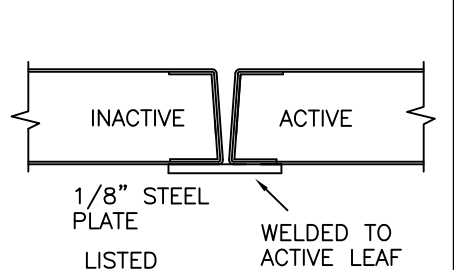

08/20/19

Experience a safer
and more open world

Ceco Door

ASSA ABLOY

D5A-3

16 GAGE STEEL END CHANNELS

WELDED TO BOTH FACE SHEETS

INVERTED TOP AND BOTTOM

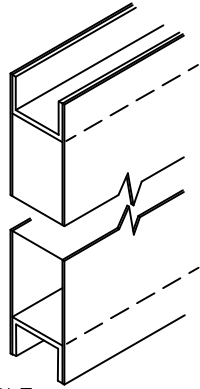

OPTIONAL TOP AND BOTTOM CAPS ARE AVAILABLE

①

VERTICAL EDGES

16 Gage Full Height Channel

Visible Edge Seam (Standard)
Filled Edge Seam (Optional)
Welded Seamless Edge (Optional)

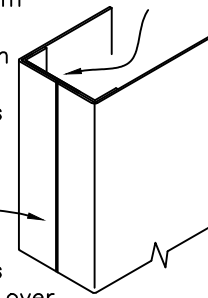

Welded Seamless Edge For Doors over 10' in height.

②

CLOSER REINFORCEMENT (OPTIONAL)

14 GAGE STEEL CHANNEL 20" LONG

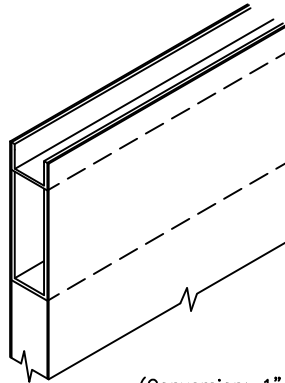

(Conversion: 1" = 25.4 mm, e.g., 1-3/4" = 44.45 mm)

③

LOCK PREPARATION GOV. 160/161 CYLINDRICAL TYPE

(LC1)

(ANSI A115.2)
2-3/4" BACKSET

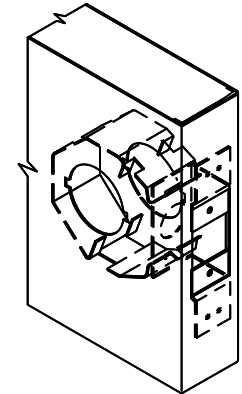

④

HINGE PREPARATION

4-1/2 OR 5 IN. HIGH, STANDARD OR HEAVY WEIGHT, FULL MORTISE HINGES

ANSI 156.7 TEMPLATE

HINGE EDGE IS HANDED AND SQUARE

14 GA. DOORS REQUIRE HEAVY WEIGHT FULL MORTISE HINGES

7 GAGE STEEL REINFORCEMENT

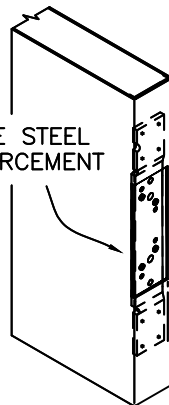

⑤

LOCK PREPARATION GOV. 86, ANSI/BHMA A115.1 MORTISE TYPE

(LM0)

NOTE: EITHER OF THE LOCK REINFORCEMENTS/GUARDS SHOWN MAY BE INSTALLED WITH ANY MORTISE LOCK PREPARATION.

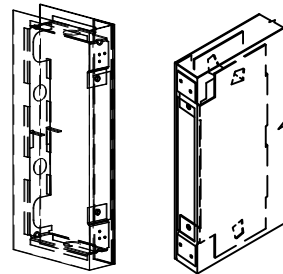

⑥

LOCK EDGE IS BEVELED 1/8" in 2" (1:16)

STANDARD GLAZING TRIM 4884 (FLUSH)

3/8" WIDE GLAZING POCKET

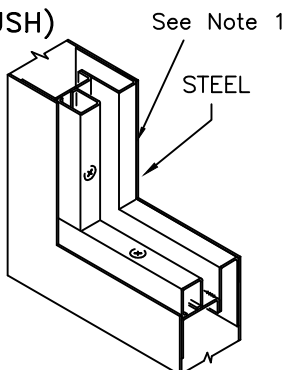

See Note 1

STEEL

⑧

OPTIONAL GLAZING TRIM SlimTrim

3/8" WIDE GLAZING POCKET

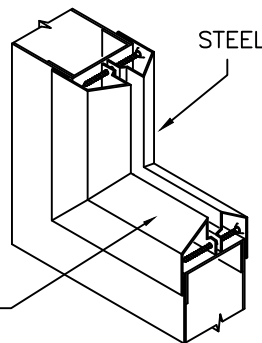

STEEL

BEVELED GLAZING BEAD

⑧

Notes:

Glazing

Only labeled, fire glazing material should be used. Glass and glazing are by glazing contractor.

Other Hardware preparations

450° Medallion doors can be prepared for listed: locks, latches, fire exit hardware, bolts (surface, flush, auto, etc.), concealed closers, and electronic hardware in accordance with procedures of specific labeling agency.

Notes:

- Field applied caulk is recommended on this seam to improve esthetics and resist water intrusion.
- Drawing Not to Scale

Ceco Door

ASSA ABLOY

Experience a safer and more open world

07/15/20

D5A-4

PRODUCT SPECIFICATIONS:

STANDARD SIZES NOMINAL DOOR OPENING

WIDTH		HEIGHT
SINGLE	DOUBLE	
2'-0"	4'-0"	6'-8"
2'-4"	4'-8"	7'-0"
2'-6"	5'-0"	7'-2"
2'-8"	5'-4"	7'-10"
2'-10"	5'-8"	8'-0"
3'-0"	6'-0"	9'-0"
3'-4"	6'-8"	10'-0"
3'-6"	7'-0"	11'-0"
3'-8"	7'-4"	12'-0"
3'-10"	7'-8"	
4'-0"	8'-0"	
5'-0"	10'-0"	

1-3/4" Thick steel doors shall be by Ceco Door Products. Doors shall conform to the Steel Door Institute guide specification, ANSI A250.8 and NAAMM specifications. See chart below for performance classifications.

450° MEDALLION doors are center edge seam design. Face sheets are commercial quality cold rolled steel (conforming to ASTM A1008...or (optional) hot-dipped galvanized or galvanized steel (conforming to ASTM A924 and A653) - see chart below.

Door face sheets are joined at their vertical edge with a center seam the full height of door (optional welded seamless design). Doors over 10'-0" in height will have welded seamless edge. 22 gage steel vertical stiffeners (other gages optional) are placed no more than 6" apart and welded to both face sheets no more than 5" on center along their length. An inorganic thermal barrier is bonded to the stiffeners. Rock wool insulates the area between stiffeners. The top and bottom door edges are closed with 16 gage steel channels welded to both face sheets.

FIRE DOORS

<p>LABELING AGENCIES:</p> <ul style="list-style-type: none"> • UL SOLUTIONS • WARNOCK HERSEY
<p>TEST: UL 10B, UL 10C, UL 1784, & NFPA 252</p> <ul style="list-style-type: none"> • RATING: 20 MIN THRU 1-1/2 HR • MAX. SIZE: 4'0" x 9'0" SINGLE (WH & FM) 8'0" x 9'0" PAIR (WH & FM) 4'0" x 10'0" SINGLE (UL) 8'0" x 10'0" PAIR (UL) 4'0" x 10'0" SINGLE (UL) 8'0" x 10'0" PAIR (UL) <p>Not all ratings are available in all sizes, designs and materials. See Fire Door sheet.</p>

Hardware Provisions: Hinge preparations are handed. The hinge edge is square. Hinge edges are mortised for 4-1/2" or 5" high, standard and heavy weight hinges (specify which). 7 gage steel reinforcements are welded inside the door edge and are drilled and tapped for fasteners in accordance with ANSI A156.7. The lock has a standard bevel (1:16). Lock edge is prepared for Gov. series 86, 160/161, or 90 locks in accordance with ANSI A115 (specify which). Optional closer reinforcement is a 14 gage steel plate.

Paint: 1-3/4" steel doors shall be provided with one coat of oven-cured neutral color primer paint. Primer coat shall conform with ANSI A250.10. The primer coat is a preparatory base for necessary finish painting.

MATERIAL

DOOR FACE SHEETS	LEVEL	C.R.	GALV		RECOMMENDED DOOR FRAME MATERIAL
			A60	G90	
18 Gage Steel	Heavy Duty	STD	OPT	N/A	16 Gage Steel
16 Gage Steel	Extra heavy Duty	STD	OPT	OPT	16 or 14 Gage Steel
14 Gage Steel (MAXIM)	Maximum Duty	STD	OPT	OPT	16 or 14 Gage Steel

Doors over 4'0" wide and/or over 10'0" tall are available only in 16 or 14 gage A60 steel.

PERFORMANCE

Sound Transmission	STC 41 (F Design, 16 Gage Face Sheets, ASTM E90 & E413 [Fully Operable])
Physical Endurance Level:	Meets ANSI A250.4 Performance Test, Level A (1,000,000 Cycles)

(Conversion: 1" = 25.4 mm, e.g., 1-3/4" = 44.45 mm)

12/05/22