

ASSA ABLOY

1-3/4" LEGION (LP) POLYSTYRENE CORE DOORS

FLUSH PANEL STEEL DOORS
BEVELED LOCK EDGE, HANDED

D4A-1

POLYSTYRENE SLAB, BONDED TO THE INSIDE OF BOTH FACE SHEETS WITH A WATERPROOF, CONTACT ADHESIVE.

SUGGESTED USE:
 INTERIOR OR EXTERIOR...
 OFFICE
 MOTEL/HOTEL
 APARTMENT
 CONDOMINIUMS
 DORMITORIES
 URBAN RENEWAL
 HEALTH CARE
 INSTITUTIONAL
 MERCANTILE
 PUBLIC UTILITY
 FACTORY
 WAREHOUSE

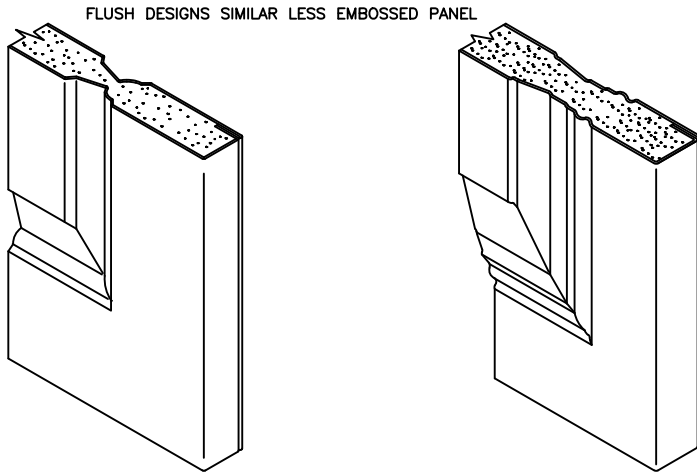

EMBOSSSED PANEL DESIGNS:
6 PANEL
CROSSBUCK

HIGH DEFINITION EMBOSSED
PANEL DESIGNS:
1 PANEL
2 PANEL

DOOR DESIGNS

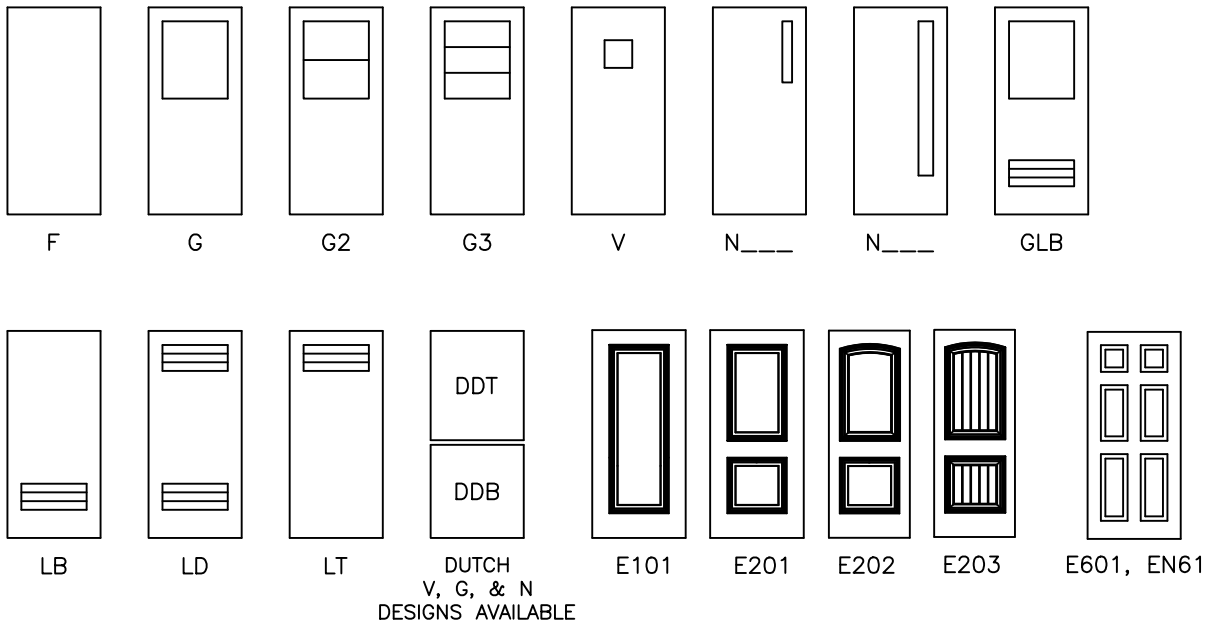

	1 PANEL	2 PANEL	6 PANEL
MAX. SIZE	3'0"X8'0"	3'0"X8'0"	3'0"X7'0"
MIN. SIZE	2'8"X6'8"	2'8"X6'8"	2'6"X6'8"

EMBOSSSED NARROW 6 PANEL DESIGNS
WILL BE CENTER EDGE SEAM CONSTRUCTION.

07/14/20

D4A-2

Hardware locations shown match Ceco standard frames.

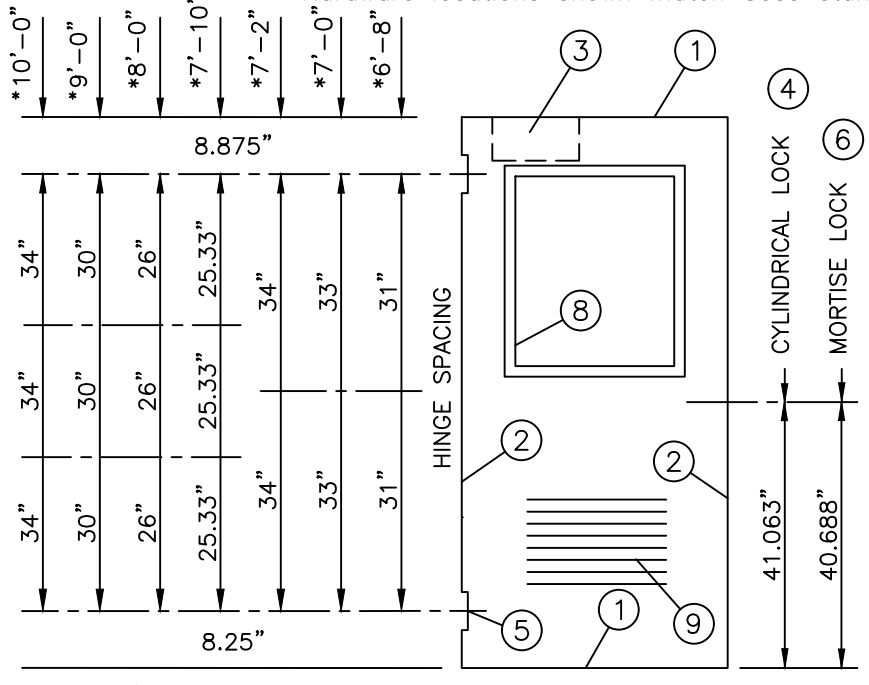

Finished Floor

DOOR ELEVATION

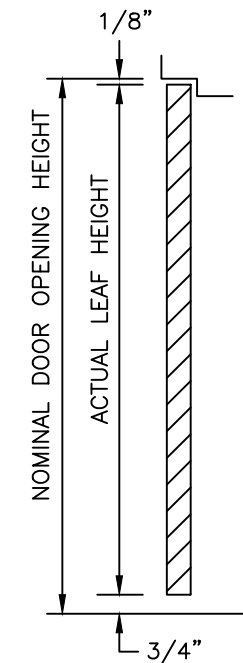

VERTICAL SECTION

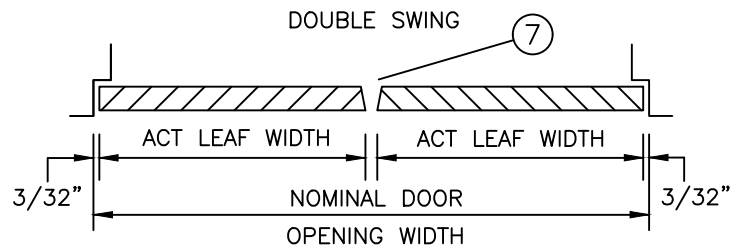
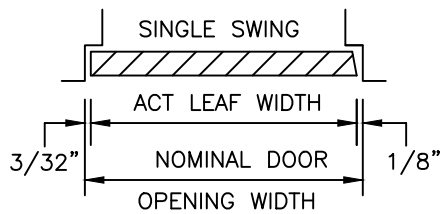

HORIZONTAL SECTIONS

(Conversion: 1" = 25.4 mm, e.g., 1-3/4" = 44.45 mm)

*See all embossed panel designs and size limitations on pages D4A-1 or D4A-4.

OVERLAPPING ASTRAGAL 4441 7
FOR 1-3/4" THICK DOORS

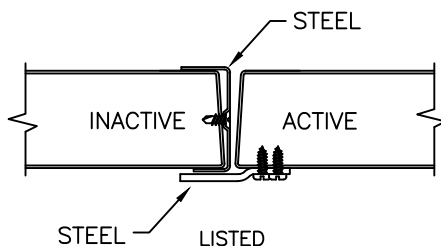

OVERLAPPING ASTRAGAL 4471 7
FOR 1-3/4" THICK DOORS

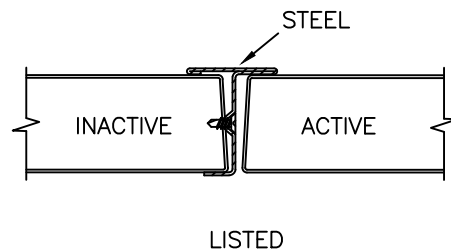

01/03/20



Experience a safer and more open world

TECH-DATA

LEGION DOORS

D4A-3

16 GAGE STEEL END CHANNELS

WELDED TO BOTH FACE SHEETS

INVERTED TOP AND BOTTOM

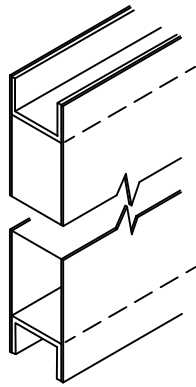

OPTIONAL TOP AND BOTTOM CAPS ARE AVAILABLE

①

VERTICAL EDGES

MECHANICALLY INTERLOCKED HEMMED EDGES

OPTIONAL: SEAMLESS (WELDED OR BODY FILLER)

EMBOSSED NARROW 6 PANEL WILL BE CENTER EDGE SEAM CONSTRUCTION.

CENTER EDGE SEAM CONSTRUCTION PROVIDED WITH 14 GAGE SKINS

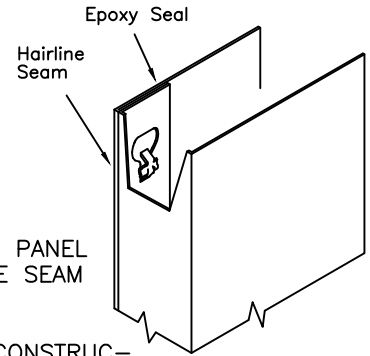

②

CLOSER REINFORCEMENT (OPTIONAL)

14 GAGE STEEL CHANNEL 20" LONG

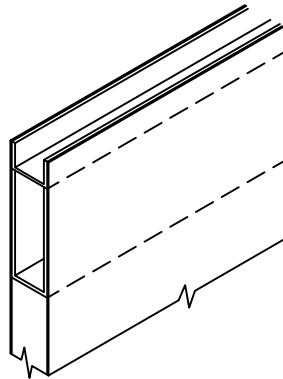

③

LOCK PREPARATION GOV. 160/161 CYLINDRICAL TYPE

(LC1)

(ANSI A115.2)
2-3/4" BACKSET

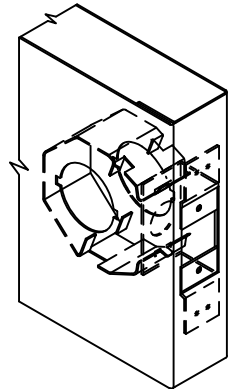

④

HINGE PREPARATION

4-1/2 OR 5 IN. HIGH, STANDARD OR HEAVY WEIGHT, FULL MORTISE HINGES

HINGE EDGE IS HANDED AND NOT BEVELED.

(Conversion: 1" = 25.4 mm, e.g., 1-3/4" = 44.45 mm)

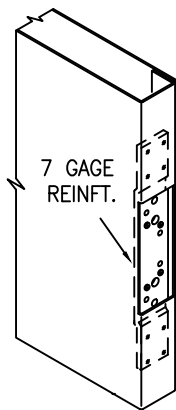

ANSI A156.7 TEMPLATE

⑤

LOCK PREPARATION GOV. 86, ANSI/BHMA A115.1 MORTISE TYPE

(LMO)

NOTE: EITHER OF THE LOCK REINFORCEMENTS/GUARDS SHOWN MAY BE INSTALLED WITH ANY MORTISE LOCK PREPARATION.

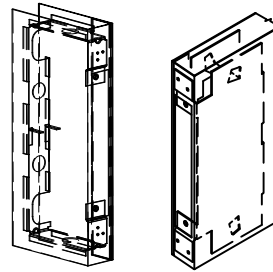

LOCK EDGE IS BEVELED 1/8" in 2" (1:16)

⑥

VERTICAL EDGES

NARROW 6 PANEL DESIGNS ARE CENTER EDGE SEAM CONSTRUCTION

14 GAGE WILL BE CENTER EDGE SEAM CONSTRUCTION

WELD SEAMLESS AND BODY FILLER SEAMLESS IS OPTIONAL

②
16 GAGE FULL HEIGHT CHANNEL

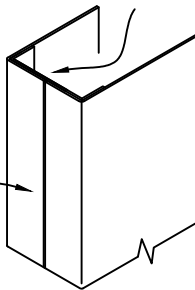

GLAZING TRIM SlimTrim

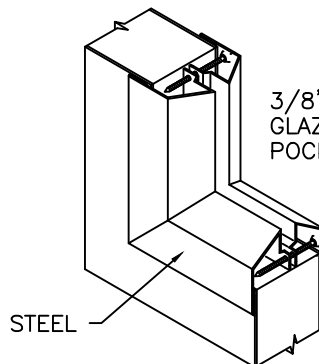

3/8" WIDE GLAZING POCKET

STEEL

LISTED

⑧

FIXED SLAT TYPE LOUVER 4634

FOR 1-3/4" THICK DOORS

50% FREE AIR FLOW

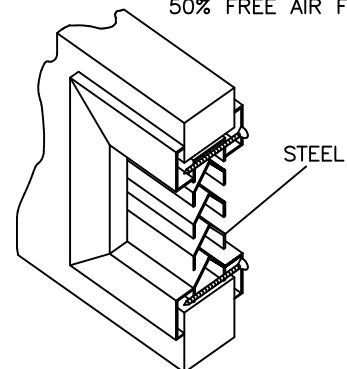

STEEL

⑨

07/14/20

Ceco Door

ASSA ABLOY

Experience a safer and more open world

D4A-4

STANDARD SIZES NOMINAL DOOR OPENING

WIDTH		HEIGHT	
SINGLE	DOUBLE		
2'-0"	4'-0"	6'-8"	
2'-4"	4'-8"		
2'-6"	5'-0"		
2'-8"	5'-4"		
2'-10"	5'-8"		
3'-0"	6'-0"		
3'-4"	6'-8"		
3'-6"	7'-0"		
3'-8"	7'-4"		
3'-10"	7'-8"		
4'-0"	8'-0"		
			7'-0"
			7'-2"
			7'-10"
			8'-0"
			9'-0"
		10'-0"	

PRODUCT SPECIFICATIONS:

1-3/4" Thick steel doors shall be as manufactured by Ceco Door Products. Doors shall conform to the Steel Door Institute guide specification, ANSI A250.8; see chart below for performance classifications.

LEGION doors are made full-flush or (optional) seamless style. Face sheets are commercial quality cold rolled steel conforming to ASTM A1008...or (optional) hot-dipped galvanized or galvanized steel conforming to ASTM A924 and A653 -- see chart below.

Legion full-flush doors have mechanically interlocked, hemmed, hairline seams on vertical edges and have no visible seams on faces. Embossed narrow 6 panel doors will have center edge seam construction. Doors specified "seamless" have no visible seams on faces or vertical edges (S.D.I. Model 2). A one piece, polystyrene slab, conforming to ASTM C578 TYPE 1, is bonded to the inside of both face sheets with a waterproof contact adhesive. The top and bottom door edges are closed with 16 gage steel channels welded to both face sheets.

Hardware Provisions: Hinge preparations are handed. Hinge edges are mortised for 4-1/2" or 5" high, standard and heavy weight hinges (specify which). 7 gage steel hinge reinforcements are welded inside the door edge and are drilled and tapped for fasteners in accordance with ANSI A156.7. The lock edge has a standard bevel (1:16) and is prepared for Gov. series 86, 160/161, or 90 locks in accordance with ANSI A115 (specify which). Optional closer reinforcement is a 14 gage steel channel.

Paint: 1-3/4" steel doors shall be provided with one coat of oven-cured neutral color primer paint. Primer coat shall conform with ANSI A250.10. The primer coat is a preparatory base for necessary finish painting. "Colorstyle" finish coat is also available from a selection of standard colors (optional). Colorstyle finish is electrostatically applied, oven-cured urethane enamel and shall conform to ANSI A250.3. For accurate color selectors ask for a Ceco Colorstyle chart.

FIRE DOORS

LABELING AGENCIES:

- UL SOLUTIONS
- WARNOCK HERSEY

TEST: UL 10C, UL 10B, UL 1784, & NFPA 252

• RATING: 20 MIN, 3/4 HR, 1-1/2 HR, OR 3 HR

• MAX. SIZE: 4'0" x 8'0" SINGLE
8'0" x 8'0" PAIR *

*8'0" x 9'0" with VERTICAL RODS

• DESIGNS: F, G, N, & V

Not all ratings are available in all sizes, designs and materials.

SIZE LIMITS - DESIGNS

	FLUSH DESIGN	1 PANEL	2 PANEL	6 PANEL
MAX.	4'0"x10'0"	3'0"x8'0"	3'0"x8'0"	3'0"x7'0"
MIN.	2'0"x6'8"	2'8"x6'8"	2'8"x6'8"	2'6"x6'8"

EXCEPTIONS:

E1, E2, and E6 designs: mortise lock preparation limited to 3'0" width.

1 & 2 panel doors are available in 18 gage face sheets only.

6 panel doors are available in 20, 18, & 16 gage face sheets only.

Panel design door face sheets are formed from A40 galv. steel.

Embossed narrow 6 panel design will have center edge seam construction.

MATERIAL

DOOR FACE SHEETS	LEVEL	COLD ROLLED	GALV		RECOMMENDED DOOR FRAME MATERIAL
			A60	G90	
20 Gage Steel (4080 max.)	Standard Duty	N/A	STD	N/A	16 Gage Steel
18 Gage Steel	Heavy Duty	STD	OPT	OPT	16 Gage Steel
16 Gage Steel	Extra heavy Duty	STD	OPT	OPT	16 or 14 Gage Steel
14 Gage Steel	Maximum Duty	STD	OPT	OPT	14 or 12 Gage Steel

PERFORMANCE

Thermal Characteristic Value:	CORE CALCULATED (ASTM C518)		R = 6.08	U = 0.16
	*NFRC 102-2014 & ASTM FLUSH DOOR WITH MERCURY FRAME		R = 2.33	U = 0.43
	*NFRC 102-2014 & ASTM FLUSH DOOR WITH WEATHERKERF FRAME		R = 2.27	U = 0.44
	*NFRC 102-2014 & ASTM FLUSH DOOR WITH STANDARD FRAME		R = 2.22	U = 0.45

*NFRC102-2014: The general requirements of testing shall be as defined in NFRC 102, ASTM C1199 and ASTM C1363.

Sound Transmission Class:	STC 27 (F Design, 18 Gage Face Sheets, ASTM E90 & E413 [Fully Operable])
Physical Endurance /Level:	Meets ANSI A250.4 Performance Test, 20 GAGE: Level B (500,000 Cycles); 18 and 16 Gage: Level A (1,000,000 Cycles)

(Conversion: 1" = 25.4 mm, e.g., 1-3/4" = 44.45 mm)



Experience a safer and more open world

12/05/22