

A13-6频锁屏发射器说明书

公司保留更改产品设计与说明书的权利, 届时将不另行通知, 图片仅供参考, 具体以实物为准。 A/O H10207

按键功能说明

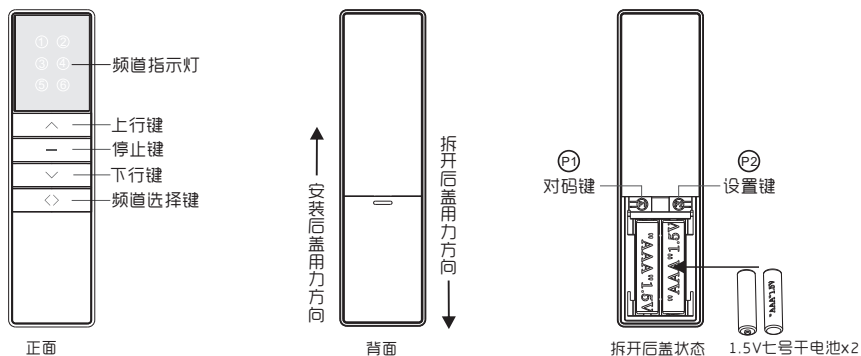

发射器操作说明 (*以K25-3E-1.6-26管状电机为例进行说明, 其它请参考相应的说明书。)

对码: 重复操作对码步骤即是消除当前码。一台电机最多储存5个发射通道, 再增加新发射通道只会循环覆盖最后一个通道:

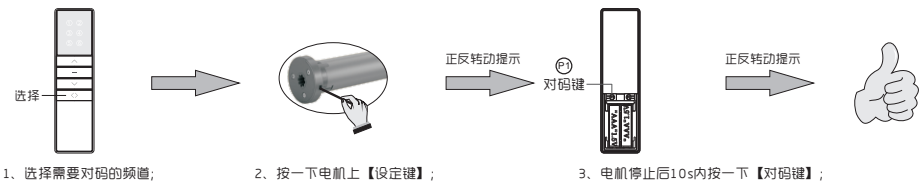

锁频设置:

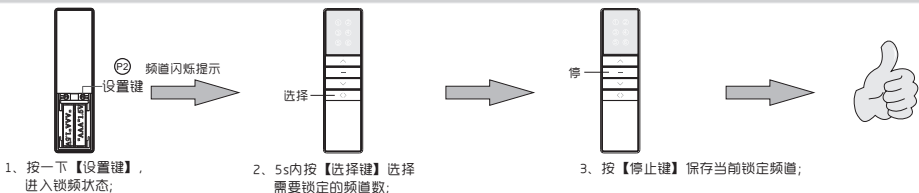

点动/连动模式互换: 电机出厂默认为连动模式, 切换为点动模式后, 长按住【上行键】或【下行键】约2s电机一直连动运转:

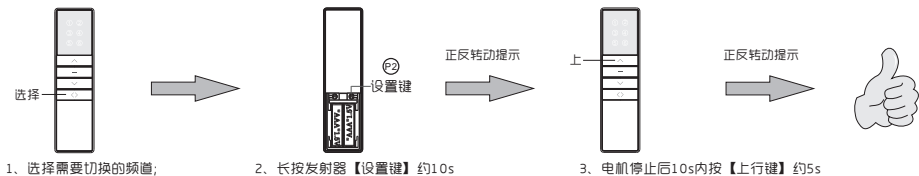

复制: 为已经对码的电机新增一个发射器:



换向: 切换已对上码电机运转方向。如: 换向前, 按发射器上行键, 窗帘往下运行; 换向后, 按发射器上行键, 窗帘往上运行:

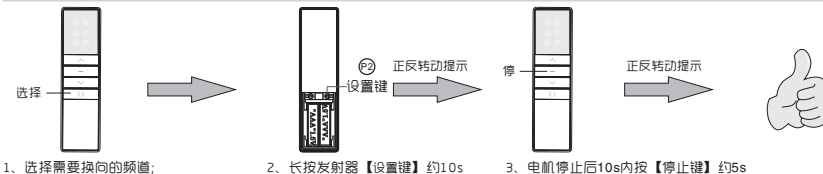

上行/下行程设置: 指按发射器【上行键或下行键】时, 窗帘向上/向下运行, 所能到达的理想最高/最低位置。

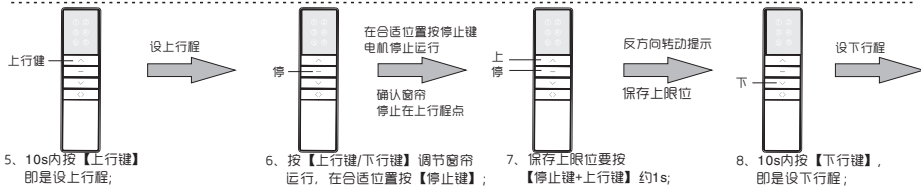
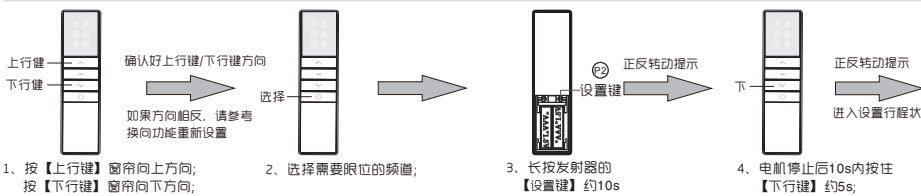

第三行程设置: 重复操作设置将会取消第三行程点:

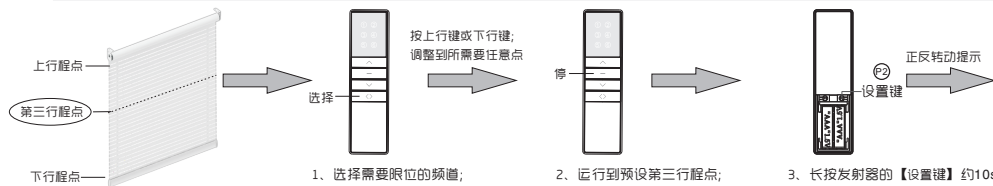

在已设置好上、下行程之间设定第三个行程点, 作为窗帘的半开的位置; 重新设置上下行程或重置设置第三行程将会清除第三行程, 长按停止键3秒窗帘会自动运行至第三行程点, 如果电机处于点动模式, 长按停止键3秒窗帘会自动运行至下行限位, 再运行至第三行程点;

A13-6 channel lock transmitter specification

Company reserves the right to change product design and specifications without prior notice then ,photos are for reference only.
A/O H10207

B Button function specifications

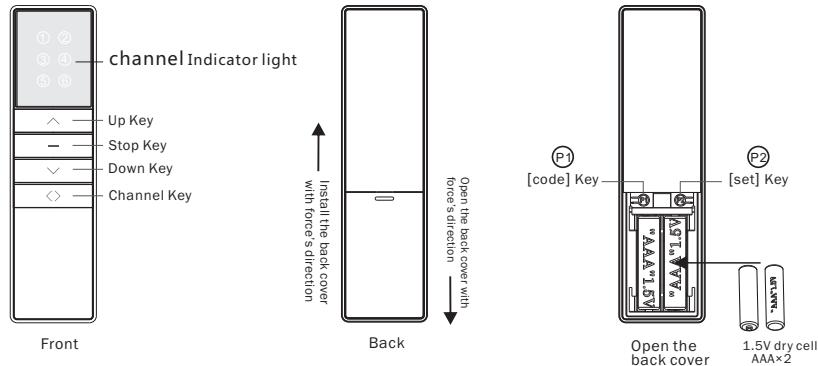

T Transmitter operating instructions

(Take K25-3E-1.6-26Tubular motor as an example. For others, please refer to the corresponding manual)

Pairing transmitter and motor :

Repeat the pairing operation once to eliminate the current pairing. A motor stores up to 5 transmitter channels. Adding a new transmitter channel will cover the earliest channel. For example, current paired channels are 1-5. If you add channel 6, paired channels will be 2-6.

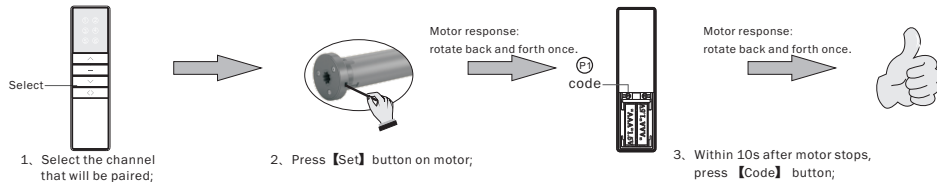

lock channel setting:

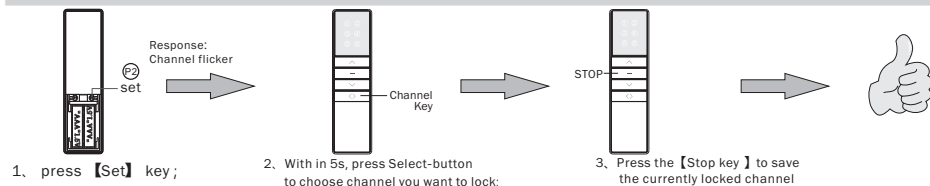

Inching / Continuous moving interchange :

Default is continuous moving. After switching to inching moving, press & hold **[Up]** or **[Down]** button about 2s, motor will continuously moves.

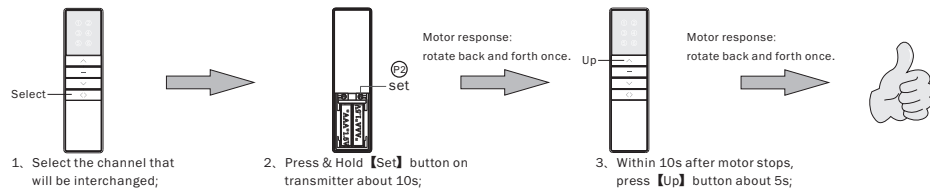

Copy : Add a new channel to control motor. (No need to touch motor):

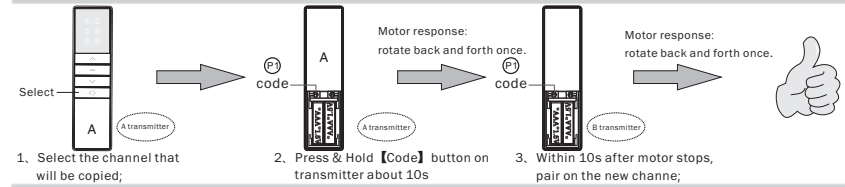

Reset direction : Reset motor direction. Such as: before reset, press transmitter up button, blinds run down. After reset, press transmitter up button, blinds run up.

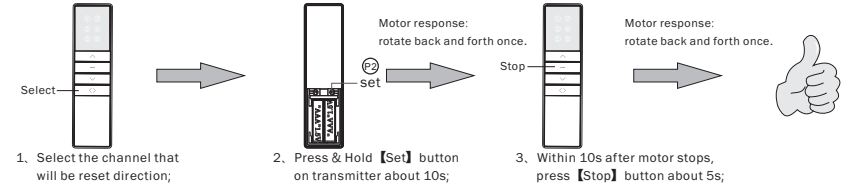

Adjusting Limits : When you press [Up] or [Down] button, the blinds will move up or down and stop automatically at the appointed position.

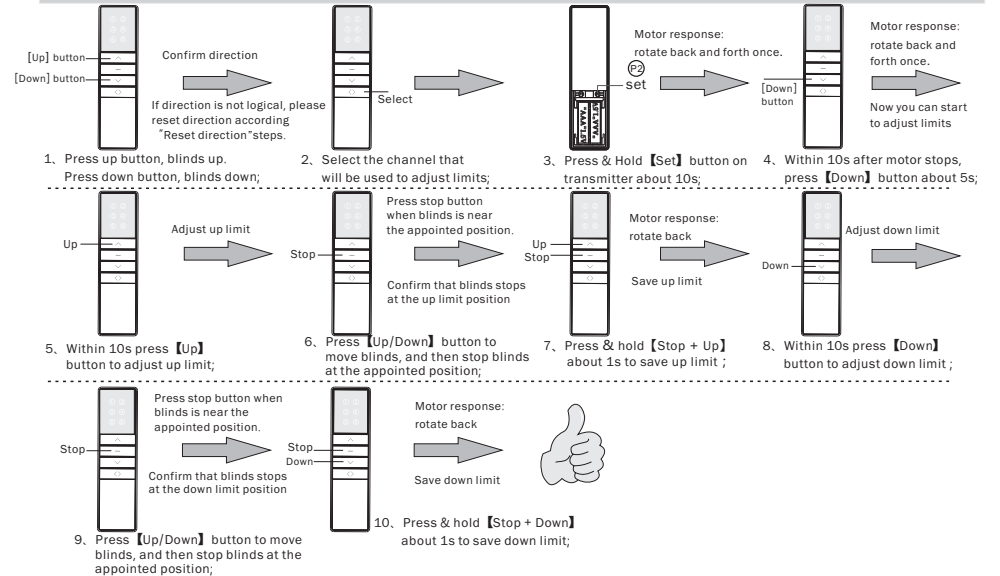

Adjust the third limit : Repeat the operation once to eliminate the third limit:

