

4

3

2

1

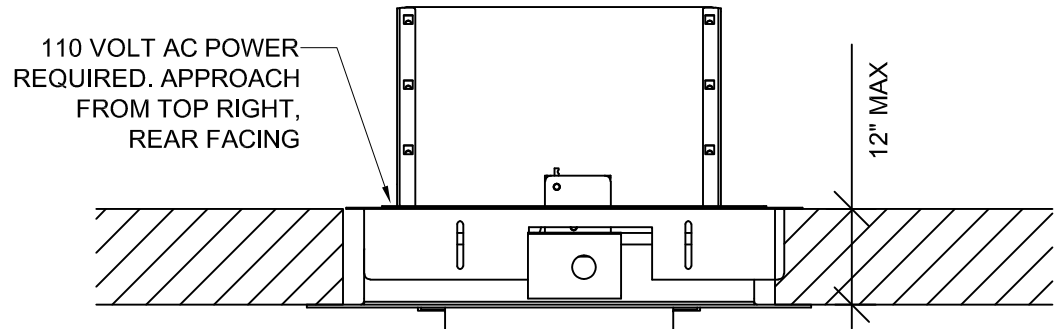

PLAN
SCALE: 1 1/2" = 1'-0"

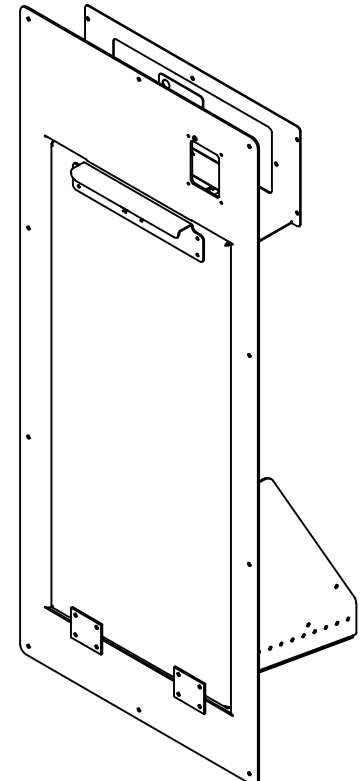

EXTERIOR ISO

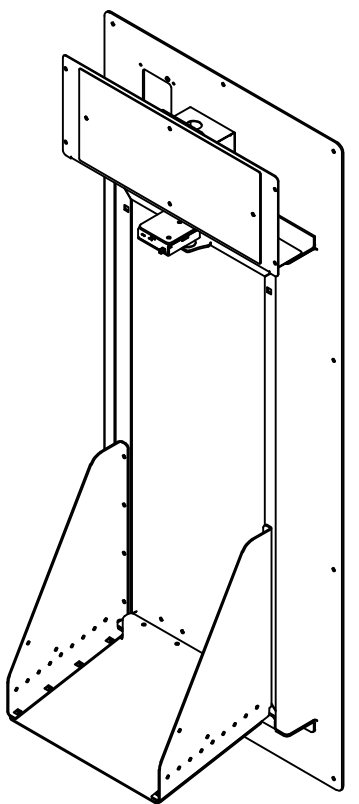

INTERIOR ISO

B

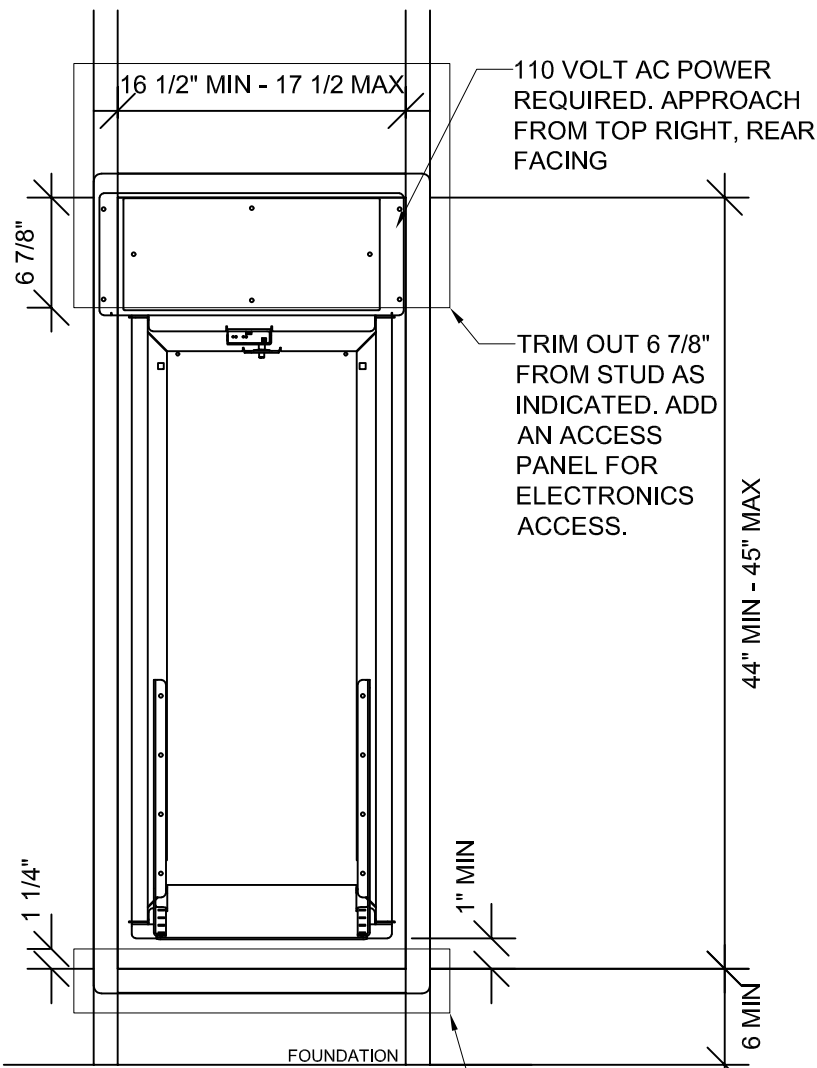

INTERIOR ELEVATION
SCALE: 1" = 1'-0"

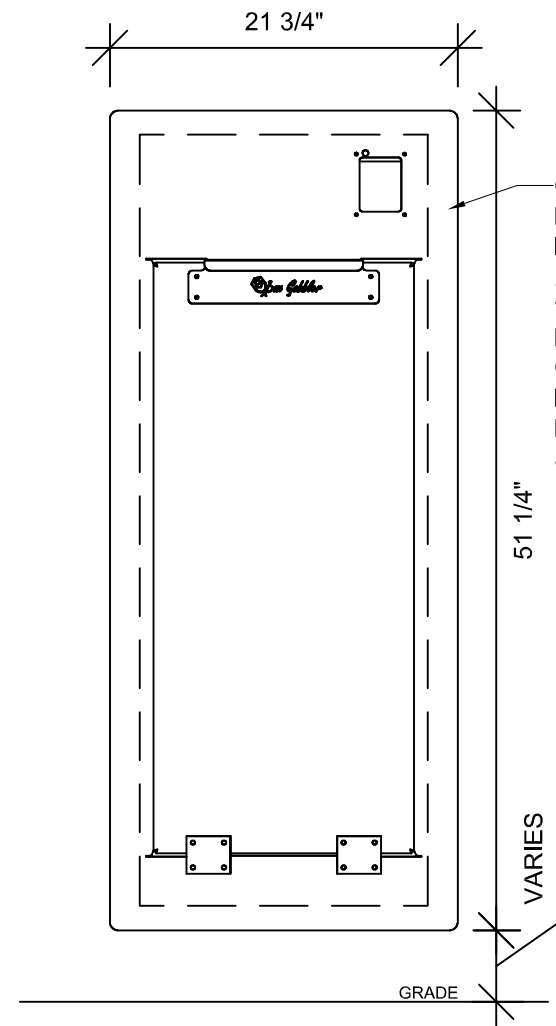

EXTERIOR ELEVATION
SCALE: 1" = 1'-0"

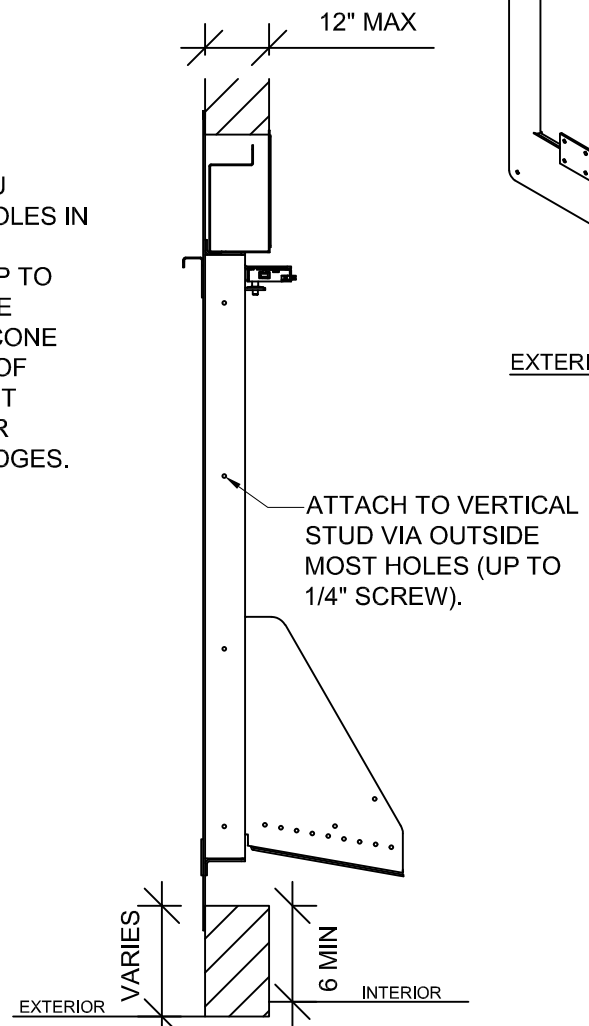

LEFT ELEVATION
SCALE: 1" = 1'-0"

CAUTION: BE SURE TO SHIM BETWEEN THE BOX GOBBLER FRAME AND THE WALL STUDS PRIOR TO SECURING IN PLACE WITH HARDWARE. THIS WILL ENSURE THE PROPER ALIGNMENT OF THE DOOR AND FRAME ASSEMBLY.

MANUFACTURER INSTALLATION REQUIREMENTS:

1. THE BOX GOBBLER SHOULD BE SHIELDED FROM DIRECT WEATHER CONDITIONS
2. WALL THICKNESS IS 12" MAXIMUM
3. UNIT TO BE INSTALLED 6" ABOVE THE INTERIOR FINISHED FLOOR TO ACCOMMODATE ADDITIONAL CONVEYOR RAMPS
4. FRAMED OPENING MINIMUM 16 1/2" X 44" / MAXIMUM 17 1/2" X 45"
5. BOTTOM DOOR FLANGE TO BE INSTALLED NO LESS THAN 1" ABOVE THE BOTTOM OF THE FRAMED OPENING TO ACCOMMODATE DOOR HINGES
6. REQUIRES 110 VOLT AC POWER (THE POWER MUST APPROACH FROM THE TOP RIGHT WHEN FACING THE REAR)

UNLESS OTHERWISE SPECIFIED:

DIMENSIONS ARE IN INCHES
TOLERANCES:
FRACTIONAL 1/32&1/64 RESPECT.
ANGULAR: BEND +/- 1 DEG
TWO PLACE DECIMAL +/- 0.030
THREE PLACE DECIMAL +/- 0.015

INTERPRET GEOMETRIC TOLERANCING PER:

MATERIAL
5052 ALUMINUM 0.125
FINISH

RAW
DO NOT SCALE DRAWING

PROPRIETARY AND CONFIDENTIAL

THE INFORMATION CONTAINED IN THIS DRAWING IS THE SOLE PROPERTY OF MB SENTINEL. ANY REPRODUCTION IN PART OR AS A WHOLE WITHOUT THE WRITTEN PERMISSION OF MB SENTINEL IS PROHIBITED.

MB SENTINEL

TITLE:
BG - 1428

SIZE - DWG. NO.

SCALE: VARIES WEIGHT: SHEET 1 OF 1

4

3

2

1

A

A