

LENOXX

! **WARNING!**
SMALL PARTS - Choking and suffocation hazard. Not recommended for children under 36 months.

! **WARNING!**
ADULT ASSEMBLY REQUIRED
- Keep away from children until assembled.



Model: YD1004

Please read and retain these instructions for future reference.

The images used in this manual are to illustrate the operation method and the structure of the product. Where there is a difference between the physical item and the illustrations, please take the physical as the standard.

SAFETY INFORMATION AND WARNINGS:

1. Children using this product must be under the supervision of an adult at all times.
2. When unpacking the ride-on, properly dispose of all plastic wrappings.
3. Failure to follow the instructions may affect the safety of children.
4. This product is designed for use by children from 3 years to 6 years of age.
5. Protective equipment such as a helmet is recommended (protective equipment is not included).
6. Assembly must be completed by an adult.
7. Each time before use, ensure that all removable parts and fasteners are firmly in place.
8. Only one child at a time can use the ride-on.
9. A child who is riding is not to be pushed.
10. Do not allow a child to stand on the ride-on.
11. Do not let children ride in the street, anywhere dangerous including stairs, doorsteps, steep slopes, streets/roads, near vehicle traffic or next to bodies of water. Use only during daylight hours or in a well-illuminated area.
12. Do not ride on long or wet grass, mud, soft ground, gravel or sand.
13. It is not recommended to use on wooden floors - the wheels may damage some floors.
14. The maximum carrying capacity is 25kg.

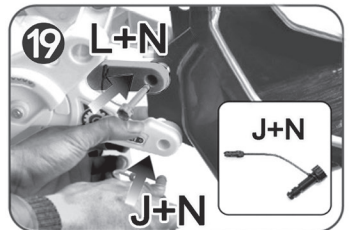
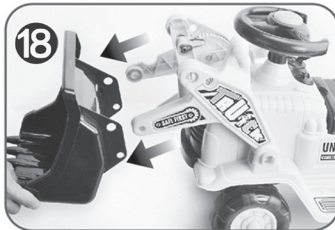
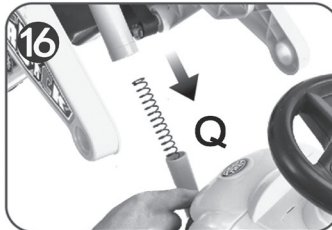
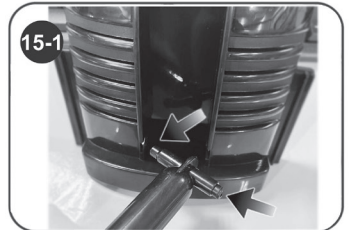
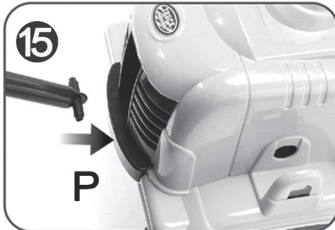
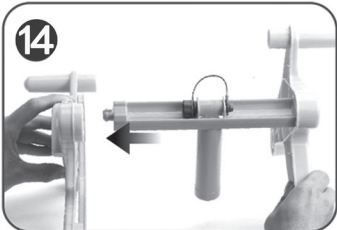
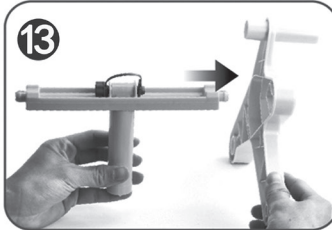
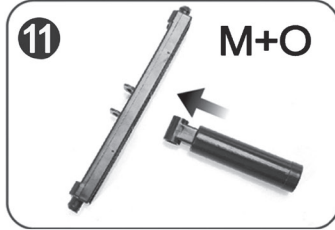
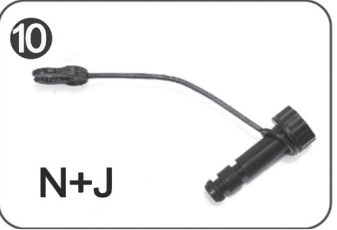
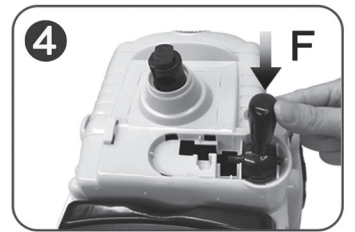
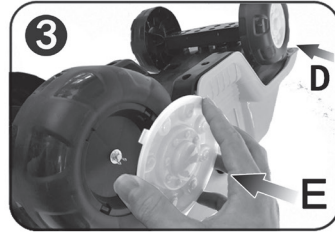
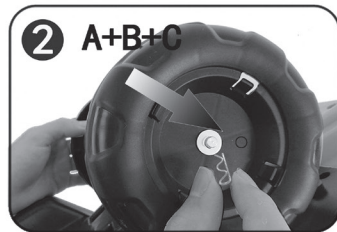
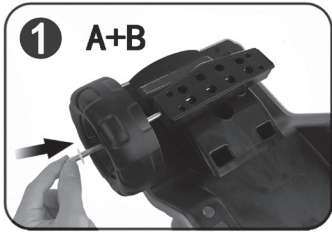

LENOXX
www.lenoxx.com.au

1300 666 848