

# LENOXX™

## Wall-Mounted Heater & Fan



Model: WMH20 | Batch: PR4918

Carefully read all instructions before use and save for future reference.

# SAFETY INSTRUCTIONS

Read and understand this entire manual before using this product. Keep these instructions for future reference.

1. Ensure the heater is securely mounted on the wall with the air outlet facing downward. Avoid placing it in unstable or tilted positions.
2. Do not use the heater in areas with combustible materials or explosive gases. Keep the air outlet unobstructed.
3. If the supply cord is damaged, it must be replaced by the manufacturer, its service agent or similarly qualified persons in order to avoid a hazard.
4. Avoid placing the heater directly below or in front of a socket outlet. The electrical outlet must have a 220-240V, 50-60Hz power supply, and ensure proper contact between the socket and plug.
5. When the heater is unattended or during maintenance, disconnect the plug.
6. Do not touch the heater with wet hands or any conductive material.
7. Immediately cease operation if the motor malfunctions.
8. While using the heater, avoid continuous opening of doors or windows to maintain optimal heating efficiency.
9. To turn off the heater, switch the on/off button to the off position. The fan will run for 30 seconds, blowing cool air before stopping. Unplug the device afterwards.
10. Do not use the heater in bathrooms.
11. Use the timer to set the heater's operating hours.
12. Remove the battery from the appliance before disposal. Dispose of the battery safely.
13. The heater must be installed at least 1.8 meters above the floor.
14. For repairs, contact our service department.
15. This appliance is not intended for use by persons (including children) with reduced physical, sensory or mental capabilities, or lack of experience and knowledge, unless they have been given supervision or instruction concerning use of the appliance by a person responsible

for their safety.

16. Children should be supervised to ensure that they do not play with the appliance.
17. CAUTION: Certain parts of the product can become very hot and cause burns, especially where children and vulnerable individuals are present. Exercise caution accordingly.



## REMOTE CONTROL BATTERY WARNING

**This product contains a coin/button cell battery inside. If swallowed, go straight to a hospital emergency room.**

- WARNING - KEEP BATTERIES OUT OF REACH OF CHILDREN
- Swallowing may lead to serious injury in as little as 2 hours or death, due to chemical burns and potential perforation of the oesophagus.
- If you suspect your child has swallowed or inserted a button battery immediately call the 24-hour Poisons Information Centre on 13 11 26 (in Australia) or 24-hour National Poisons Centre on 0800 764 766 (in New Zealand) for fast, expert advice.
- Examine devices and make sure the battery compartment is correctly secured, e.g. that the screw or other mechanical fastener is tightened. Do not use if compartment is not secure.
- Dispose of used button batteries immediately and safely. Flat batteries can still be dangerous.

**WARNING:** This heater is not equipped with a device to control the room temperature. Do not use this heater in small rooms when they are occupied by persons not capable of leaving the room on their own, unless constant supervision is provided.

# PRODUCT OVERVIEW

Model	WMH20
Rated Power	2000W
Rated Voltage	220-240V~
Frequency	50/60Hz

## INSTALLATION

Drill two holes in the wall, maintaining a distance of at least 2.0m from the ground. The hole diameter should be 6mm. Once the anchor plugs and screws are in place, attach the heater. Secure to the wall as illustrated below.

Note: Verify that the wall can withstand 4.1 kg weight before proceeding with the installation.

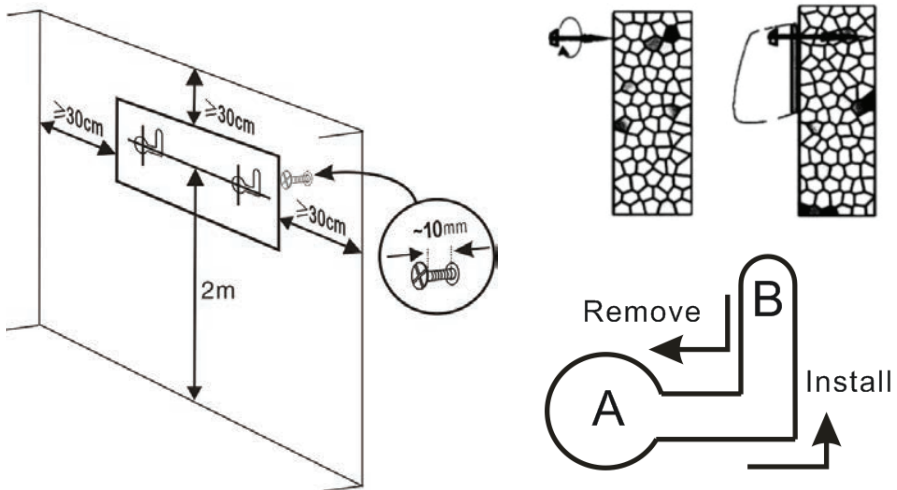



The distance between the product and the ceiling/walls should be  $\geq 30$ cm.

Note: When installing the product, align the screw with hole "A" on the product. Once hung, slide to position "B" to securely fasten it. When removing the product, shift from position "B" back to "A" before taking it off.

## GETTING STARTED

Make sure the electrical outlet has a 220-240V, 50-60Hz power supply. Connect the heater to the power outlet and ensure proper contact between the socket and plug.

Switch the appliance on.

"O" is "OFF". "I": is "ON".



Operate the heater using the included remote control.

### Simple control

The unit can be turned on (high-heat setting only) using the button on the side of the heater, below the power switch. Press once to start, press again to stop. After shutdown, the fan will continue operating for 30 seconds to cool down the appliance.



## Remote control



ON/OFF fan only



Low heat



High heat



Timer (1-8 hours)



Temperature increase/  
decrease

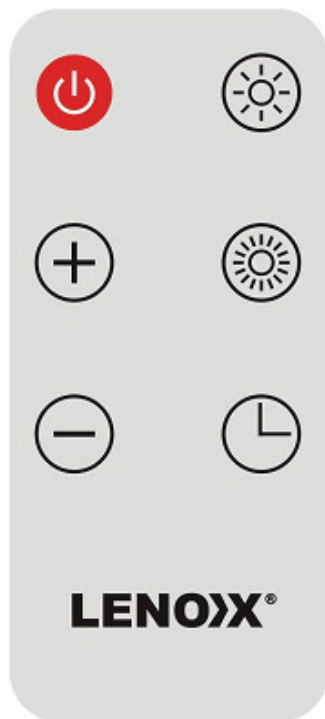

## Display



Fan



Low heat (1000W)



High heat (2000W)



Timer (1-8 hours)



Set temperature mode



## CLEANING & CARE

- Wait for the heater to cool down and ensure the plug is disconnected before cleaning.
- Use a soft, damp cloth with mild detergent; do not use abrasive detergents and do not immerse in water or any other liquid.
- Do not pour water into the machine.

# LENOXX™

[www.lenoxx.com.au](http://www.lenoxx.com.au)



1300 666 848



LenoxxElectronics



LenoxxElectronics