

LENOXX

CHILDREN'S PEDAL GO-KART OPERATION INSTRUCTIONS

Please read this manual in detail before using

Model no: GK229



Owner's Manual with Assembly Instructions

Styles and color may vary.

The owner's manual contains important safety information as well as assembly. Please read the assembly manual carefully before operating

The Ride-on Car must be assembled by an adult only.

Keep the package away from children and dispose of properly before use.

Always wear a helmet when riding

Keep this manual for future reference.

WARNING

Adult supervision is required. Do not drive anywhere dangerous including slopes with more than 10 degrees, streets, next to bodies of water and away from other obstacles. The driver must sit on the seat to drive. Read the instruction manual and acknowledge it before use.

1. Adult supervision required
2. Read the instruction manual and instruct the child user
3. The weight limit is 25kg
4. Only one rider to use at the one time
5. Please wear a bike helmet when riding
6. Sit straight on the seat when riding
7. Ride only on flat surfaces
8. Ride away from other vehicles and bodies of water
9. Wear shoes when riding

Suitable age	37-96Months	Battery	-----
Load capacity	25KGS	Size of car	94*63*51CM
Speed	3-5km/h	Power way	-----
Charge	-----	Average battery life	-----
Charge time	-----	Fuse	-----

Part List



Body*1



Seat*1

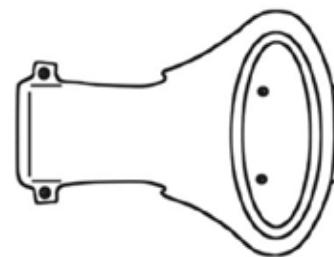

Front Panel*1



Direction*1



Front Bumper*1



The car body stand tube*2
(Right and Left)



Steering Wheel*1



Panel Sticker*1

Screw Packing



Φ13.7washer*1

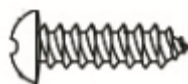

Φ4*10machine screw*4



Φ5*35 machine screw *8



Φ5*50 machine screw *2

Part Diagram

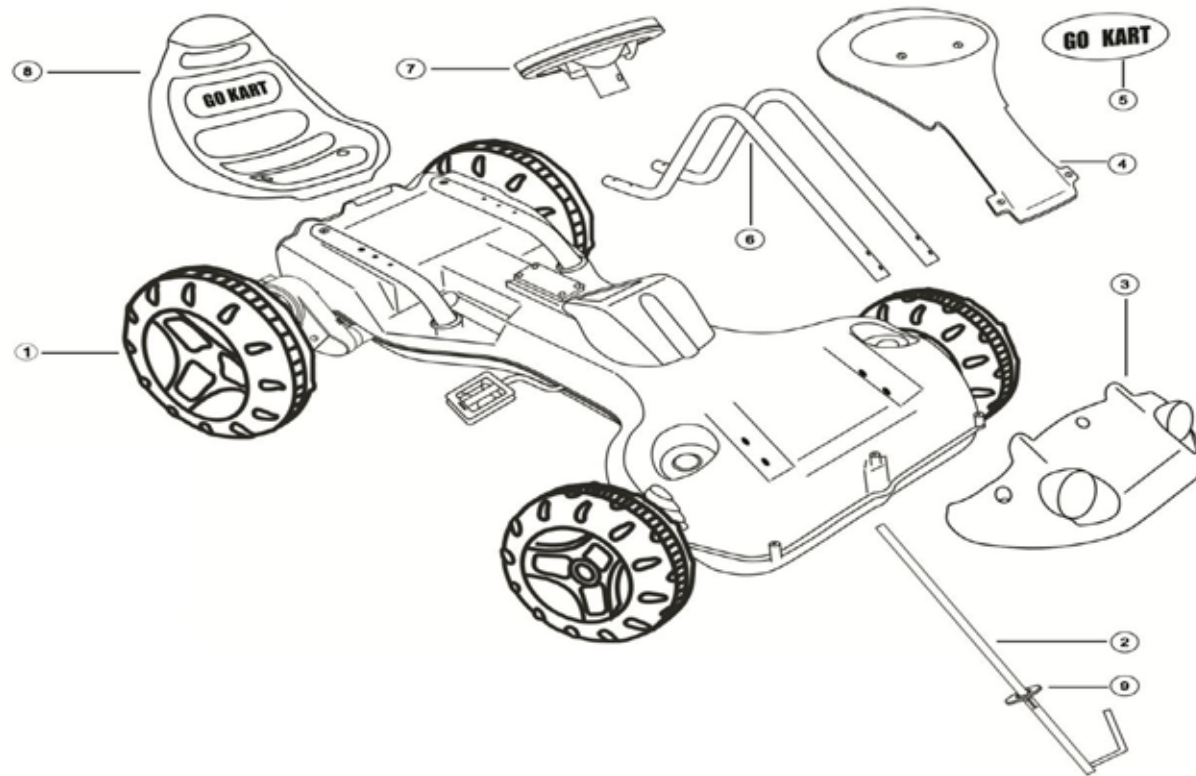

1 Wheel	4 Front panel	7 Steering Wheel
2 Direction	5 Front Sticker	8 Seat
3 Front Bumper	6 The car body stand tube	9 Washer

Tools Required



Screwdriver(not included)

Before You Begin Assembly



WARNING!

FOR THE SAFETY OF YOUR CHILD, PLEASE READ ALL WARNINGS AND ASSEMBLY/ USE INSTRUCTIONS. KEEP THIS GUIDE FOR FUTURE REFERENCE.

- **ADULT ASSEMBLY REQUIRED.** The product contains small parts, which are for adult assembly only. Keep children away when assembling.
- Always remove protective material and poly bags and dispose before assembly.

- Assembly tools required:



Screwdriver
(not included)



Long nose pliers
(not included)

WARNING:

Warning: Children could be injured by sharp edges, sharp angles, small components or electrical components. Take care when assembling or disassembling the motor tricycle. Keep the components and battery out of reach of children.

Assembly steps

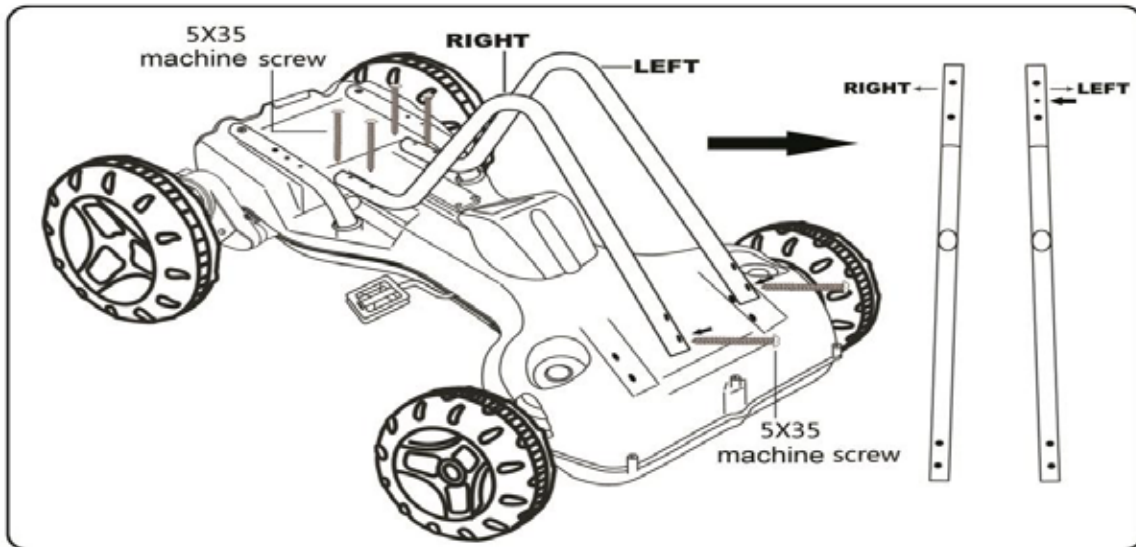

Attach the tube:

1. Fit the left and right support to the car. (please see the picture about the left and right)
2. Tighten six $\text{Ø}5 \times 35$ screws to secure it with a screwdriver.

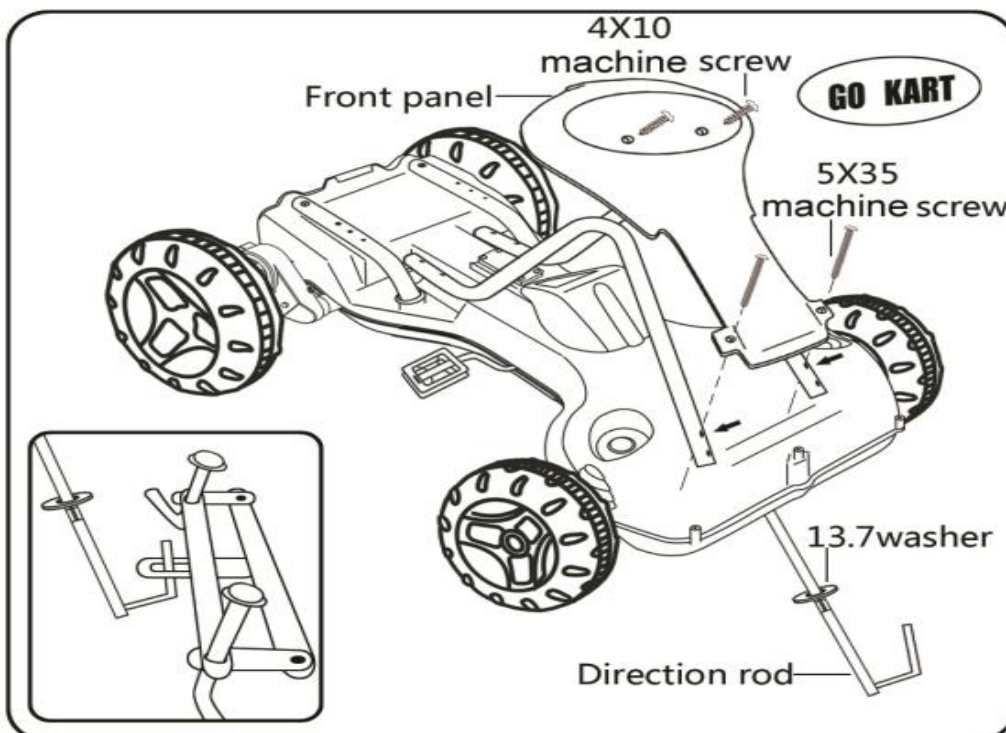

Attach the front panel and direction rod:

First insert washer on to direction rod, then insert direction rod from bottom side to car body according to picture, secure front panel to car stand tube. Last, place sticker on front panel

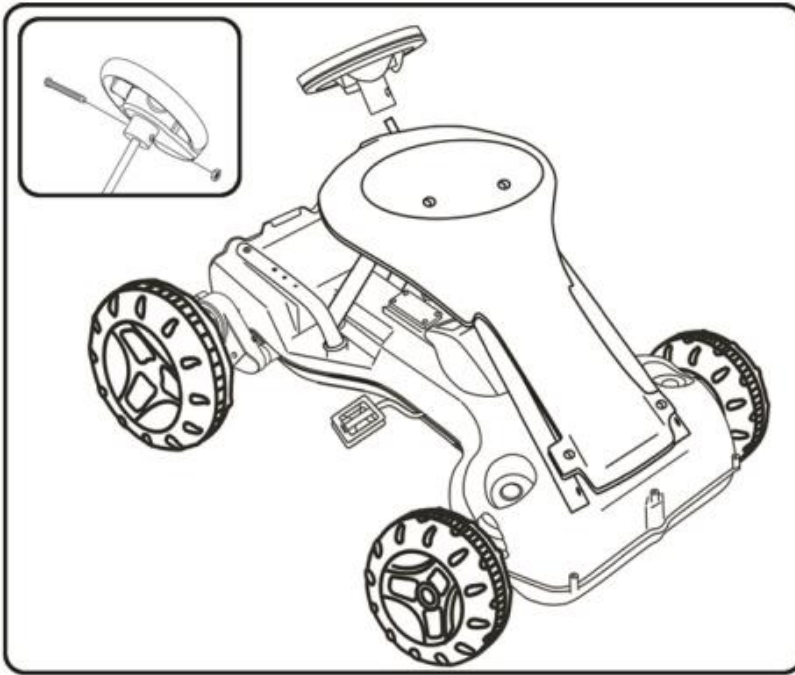

Attach the steering wheel

Insert the bolt through the steering wheel and steering column and tighten the screw.

Attach the seat

Insert the seat into car body and tighten the screws.

Note: Seat can be adjusted.

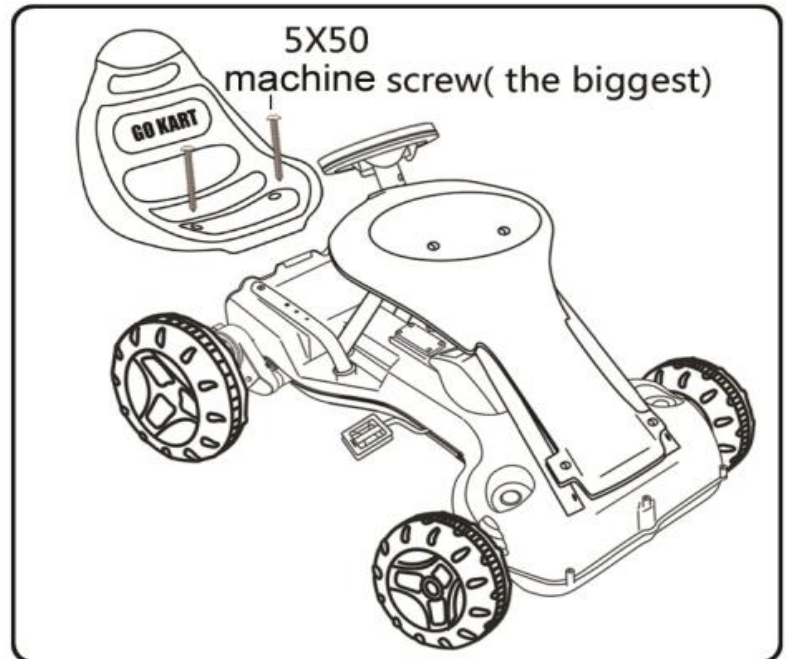

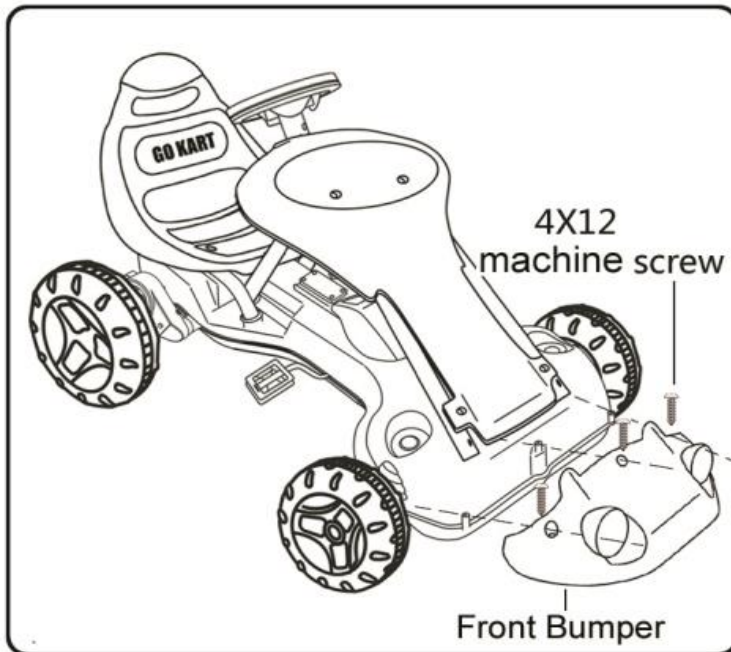

Attach the front bumper

As per picture, please take out three 4*12 screws from the car body and insert the front bumper to the car body then tighten the screws.

Use Safety

WARNING!

PREVENT INJURIES AND DEATHS:

• **NEVER LEAVE CHILD UNATTENDED. DIRECT ADULT SUPERVISION IS REQUIRED.**

Always keep child in view when child is in vehicle.

- This toy should be used with caution since skill is required to avoid falls or collisions causing injury to the user or third parties.
- Protective equipment should be worn.
- Never use in roadways, near cars, on or near steep inclines or steps, swimming pools or other bodies of water.
- Always wear shoes.
- Always sit on the seat.
- Not to be used in traffic.
- This toy is unsuitable for children under 37 months due to its maximum speed; Maximum user weight is 25 kgs.
- This toy has no brake.

• **Keep Children within Safe Riding Areas:**

- Never use in roadway, near motor vehicles, on lawn space, on or near steep inclines or steps, swimming pools or other bodies of water;

- Use the toy only on flat surfaces. Such as inside your house, garden or playground.
- Never use in the dark. A child could encounter unexpected obstacles and have an accident.

Operate the vehicle only in the daytime or a well-lit area.

- Do not let any child touch the wheels or be near them when the car is moving .
- This vehicle has adjustable play seat belts. Please instruct children how to tie the safety belt before using, guarantee the security.



Maintaining

- It is parents' responsibility to check main parts of the toy before using, Must regularly examine for potential hazard, such as screws are fastening enclosure of other parts and that in the event of such damage, the toy must not be used until that damage had been properly removed.
- Make sure the plastic parts of the vehicle are not cracked or broken.
- Occasionally use a lightweight oil to lubricate moving parts such as wheels.
- Park the vehicle indoors or cover it with a tarp to protect it from wet weather.
- Keep the vehicle away from sources of heat, such as stoves and heaters. Plastic parts may melt.
- Clean the vehicle with a soft, dry cloth. To restore shine to plastic parts, use a non-wax furniture polish. Do not use car wax. Do not use abrasive cleaners.
- Do not drive the vehicle in loose dirt, sand or fine gravel which could damage the moving parts.

Our products are suitable for

ASTM F963; GB6675; EN71 and EN62115 standard.



WARNING

To reduce the risk of injury, adult supervision is required. Never use in roadways, near motor vehicles, on or near steep inclines or steps, swimming pools or other bodies of water, always wear shoes, and never allow more than 1 rider.

LENOXX

Lenoxx Electronics Aust Pty Ltd
www.lenoxx.com.au
Customer Service : 1300 666 848

LENOXX
www.lenoxx.com.au



[Facebook.com/LenoxxElectronics](https://www.facebook.com/LenoxxElectronics)

Follow us



twitter.com/LenoxxAustralia