



REXi-EASYTRY

**BICYCLE QUICK
INSTALLATION MANUAL**

1. Remove the outer packaging



First unpack the outer box



Find a flat place to place it and unpack the inner packaging materials



Remove all packaging



Check if accessories and tools are complete

2. Install the front brake

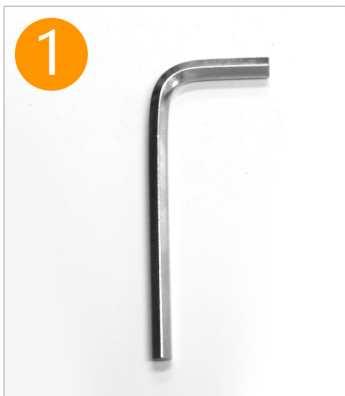

Find the 5mm wrench to fix the front brake



Unscrew the 2 screws that fixed on the front caliper



Effect after unscrew



Align the hole of the brake caliper with the hole of the front fork

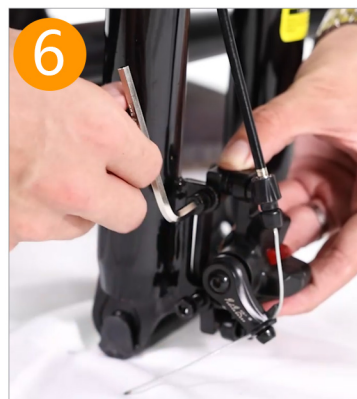

Tighten the first screw



Tighten the second screw

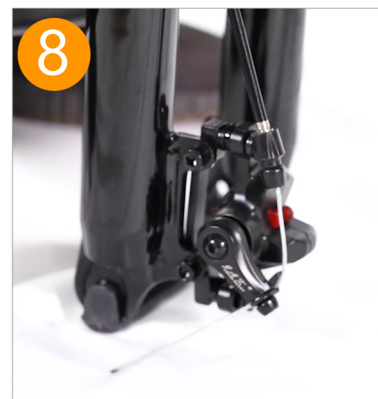

Finish effect

3. Install the front wheel



1 Remove the protective covers on both sides of the front wheel



2 Put the front wheel in the middle of the fork (note that the brake disc and the caliper need to be on the same side)



3 Loosen one end of the quick release device



4 Then insert the front axle

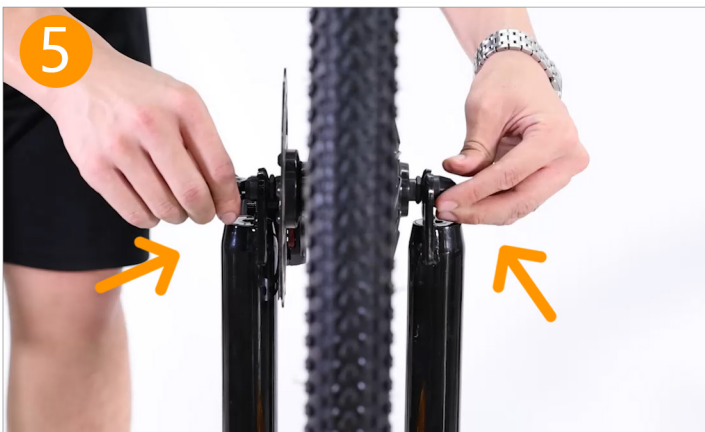

5 Tighten the quick release device. Please turn both sides in opposite directions at the same time to ensure that the wheel is installed in the middle position.



6 Press the quick release handle 90 degrees to fix it



7 Effect after completion

4. Install the pedals

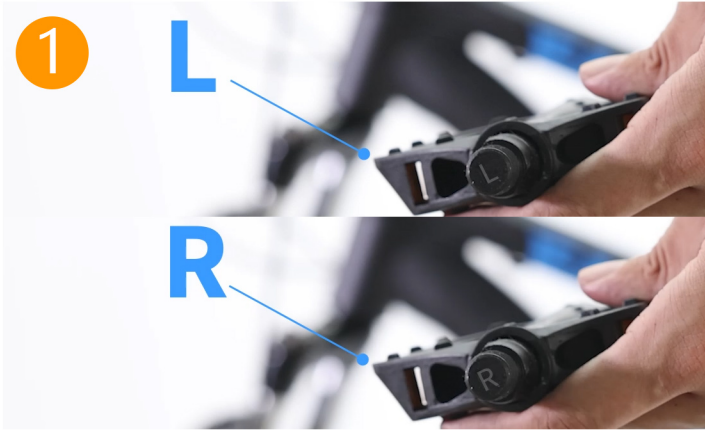

Find the left and right pedals according to the picture(differentiated by riding direction)



Then install it on the crank manually first and tighten it with a wrench



Install in the same way on the other side



Effect after completion

5. Install the handle



Loosen the screws first as shown in the picture



Adjust the front fork to the correct position as shown in the picture (the fender is on the front side of the fork)



Fix the middle position of the front handle as shown in the picture

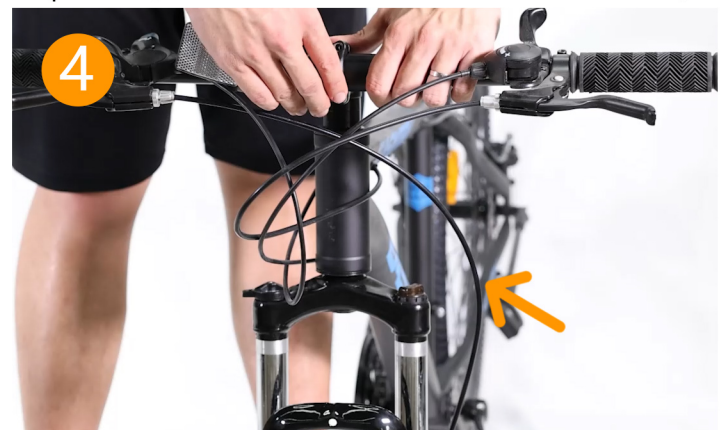

Please make sure that the front brake cable is placed on the outside of the front fork, and then next step



Then tighten the 4 screws



Effect after completion

6. Adjust the front reflective warning board



Adjust the reflective warning board to a suitable position



Effect after completion

7. Install the saddle



Find the saddle



Adjust the bundle to the extent that it can tighten the saddle seat tube



Put the saddle into the riser and tighten



Adjust the position of the reflective warning board

8. The effect of installation completion



REXi-EASYTRY



You can scan the QR code to view the installation video

INSTALLATION VIDEO LINK

<https://www.easytrybike.com.au>