

# bēbee™

LIGHTWEIGHT STROLLER  
51800, 51801, 51802, 51803, 51804, 51805



## OWNERS GUIDE

GIVE THIS TO THE  
PUT-ER-TOGETHER-ER

### **WARNING**

**ADULT ASSEMBLY REQUIRED.  
EXERCISE CARE WHEN UNPACKING  
AND ASSEMBLING PRODUCT.**

Please read the following instructions carefully. Keep this owners guide for future reference. No tools required. Keep small parts away from children. For technical support, contact us at  
Phone: 401 300 5522  
E-mail: [info@bombigear.com](mailto:info@bombigear.com)

For more information  
visit our website



 **bombi™**

# MADE FOR MORE, MADE FROM LESS™

Hey! We're Bombi™ & we want you to know you rock & you matter to us.

We believe everyone who interacts with Bombi™ plays a crucial role in carrying our message and mission to their communities, so thank you for your purchase & welcoming us into your family!

## YOUR STROLLER



Recycles at least 56 plastic bottles



Gives back to environmental causes



Eliminates single use plastics



Uses eco-conscious design practices

Should you have any questions, comment or concerns, give us a buzz.

We are here for you 24/7/365.

Phone: 401 300 5522

E-mail: [info@bombigear.com](mailto:info@bombigear.com)

Now lets get strollin'!



Proud Partner of 1% for the Planet- We donate 1% of all sales to important environmental causes.

# ⚠ WARNING

- Read and follow all warnings and instructions. Failure to do so could result in serious injury or death
- Minimum age-grade: 6 months and up
- Maximum weight and height of child: 50 lbs. (22.7 kg), 43 in. (109cm)
- NEVER leave child unattended
- Avoid serious injury from falling or sliding out. ALWAYS use safety harness
- When adjusting the product ALWAYS ENSURE that all parts of a child's body are clear of any moving parts of the product
- Care must be taken when folding and unfolding the product to prevent finger entrapment
- DO NOT carry additional children, goods or accessories in or on this product except as recommended in the manufacturer's instructions
- TO AVOID INJURY TO YOUR CHILD, DO NOT USE STORAGE BASKET AS A CHILD CARRIER
- DO NOT hang items on handlebar or place them on the canopy, as they can tip stroller over and injure child
- DO NOT OVERLOAD STORAGE BASKET. MAXIMUM 25 lbs. (11.3 kg)
- This product may become unstable if a parcel bag, other than the one recommended is used
- DO NOT overload the storage pocket or cup holder. MAXIMUM weight for the cup holder is 1lb. (0.45 kg). MAXIMUM weight of storage pocket and child cup holder is 1/2 lb. (0.23 kg)  
Excessive weight may cause stroller to become unstable or tip over
- DO NOT place hot liquids in the cup holder. Spills can burn your child
- Do not carry or roll stroller on stairs or escalators with child in it
- Do not use the stroller if any part is lost or damaged

## COMPONENTS

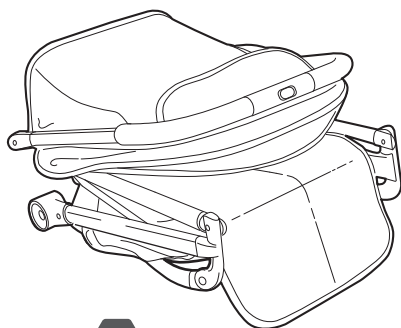

A

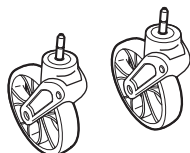

B

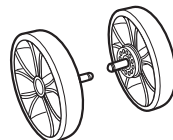

C



D



E



F

**IMPORTANT!** Before assembly, inspect this product for damaged hardware, loose joints or missing parts. Never use if any parts are missing or broken.

A Stroller Frame with Seat & Canopy

B Front Wheels (2)

C Rear Wheels (2)

D Bumper Bar

E Cup Holder

F Travel Bag

# FEATURES

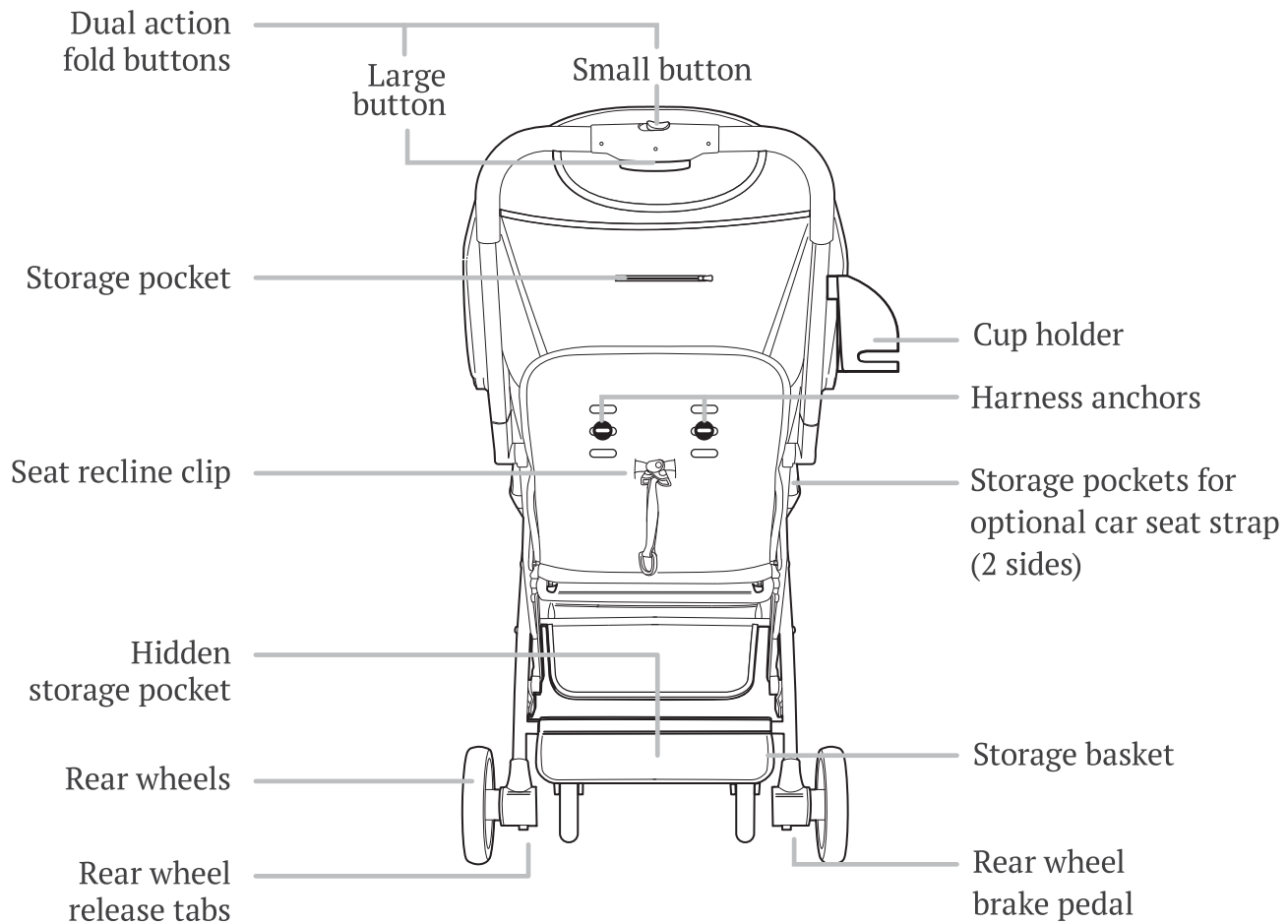
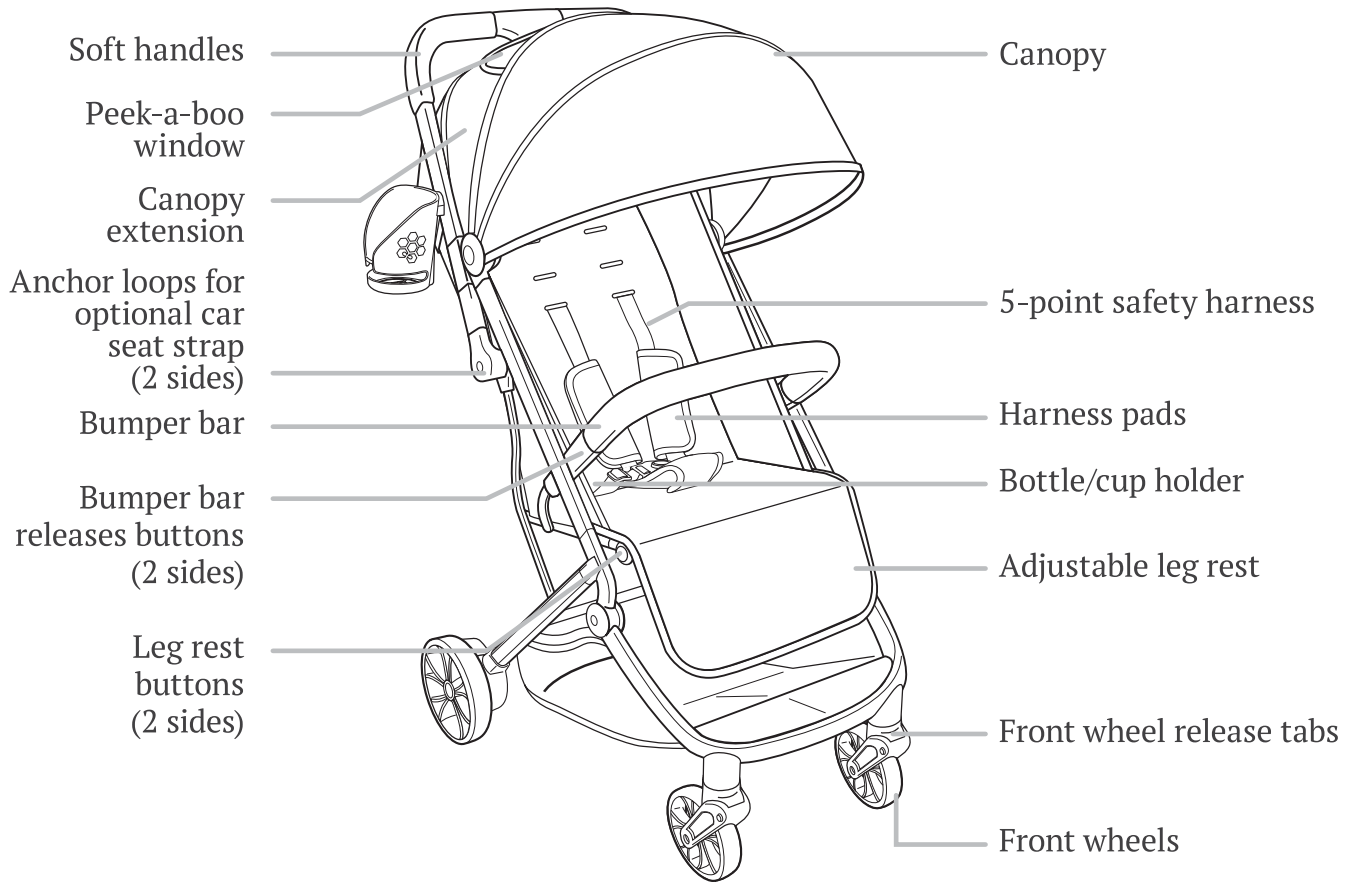

# ASSEMBLY INSTRUCTIONS

LET'S PUT THIS BĒBEE TOGETHER

**NOTE: When opening the stroller, ensure that your child, or other children, are at a safe distance.**

- 1 Slide small button to the left
- 2 While holding small button to the left, squeeze the large button & quickly pull up the stroller by the handle until it is fully open and you hear a click

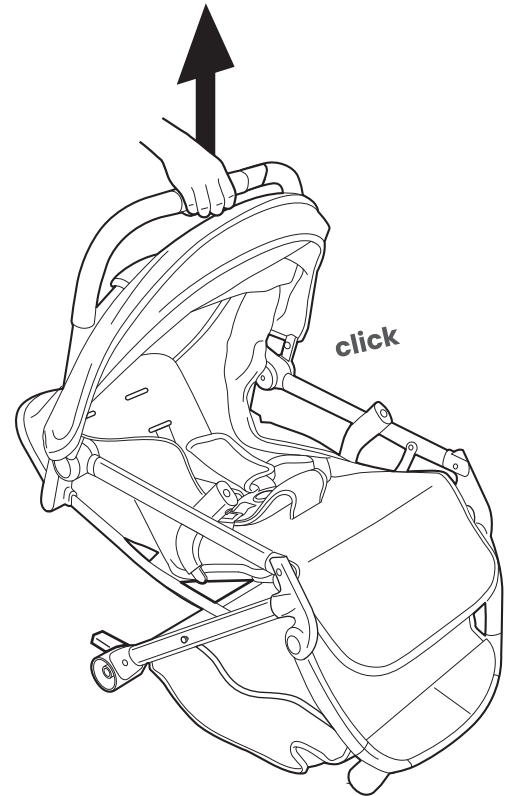
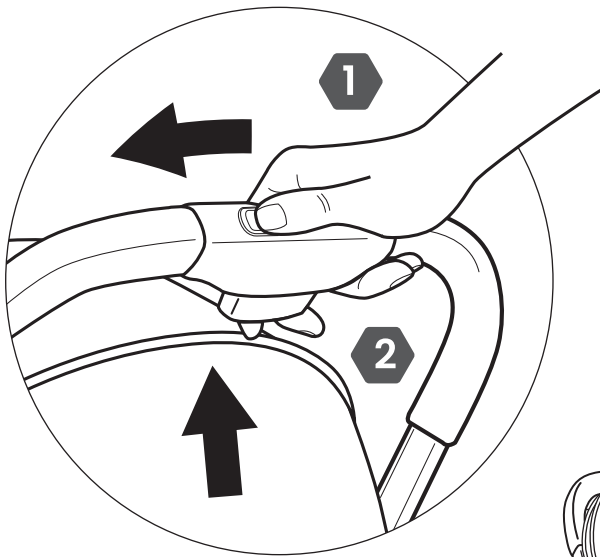

- 3 Install wheels as shown

**Note: Tug on each wheel to ensure they are securely attached and the front wheels swivel freely.**

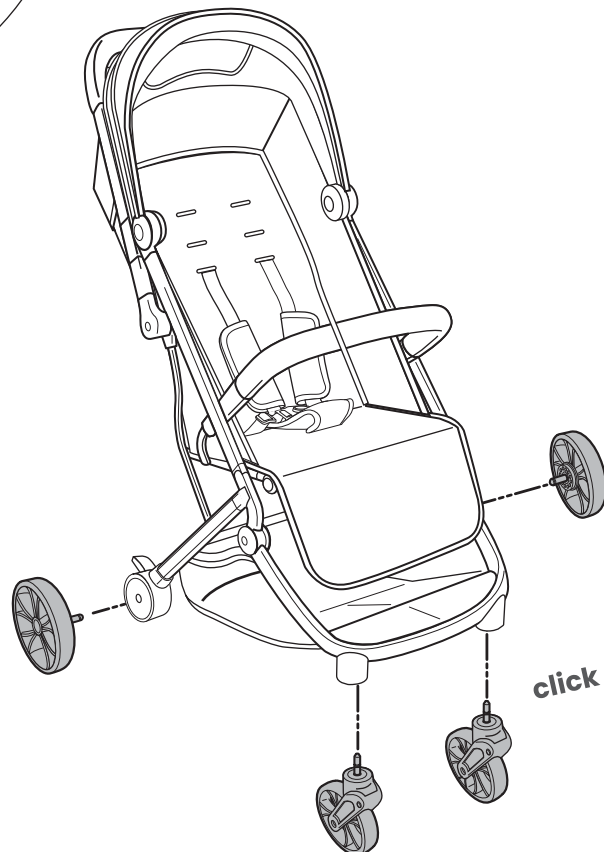

# ASSEMBLY INSTRUCTIONS

ALMOST READY TO ROLL!

- 4 Bump it: click bumper bar into position

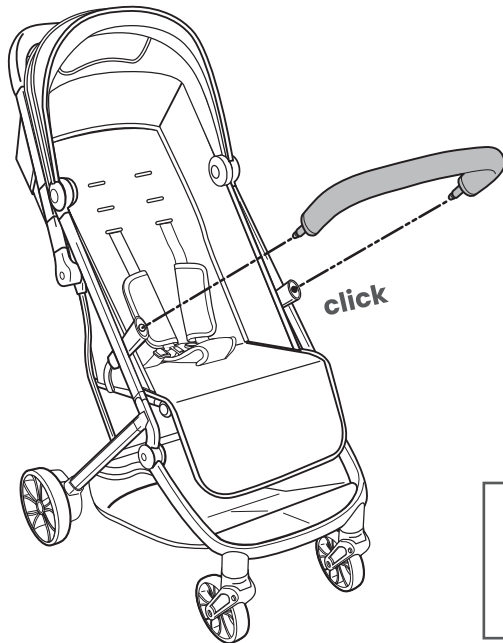

- 5 Attach your cup holder/ water holder/ wine holder (the options are endless)- line up the slot on the back with the mounting post and push down

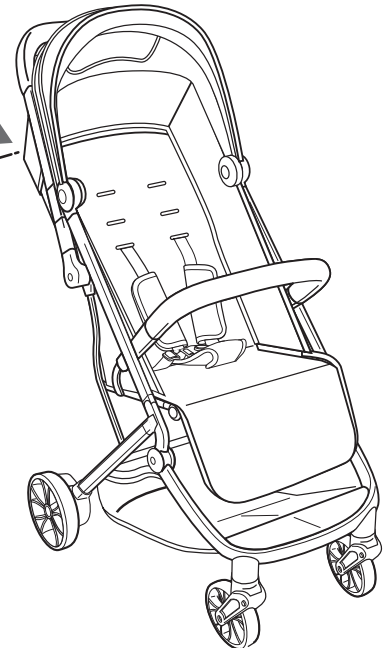
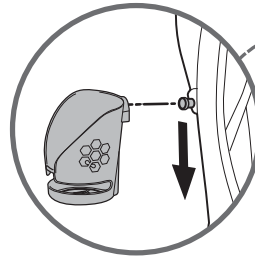

**NOTE: Max weight of the cup holder 1 lb (.45kg).  
Max weight of storage pocket 1/2 lb (.22kg)**

- 6 Open your canopy. optional: unzip the canopy extension for maximum sun blockage

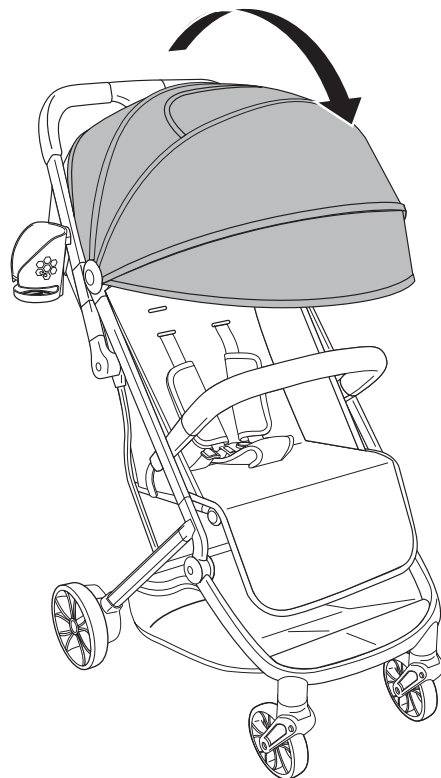
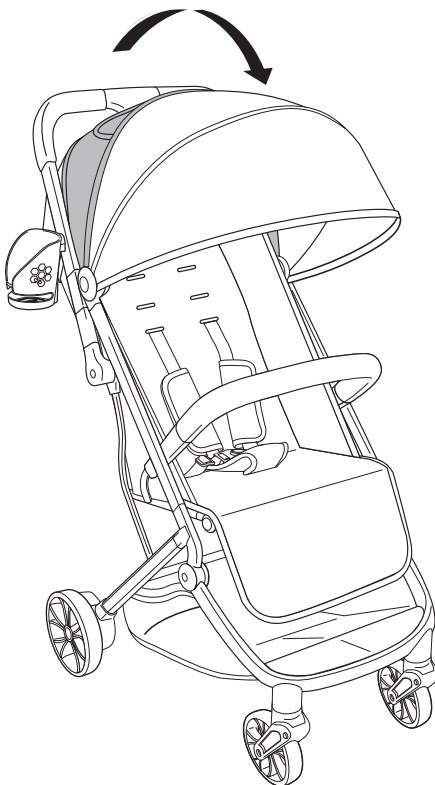

# THE HOW TO'S

## LOCKING & UNLOCKING THE 5-POINT SAFETY HARNESS:

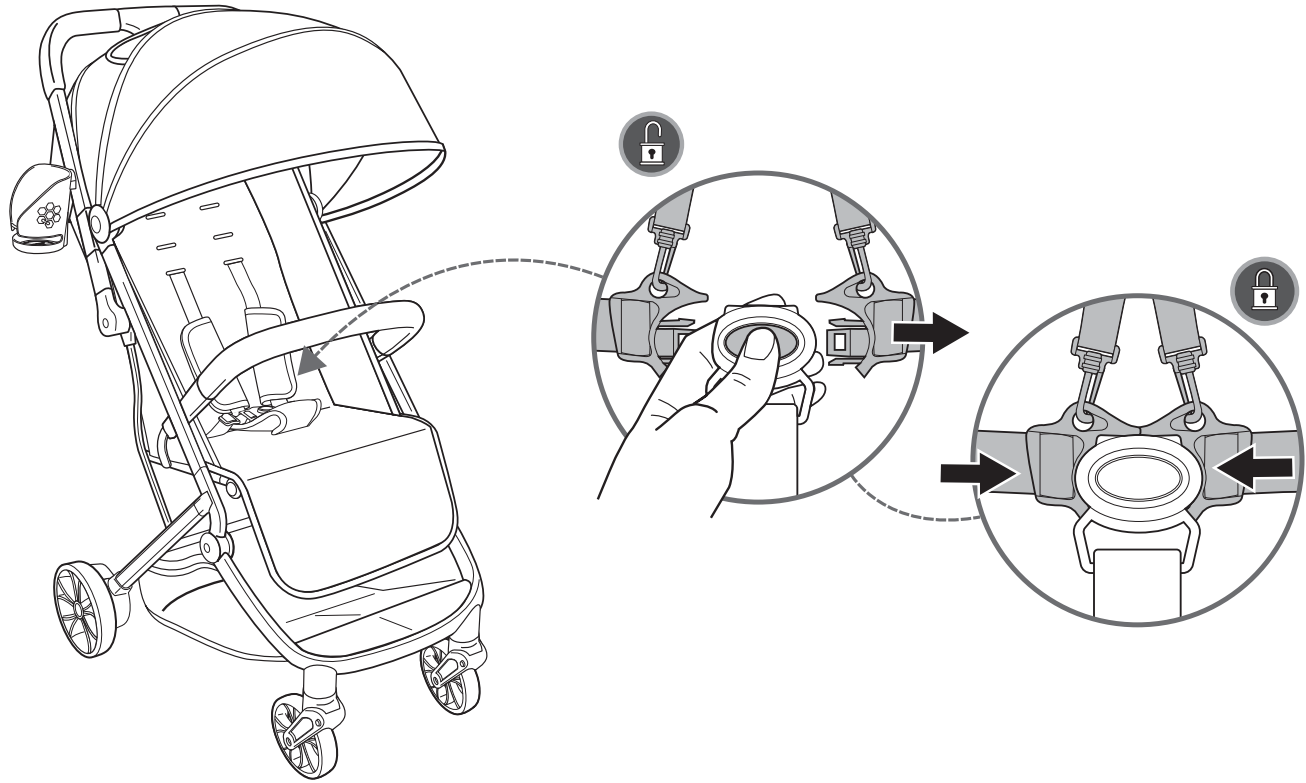

## TIGHTENING & LOOSENING THE 5-POINT SAFETY HARNESS:

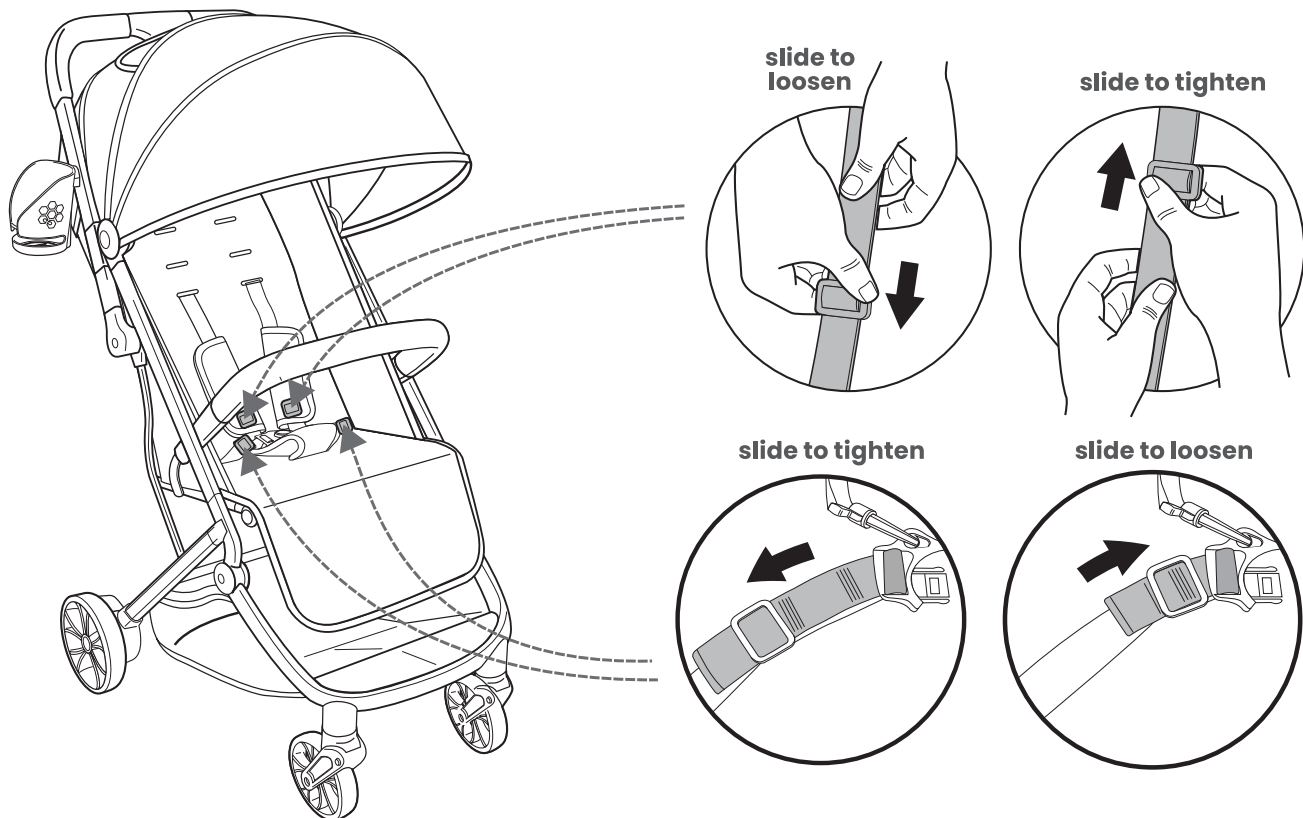

# ADJUSTING THE SHOULDER HARNESS POSITION

- 1 From behind the seat back, gently pull on the harness anchor to loosen the strap, then rotate harness anchors 90° so they can be pushed through height adjustment holes, as shown in images 1 & 2
- 2 Place anchor at desired height and slide back through the hole, see images 3 & 4.
- 3 Be sure harness anchors are flush to the seat back by gently tugging the harness to ensure the straps are securely attached.

**NOTE: Do not remove harness pads from straps during height adjustment.**

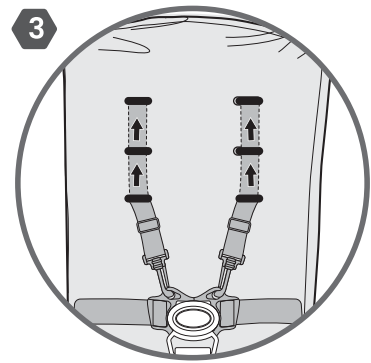
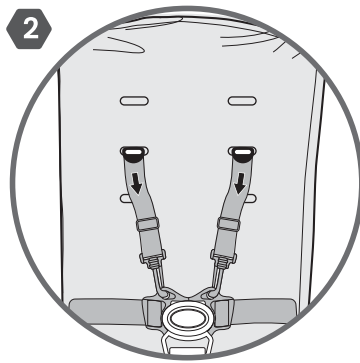
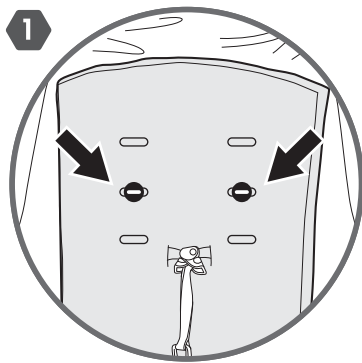

**NOTE: Shoulder straps should be at or below your child's shoulder (not above).**

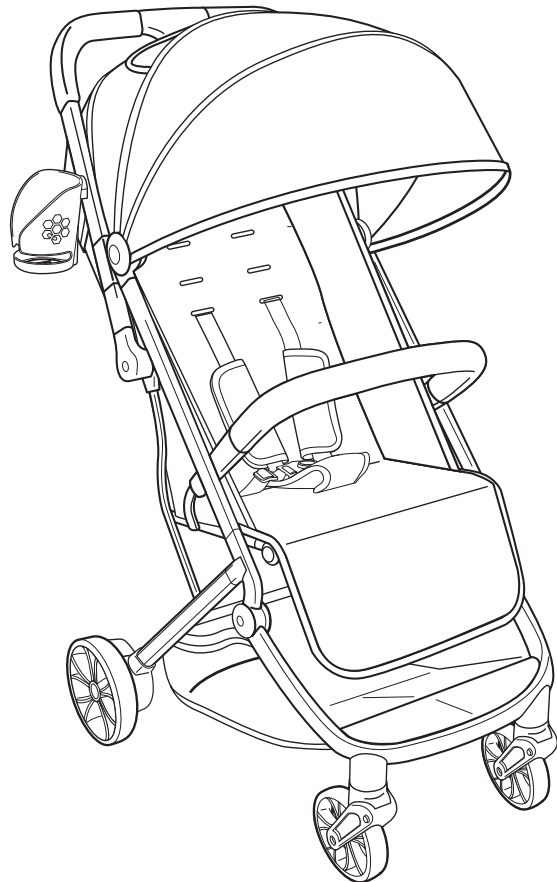



# REAR BRAKE PEDAL

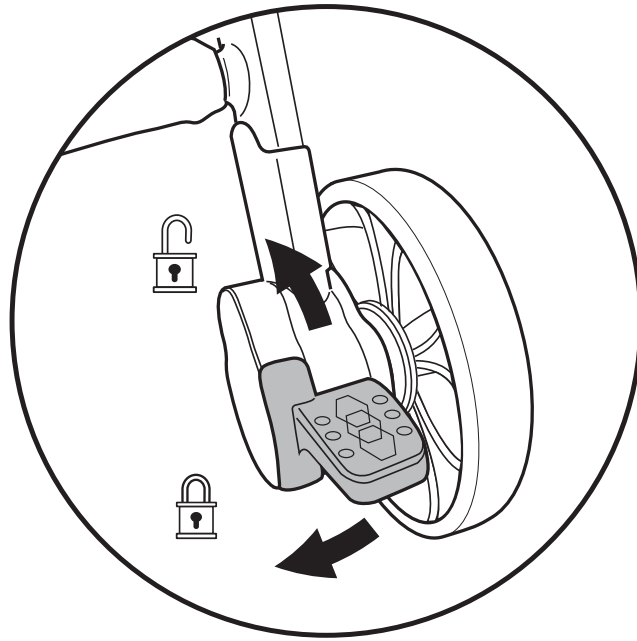

## ADJUSTING THE SEAT RECLINE

READY TO SNOOZE? US TOO,  
BUT HERE'S HOW TO WORK THE RECLINE.

Pinch seat recline clip on back of the stroller seat and slide along webbing to adjust seat recline angle up & down

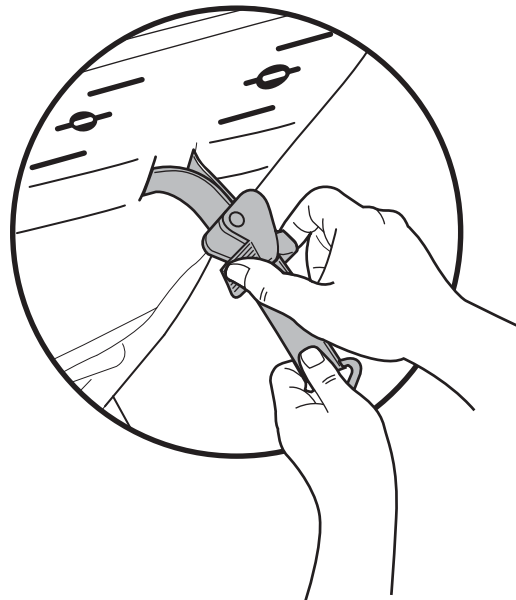
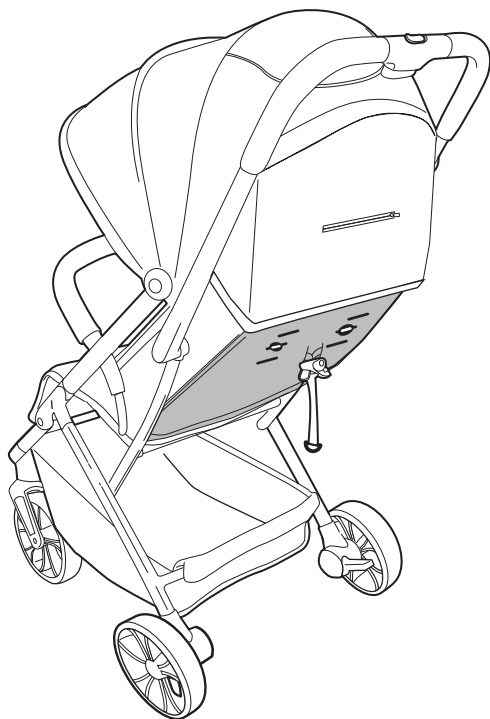

# ADJUSTING THE LEG REST POSITION

BEING A KID IS TOUGH, KICK THOSE TOOTSIES UP!

- 1 Raise leg rest up until it locks into desired maxin' & relaxin' position

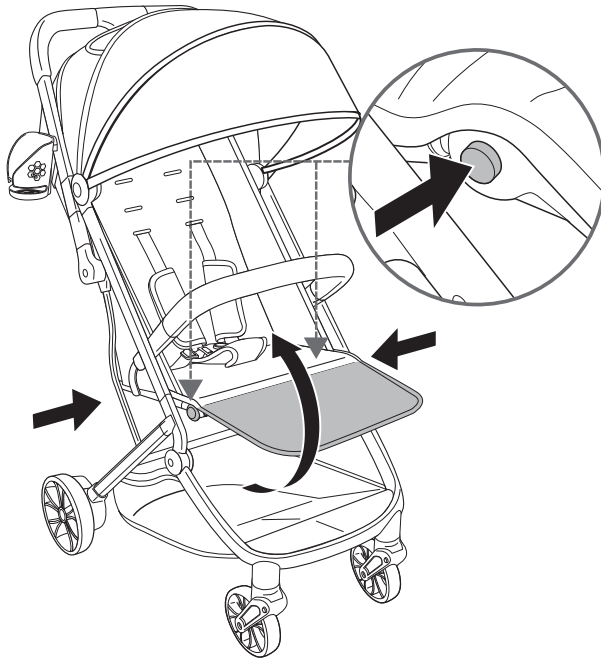

- 2 Press the buttons on the side of the leg rest and rotate leg rest down to lower the angle

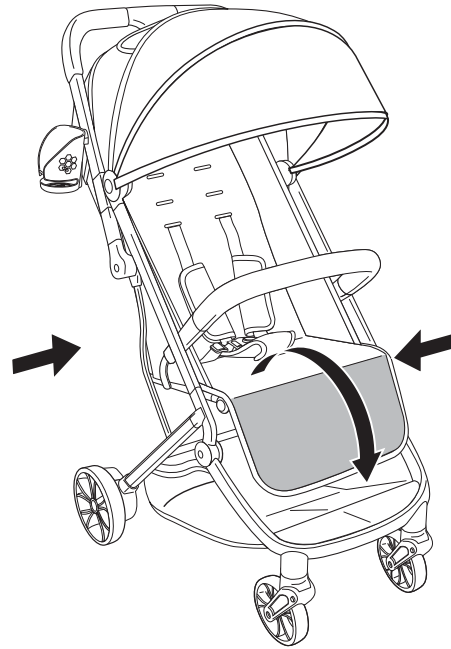

## PEEK-A-BOO WINDOW

HAS IT BEEN 47 SECONDS & YOU WANT TO CHECK ON YOUR BEEBS?

Flip up the peek-a-boo window on top of the canopy!  
Magnets = quiet = no waking a sleeping baby



# FOLDING YOUR STROLLER

**NOTE: Please remove your baby before folding.**

- 1 Flip canopy back into storage position
- 2 Slide small button to the left
- 3 While holding small button to the left, squeeze large button & release stroller. Your Bēbee stroller will automatically fold & stand upright.

Cool, right? We think so, too.

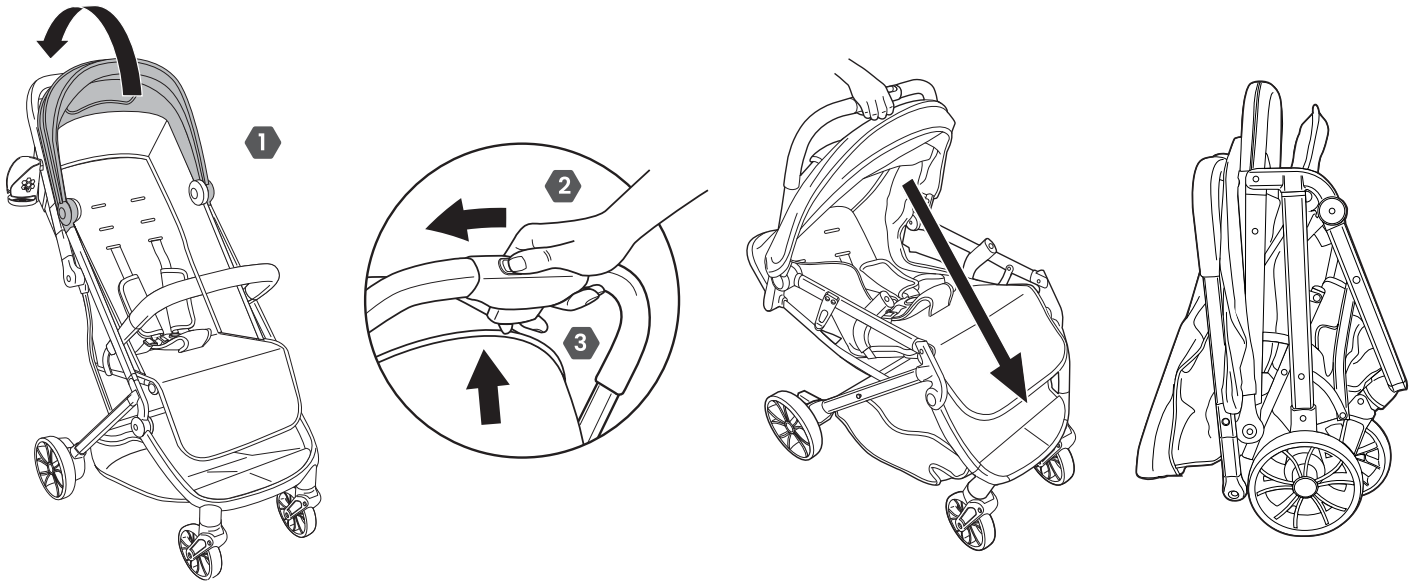

# UNFOLDING YOUR STROLLER

- 1 Slide small button to the left
- 2 While holding small button to the left, squeeze the large button & quickly pull up the stroller by the handle until it is fully open and you hear a click

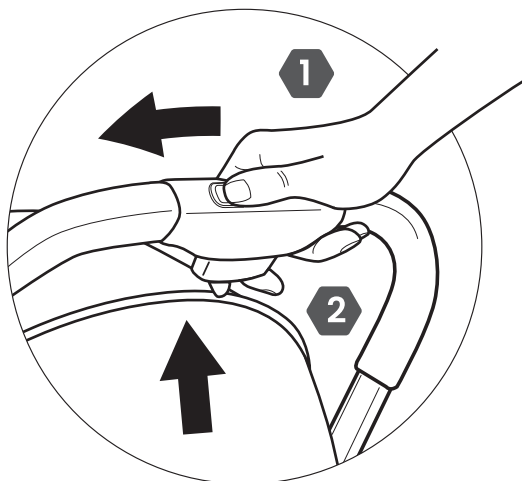

**NOTE: When opening the stroller, ensure that your child, or other children, are at a safe distance.**

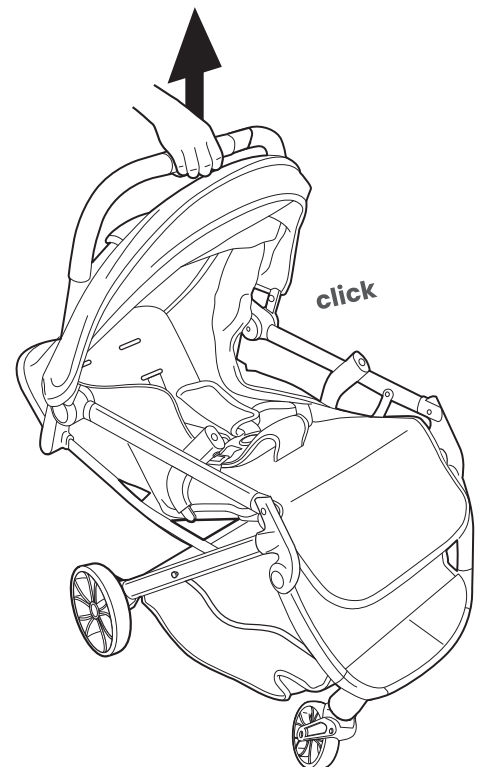

# REMOVING COMPONENTS

## REMOVING THE BUMPER BAR:

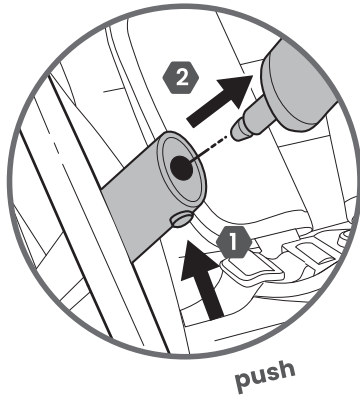

## REMOVING THE WHEELS:

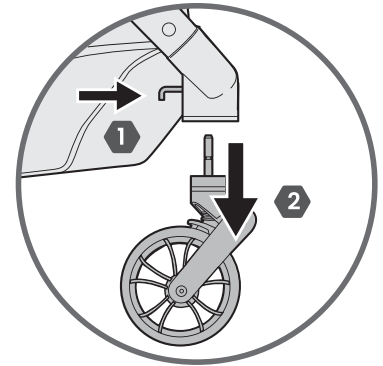
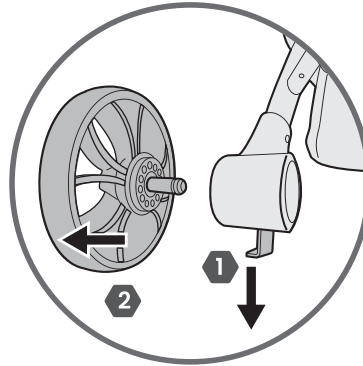

# CARE AND MAINTENANCE

Clean minor stains on fabric with cold water and mild soap

Clean plastic and metal surfaces with a soft damp cloth. Air dry.  
Do not use abrasive cleaners. Do not use bleach.

Check seat pad harness, crotch strap, and buckles to ensure they are properly secured to frame.

# ACCESSORIZE YOUR BOMBI STROLLER

**Rain Cover**  
Item No. 52000

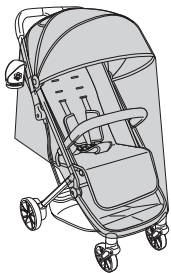

**Bug Net**  
Item No. 52001

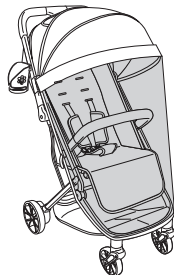

**Infant Car Seat Straps\***  
Item No. 52002

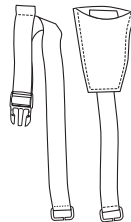

**Cup Holder**  
Item No. 52003

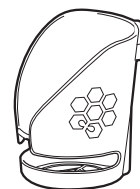

**Travel Bag**  
Item No. 52004



\* Infant Car Seat Straps are compatible with only certain carseats.  
Please check website for complete compatibility list.

We stand behind all of our products. If you are not completely satisfied or have any questions, please contact our Consumer Relations Team at [info@bombigear.com](mailto:info@bombigear.com) or call 401 300 5522.

© 2021 Memm, LLC, 1561 Hartford Ave, Johnston, RI 02919 USA MADE IN CHINA