

AXUS

AXK4

USER MANUAL

ELECTRONIC DRUM KIT

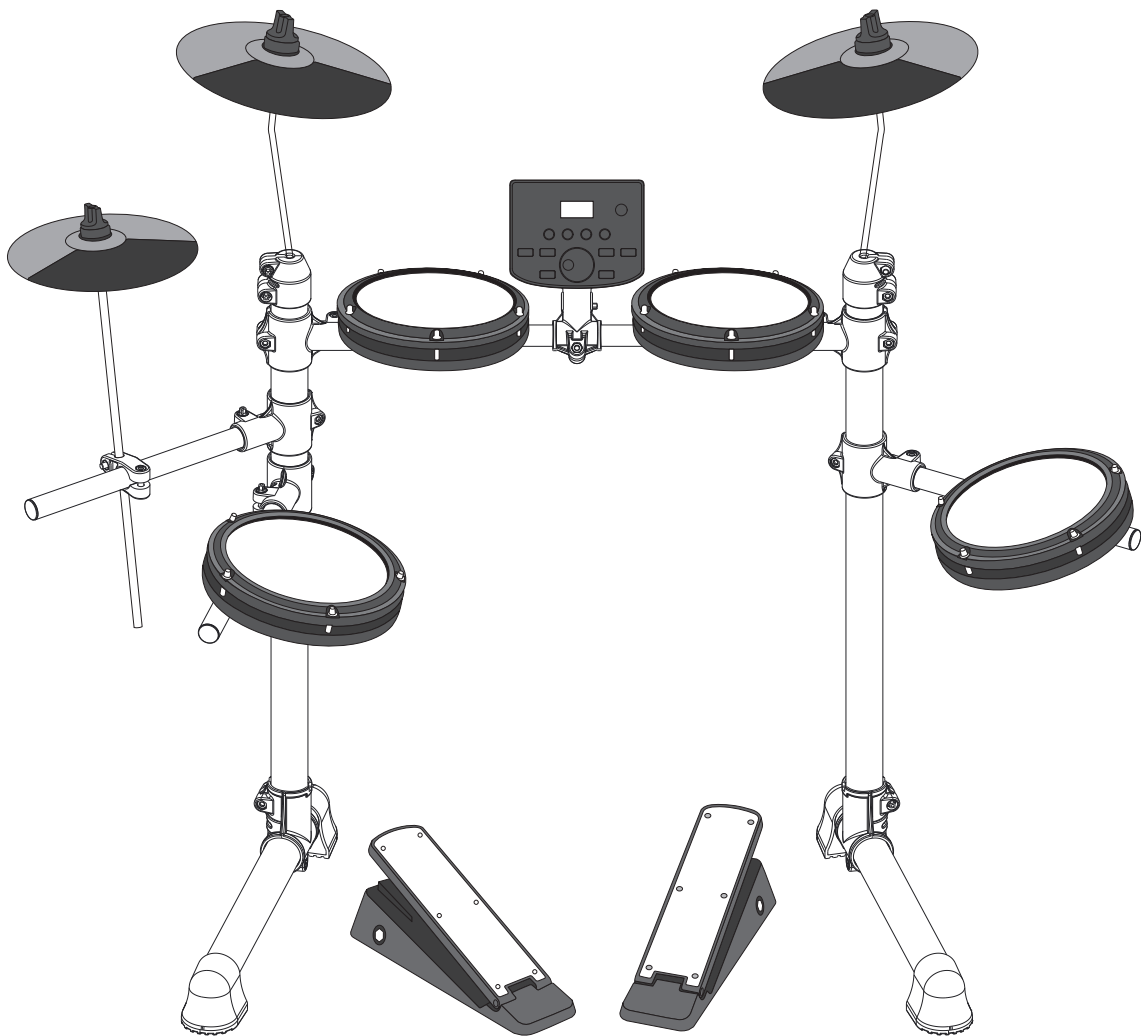

This product is subject to change without prior notice



INTRODUCTION

Thank you for choosing our electronic drum kit. Before using this product, please read the instructions and warnings in detail.

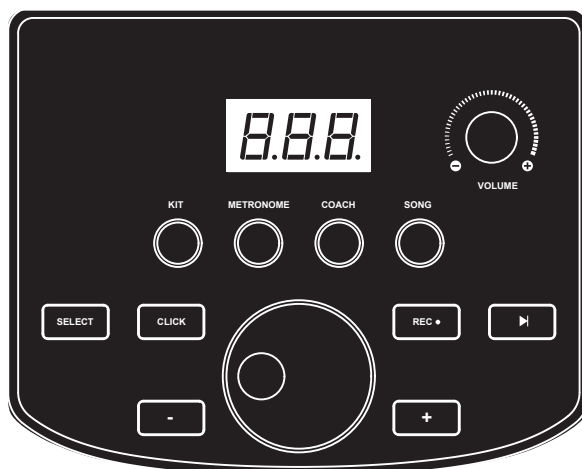

- 6 layers
- 15 sets of drums
- 165 timbres
- 30 songs
- Adjustable drum sensitivity
- Three teaching modes
- Speed control: 30 ~ 250 beats / min
- Metronome: 1-4 types
- Other functions: parameter storage, reset and recording
- Three digit LED display
- Connectivity: power supply DC, USB MIDI, headphones, audio input, audio output

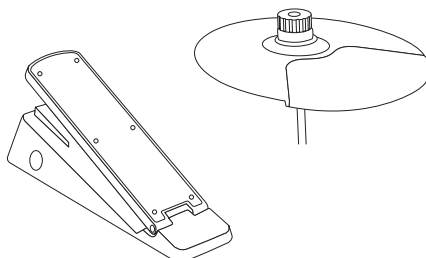

CAUTION!

- This product is an electro-acoustic instrument. It is normal to hear a little current sound in the speakers or headphones after power-on.
- Keep away from radio, TV, antenna receiver, router, refrigerator, TV, motor and other RF electrical interference sources during use.



CONTENTS

INTRODUCTION	1
CONTENTS	2
INSTALLATION GUIDE	3
CHECK THE INCLUDED ITEMS	3
STAND PIPE FITTING	4
DRUM PAD INSTALLATION	4
MOUNTING BRACKET AND DRUM	5
INSTALL CYMBALS, SOUND MODULE AND PLACE PEDALS	6
INSERT CONNECTION CABLE	7
SOUND MODULE DIAGRAM	8
POWER SUPPLY CONNECTION	8
USB MIDI PORT	8
AUDIO OUTPUT PORT	8
AUDIO INPUT PORT	8
HEADPHONE PORT	8
OPERATION GUIDE	9
POWER	9
DRUM KIT SELECTION	9
METRONOME	9
PRACTICE FUNCTION	9
COACH MODE	9
DEMO SONG	10
DRUM PARAMETERS	10
RECORDING FUNCTION	10
SAVE / RESET	10
USB MIDI	10
APPENDIX	11
DRUM SOUNDS	11
PRESET DRUM KITS	11
USER DEFINED DRUM KITS	11
DEMO SONGS	11
PRODUCT MAINTENANCE	12
SAFETY PRECAUTIONS	13



INSTALLATION GUIDE

WARNING!

- Please follow the instructions and read the safety precautions carefully before using.
- This product must be installed by an adult, please do not let children install it independently.

01

Check the included items

• After opening the package, please check whether it contains all the items immediately. If there are any missing, please contact your dealer.

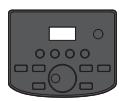

Sound module



Module bracket

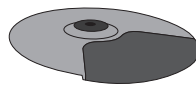

Hi-hat

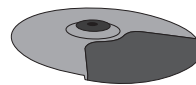

Ride

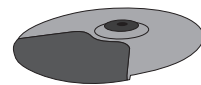

Crash



Tom
(3pcs)



Snare



Drum sticks

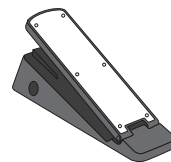

Hi-hat pedal

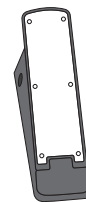

Kick pedal



Ride/Crash arm



Hi-hat arm

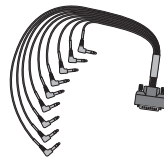

Signal connection cable



Power adapter

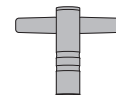

Drum key

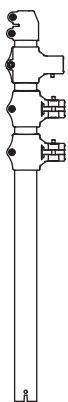

Left base leg



Right base leg



Left foot



Right foot



Middle support bar

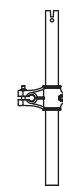

Hi-Hat cymbal support bar



Snare/Tom support bar*2



INSTALLATION GUIDE

02

Stand pipe fitting

•The stand is located in a small individual package inside the box.

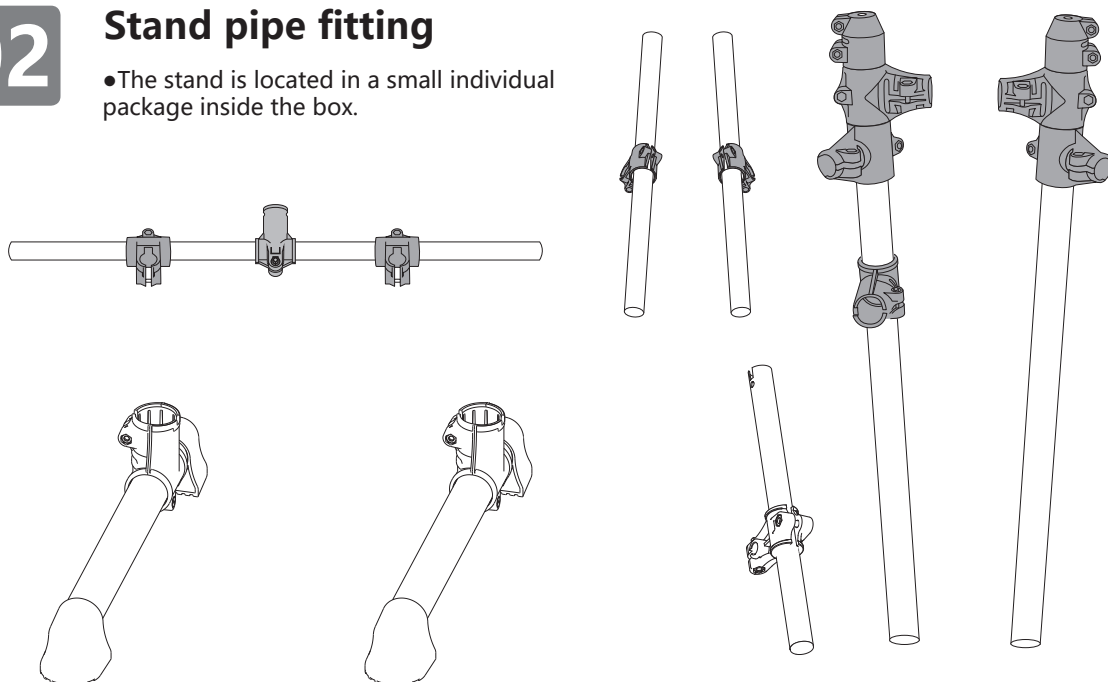

03

Drum pad installation

•Please be careful and do not to pinch your fingers when installing.

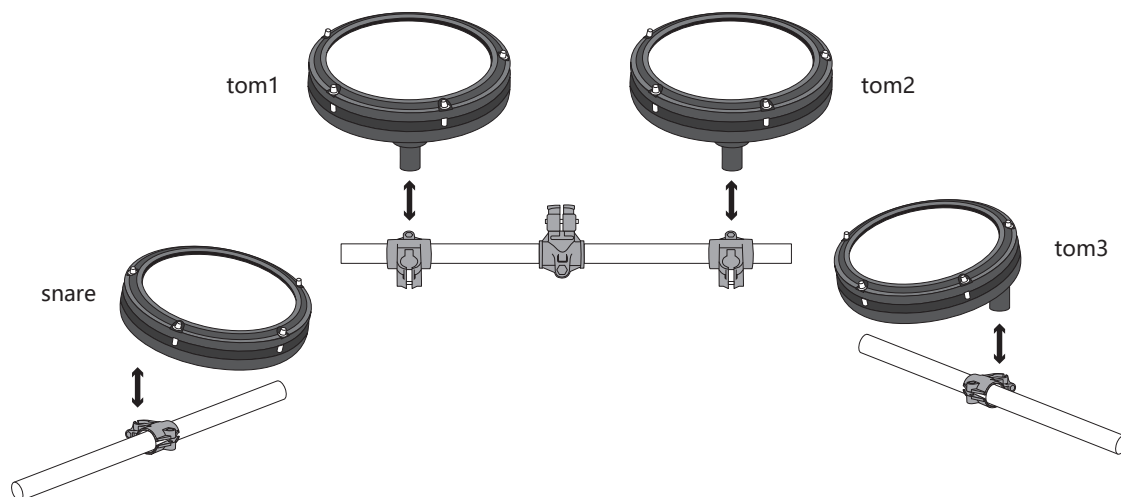



04

Mounting bracket

- The bracket needs to be inserted into place and the screws tightened to avoid dropping.

Insert the bracket and drum pads into the corresponding positions and then tighten the screws.

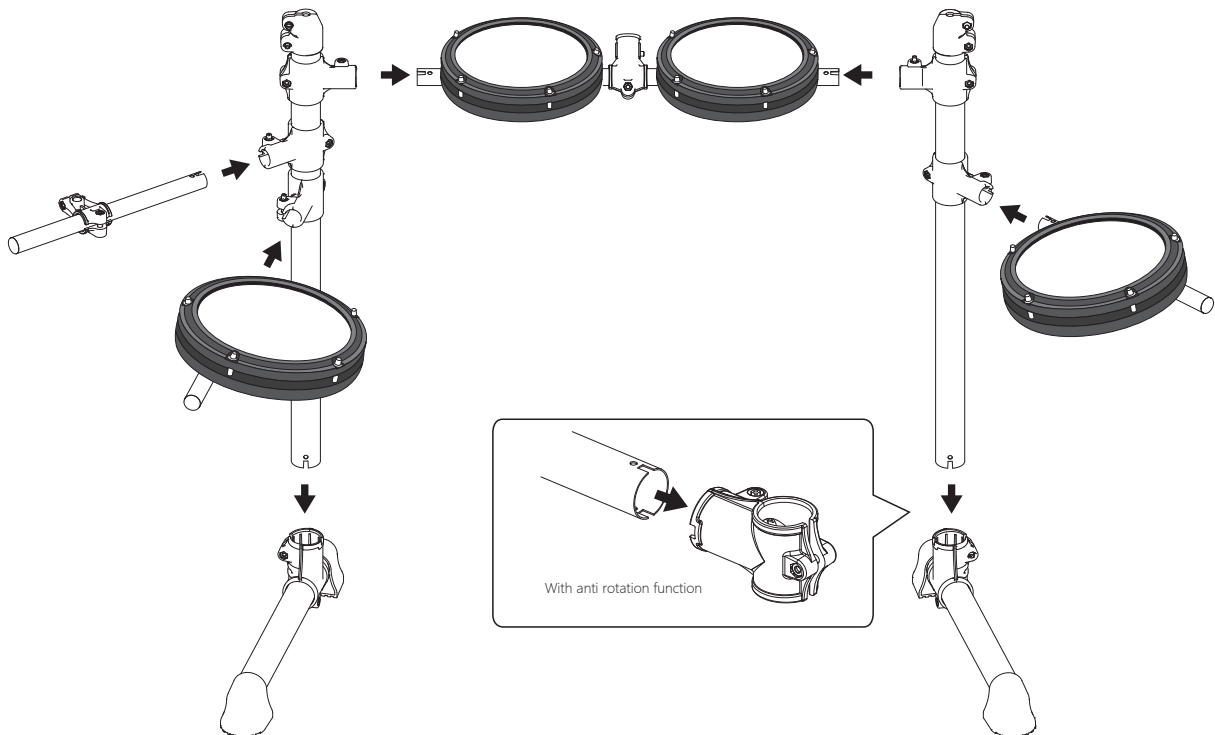
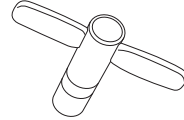



INSTALLATION GUIDE

05

Install cymbals, sound module, place pedals

- Do not tighten the cymbal too tightly, leave some space for them to snake up and down.

Install the cymbal and the sound module on the bracket as shown in the picture.





06

Insert the connection cable

- Please insert the connection cable correctly as shown in the diagram to avoid poor contact. Each drum/cymbal is noted on the coloured cable end, use the diagram to connect the correct cable to the corresponding position.

The Foot Switch must be switched to "B" for the pedal to work.

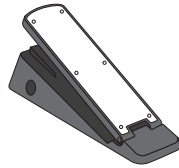

***This product adopts mode B**

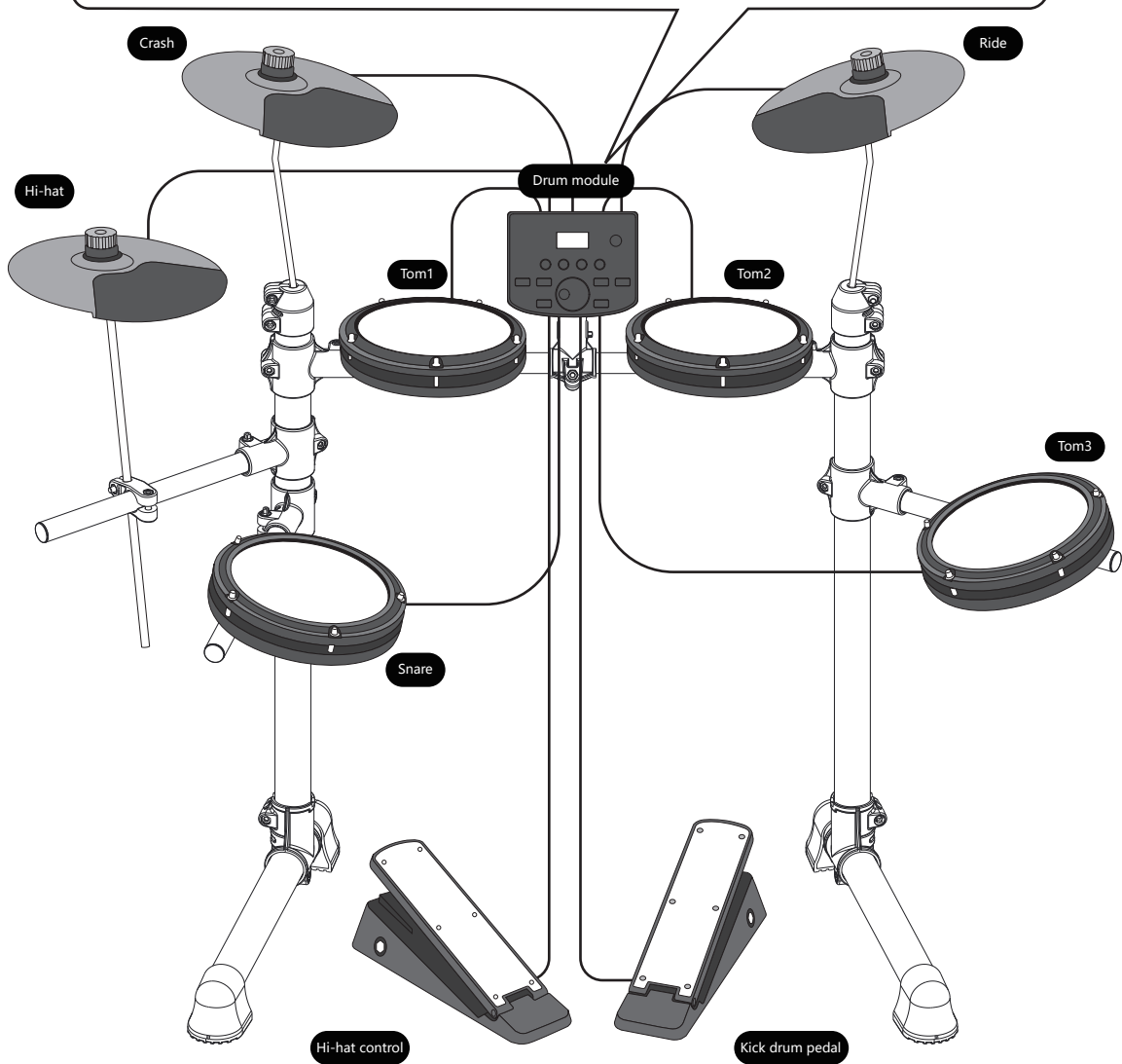
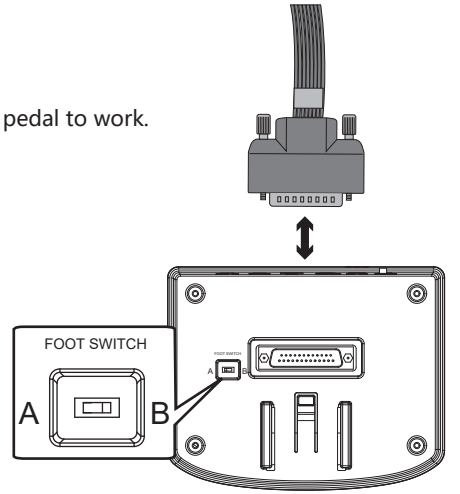



SOUND MODULE DIAGRAM

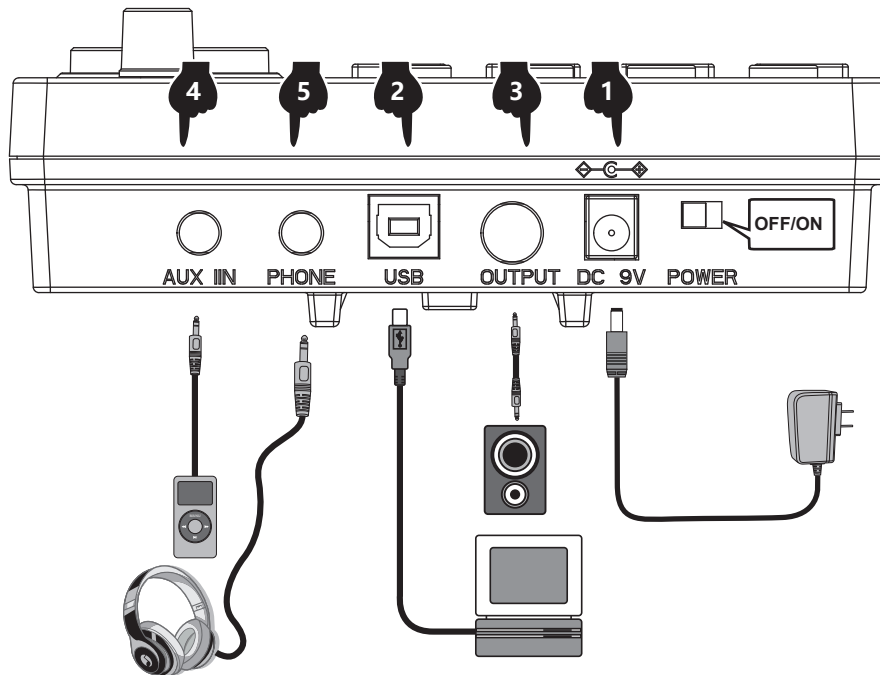

1 POWER SUPPLY CONNECTION

1. Connect the power supply according to the diagram (DC 9V). (Fig. 1)
2. If you do not use this product for a long time, please pull out the power plug and store in a safe place.

2 USB MIDI PORT

1. By connecting a computer or device to the USB port, you can learn to play, compose and store music with pre-installed software from your computer. Use a USB type B cable. (Fig. 2)
2. When connected to a computer or device, the audio output of the device needs to be connected to the audio input (PHONE) socket of the module box in order to synchronize the sound effects on the device. (Fig. 5)

3 AUDIO OUTPUT PORT

The audio output port (OUTPUT) can be connected to an active speaker (electronic drum speaker is recommended) or large audio equipment. (Fig. 3)

4 AUDIO INPUT PORT

The audio input port (AUX IN) can connect the sound from your device (such as MP3 or mobile phone) so you can play along with your favourite songs. (Fig. 4)

5 HEADPHONE PORT

Connect a set of standard stereo headphones to not disturb others around you when playing without connecting speakers. (Fig. 5)

CAUTION!

- To prevent damage to the equipment or hearing loss, turn the volume to minimum before connecting any devices.



OPERATION GUIDE

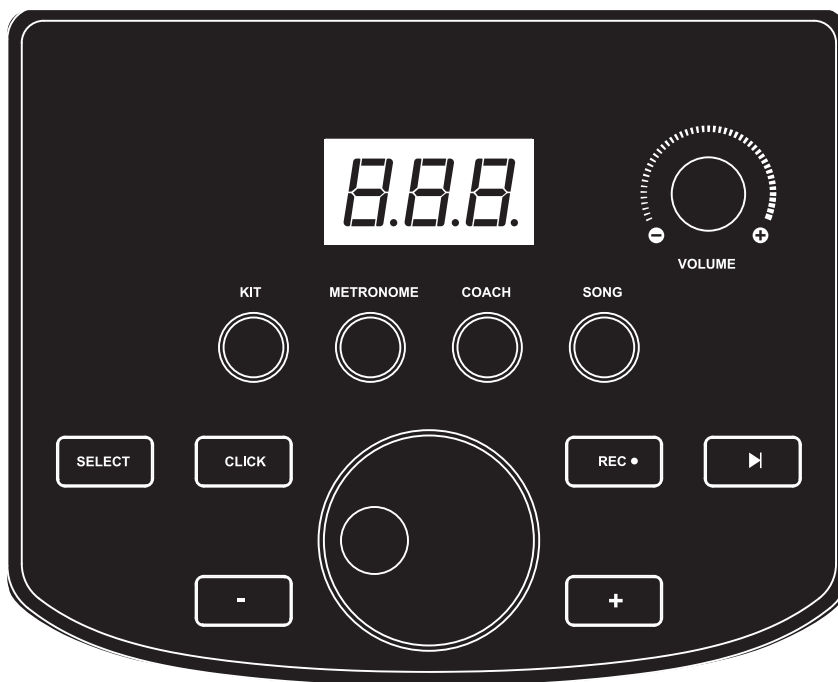

1 POWER

1. Insert the DC plug into the DC 9V port on the top of the module. Slide the POWER switch to the right (viewed from the front) to power up the drum kit. To turn the drum kit off slide the switch to the left.

2 DRUM KIT SELECTION

1. Press the KIT button to show the current drum kit. Turn the parameter wheel or use the -/+ buttons to select the desired drum kit. There are 15 drum kits to choose from - see drum kit list on page 11.

3 METRONOME

1. Press the METRONOME button to enter the metronome mode.
2. The screen will display the speed value (120 BPM default speed). Turn the parameter wheel or use the -/+ buttons to change the metronome speed. Press the CLICK button to start the metronome.
3. Press the SELECT button in metronome mode, the screen will jump to the metronome parameter adjustment interface. You can press the -/+ buttons to select the parameter you want to adjust:
r (beat type:2,4,8,16), b (beat number: 01-09), L (metronome volume: 00-31), and then turn the parameter wheel to adjust the parameter settings.
4. Once the parameters have been adjusted, press the SELECT button to confirm and exit the parameter interface. Then use the CLICK button to start and stop the metronome as desired.

4 PRACTICE FUNCTION & COACH MODE

1. The coach mode of this product can help establish speed, accuracy, endurance and help cultivate the practice of a better sense of rhythm. Make progress under the supervision of the coach mode! Press the COACH button to enter the coach mode. In this mode, there are three practice modes. Select the practice mode through the data wheel or -/+ button:
 - i. Exercise mode 1: C-1 beat detection exercise: beat the drum at a fixed speed to train the accuracy of the blow.
 - ii. Practice mode 2: C-2 silent strike mode: the metronome will sound one section and mute one section to train the strike accuracy without metronome prompt. It is an advanced version of practice mode 1.
 - iii. Practice mode 3: C-3 speed strike practice, the metronome will automatically change the speed from the slowest to the fastest and then the fastest to the slowest.



OPERATION GUIDE

2. Once the coaching mode has been chosen, press the CLICK button. The metronome beats will start and you can play along on the drum for practice.

3. After four preliminary beats, the display will show:

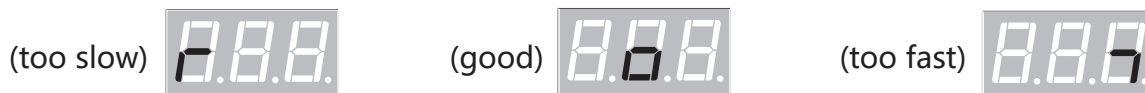

4. Once you have completed the coaching mode a score will be displayed from 0-100 evaluating the accuracy of the exercise.

C-1 mode: Press the SELECT button to enter the parameter setting interface. You can adjust the number of practice sessions as required (01-32). The number of sessions to practice determines the length of this exercise.

C-2 mode: Press the SELECT button to enter the parameter setting interface. You can adjust the number of practice sessions as required (04-32). The number of sessions to practice determines the length of this exercise.

C-3 mode: Press the SELECT button to enter the parameter setting interface. You can adjust the rate at which the BPM changes (01-09 BPM).

5. Press the CLICK button again to end the coach mode.

6 DEMO SONGS

1. Press the SONG button to enter the demo mode, there are 30 demos to choose from. The screen will display the current demo song number (01-30).

2. Press the < ▶▶ button to start playing the demo songs. To stop playing press the < ▶▶ button again.

3. Turn the parameter wheel or press the -/+ buttons to select a demo song.

4. Press the SELECT button in song mode to jump to the song parameter setting interface.

You can turn the drum sound on or off by turning the parameter wheel (the drum sound is on by default).

5. Press the SELECT button to confirm and exit the parameter interface.

7 DRUM PARAMETERS

1. Press the KIT button and the screen will display 01 (drum kit number). Press SELECT to enter the drum parameter adjustment mode.

2. Tap the drum you want to adjust, then press the -/+ buttons to select the parameter for adjustment.

Sensitivity S (01-06). Trigger threshold t (01 - 32). Crosstalk threshold c (01 -32).

Repeated trigger r (01-32). Drum Force V (01-03). Drum volume L (00 - 31).

3. Change the parameters by rotating the parameter wheel and long press the - button to save. The screen will display SAV to indicate the parameter adjustment has been saved successfully.

4. To restore the drum parameters back to factory settings long press the + button until the screen displays RES.

PLEASE NOTE: The parameters for the 3 tom drums can not be set individually.

8 RECORDING FUNCTION

1. Press the < REC > button when the indicator light is in the "KIT" and "CLICK" states and the screen displays the words "REC" in the flashing state, entering the recording preparation state.

2. Tap any drum and the metronome sounds. At this time, the screen displays "---" in the flashing state and starts recording.

3. Press the < REC > key or < PLAY > key again, the recording stops and "A-1" is displayed on the screen.

4. Press < ▶▶ > to start playing the current recording and press again to stop playback.

5. If you enter the recording preparation state again without any drumming, the "A-1" recorded last time is played back.

9 SAVE / RESET

1. To save parameters long press the <-> button and the screen will display SAV.

2. To reset parameters long press the <+> button and the screen will display RES res.

10 USBMIDI

1. To use the drum kits MIDI function plug a USB-B data cable (not included with this drum kit) into the control unit and connect to PC/Smartphone.



APPENDIX

Sounds

Kick

- 1 Funk Kick
- 2 Original Kick
- 3 Poprock Kick
- 4 Rock Kick
- 5 Session Kick
- 6 Speed Metal Kick
- 7 Classic Dry Kick
- 8 Modern Kick
- 9 Jazz Kick
- 10 Blues Kick
- 11 Popular Kick
- 12 Fuse Kick
- 13 Dancehall Kick
- 14 Synthgaze Kick
- 15 Standard Kick

Snare

- 16 Funk Snare
- 17 Original Snare
- 18 Poprock Snare
- 19 Rock Snare
- 20 Session Snare
- 21 Speed Metal Snare
- 22 Classic Dry Snare
- 23 Modern Snare
- 24 Jazz Snare
- 25 Blues Snare
- 26 Popular Snare
- 27 Fuse Snare
- 28 Dancehall Snare
- 29 Synthgaze Snare
- 30 Standard Snare
- 31 Funk Snare Rim
- 32 Original Snare Rim
- 33 Poprock Snare Rim
- 34 Rock Snare Rim
- 35 Session Snare Rim
- 36 Speed Metal Snare Rim
- 37 Classic Dry Snare Rim
- 38 Modern Snare Rim
- 39 Jazz Snare Rim
- 40 Blues Snare Rim
- 41 Popular Snare Rim
- 42 Fuse Snare Rim
- 43 Dancehall Snare Rim
- 44 Synthgaze Snare Rim
- 45 Standard Snare Rim

Tom

- 46 Funk Tom1
- 47 Original Tom1
- 48 Poprock Tom1
- 49 Rock Tom1

- 50 Session Tom1
- 51 Speed Metal Tom1
- 52 Classic Dry Tom1
- 53 Modern Tom1
- 54 Jazz Tom1
- 55 Blues Tom1
- 56 Popular Tom1
- 57 Fuse Tom1
- 58 Dancehall Tom1
- 59 Synthgaze Tom1
- 60 Standard Tom1
- 61 Funk Tom2
- 62 Original Tom2
- 63 Poprock Tom2
- 64 Rock Tom2
- 65 Session Tom2
- 66 Speed Metal Tom2
- 67 Classic Dry Tom2
- 68 Modern Tom2
- 69 Jazz Tom2
- 70 Blues Tom2
- 71 Popular Tom2
- 72 Fuse Tom2
- 73 Dancehall Tom2
- 74 Synthgaze Tom2
- 75 Standard Tom2
- 76 Funk Tom3
- 77 Original Tom3
- 78 Poprock Tom3
- 79 Rock Tom3
- 80 Session Tom3
- 81 Speed Metal Tom3
- 82 Classic Dry Tom3
- 83 Modern Tom3
- 84 Jazz Tom3
- 85 Blues Tom3
- 86 Popular Tom3
- 87 Fuse Tom3
- 88 Dancehall Tom3
- 89 Synthgaze Tom3
- 90 Standard Tom3

Crash

- 91 Funk Crash
- 92 Original Crash
- 93 Poprock Crash
- 94 Rock Crash
- 95 Session Crash
- 96 Speed Metal Crash
- 97 Classic Dry Crash
- 98 Modern Crash
- 99 Jazz Crash

- 100 Blues Crash
- 101 Popular Crash
- 102 Fuse Crash
- 103 Dancehall Crash
- 104 Synthgaze Crash
- 105 Standard Crash

Ride

- 106 Funk Ride
- 107 Original Ride
- 108 Poprock Ride
- 109 Rock Ride
- 110 Session Ride
- 111 Speed Metal Ride
- 112 Classic Dry Ride
- 113 Modern Ride
- 114 Jazz Ride
- 115 Blues Ride
- 116 Popular Ride
- 117 Fuse Ride
- 118 Dancehall Ride
- 119 Synthgaze Ride
- 120 Standard Ride

Hi-Hat

- 121 Funk Hi-Hat Open
- 122 Original Hi-Hat Open
- 123 Poprock Hi-Hat Open
- 124 Rock Hi-Hat Open
- 125 Session Hi-Hat Open
- 126 Speed Metal Hi-Hat Open
- 127 Classic Dry Hi-Hat Open
- 128 Modern Hi-Hat Open
- 129 Jazz Hi-Hat Open
- 130 Blues Hi-Hat Open
- 131 Popular Hi-Hat Open
- 132 Fuse Hi-Hat Open
- 133 Dancehall Hi-Hat Open
- 134 Synthgaze Hi-Hat Open
- 135 Standard Hi-Hat Open
- 136 Funk Hi-Hat Close
- 137 Original Hi-Hat Close
- 138 Poprock Hi-Hat Close
- 139 Rock Hi-Hat Close
- 140 Session Hi-Hat Close
- 141 Speed Metal Hi-Hat Close
- 142 Classic Dry Hi-Hat Close
- 143 Modern Hi-Hat Close
- 144 Jazz Hi-Hat Close
- 145 Blues Hi-Hat Close
- 146 Popular Hi-Hat Close

- 147 Fuse Hi-Hat Close
- 148 Dancehall Hi-Hat Close
- 149 Synthgaze Hi-Hat Close
- 150 Standard Hi-Hat Close
- 151 Funk Hi-Hat Pedal
- 152 Original Hi-Hat Pedal
- 153 Poprock Hi-Hat Pedal
- 154 Rock Hi-Hat Pedal
- 155 Session Hi-Hat Pedal
- 156 Speed Metal Hi-Hat Pedal
- 157 Classic Dry Hi-Hat Pedal
- 158 Modern Hi-Hat Pedal
- 159 Jazz Hi-Hat Pedal
- 160 Blues Hi-Hat Pedal
- 161 Popular Hi-Hat Pedal
- 162 Fuse Hi-Hat Pedal
- 163 Dancehall Hi-Hat Pedal
- 164 Synthgaze Hi-Hat Pedal
- 165 Standard Hi-Hat Pedal

Preset Drum Kits

- 01 Funk
- 02 Original
- 03 Poprock
- 04 Rock
- 05 Seesion
- 06 SpeedMetal

- 07 ClassicDry
- 08 Modern
- 09 Jazz

User Defined Drum Kits

- 10 Blues
- 11 Popular
- 12 Fuse
- 13 Dancehall
- 14 Synthgaze
- 15 Standard

Demo songs

- | | | | | | | | | |
|----------|----------|----------|----------|----------|----------|----------|----------|----------|
| Song 001 | Song 011 | Song 021 | Song 002 | Song 012 | Song 022 | Song 003 | Song 013 | Song 023 |
| Song 004 | Song 014 | Song 024 | Song 005 | Song 015 | Song 025 | Song 006 | Song 016 | Song 026 |
| Song 007 | Song 017 | Song 027 | Song 008 | Song 018 | Song 028 | Song 009 | Song 019 | Song 029 |
| Song 010 | Song 020 | Song 030 | | | | | | |



PRODUCT MAINTENANCE

Careful maintenance and protection extends the service life of the product and reduces faults.

1 AVOID HEAT, DAMP OR DIRECT SUNLIGHT

Do not expose the product to excessive dust or vibrations, or extreme cold or heat (such as in direct sunlight, near a heater, or in a car during the day).

2 DO NOT USE NEAR THE TV OR RADIO

Do not use this product in the vicinity of a TV, radio, stereo equipment, mobile phone, or other electric devices. Otherwise, this product or the other device may generate noise.

3 DO NOT USE CHEMICALS FOR CLEANING

When cleaning the product, use a soft and dry (or slightly damp) cloth. Do not use paint thinners, solvents, alcohol, cleaning fluids, or chemical-impregnated wiping cloths.

4 DO NOT SHAKE, AVOID COLLISION

Do not place the product in an unstable position or a location with excessive vibration, where it might accidentally fall over and cause injury.



SAFETY PRECAUTIONS

POWER SUPPLY

Use only the supplied or the specified AC adapter. Do not use the AC adapter for other devices. When not in use, please turn off the power supply. When not in use for a long time, pull out the power cord and store it securely.

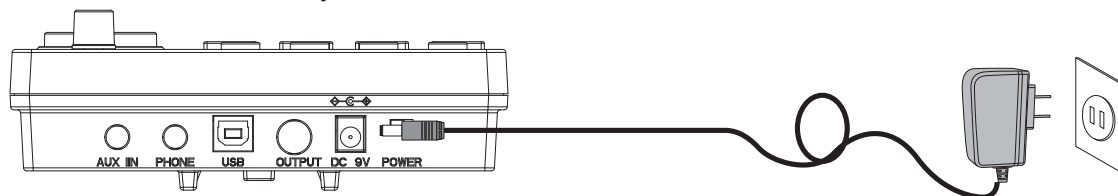

To ensure that you use this product safely and correctly, to prevent harm to users and others and financial damage, this manual and products are marked with a series of safety signs. The various signs and their meanings are as follows:

WARNING

This sign indicates that there is a potential risk of death or serious injury if this mark is ignored and the product is mishandled.

CAUTION

This sign indicates that there is a potential danger of injury to personnel or other financial damage if this sign is ignored and the product is operated incorrectly.

NOTICE



This triangle sign indicates what users should pay attention to. (The left example is careful of shocks).



A circular sign with an oblique line indicates prohibitions. The icons in or beside the logo indicate the contents specifically prohibited. (The example on the left is no disassembly).



The round black bottom sign indicates what must be observed. The diagrams in this sign indicate the contents must be observed. (The example on the left is that the power plug must be pulled out of the socket)



SAFETY PRECAUTIONS

WARNING



Smoke, odour, overheating

When the product smokes, smells or overheats, there is a danger of fire and electric shock when it is used continually. In case of the above situation, the following operations should be performed immediately:



1. Turn off the power supply
2. Pull the plug out of the power outlet.
3. Contact your dealer.





Power cable

The improper use of the power cable may cause fire or electric shock. The following precautions must be observed:

- The special power cord designated for this product must be used. 
- The AC power supply with output voltage within the rated voltage range for household use must be used. 
- Do not overload power sockets and extension lines. 



The improper treatment of the power cable will lead to its damage or breakage, which will cause fire and electric shock hazards. The following precautions must be observed:

- Do not place or heat heavy objects on power cables. 
- Do not attempt to alter or bend the power cable too much.
- Do not twist or pull the power cable.
- If the power cable or plug is damaged, please replace with the same type of power cable. 

- Do not touch the power cord and plug with wet hands, otherwise there is a danger of electric shock. 
- Do not use the power cable around water. Water is a danger of causing fire and electric shock. 
- Never place vases or any other container with water on this product. 
- Do not allow minors to unplug and touch power cable or connection boards. 

CAUTION

The improper use of power cable may cause fire and electric shock. The following precautions must be observed:

- Never put the power cable near the oven or other heat source. 
- Do not pull on the cable when pulling out of the power socket. The main body of the plug must be grasped.
- The power cable plug must be inserted in the socket to the end.
- Make sure the power supply is off before connecting or disconnecting it.
- When thunderstorms occur or before travelling or other long-term departure, disconnect the power cable from the wall outlet. 
- At least once a year, remove the power cable from the wall outlet and clean the dust accumulated around the plug.

Do not burn this product

Do not put this product in the fire, otherwise it will lead to product combustion and explosion of internal electronic components, which will cause fire and personal injury. 

Water and foreign bodies

Water, other liquids and (metal sheets, etc.) entering this product are in danger of causing fire and electric shock. In case of the above situation, the following operations shall be performed immediately: 

1. Turn off the power supply.
2. Pull the plug out of the power outlet.
3. Contact your dealer.



Disassembly and modification



This product contains no user-serviceable parts. Do not attempt to disassemble the internal parts or modify them in any way. This could cause a risk of electric shock, scald or other personal injury. 





SAFETY PRECAUTIONS

Location

- Do not place the product in an unstable position or a location with excessive vibration, where it might accidentally fall over and cause injury. 
- Before moving the product, remove all connected cables, to prevent damage to the cables or injury to anyone who might trip over them.
- Use only the stand specified for the product. When attaching it, use the provided screws only.
- Failure to do so could cause damage to the internal components or result in the product falling over.
- Climbing the bracket is dangerous. Families with young children should pay special attention to it. 
- If the product falls or is damaged by strong impact, it will be in danger of causing fire and electric shock. In case of the above situation, the following operations shall be performed immediately:
 1. Turn off the power supply
 2. Pull the plug out of the power outlet.
 3. Contact your dealer.

- Incorrect assembly of the bracket may cause the product to fall off posing a risk of injury. Therefore, it must be assembled according to the instructions in the attached installation guide to ensure that the product is properly mounted on its bracket. 
- Dispose of plastic bags and packaging to avoid risk of asphyxia in young children. 

Connections

- Before turning the power on or off for all devices, set all volume levels to minimum. 
- Be sure to set the volumes of all devices at their minimum levels and gradually raise the volume controls while playing the product to set the desired listening level. Excessive volume can damage your hearing.
- The connections on the module can only be connected to the designated equipment and devices. Connecting non-designated equipment or devices is dangerous and could cause fire or electric shocks. 

Handling

- Do not insert foreign materials such as metal or paper into any openings or gaps of the product. 
- Failure to observe this may cause a fire, electric shocks, or malfunctions.
- Do not rest your weight on, or place heavy objects on the product, and do not use excessive force on the buttons, switches or connectors.
- Do not use the product or headphones for a long period of time at a high or uncomfortable volume level, since this can cause permanent hearing loss. If you experience any hearing loss or ringing in the ears, consult a physician.
- Remove the power plug from the AC outlet before cleaning the unit. Failure to observe this may cause electric shocks. 