

MUKOUYAMA KU-KAN

REALISTIC PAPER CRAFTS

# XJR1300

## PAPER CRAFT

ASSEMBLY INSTRUCTIONS



By assembling all parts referring to the symbols on the parts sheets and the assembly instructions, a paper craft model faithfully reproducing the "YAMAHA XJR1300" is completed.

- **Assembly instructions: Fourteen A4-sized sheets.**
- **Paper craft: Seventeen A4-sized sheets with 185 parts in all**

These **Assembly instructions** apply only to the "YAMAHA XJR1300."  
Please download the parts sheets separately.

These Paper Craft parts are easier to work with when printed out on strong, thick paper (Paper Weight in gsm: 127.9gms ~ 157.0gms, Thickness: 0.18mm ~ 0.22mm)

**Note: The copyright of this paper craft belongs to MUKOUYAMA KU-KAN.**



This paper craft is intended for personal enjoyment. The contents of the Paper Crafts (net drawing and instructions and assembled finished model), including the designs, text, and images, may not be quoted, reproduced, used, copied, distributed, modified, or sold without the permission of the author. However, please refrain from posting or exhibiting paper crafts for commercial purposes, such as explaining how to make paper crafts to the general public, or posting videos or images of paper crafts. These terms and conditions are deemed to be agreed upon upon opening the file. You are also deemed to have agreed to the terms of use and violations of the MUKOUYAMA KU-KAN website.

Copyright 2022 Nobutaka Mukoyama / MUKOUYAMA KU-KAN All Rights Reserved.

By using this paper craft, you agree to the terms and conditions of use of the MUKOUYAMA KU-KAN website.

## 1 To begin

### ■ Tools and materials needed

●Ruler ●Scissors ●Cutter knife ●Cutter mat (A4 size or larger) ●Stylus pen (for making folds) ●Pencil ●Tweezers ●Quick-drying wood glue (adhesive) ●Brush (for glue) ●Wipe cloth (to wipe off excess glue from the brush) ●Wipe cloth (to wipe off excess glue from brush) ●Hand towel to clean fingertips ●Acrylic board and weight (to ensure a level crimp) ●Aluminum rod(to round the paper) ●Containers (for temporary storage of parts) ●Memo blocks (to use as a palette for applying glue to brushes)

### ■ Items of Caution

\*Take care when using sharp or pointed objects or when using bladed cutting tools. Place a heavy sheet of paper under the paper you want to cut.

\*Use glue and other adhesives only in well-ventilated areas.

\*When printing, use a slightly reduced font size. There may be differences in dimensions, depending on the type of printer used.

## 2 How to assemble

\*Follow the working method and markings carefully.

\*Cut carefully along the outer line with cutting blade, Exacto-knife or scissors.

### One - point Advice

\*Cut carefully with cutting blade, Exacto-knife or scissors.

\*For folding parts, first use an awl or other pointed tool to make a light crease along the dotted or solid line. This will make the folds straight. Avoid making strong creases, as this will cause the paper to tear.

\*As an adhesive, white wood glue is recommended. Avoid over application as this may cause the paper to wrinkle.

\*Before beginning assembly, test adhesive amounts on extra paper.

## Basic working method and markings

### ————— Solid lines

Fold along these lines.  
The printed surface should be on the outside of the folded shape.

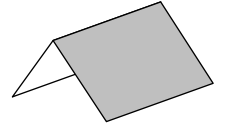

### ----- Broken lines

Fold along these lines.  
The printed surface should be on the inside of the folded shape.

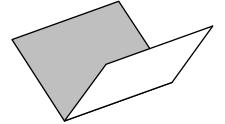

### ----- Dotted line

Cut along these lines.

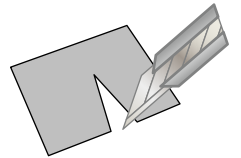

Do not fold or cut the parts marked X.

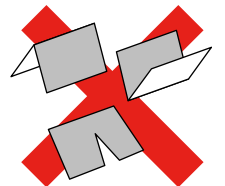

Cut out parts marked with an asterisk(\*).

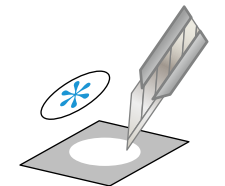

Red dots are the reference positions for gluing surfaces.

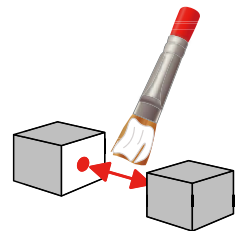

\*Please refer to the MUKOUYAMA KU-KAN website TECHNICAL for details on the crafting method.

# 3 Assembly

Please refer to the "Basic working method and markings" symbol chart on Page 2 to assemble each part.

Indication of Working Methods  Fold or Curve  Glue

## Fuel Tank

Sheet A, 1 part in total

Fold each relevant part according to the assembly symbols.

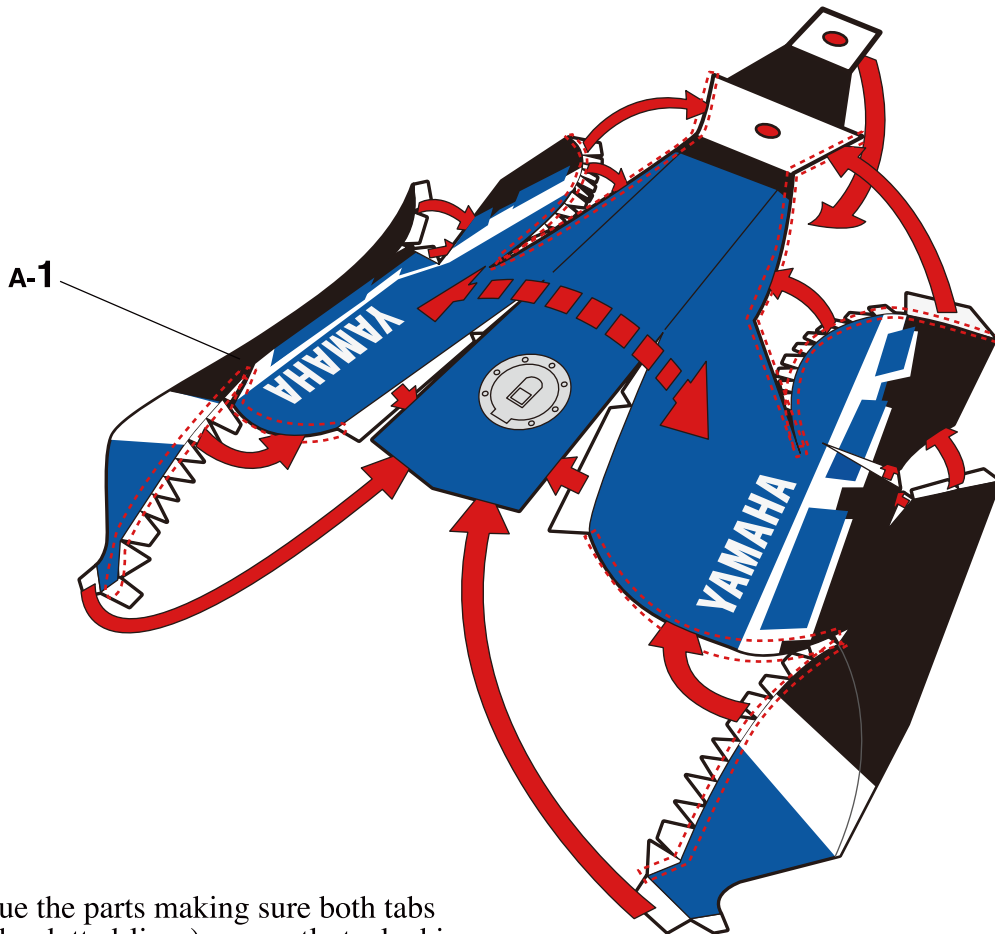

Fold and glue the parts making sure both tabs (illustrated by dotted-lines) are neatly tucked in.

### Reference photo



# 3 Assembly

Please refer to the "Basic working method and markings" symbol chart on Page 2 to assemble each part.

Indication of Working Methods

---> Fold or Curve    -> Glue

## Steering column

Sheet B, 36 parts in total

Fold each relevant part according to the assembly symbols.

Please use the ● dots on each component as reference when gluing surfaces.

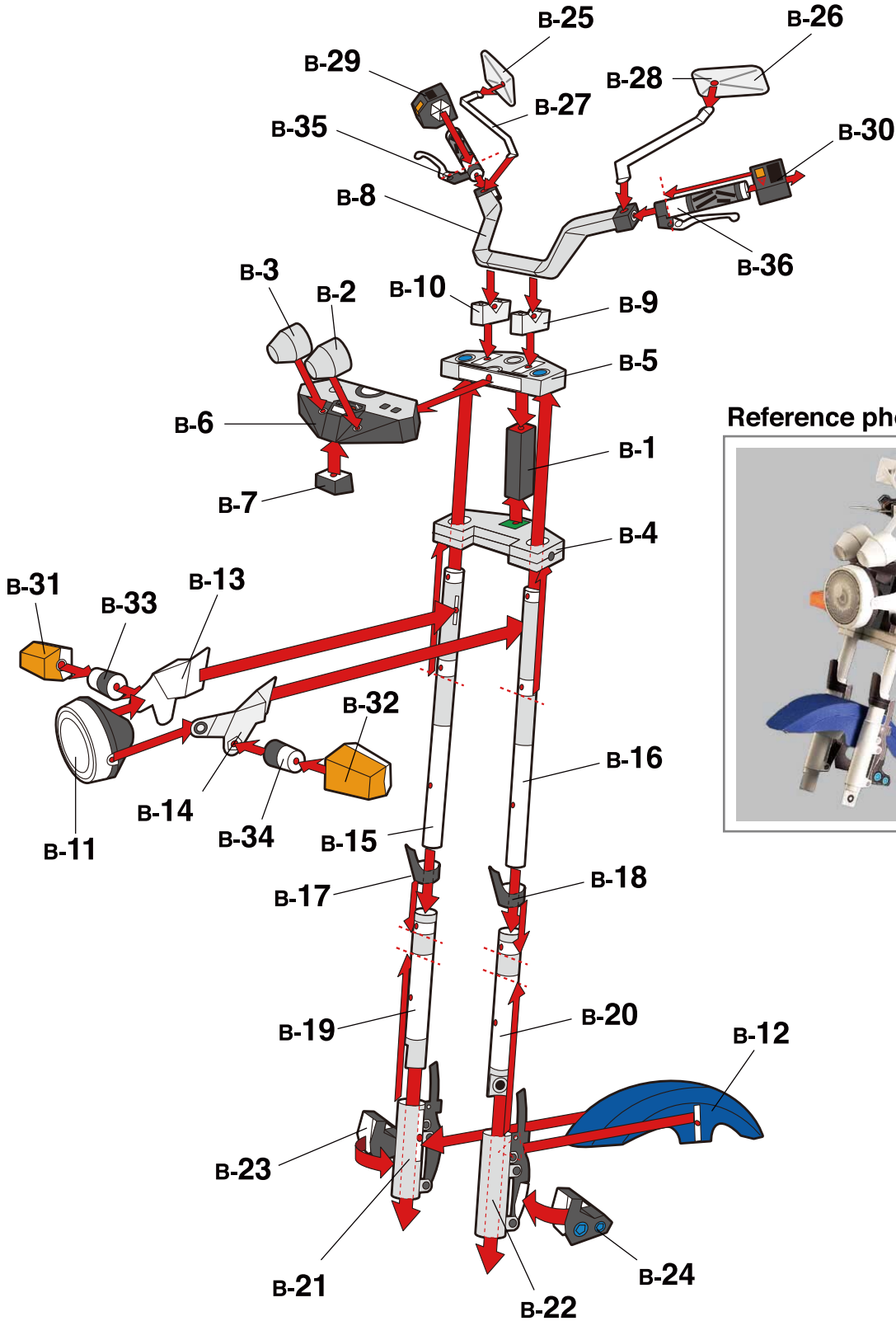

Reference photo



# 3 Assembly

Please refer to the "Basic working method and markings" symbol chart on Page 2 to assemble each part.

Indication of Working Methods

---> Fold or Curve    -> Glue

## Frame

Sheet C, 29 parts in total

Fold each relevant part according to the assembly symbols.

Please use the ● dots on each component as reference when gluing surfaces.

➡ in the diagram indicates where the parts are to be glued later.  
Please do not glue parts at this stage.

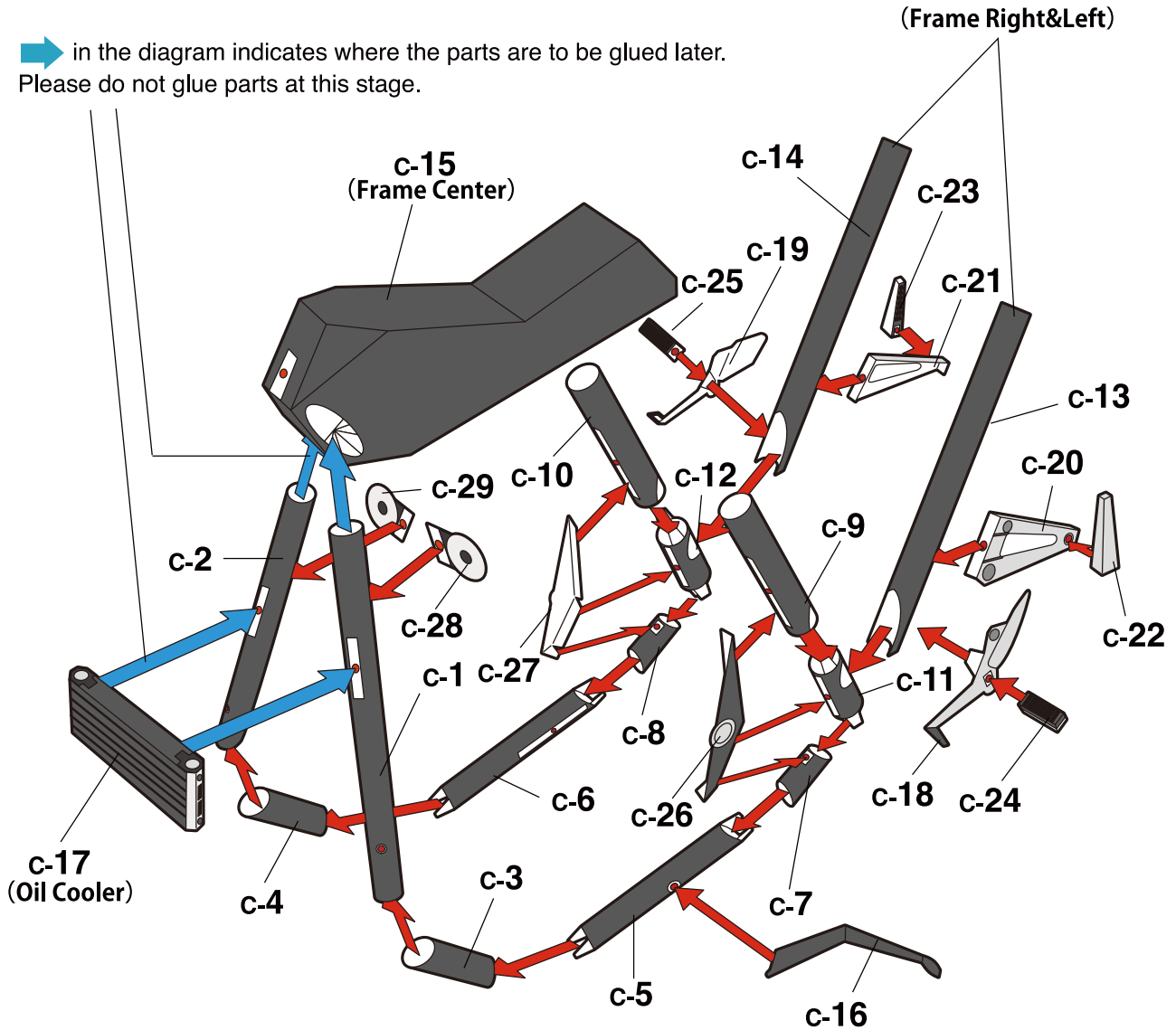

## Reference photo



# 3 Assembly

Please refer to the "Basic working method and markings" symbol chart on Page 2 to assemble each part.

Indication of Working Methods

---> Fold or Curve

→ Glue

## Engine

Sheet D, 38 parts in total

Fold each relevant part according to the assembly symbols.

Please use the ● dots on each component as reference when gluing surfaces.

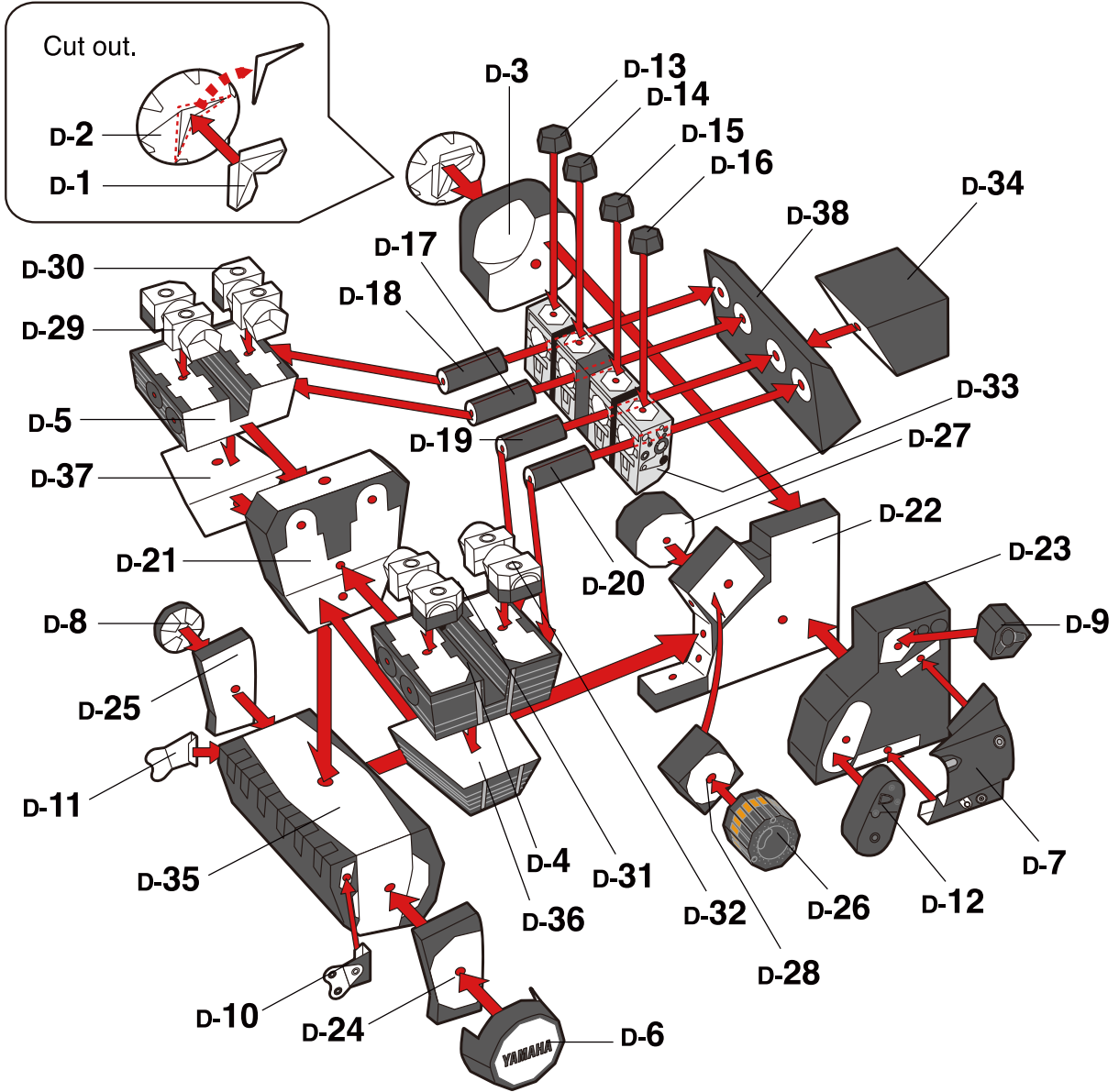

### Reference photo



# 3 Assembly

Please refer to the "Basic working method and markings" symbol chart on Page 2 to assemble each part.

Indication of Working Methods  Fold or Curve  Glue

## Exhaust

Sheet E, 23 parts in total

Fold each relevant part according to the assembly symbols.

Please use the ● dots on each component as reference when gluing surfaces.

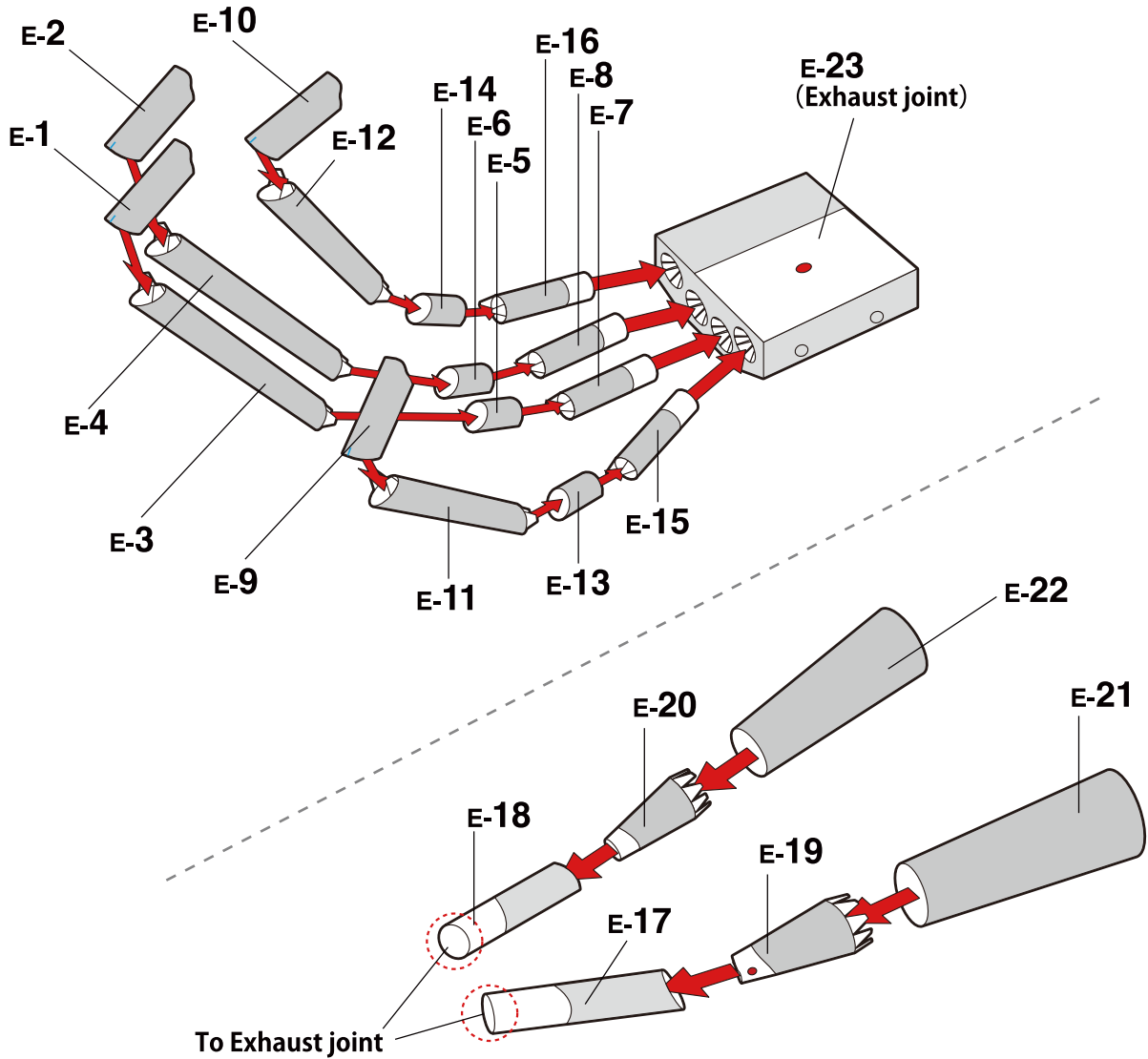

### Reference photo

Referring to the photo on the right, be careful of the angle when gluing each part.

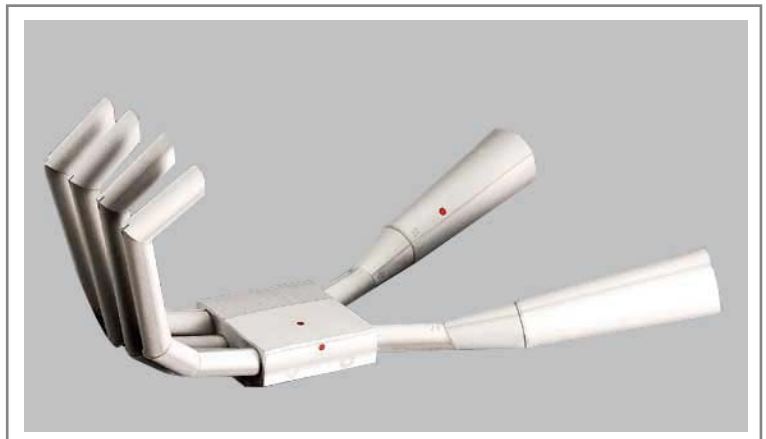

# 3 Assembly

Please refer to the "Basic working method and markings" symbol chart on Page 2 to assemble each part.

Indication of Working Methods

---> Fold or Curve    -> Glue

## Seat and Side Cover

Sheet F, 5 parts in total

Fold each relevant part according to the assembly symbols.

Please use the ● dots on each component as reference when gluing surfaces.

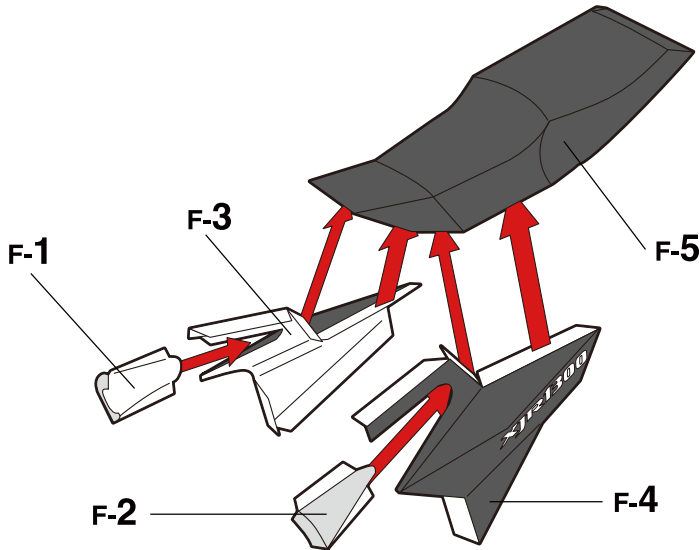

Reference photo

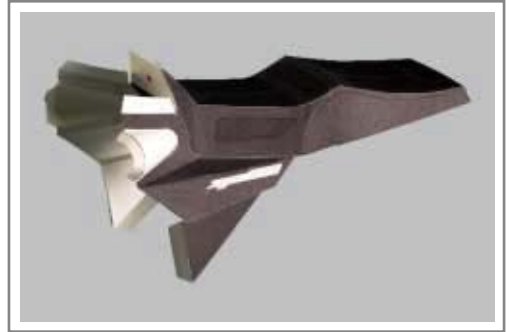

## Rear Arm

Sheet G, 7 parts in total

Fold each relevant part according to the assembly symbols.

Please use the ● dots on each component as reference when gluing surfaces.

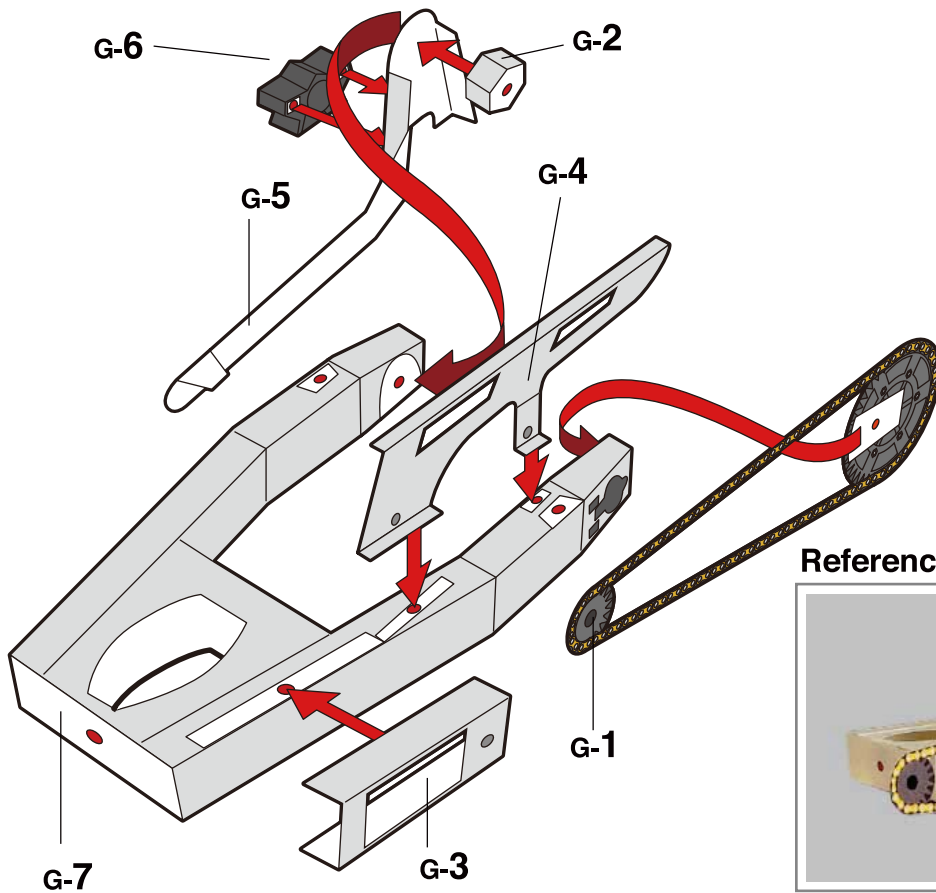

Reference photo

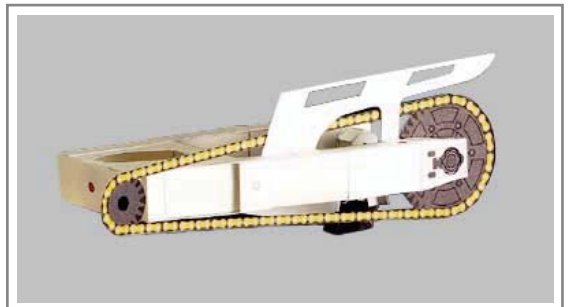



# 3 Assembly

Please refer to the "Basic working method and markings" symbol chart on Page 2 to assemble each part.

Indication of Working Methods

---> Fold or Curve    -> Glue

## Rear Suspensions

Sheet H, 10 parts in total

Fold each relevant part according to the assembly symbols.

Please use the ● dots on each component as reference when gluing surfaces.

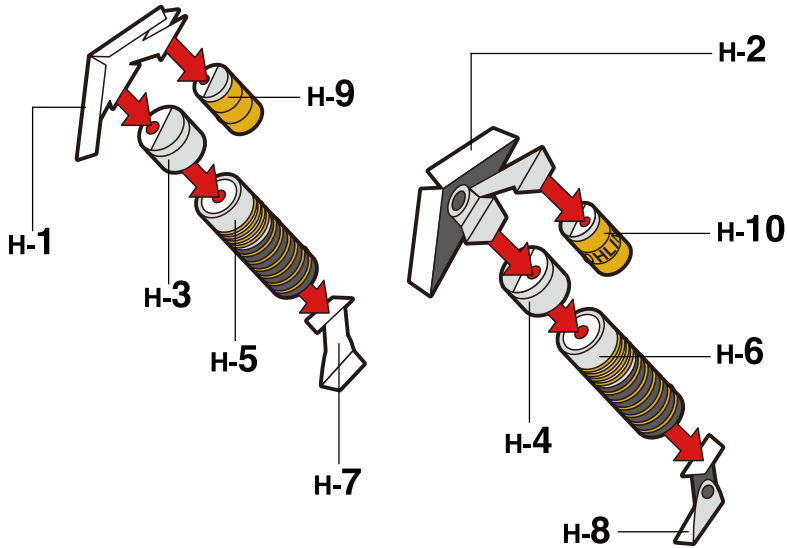

Reference photo



## Rear Fender

Sheet I, 9 parts in total

Fold each relevant part according to the assembly symbols.

Please use the ● dots on each component as reference when gluing surfaces.

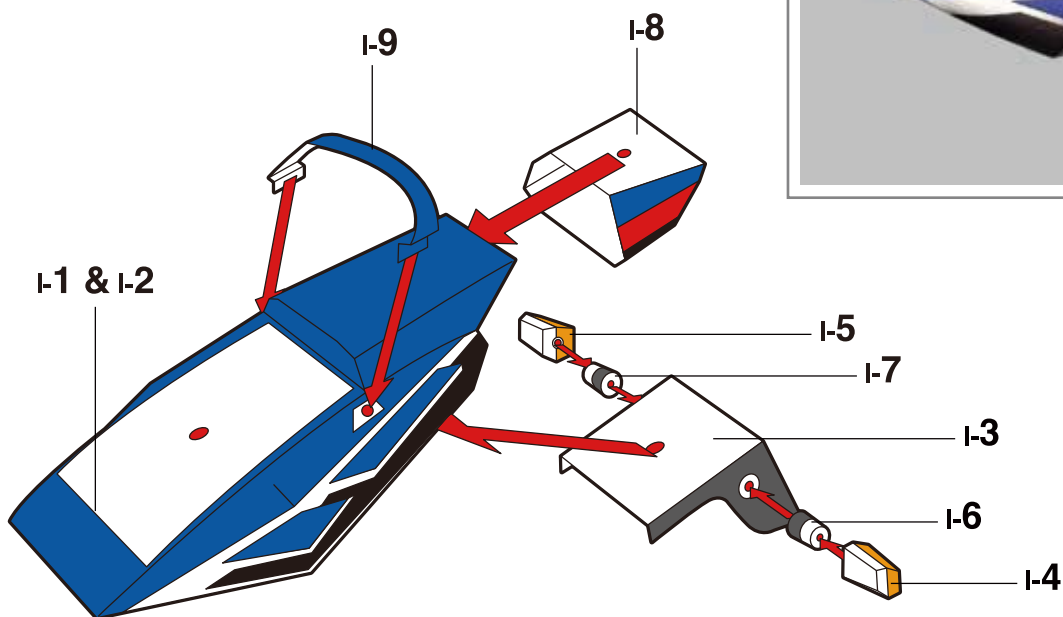

Reference photo

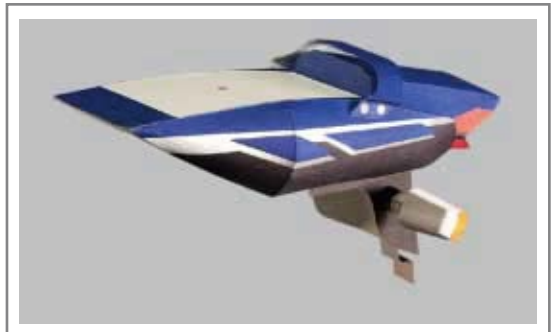

# 3 Assembly

Please refer to the "Basic working method and markings" symbol chart on Page 2 to assemble each part.

Indication of Working Methods

---> Fold or Curve    -> Glue

## Front tire

Sheet J, 14 parts in total

Fold each relevant part according to the assembly symbols.

Please use the ● dots on each component as reference when gluing surfaces.

\*Glue the completed front wheel to the assembled front tire.

### [Front tire]

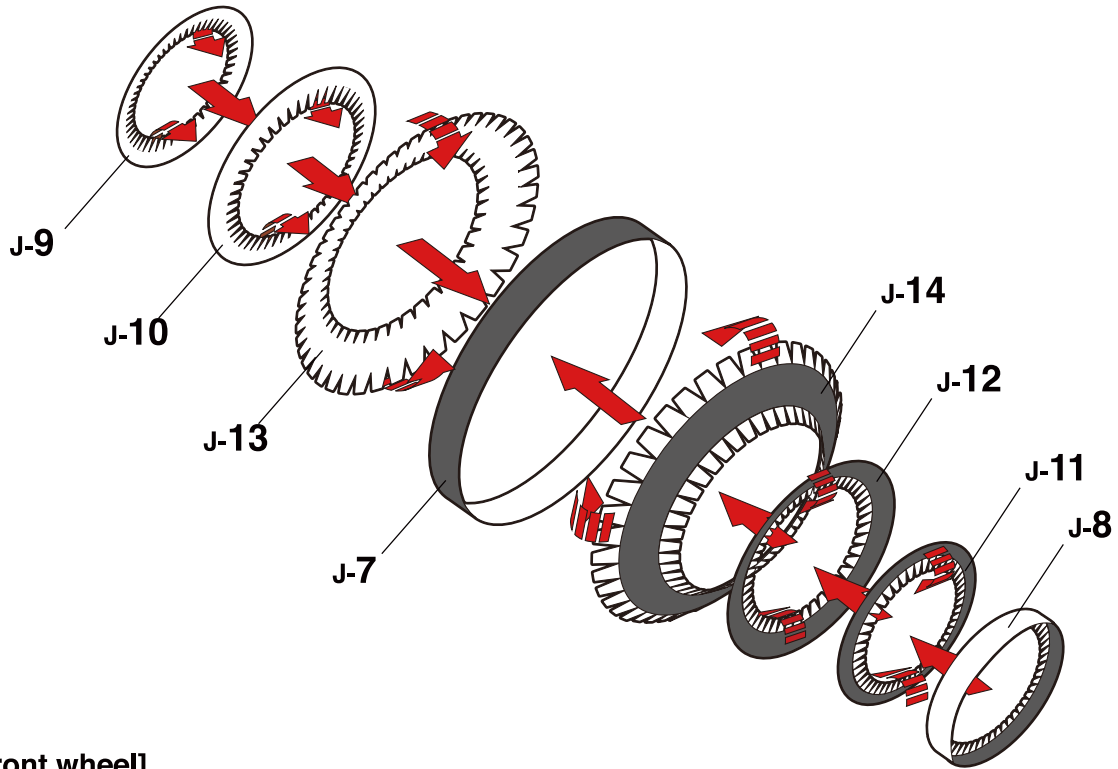

### [Front wheel]

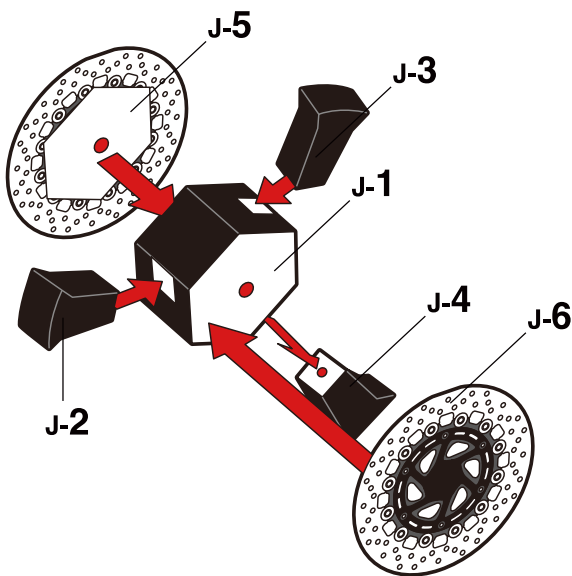

### Reference photo



# 3 Assembly

Please refer to the "Basic working method and markings" symbol chart on Page 2 to assemble each part.

Indication of Working Methods

---> Fold or Curve    -> Glue

## Rear tire

Sheet K, 13 parts in total

Fold each relevant part according to the assembly symbols.

Please use the ● dots on each component as reference when gluing surfaces.

\*Glue the completed rear wheel to the assembled rear tire.

[Rear tire]

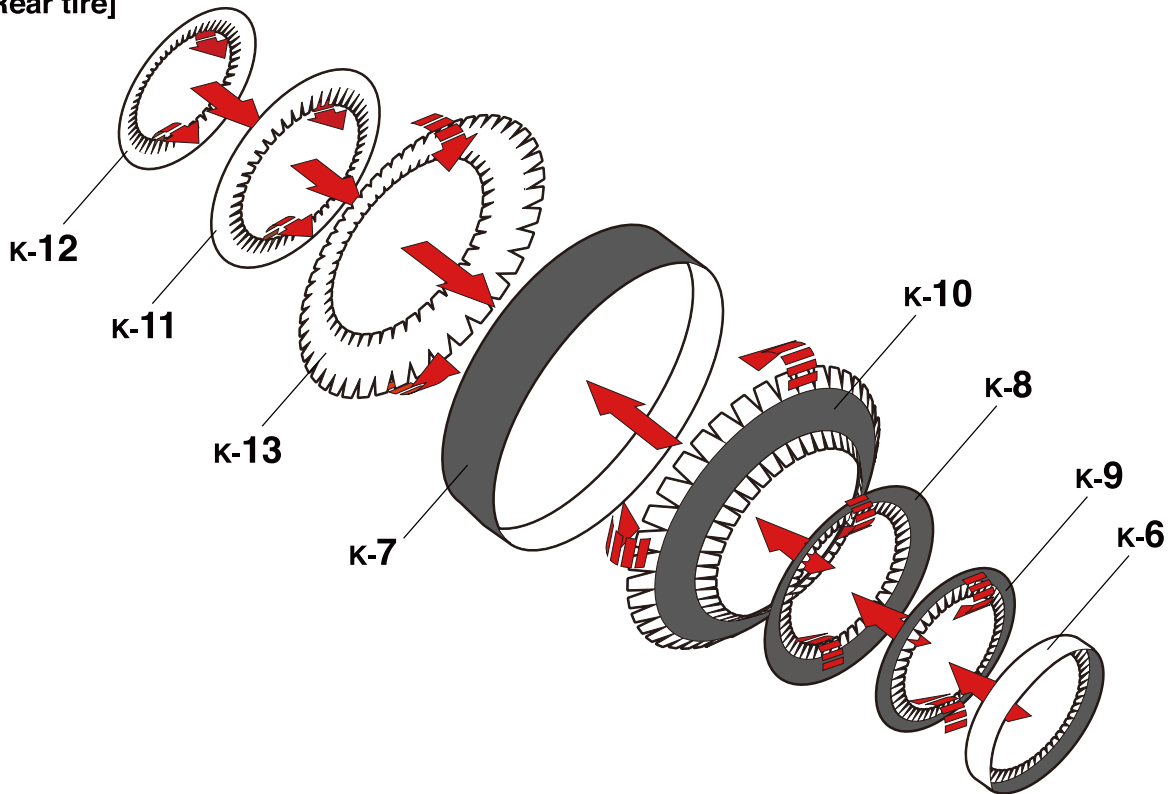

[Rear wheel]

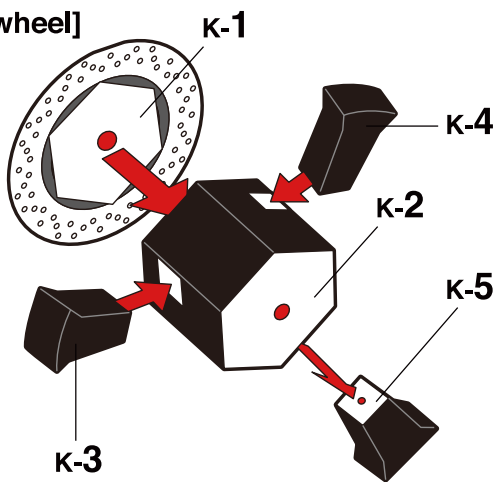

Reference photo



Please use the ● dots on each component as reference when gluing surfaces.

## Assembly Instructions

glue the assembled parts in numerical order 1 through 13.

- 1 Glue the central frame to the fuel tank.
- 2 Glue the seat to the fuel tank.
- 3 Glue the seat to the rear fender.
- 4 Glue the engine to the central frame.
- 5 Glue the rear arm to the engine.
- 6 Glue the exhaust pipe to the engine.
- 7 Glue the exhaust pipe to the rear arm.
- 8 Insert the right and left frames into the central frame and glue this part to the seat.
- 9 Glue the right and left rear shock absorbers to the right and left frame and rear fender.
- 10 Glue the rear tire to the rear arm.
- 11 Glue the oil cooler to the frame.
- 12 Glue the front tire to the steering column.
- 13 Complete the assembly by gluing the steering column to the central frame.

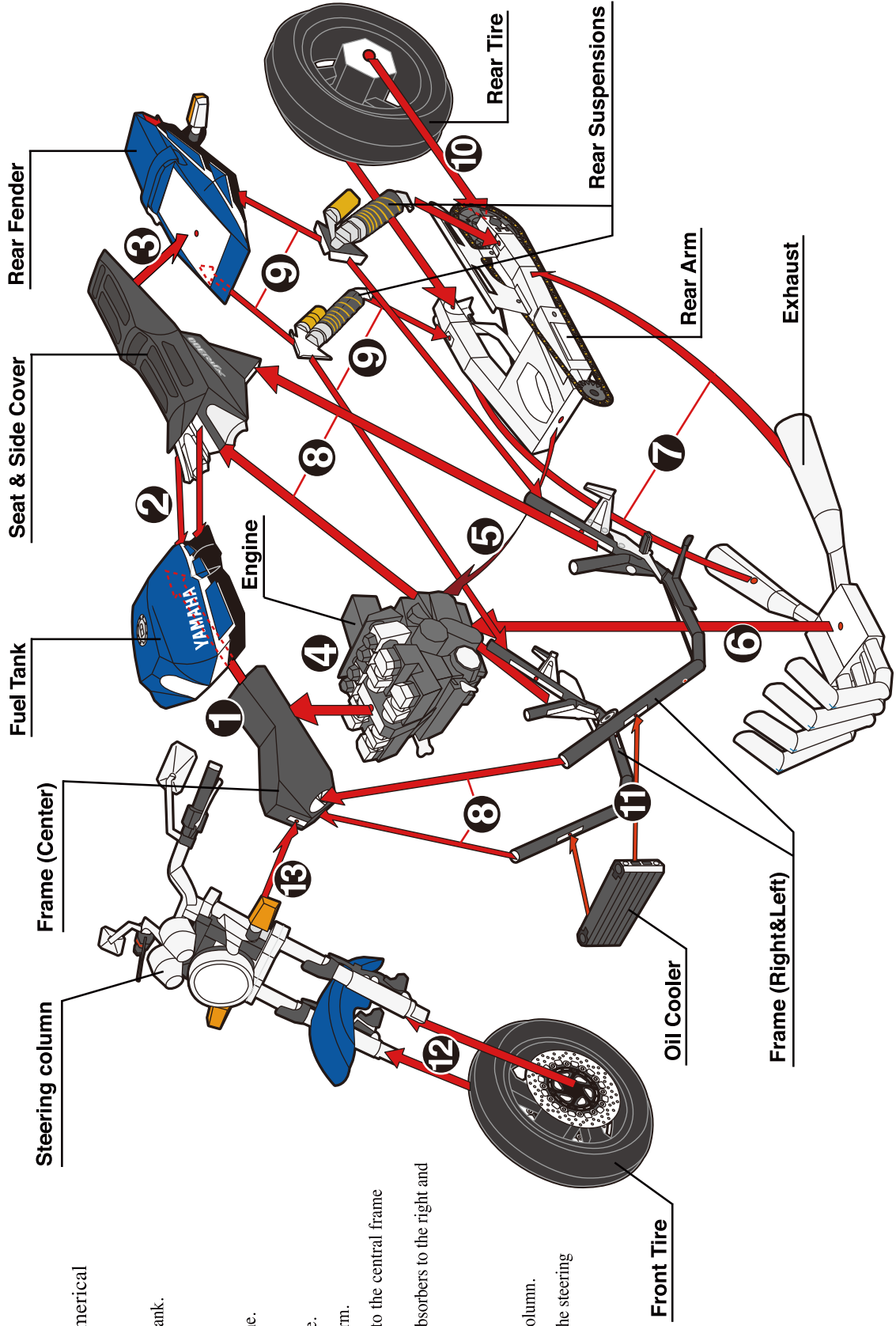

# 5 Assembled Model and the List of Parts

Here are pictures of the completed models. Please refer to them when assembling.

## RIGHT

### Rear Suspensions

- H-1 H-6
- H-2 H-7
- H-3 H-8
- H-4 H-9
- H-5 H-10

### Seat & Side Cover

- F-1 F-4
- F-2 F-5
- F-3

### Fuel Tank

- A-1

## FRONT

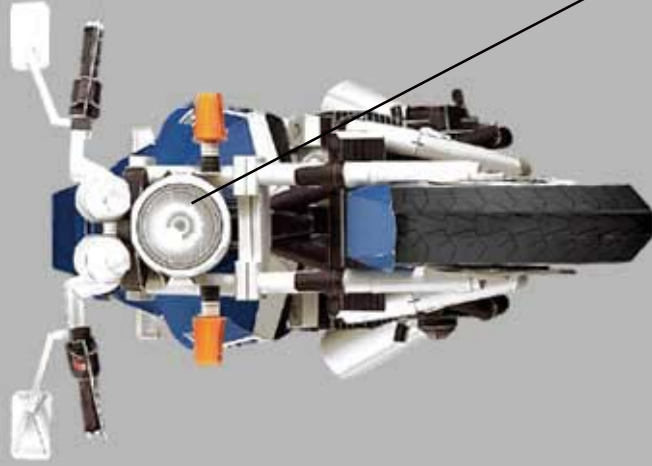

### Steering

- B-1 B-8 B-15 B-22 B-29
- B-2 B-9 B-16 B-23 B-30
- B-3 B-10 B-17 B-24 B-31
- B-4 B-11 B-18 B-25 B-32
- B-5 B-12 B-19 B-26 B-33
- B-6 B-13 B-20 B-27 B-34
- B-7 B-14 B-21 B-28 B-35
- B-36

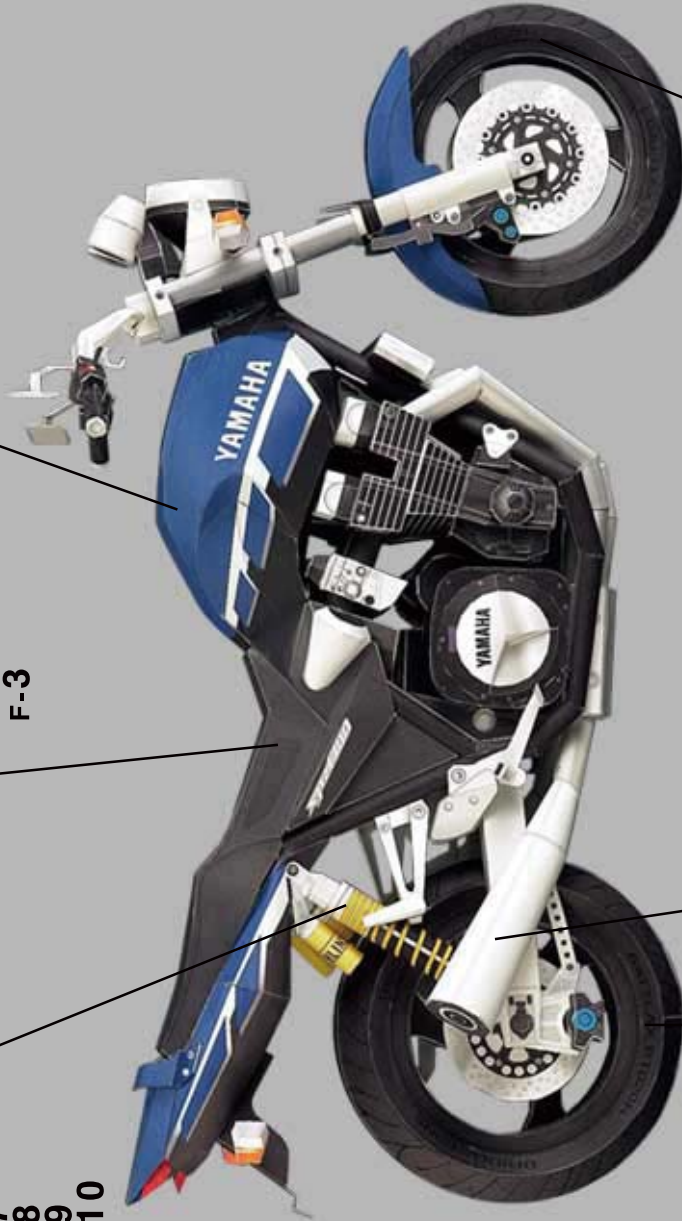

### Exhaust

- E-1 E-7 E-13 E-19
- E-2 E-8 E-14 E-20
- E-3 E-9 E-15 E-21
- E-4 E-10 E-16 E-22
- E-5 E-11 E-17 E-23
- E-6 E-12 E-18

### Rear Tire

- K-1 K-6 K-10
- K-2 K-7 K-11
- K-3 K-8 K-12
- K-4 K-9 K-13
- K-5

### Front Tire

- J-1 J-6 J-11
- J-2 J-7 J-12
- J-3 J-8 J-13
- J-4 J-9 J-14
- J-5 J-10

# 5 Assembled Model and the List of Parts

Here are pictures of the completed models. Please refer to them when assembling.

**LEFT**



**Engine**

- D-1 D-8 D-15 D-23 D-30
- D-2 D-9 D-16 D-24 D-31
- D-3 D-10 D-18 D-25 D-32
- D-4 D-11 D-19 D-26 D-33
- D-5 D-12 D-20 D-27 D-35
- D-6 D-13 D-21 D-28 D-36
- D-7 D-14 D-22 D-29 D-37
- D-38

**Oil Cooler**  
C-17

**Frame**

- C-1 C-8 C-15 C-23
- C-2 C-9 C-16 C-24
- C-3 C-10 C-18 C-25
- C-4 C-11 C-19 C-26
- C-5 C-12 C-20 C-27
- C-6 C-13 C-21 C-28
- C-7 C-14 C-22 C-29

**Rear Arm**

- G-1 G-4 G-7
- G-2 G-5
- G-3 G-6

**REAR**

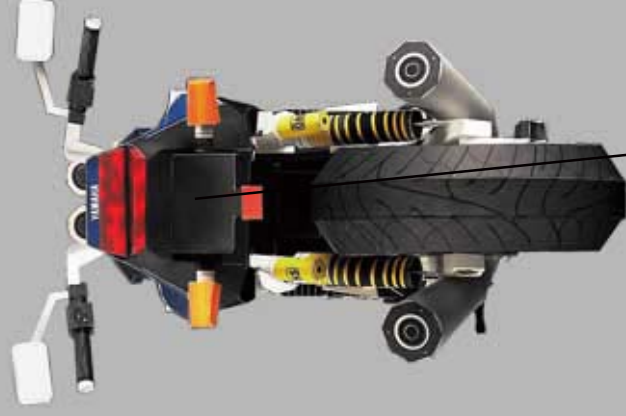

**Rear Fender**

- I-1 I-6
- I-2 I-7
- I-3 I-8
- I-4 I-9
- I-5