

*Gather Wisdom and Strength*

*To Forge First-Class Products*



# Constant Temperature Heating Platform

## HP Series Instruction Manual

(Please Read Carefully Before use)

**Zhejiang Huaqi Zhengbang Automation Technology Co., Ltd.**

NO. 1, Shanha Road, Nanming Mountain Street, Liandu District,  
Lishui City, Zhejiang Province, China.

Web: [www.itechsmt.com](http://www.itechsmt.com) Zip code: 323000

Unified national service hotline: +8657786701181



Zhejiang Huaqi Zhengbang Automation Technology Co., Ltd.

➤ [HTTP://WWW.ITECHSMT.COM](http://www.itechsmt.com)

## Chapter 8 After-Sales Service

### Warranty Card

Date of manufacture: \_\_\_\_\_/\_\_\_\_\_/\_\_\_\_\_

Sales Unit: \_\_\_\_\_

### The User Instructions

1. The warranty period of our products is one year, from the date of sale of manufacturing quality problems within 12 months, our company will be free repair
2. During the warranty period, due to improper handling, incorrect operation according to the operation instructions or self-demolition and repair, will not be guaranteed. Appropriate cost will be charged for any repairs required.
3. In order to protect the interests of users, the company provides lifetime maintenance service for all products purchased from the company, if the warranty period is exceeded, and the spare parts will only be charged at appropriate cost.
4. The Company will not bear any transportation expenses.

## Preface

Thank you very much for using the equipment produced by our company. We sincerely promise to you that we will help you achieve success with excellent product quality and perfect after-sales service.

Zhejiang Huaqi Zhengbang Automation Technology Co., Ltd. was founded in early 2000, specializing in the design and production of electronic soldering equipment and production lines, such as: soldering pot, PCB pin cutting machine, blade sharpner, semi-automatic dip soldering machine, wave soldering machine, reflow oven, manual solder paste printer, Conveyor, plug-in line, assembly line and other equipment.

Since its establishment, the company has been taking "customer-oriented, excellence, full participation, continuous improvement, sustainable management" as the highest business purpose and quality policy, to "build a famous brand of Chinese people, create a leading trend of products" "Customer-oriented, excellence" as the guiding ideology, for domestic and foreign market needs to develop and produce high-quality products is the company's most basic core resources. The company has been adhering to the manufacturing of high quality and high performance products.

The company has experienced professional designers, quality control in each production process, and a team can provide you with excellent and perfect after-sales service, "Customer satisfaction" is our purpose, quality and service and strive to achieve "excellence, perfection" is the company's firm commitment.

Special attention: before using the company's equipment, please read this manual carefully.

As the level of the editor is limited, please forgive me for any shortcomings!

**Wish an Business move!**

## Content

Chapter 1 Product overview -----	1
Chapter 2 Technical parameters -----	1
Chapter 3 Product structure -----	2
Chapter 4 Installation and debugging -----	2
Chapter 5 Temperature controller panel description -----	3
Chapter 6 Matters needing attention -----	5
Chapter 7 Attachment List -----	5
Chapter 8 After-sales Service -----	6

## Chapter 6 Matters needing attention

- 1.The temperature of the shell is high during the working process of the machine, so it must not be touched by hand.
- 2.Do not drop any liquid on the heating plate, otherwise the liquid will splash and hurt people under high temperature.
- 3.The machine is not suitable for use in humid, combustible, corrosive, high dust and other harsh environments.
- 4.Non-professionals should not disassemble the machine and repair it by themselves, otherwise the company will not bear any responsibility.

## Chapter 7 Attachment List

- |                           |      |
|---------------------------|------|
| 1.Fuse                    | 1PCs |
| 2.Instruction             | 1PCs |
| 3.Certificate of approval | 1PCs |

### 3. Temperature Calibration

When the temperature displayed by the machine deviates from the actual temperature, it is necessary to set the temperature calibration. When the actual temperature reaches the set temperature, such as the measured temperature is 110°C, the actual temperature of the machine is 100°C, and the set temperature is 100°C. Operating methods are as follows:

(1) At the same time press the "function key SET" and "bring addend key ▲", the actual temperature window will display "CAL" "SET temperature window displays the current setting temperature value.

(2) By clicking on the "shift key ◀" can be very bit, bits, moving between 10, one hundred, stay where single digits flashing, can through the "addend key ▲" to bring about and the reduction key ▼" into, after input the actual correct temperature measured, press the "function key SET" for confirmation to complete the calibration process.

### 4. Password Setting

The machine is equipped with password setting function, can lock set temperature and other parameters, to prevent the personnel without set permission to change at will, the factory default password is 0000, in this state can be adjusted various parameters.

(1) The password Settings: In shutdown state, press and hold "function key SET" don't put open the power supply to enter password SET, through the "shift key ◀" and "add and subtract the number keys ▲ ▼" set the password, simply enter two complete set.

(2) The password to unlock the lock machine Settings: In shutdown state, hold down the "SET" function key to enter password SET turned on the power of tong Through the "shift key ◀" and "add and subtract number key ▲ ▼" input twice SET password, you can unlock the machine.

(3) password clearance: in the shutdown state, press and hold the "function key SET" do not put on the power can enter the password setting, through the "shift key ◀" and "add and subtract number key ▲ ▼" input "1234" confirm, then input "4321" confirm, you can clear the password.

### 5. Set the upper limit of maximum temperature

When the device is turned on, press and hold the "function key SET" and the "subtraction key ▼" at the same time to set the temperature blinking, and then press the "Shift key ◀" to adjust the upper limit of temperature setting.

### 6. Restore factory Settings

Shutdown state, press four keys at the same time, and then start, the actual temperature display F--0, press the "shift key ◀" the actual temperature display F--2, set the temperature display 6.01. Turn off and start again to restore factory Settings.

## Chapter 1 Product overview

HP series for stable temperature controlled heating equipment, heating is applicable to any need stable heating temperature control occasions, such as: mobile phone repair, aluminum plate LED lamp bead soldering, preheating, sealing glue dispensing for PCB, die die mandrel preheating, chemical test, heat curing, solid state relay chip welding etc, simple operation, high working efficiency, and, is your production and processing good helper.

This machine adopts high efficiency heating tube multi-tube technology combined with high quality aluminum plate as the heating body heating tube is easy to replace, heat transfer uniform, high conduction efficiency. Temperature is controlled by PID intelligent, temperature control is accurate, intuitive, beautiful shape. Our quality policy: "Continuous improvement, continuous and effective, the customer first" Hua Zhengbang wholeheartedly for your service!

## Chapter 2 Technical parameters

Model	HP-B100	HP-B150	HP-B180	HP-B200	HP-B250
Power Supply	AC220V±10% 50HZ				
The Total Power	300W	400W	350W	900W	1200W
Operating Temperature	Indoor Temperature-450°C				
Working Dimensions (mm)	100*100	150*150	180*100	200*200	250*250
Overall Dimensions (mm)	120*120*140	170*170*140	200*120*140	230*230*143	280*280*143

Model	HP-B280	HP-B350	HP-B430	HP-B520	HP-B540
Power Supply	AC220V±10% 50HZ				
The Total Power	900W	1800W	2400W	1800W	3300W
Operating Temperature	Indoor Temperature-450°C				
Working Dimensions (mm)	280*200	350*300	400*300	500*200	500*400
Overall Dimensions (mm)	310*230*140	380*330*140	430*330*140	530*230*143	530*430*143

### Chapter 3 Product structure

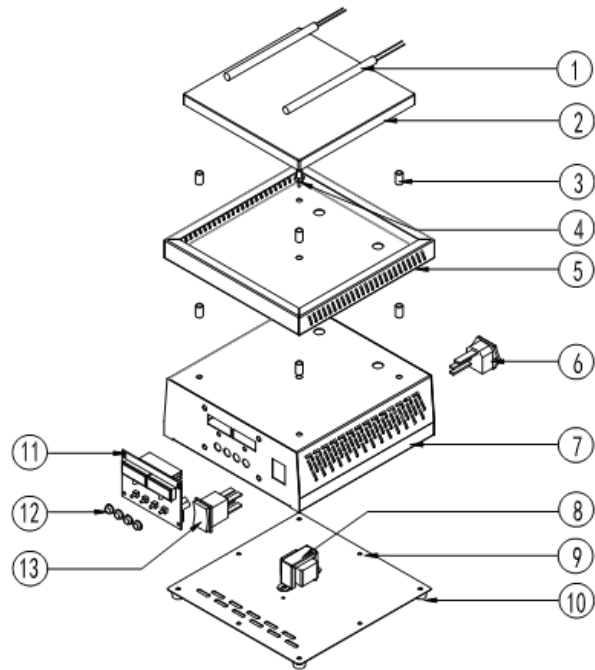

- 1、Heating Tube 2、Heating Aluminum Plate 3、Heat insulation pad column
- 4、Temperature Sensor 5、Heat shield 6、Power Socket 7、Shell
- 8、Controller Motherboard Transformer 9、Bottom Sealing Plate 10、Rubber
- 11、Control Board 12、Button 13、Power Switch

### Chapter 4 Installation and debugging

1. Open the package and read this manual carefully and check the attachment (see the attached list).
2. Remove and place the host horizontally.
3. Confirm that the grounding line of the machine is well grounded before the power test machine.

### Chapter 5 Panel operation

#### 1. Panel Instruction

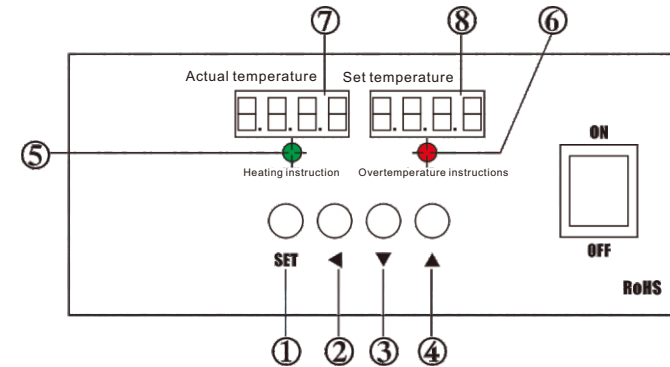

- ① Function key SET
- ② Shift key ◀
- ③ Reduction key ▼
- ④ Addend key ▲
- ⑤ Heating indicator: the light is long on, indicating that it is heating, and the light flickers, indicating that the heating is over and entering a constant temperature state.
- ⑥ Overtemperature indicator: when the temperature of the tin furnace exceeds the set temperature of 10°C, the light will be bright.
- ⑦ Actual temperature: display the actual temperature of the tin furnace.
- ⑧ Set temperature: show you set the use temperature of the soldering pot.

#### 2. Temperature setting

(1)Click the "Shift key ◀" and now the digital tube of temperature twinkle, continuous click it will moves between deciles, units, tens, and hundreds, when the twinkle stays at this bit,you can use the "Addend key ▲" and "subtract key ▼" to add or subtract the digit value,. After setting,click "function key SET" to save the setting. If not, five seconds without clicking to cancel the setting.

(2)Directly press the "add-on key ▲" and "subtraction key ▼" to directly start the temperature addition and subtraction setting from the lowest point.