

The TDHTT Series Low Cost Industrial Temperature Transducer



SERIES: TDHTT

APPLICATIONS

- Hydraulic / Mobile Hydraulic
- Automated Systems
- Energy and water management
- Anywhere Accurate Temperature Measurement of fluids is required

DESCRIPTION

The TDHTT series temperature transducer is built using dependable thermistor based sensing technology with industry standard voltage or current outputs.

Perfect for a wide range of applications, this solution is perfect for communicating accurate temperature measurements to panel mount displays, PLC's, or data acquisition systems.

FEATURES

- Low Cost
- Wide Temperature Measurement Range
- Industry Standard Analog Outputs
- 316 Stainless Steel Wetted Parts
- Excellent Long Term Stability
- OEM Tested and Approved

ELECTRICAL CONNECTIONS

Signal	Function	Color	Pin
0.5-4.5V	Supply V +	Brown	1
0-5V	Output +	White	2
0-10V	Com	Blue	3
4-20mA	Supply V +	Brown	1
	Output	Blue	3

M12

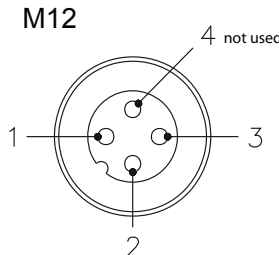

DIMENSIONS

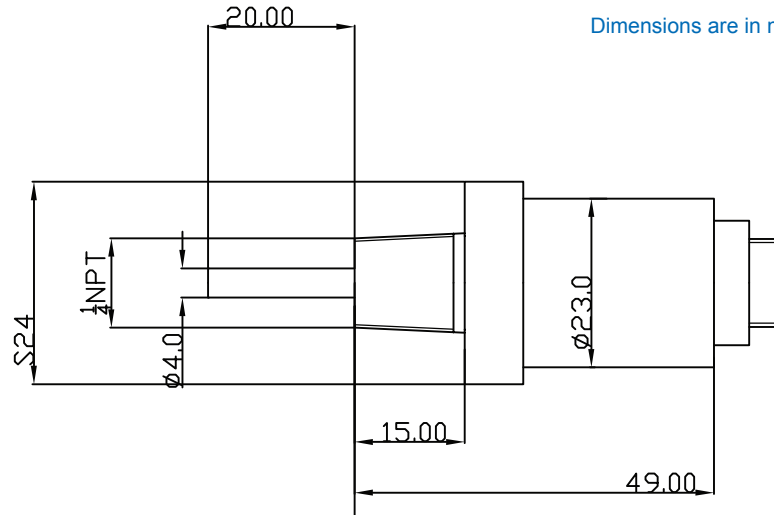

Dimensions are in millimeters and for reference only

SPECIFICATIONS

Performance @ 25°C (77 °F)

Accuracy	1% FS
Stability	0.2% FS
Measuring Temperature Range	-50 to 200° C (-58 to 392° F)
Max Continuous Temperature	250° F
Stability	0.2% FS
Operating Temperature Range	-40 to 85° C (-40 to 185° F)
Current Consumption	23mA for 4-20mA 8mA for 0-5V 11mA for 0-10V

Max Pressure for 6 mm Diameter Probe	300 bar
Max Pressure for 8mm Diameter Probe	500 bar

Mechanical Configuration

Probe Lengths	50mm, 100mm, 150mm
Process Connection	1/4 NPT (standard) *
Electrical Connection	4-pin M12 *
Ingress Rating	IP67 with T-Direct standard M12 cable
Housing	304 stainless steel
Wetted Parts	316SS

Input

Supply Voltage / (Output)	8-28 VDC (0-5V, 4-20mA)
	5 VDC (0.5-4.5V)
	12-36 VDC (0-10V)

For best performance use shielded cables.

Mating connectors and cable assemblies sold separately.®

** Consult factory for further OEM options.*

ORDERING

Series	Output	Electrical Connection	Probe Length	Pressure Port	Temperature Range
TDHTT	B	Q	50	03	0-200° F
	B = 4-20mA C = 0-5V (3 wire) **	Q = 4-pin M12 **	50 100 150 **	03= 1/4" NPT Male **	-40-392° F

**= Consult factory for further OEM options

Pressure ranges and outputs listed above are quick ship versions

Specifications may change without notice. The information we supply is believed to be accurate and reliable as of this printing. However, we assume no responsibility for its use. While we provide application assistance personally, through our literature and the Transducers Direct web site, it is up to the customer to determine the suitability of the product in the application.