

EF Series Foot Valves



PVC

SERIES: EF

SIZES: 1/2" to 3"

ENDS: Socket, Threaded or Flanged

SEALS: EPDM or FKM (Viton®)



Chemline EF Series PVC True Union Foot valve are designed for industrial applications. They are installed at the end of a pump suction line, always submerged. The polypropylene screen filters out debris.

Features

True Union Design

- Easy installation and maintenance

Rugged Polypropylene Screen

- Filters out debris
- Protects the valve from damage due to impact

EF Series Foot Valves



PARTS

▲ Recommended Spare Parts

No.	Part	Pcs.	Materials
1	Body	1	PVC
2	Ball/Disc	1	PVC
3▲	Seat	1	EPDM, FKM (Viton®)
4	End Connector	2	PVC
5	Union Nut	2	PVC
6▲	Face O-Ring	1/2*	EPDM, FKM (Viton®)
7▲	Foot Valve Screen	1	PP
8▲	Seat Carrier	1	PVC
9▲	Seat O-Ring	1	EPDM, FKM (Viton®)
10▲	Seat Carrier O-Ring	1	EPDM, FKM (Viton®)

*1 pcs. for the 1/2" to 2" sizes. 2 pcs. for 2-1/2" to 3" sizes

DIMENSIONS INCHES

Size	D	I _S (Soc)	I _T (Thd)	A	B _S (Soc)	B _T (Thd)	Screen Slot Width
1/2"	2.0	0.89	0.5	1.7	4.82	4.57	0.08
3/4"	2.3	1.00	0.6	2.0	5.53	5.28	0.09
1"	2.7	1.13	0.7	2.3	6.09	5.83	0.10
1-1/4"	3.2	1.26	0.7	2.5	6.89	6.57	0.11
1-1/2"	3.7	1.38	0.7	2.8	7.76	7.32	0.12
2"	4.5	1.50	0.7	3.0	8.71	8.31	0.12
2-1/2"	6.6	1.80	0.9	3.5	10.90	10.00	-
3"	6.6	1.90	1.0	3.8	11.20	10.30	-

PRESSURE TO OPEN/CLOSE PSI

Size	Minimum ΔP to Open		Minimum ΔP to Close	
	Horizontal	Vertical	Horizontal	Vertical
1/2"	0.7	0.1	2.9	2.9
3/4"	0.7	0.1	2.9	2.9
1"	0.7	0.1	2.9	2.9
1-1/4"	1.4	0.3	2.9	2.9
1-1/2"	1.4	0.3	2.9	2.9
2"	1.4	0.3	2.9	2.9
2-1/2"	1.4	0.3	1.2	1.2
3"	1.4	0.3	1.2	1.2

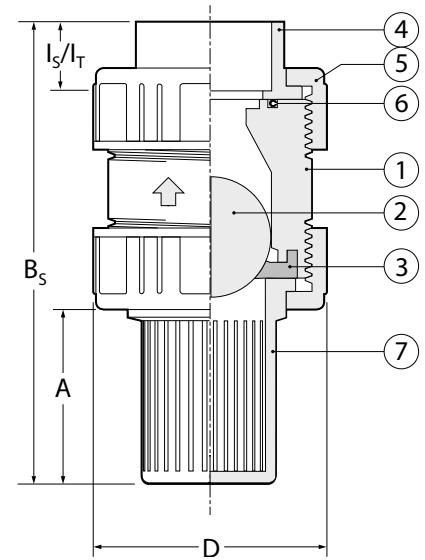

1/2" to 2"

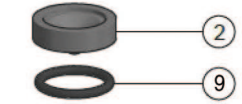
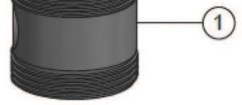
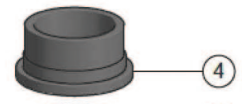
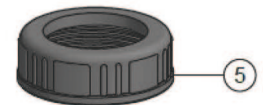

2-1/2" to 3"

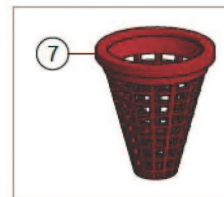

EF Series Foot Valves



NET WEIGHTS LBS.		Cv VALUES	WORKING PRESSURES PSI				
Size	Lbs.	USGPM flow @ 1 psi ΔP	20°C 68°F	30°C 94°F	40°C 105°F	50°C 120°F	60°C 140°F
1/2"	0.2	2.0	230	190	150	100	45
3/4"	0.4	4.0	230	190	150	100	45
1"	0.6	6.0	230	190	150	100	45
1-1/4"	0.9	9.0	230	190	150	100	45
1-1/2"	1.4	13.0	230	190	150	100	45
2"	2.4	18.0	230	190	150	100	45
2-1/2"	6.2	38.0	230	190	150	100	45
3"	6.6	51.0	230	190	150	100	45

Maximum Temperature: 60°C (140°F)

VACUUM RATING

- 29.9 inches mercury

SAMPLE SPECIFICATION

1. All PVC Foot valves 1/2" to 3", will be Chemline EF Series or equal, true union design, with EPDM (or FKM Viton®) seals. Valves 1/2" to 2" will be pressure rated 230 psi. 2-1/2" to 3" valves will be 150 psi rated.
2. Socket ends shall be Schedule 80 and conform to ASTM D-2467.
3. Threaded ends shall be Schedule 80 and conform to ASTM D-2464.
4. Flanged ends shall be ANSI Class 150.

ORDERING EXAMPLE

Chemline EF Series PVC True Union Foot Valve	EF	A	015	E	S
Material A – PVC					
Size 005 – 1/2" 007 – 3/4" 010 – 1" 012 – 1-1/4" 015 – 1-1/2" 020 – 2" 025 – 2-1/2" 030 – 3"					
Seals E – EPDM V – FKM (Viton®)					
Ends S – Socket T – Threaded F – Flanged					

Example: Chemline EF Series PVC True Union Foot Valve, 1-1/2", with EPDM seals, socket ends