

# VYPER

ASSEMBLY GUIDE

---

**ROBUST STEEL**  
*MAX*

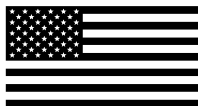

# WARNING

## Safety & Warnings

The VYPER CHAIR complies with all legally prescribed safety rules and regulations. Inappropriate use may cause damage to the product and injury or death to persons.

It is crucial to read the operation manual prior to using the VYPER CHAIR. It provides you with important information about safe and proper assembly, use and maintenance of the VYPER CHAIR.

Children should never use this VYPER CHAIR unless closely supervised by an adult.

Do not allow horseplay on or around the VYPER CHAIR.

**SERIOUS OR FATAL INJURY CAN OCCUR FROM THE VYPER CHAIR FROM TIPPING OVER OR FALLING OFF OF THE VYPER CHAIR.**

### **ACCORDINGLY:**

Keep weight centered when using the VYPER CHAIR.

Only use VYPER CHAIR on a flat level surface, free of debris.

Keep one or both feet on the ground at all times when sitting on the VYPER CHAIR.

Never stand on the VYPER CHAIR.

Never allow more than one person on the VYPER CHAIR.

**DO NOT USE THE VYPER CHAIR IF IT APPEARS DAMAGED OR BROKEN.**

**WARNING:** To avoid the danger of suffocation, keep this plastic bag away from babies and children. Do not use this bag in cribs, beds, carriages or playpens. This bag is not a toy.

Read all instructions before assembly and use of VYPER CHAIR. Failure to comply with and observe all assembly, safety, operating instructions and warnings regarding the use of the VYPER CHAIR may result in serious bodily injury or death.

This includes strictly following all assembly instructions in the order in which they appear.

Assembling any VYPER CHAIR in an order other than that set out in the instructions increases the risk of product damage or injury or death to individuals.

Never attempt to sit on the VYPER CHAIR until it is fully assembled and all the fasteners are tightened in accordance with the assembly instructions. Failure to comply with this warning can lead to product damage and injury or death to individuals.

Do not attempt to repair any broken or defective parts or assemble using any parts that are damaged or defective. Please contact manufacturer immediately at: [sales@vyperindustrial.com](mailto:sales@vyperindustrial.com)

Never use substitute parts when assembling the VYPER CHAIR. Please contact manufacturer immediately if replacement parts are needed at VYPER CHAIR.



# VYPER

VYPER was founded by the Rusch Family, a family that spent countless hours in the garage, starting one project after another. After years of torture using cheap chairs and hundreds of falls, Chris Rusch (known for being a master in metal shaping), designed & built the first ever VYPER Chair.

The VYPER Chair is strategically designed to prevent tipping over while rolling, provides relieving back support, improved sitting posture and increase comfort while using the highest quality American-made materials.

With their passion for the garage industry, Dayne and Dylan (the brothers) took over VYPER years ago with the determination to launch the highest quality products in any industry under the VYPER Brand while continuing to provide jobs to the American people.

## TOOLS REQUIRED FOR ASSEMBLY

1/2" WRENCH AND/OR SOCKET | 3/4" WRENCH AND/OR SOCKET

x2



or x2



x2



or x2



3/8" WRENCH AND/OR SOCKET | 5/32" HEX KEY WRENCH

x1



or x1



x1



**\*POWER TOOLS NOT RECOMMENDED!**

# STEP 1

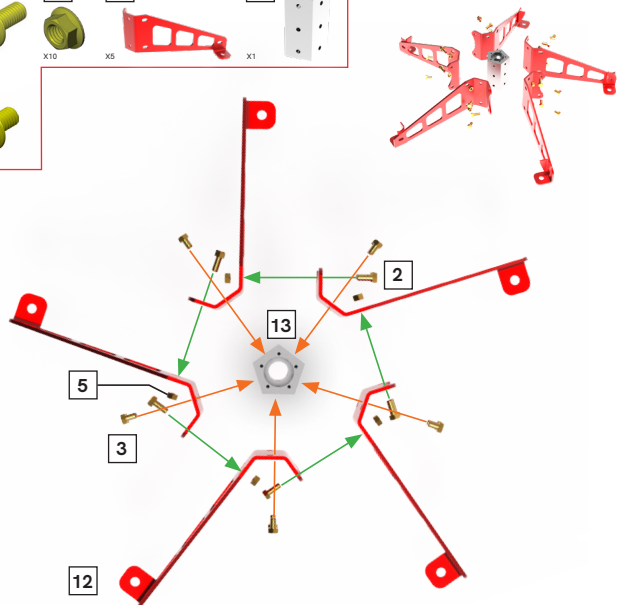
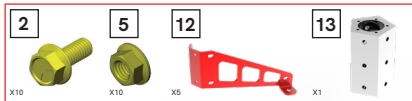

\* DO NOT TIGHTEN BOLTS

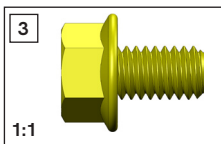
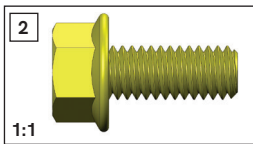

\* NUTS WILL HAVE RESISTANCE

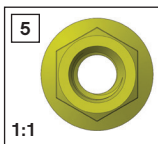

# STEP 2

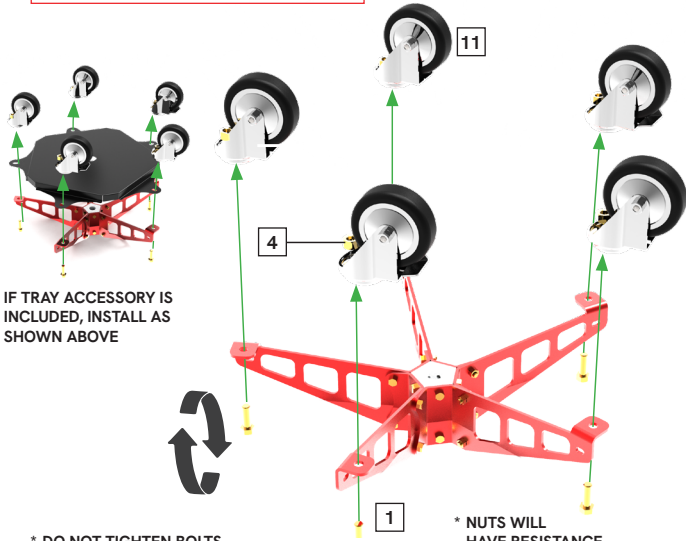
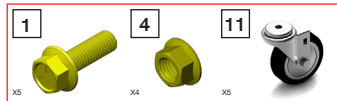

\* DO NOT TIGHTEN BOLTS

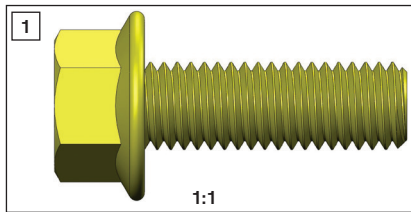

\* NUTS WILL HAVE RESISTANCE

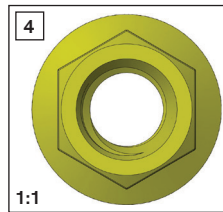

## STEP 3

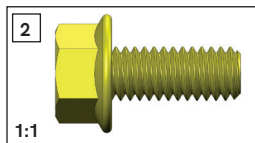
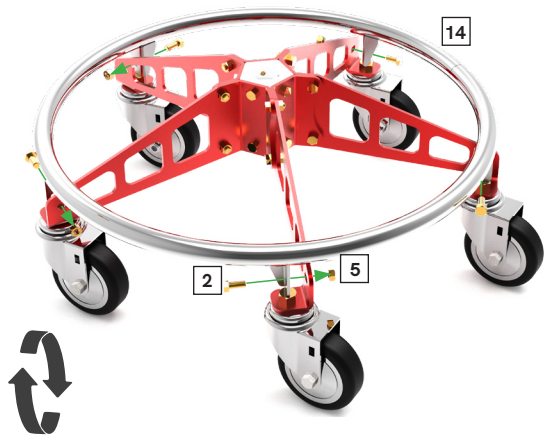
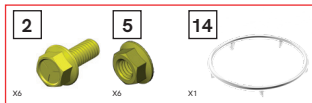

\* OK TO TIGHTEN ALL NUTS AND BOLTS

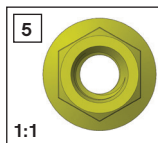

## STEP 4

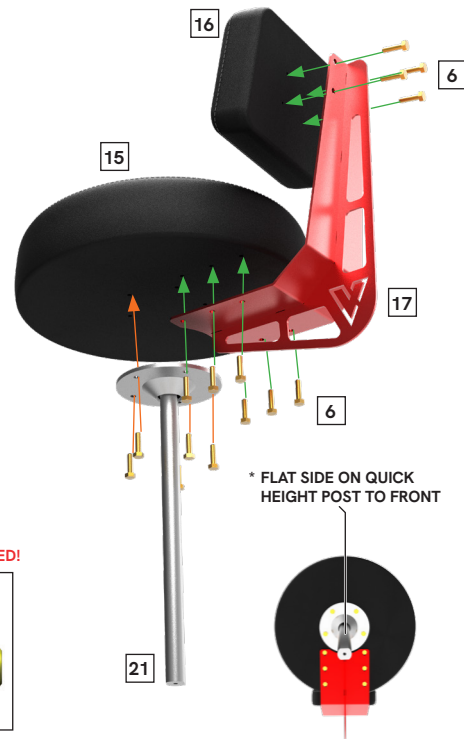

\*POWER TOOLS NOT RECOMMENDED!

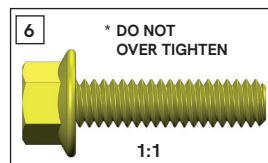

## STEP 5 | QUICK HEIGHT CHAIRS ONLY

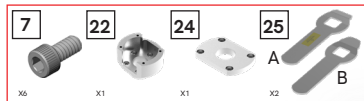

### QUICK HEIGHT HUB ASSEMBLY



\* WARNING LABEL ON TOP - LEAVE IN PLASTIC WRAP DURING INSTALLATION

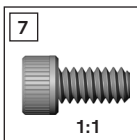
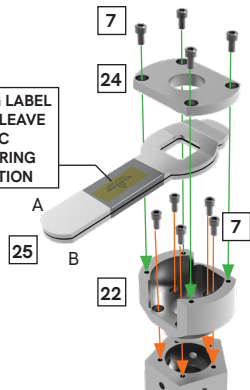

## STEP 6 | QUICK HEIGHT CHAIRS ONLY

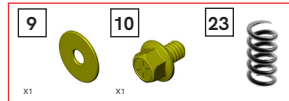

\* FLAT SIDE ON QUICK HEIGHT POST TO FRONT

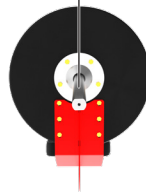

\* REMOVE PLASTIC WRAP AND LIFT HANDLES AS QUICK HEIGHT ROD IS LOWERED INTO HUB

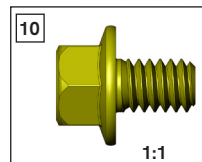
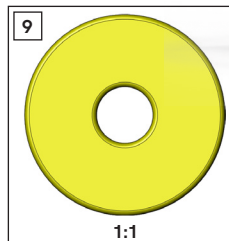
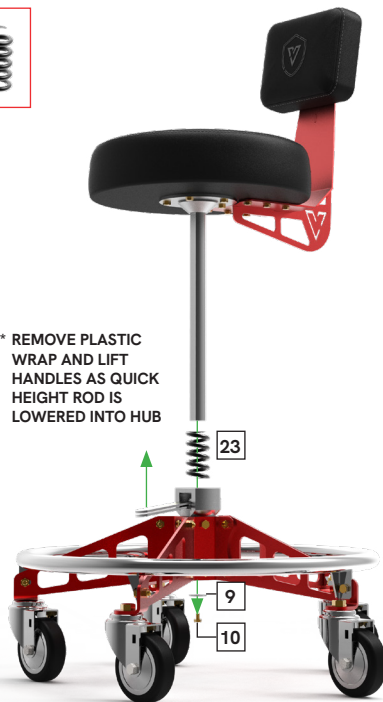

## STEP 5A | ACME ROD CHAIRS ONLY



\* ACME SCREW NUT ORIENTATION

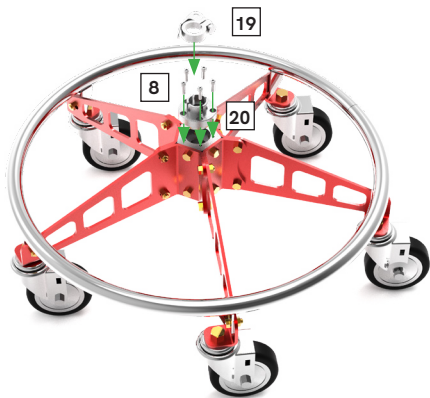

\* INSTALL SEAT CLAMP WITH LIP TO TOP SIDE

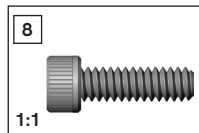

## STEP 6A | ACME ROD CHAIRS ONLY

\* ROTATE CLOCKWISE TO INSTALL



\* MAX HEIGHT FROM TOP OF CUSHION TO FLOOR 24" MAY CAUSE INJURY IF SEAT IS RAISED ABOVE 24" FROM FLOOR



## OPERATION

### QUICK HEIGHT CHAIRS ONLY

#### QUICK HEIGHT OPERATION

TO LOWERING THE SEAT:  
REMOVE WEIGHT FROM SEAT. WHILE HOLDING SEAT WITH ONE HAND, PULL UP ON THE LEVERS AND PUSH THE SEAT DOWN TO DESIRED HEIGHT, RELEASE THE LEVERS.

\* TO AVOID INJURY OR DAMAGE TO THE CHAIR, DO NOT PULL LEVERS WHILE SITTING ON CHAIR! THE SEAT WILL DROP QUICKLY RESULTING IN INJURY OR DAMAGE TO THE CHAIR.

TO RAISING THE SEAT:  
REMOVE WEIGHT FROM SEAT. WITH BOTH HANDS OPPOSITE EACH OTHER ON THE SEAT, LIFT TO THE DESIRED HEIGHT.

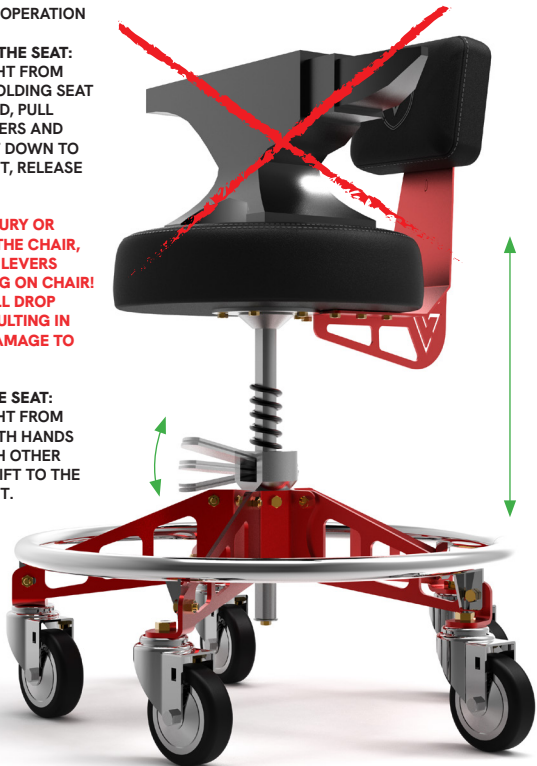

## OPERATION

### ACME ROD CHAIRS ONLY

#### ACME ROD OPERATION:

THREAD ACME ROD  
CLOCKWISE INTO ACME NUT  
TO LOWER THE SEAT.

\* MAX HEIGHT FROM TOP  
OF CUSHION TO FLOOR 24"  
MAY CAUSE INJURY IF  
SEAT IS RAISED ABOVE 24"  
FROM FLOOR (REFERENCE  
STEP 6A)

TIGHTEN SEAT CLAMP ONCE  
SEAT IS AT DESIRED HEIGHT.  
ENSURE CLAMP IS PROPERLY  
CLAMPED, THE CLAMP  
LEVER MUST BE  
AGAINST COLLAR.

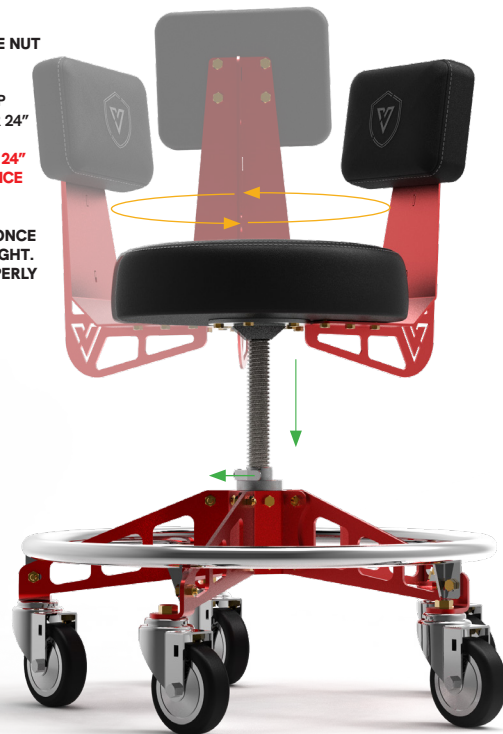
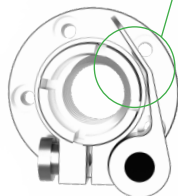



## AVAILABLE ACCESSORIES

### SIDEKICK

Need a drink?  
How about two?  
The SideKick contains two stainless steel cup holders, outside rubber protectors and holes for cleaning brushes.

### TOWEL RACK

Keep your towels clean and off the ground with the SideKick's Towel Rack.

### TOOL TRAY

Increase efficiency through organization by adding a tool tray to your chair!



### BIG BOY

Increase the width of your Vyper Chair seating with the two side cushion adapters.

### WHEEL LOCKS

Keep your chair from going rogue by with our locking caster attachment.

## TROUBLESHOOTING

### MY CASTER(S) DO NOT SWIVEL

BE SURE CASTER BOLTS ARE NOT OVERTIGHTENED  
**SLIGHTLY LOOSEN CASTER NUT (ITEM #5) UNTIL CASTER ROTATES SMOOTHLY. IF PROBLEM PERSISTS INSPECT CASTER FOR DAMAGE**

### CHAIR HAS SLIGHT WOBBLE

ENSURE ALL NUTS AND BOLTS HAVE BEEN TIGHTENED  
**POWER TOOLS ARE NO RECOMMENDED. IF PROBLEM PERSISTS, CRACK LOOSE LEG AND RAIL BOLTS. PLACE CHAIR ON FLAT AND LEVEL SURFACE AND RE-TIGHTEN.**

### SEAT NOT STAYING AT DESIRED HEIGHT (QUICK HEIGHT MODEL)

REFER TO STEP 5  
**THE LONGER LEVER IS ON THE BOTTOM, ANGLED UPWARD AND THE SHORTER LEVER (WITH WARNING LABEL) IS ON THE TOP, ANGLED UPWARD AS WELL. THE LEVERS ARE TO GRIP THE FLATS OF THE SHAFT.  
(AS OF 11.01.22 - 3 LEVER QUICK HEIGHT SYSTEM UPDATED TO 2 HANDLE SYSTEM)**

### SEAT SHAFT DOES NOT GO THROUGH CENTER HUB

REFER TO STEP 1  
**ENSURE THAT THE CORRECT BOLTS WERE INSTALLED TO ATTACH THE LEGS TO THE CENTER HUB.**



### VYPER INDUSTRIAL CUSTOMER SERVICE

(920) 301-3822 OR [sales@vyperindustrial.com](mailto:sales@vyperindustrial.com)

VISIT [WWW.VYPERINDUSTRIAL.COM](http://WWW.VYPERINDUSTRIAL.COM)

# PARTS

1

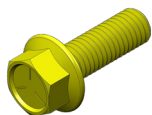

X5 | JHS08048-GR5-YZ

2



X15 | JHS05024-GR5-YZ

3



X10 | JHS05016-YZ

4



X5 | JFS08

5



X15 | JFS05

6

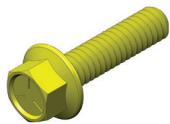

X15 | JHS04032-GR5-YZ

7



X9 | JAA03012

8



X5 | JAA03020

9



X1 | 14RC-7015

10



X1 | JHS04012-YZ

11



X5 | 4" SWIVEL CASTER

12

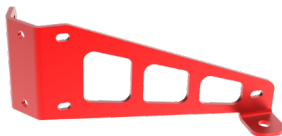

X5 | SUPPORT LEG

13



X1 | CENTER HUB

14



X1 | ROBUST STEEL FOOT RAIL

15



X1 | SEAT

16



X1 | BACKREST CUSHION

17

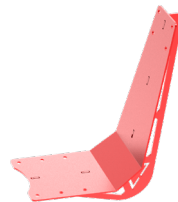

X1 | SEAT BACK BRACKET

18



X1 | ACME SEAT POST

21



X1 | QH SEAT POST

23



X1 | DAMPENING SPRING

24



X1 | LATCH CAP

19



X1 | SEAT CLAMP

22



X1 | HEIGHT ADJUST HUB

25

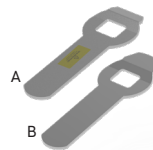

X2 | SQ LEVERS

20



X1 | CLAMP ACME SCREW NUT

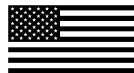

**VYPER INDUSTRIAL CUSTOMER SERVICE**

(920) 301-3822 OR [sales@vyperindustrial.com](mailto:sales@vyperindustrial.com)

VISIT [WWW.VYPERINDUSTRIAL.COM](http://WWW.VYPERINDUSTRIAL.COM)

# VYPER

## SHARE THE LOVE!

If you love your VYPER CHAIR, we'd be honored if you left us a review on our website!

Want a VYPER \$25 gift card?

Take a screenshot of your review and email it to: [sales@vyperindustrial.com](mailto:sales@vyperindustrial.com)

## STILL HAVE QUESTIONS?

Visit: [www.vyperindustrial.com/pages/assembly-tutorials](http://www.vyperindustrial.com/pages/assembly-tutorials)

Call: 920.301.3822

ROBUST STEEL<sup>SM</sup>



## RETURN INFO

If your chair was damaged during shipping please follow the steps below:

Take a picture of the box and parts that were damaged along with your packing slip

Send pictures to [sales@vyperindustrial.com](mailto:sales@vyperindustrial.com) with your order number

Once we receive the inquiry, we will contact you to resolve the issue

To review our refund policy, please visit: [www.vyperindustrial.com/policies/refund-policy](http://www.vyperindustrial.com/policies/refund-policy)



## CONTACT US

Please contact us at anytime with any questions, concerns or feedback. One of our team members will be in touch with you.



[sales@vyperindustrial.com](mailto:sales@vyperindustrial.com)



920.301.3822