

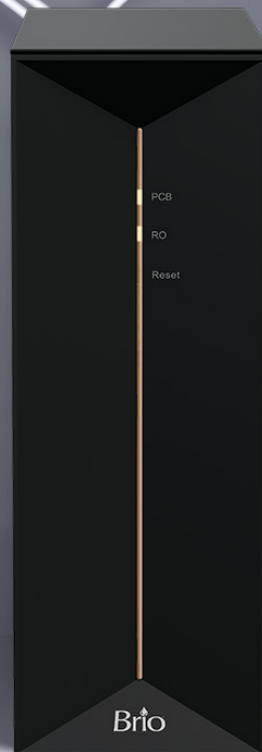

Brio®

**Tankless 1.5:1 RO Filtration System  
with Stainless Steel Faucet**  
Setup Manual

Model No.: TROE600PRISM



# Table of Contents

<b>Safety Information</b> .....	<b>3</b>
<b>Intended Use</b> .....	<b>3</b>
<b>Package Contents</b> .....	<b>4</b>
<b>Product Features</b> .....	<b>5</b>
Indicator Panel Description .....	5
<b>Specifications</b> .....	<b>6</b>
<b>Materials Needed</b> .....	<b>6</b>
<b>Installation</b> .....	<b>7</b>
Installation Overview .....	7
Connect to the Cold Water Supply .....	7
Install the Reverse Osmosis Drain Saddle .....	8
Install the Faucet .....	10
Complete the Installation .....	11
<b>Operation</b> .....	<b>11</b>
Start Up the Filtration System .....	11
Start Water Purification .....	11
Shut Down .....	11
<b>Care and Maintenance</b> .....	<b>12</b>
Filter Replacement Schedule .....	12
Replacing the Filters .....	12
Flushing the Filters .....	13
<b>Troubleshooting</b> .....	<b>13</b>
<b>Warranty</b> .....	<b>15</b>

# Safety Information

**WARNING:** To reduce risk of injury and property damage, you must read this entire manual before assembling, installing, and operating the filtration system.

- Installation needs to comply with state and local laws and regulations.
- If the power cable is damaged, do not use. Contact customer service for a replacement.
- Avoid storing in an area exposed to intense sunlight as this can cause damage to components.
- Do not store in or expose the device to temperatures lower than 32 °F (0 °C). The ideal temperature range is 39–100 °F (4–38 °C).
- The device must be installed or relocated by a professional technician due to the risk of electric shock and product damage.
- The best working pressure for this device ranges from 15 to 100 PSI. Install a pressure increasing or decreasing device if the water pressure is lower or higher than this level.
- For use with municipal tap water only. Not for use with well or underground water.
- Do not place magnetic devices near the device as damage could occur.
- Do not place heavy objects on the device.
- Do not allow children near the device without adult supervision.
- Do not pull the power cord as this could cause damage. To unplug the unit, grasp the power cord by the plug and pull directly from socket.
- Do not plug in or unplug with wet hands.
- Do not place combustible substances near the device. Keep away from heat sources and open flames.
- Install this device near a floor drain.
- If the device is not going to be used for a long period of time, unplug the unit from the power source and close the shut-off valve.

## Intended Use

This filtration system is intended to be used in household and similar applications such as:

- Staff kitchen areas in shops, offices, and other working environments
- Farm houses
- Hotels, motels, and bed-and-breakfast environments
- Residential-type environments
- Catering and similar non-retail applications

This appliance is not intended for use by persons (including children) with reduced physical, sensory, or mental capabilities, or lack of experience and knowledge, unless they are given supervision or instruction concerning the use of appliance by a person responsible for their safety.

# Package Contents

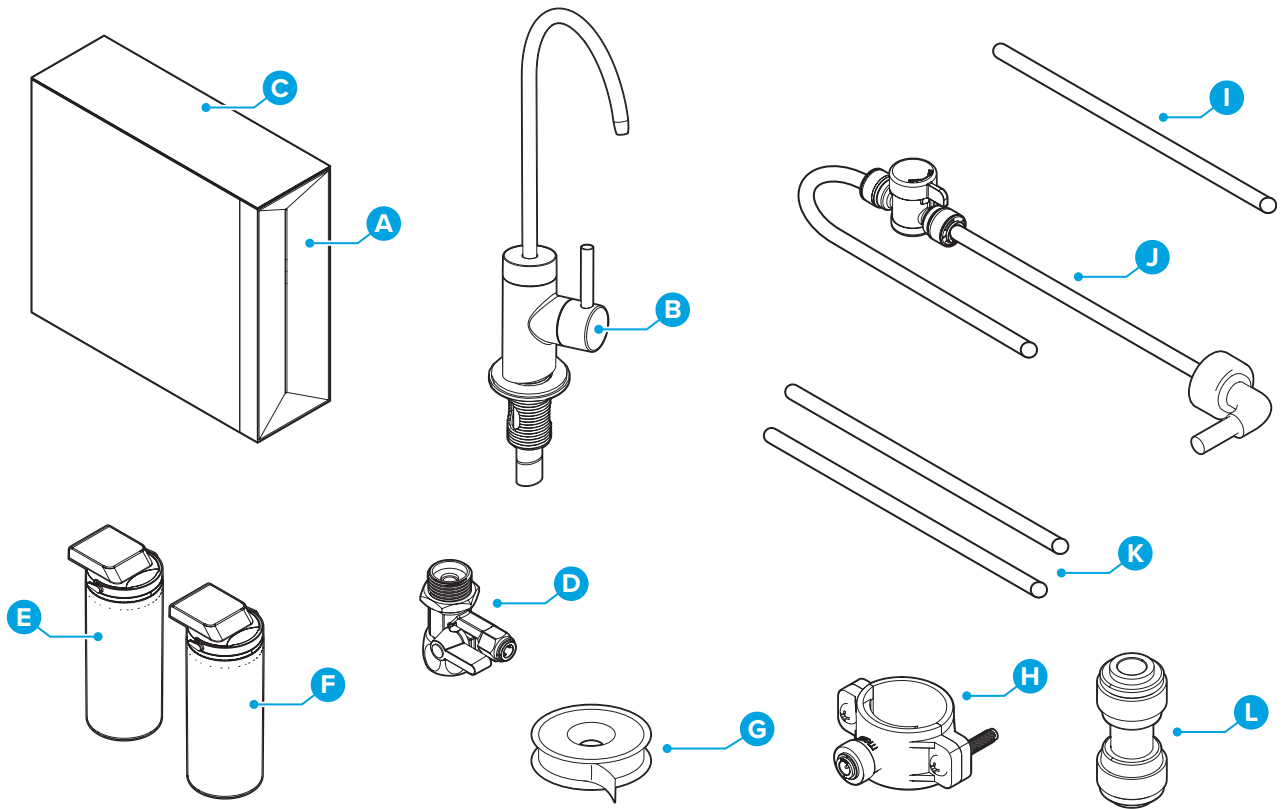

Part	Description	Quantity
A	RO filtration unit	1
B	Faucet	1
C	Filter compartment cover	1
D	Feed water adapter	1
E	PCB filter	1
F	RO filter	1

Part	Description	Quantity
G	Plumbers tape	1
H	Drain saddle	1
I	RO waste water tube	1
J	Shut-off valve tube	1
K	Faucet tubing	2
L	1/4 in. Quick connector	1

# Product Features

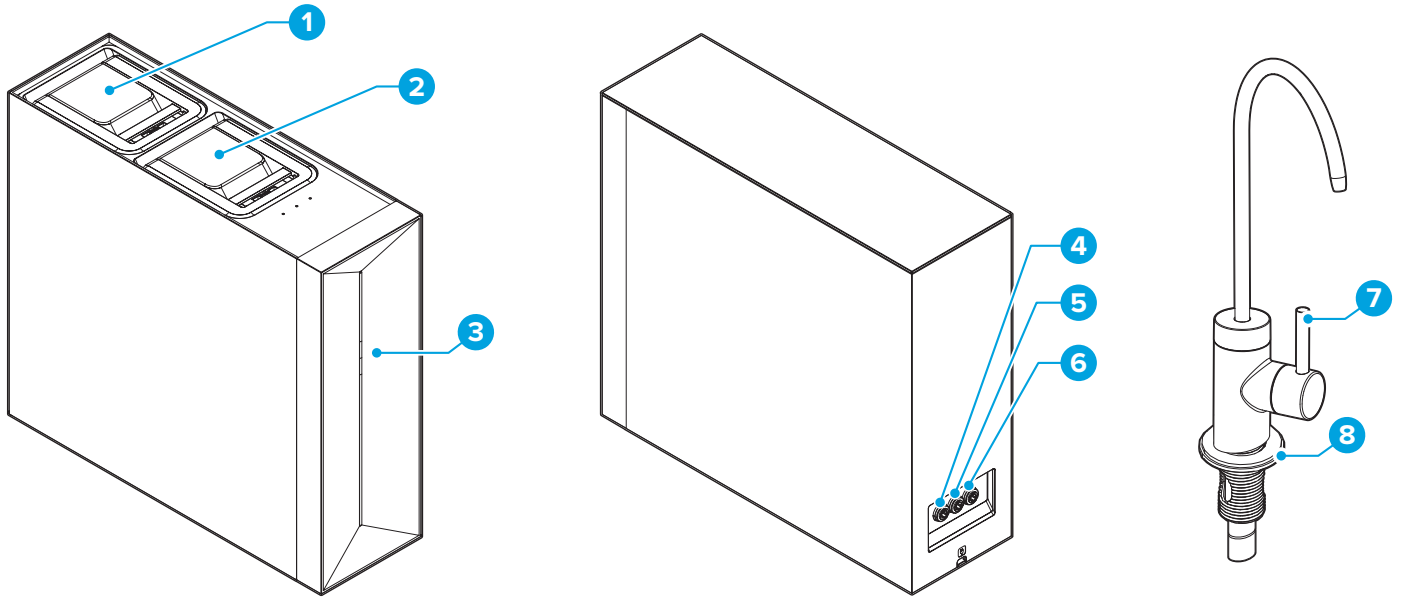

Part	Description
1	PCB filter compartment
2	RO filter compartment
3	Filter indicator
4	Inlet water connection

Part	Description
5	Filtered water connection
6	Waste water connection
7	Filtered water lever
8	Faucet O-ring

## Indicator Panel Description

Item	Description
9	Filter indicator lights – When blinking, indicates it is time to change filters (RO or PCB).
10	Reset button – Touch and hold for 3 seconds to reset the system after changing filters.

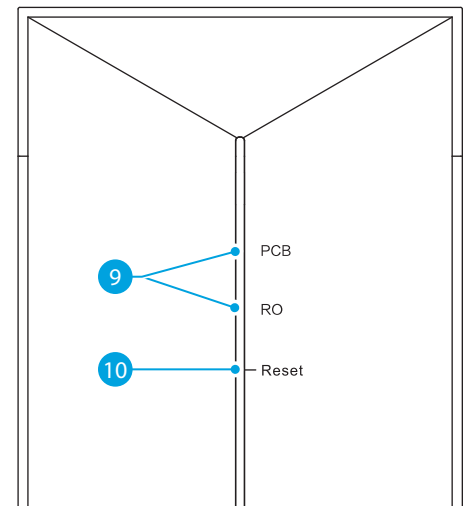

# Specifications

Model No.	TROE600PRISM
Product Dimensions (WxHxD)	5.4 x 15.4 x 16.9 in. (13.8 x 39.0 x 43.0 cm)
Daily Production Rate	600 GPD
Purified Flow Rate	1.5 LPM
Feed Water Requirement	Municipal tap water
Feed Water Pressure	15–100 psi
Feed Water Temperature	39–100 °F (4–38 °C)
Filtration System	PCB and RO
Rated Voltage / Frequency	220–240 V / 50/60 Hz
Rated Power	60 W

# Materials Needed

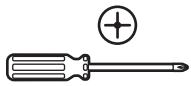

Phillips-Head  
Screwdriver



Adjustable Wrench

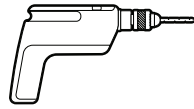

Power Drill



1/4" Drill Bit  
(for Drain Saddle)



1" Drill Bit  
(for Faucet  
Mounting Hole)

# Installation

## 1. Installation Overview

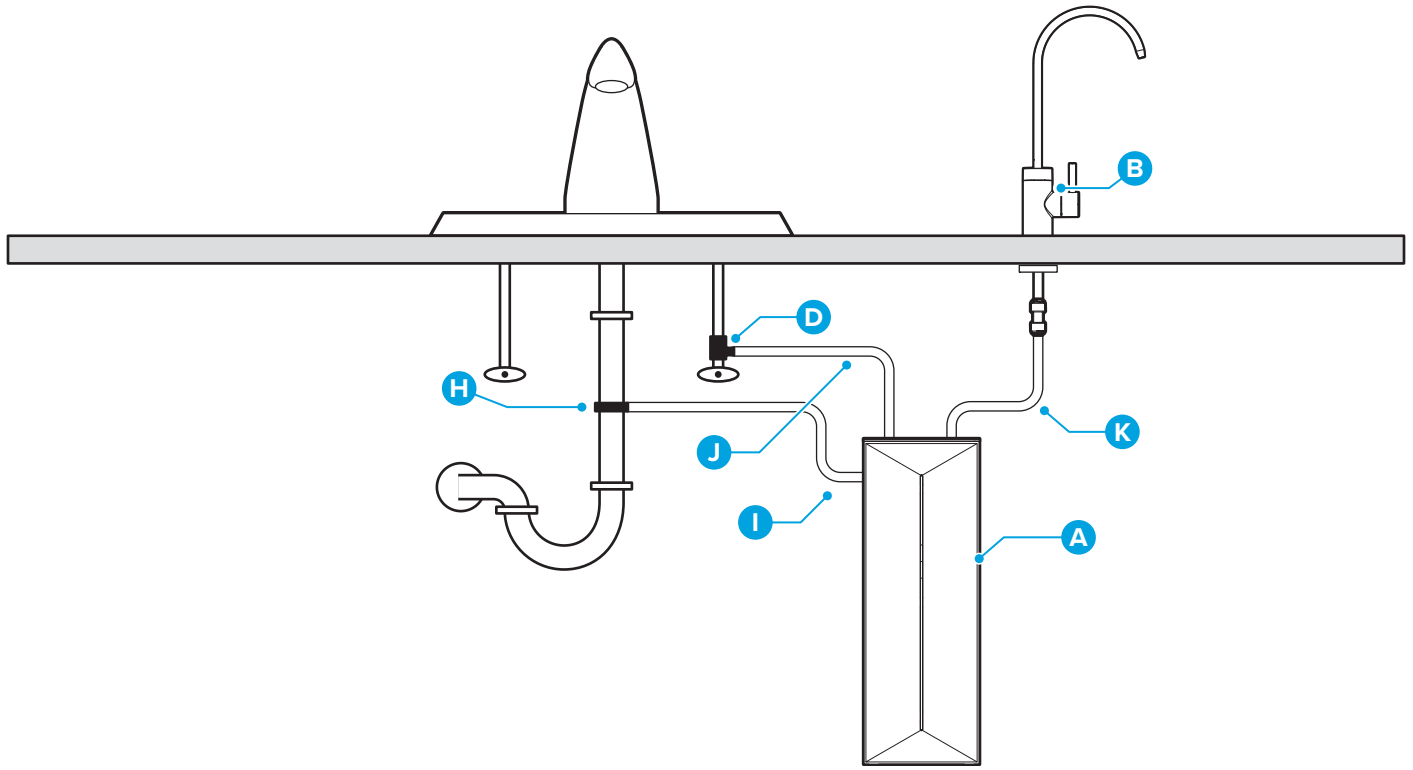

## 2. Connect to the Cold Water Supply

**CAUTION:** DO NOT CONNECT THIS WATER LINE TO A HOT WATER SUPPLY LINE. The water supply to the unit MUST be from the COLD WATER LINE. Using HOT WATER will severely damage your filters.

- A. Turn off and then disconnect the current cold water supply line.
- B. Connect the feed water adapter (D) to the cold water supply line.
- C. Connect the cold water supply line on top of the feed water adapter (D).

**NOTE:** An extra adapter nut is included on top of the feed water adapter (D) to attach to a 3/8 in. or 1/2 in. feed plumbing line.

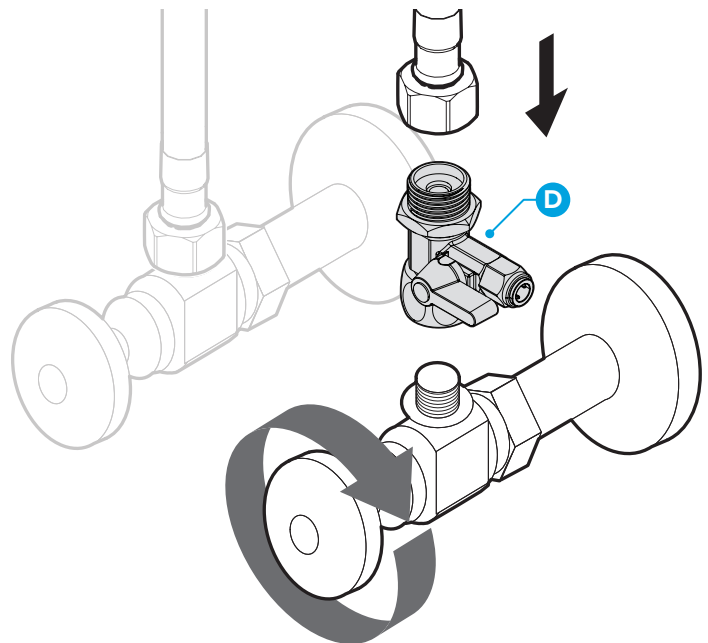

- D. Insert the shut-off valve tube (J) straight into the quick connector piece of the feed water adapter (D).
- E. Tighten the nut on the feed water adapter (D).

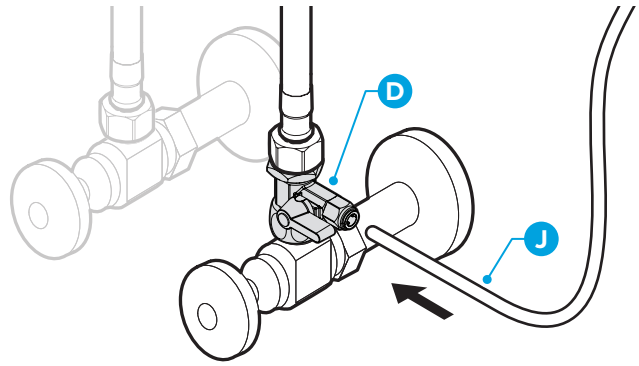

- F. Gently tug on the shut-of valve tube (J) to ensure a secure connection with the feed water adapter (D).

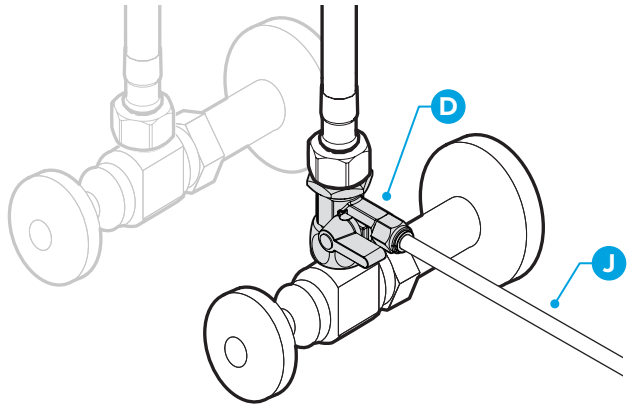

### 3. Install the Reverse Osmosis Drain Saddle

The RO filter assembly requires a drain line connection to be installed, which removes rejected water to the sewer. The drain saddle connects the drain line from the dispenser to your drain pipe. The drain saddle is designed to fit around a standard 1.5 in. OD (outer diameter) drain pipe.

- ✓ Always install the drain saddle above the P-trap (11). Ensure the drain saddle is in place on the vertical or horizontal section of the pipe.
- ✗ To avoid clogging the drain line with debris, do not install the drain saddle on a section of piping that is located after the drain pipe meets a garbage disposal or dishwasher drain.

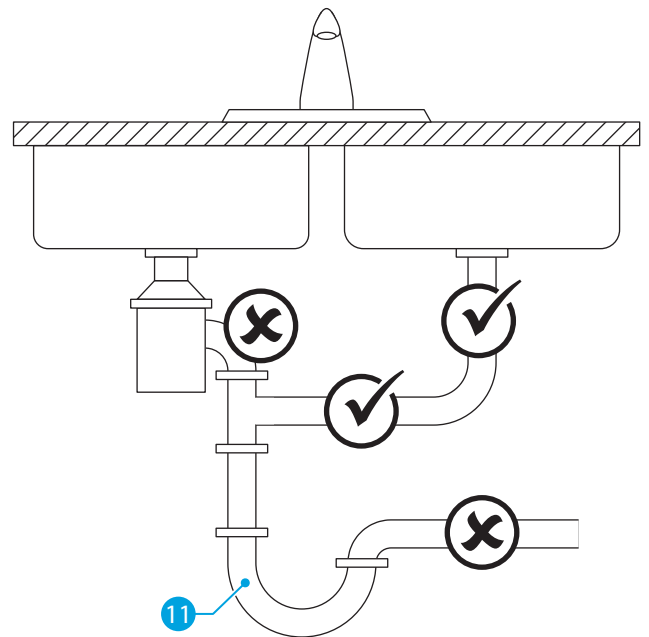



To install the Reverse Osmosis (RO) drain saddle:

- A.** Determine the location for your drain saddle (H) and then make a mark on the drain pipe for the opening (12).
- B.** Use your drill and a 1/4 in. drill bit to create a hole at the mark, ensuring you only drill through one side of the drain pipe.
- C.** Find the half of the drain saddle (H) with the hole in the center, remove the backing from the foam gasket, align the gasket with the hole on the drain saddle (H), and stick the adhesive side of the gasket to the drain saddle (H).
- D.** Position both halves of the drain saddle (H) on the drain pipe with the saddle's opening aligned over the drilled hole, and insert your drill bit through the saddle (H) and drilled hole to ensure proper alignment.
- E.** Secure both ends of the drain saddle (H) together using the bolts and nuts, but do not overtighten.
- F.** Connect the RO waste water tube (I) to the drain saddle (H).

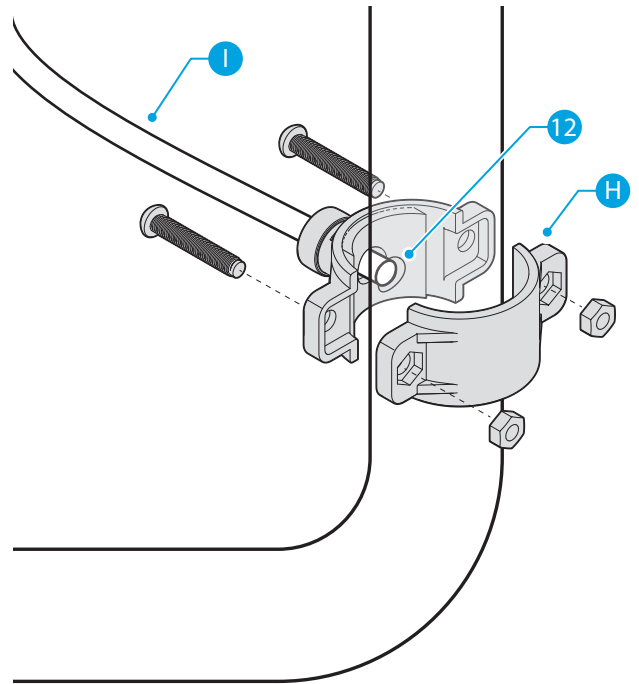

## 4. Install the Faucet

- A. Ensure that you have a mounting hole in your sink or countertop for this faucet. If you do not, create a mounting hole no less than 1.0–1.2 in. (2.54–3.0 cm).
- B. Remove the washer (13) and lock nut (14) from the faucet (B). Ensure that you leave the O-ring (8) on the faucet.
- C. Attach the 1/4 in. quick connector (L) to the stem outlet.

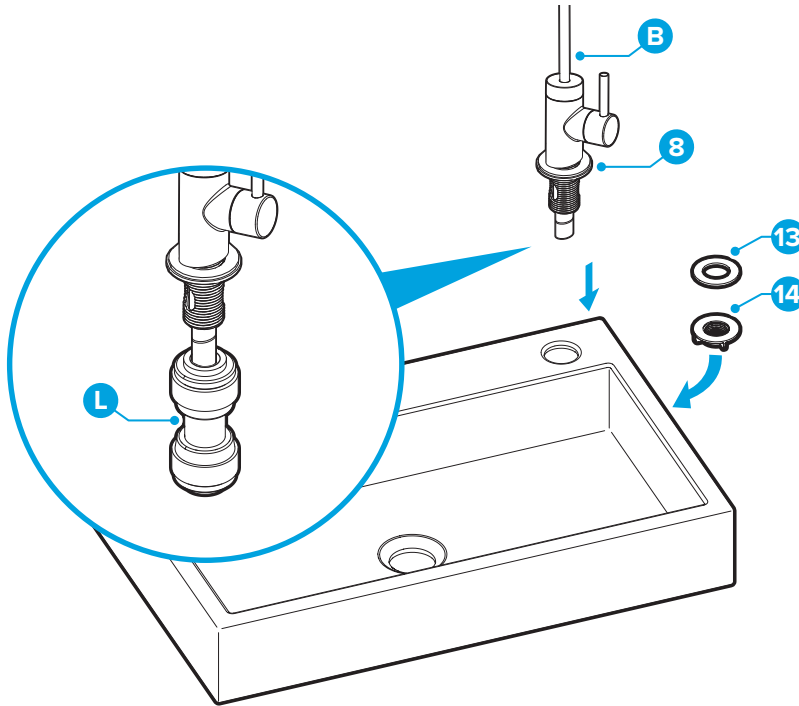

- D. Insert the faucet into the mounting hole and secure in place underneath the sink with washer (13) and lock nut (14).
- E. From underneath the sink, attach the faucet tube (K) to the 1/4 in. quick connector (L).

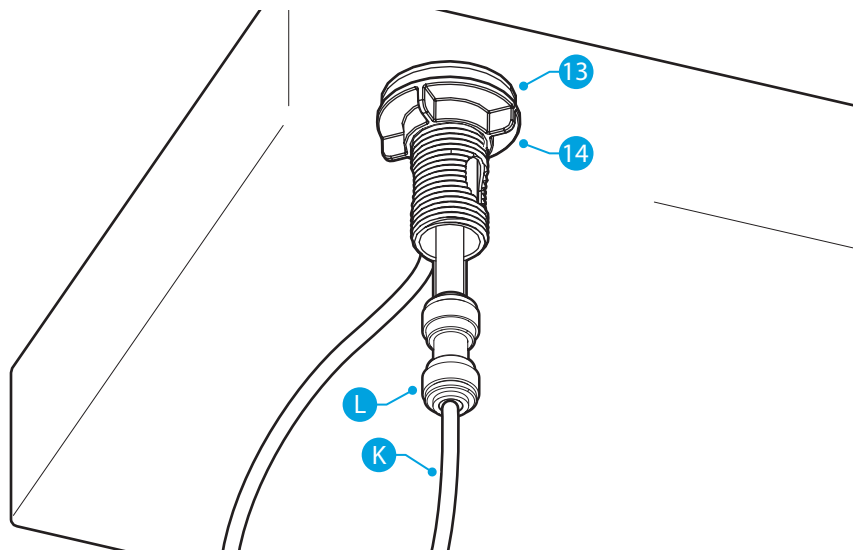

## 5. Complete the Installation

- A. Connect the shut-off valve tube (J) to the inlet water connection (4).
- B. Connect the filtered water tube (K) to the filtered water connection (5).
- C. Connect the RO waste water tube (I) to the waste water connection (6).
- D. Ensure all connections are secure before proceeding.

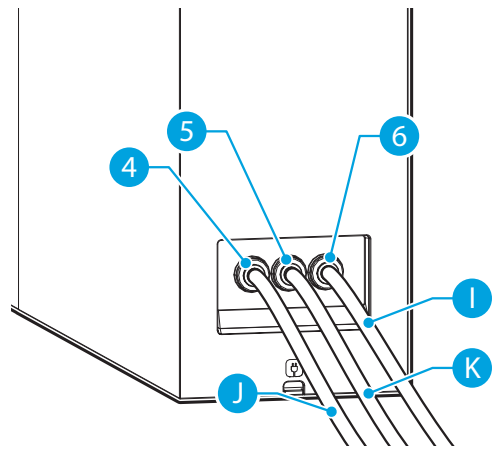

## Operation

### Start Up the Filtration System

1. Ensure all water connections are completed as described in the Installation section.
2. Connect the power supply to the filtration system and then to an outlet. The filter indicator panel turns on.
3. Turn the cold water supply on. Open the shut-off valve on tube (J).

**NOTE:** When the system is first turned on, it goes into automatic flushing state, which lasts approximately 25 seconds.

4. Flush the filters. (See “Flushing the Filters” on page 13.) While system is flushing, make sure there are no leaks in the joints, fittings, valves, and tubing connections.

### Start Water Purification

Turn on the faucet by rotating the lever forward. The water filtration system starts to produce water.

**NOTE:** If the faucet runs water for over 30 minutes, the filtration unit enters overtime protection mode. When this happens, the unit will beep, the filter indicator lights will flash, and the system will no longer produce water. Unplug the filtration unit from the outlet, and then plug it in again to clear the protection mode.

### Shut Down

1. Close the shut-off valve on tube (J).
2. Unplug the unit from the outlet.

# Care and Maintenance

- Keep this device in a cool, dry place away from direct sunshine.
- Use a clean, soft cloth to remove dust build-up. Do not use soap, detergent, or harsh abrasives.
- If the filtration system is not going to be used for an extended period of time, close the shut-off valve on tube (J) and unplug the unit from the outlet.
- Never lay the unit on its side or back. It should always be operated and stored in an upright position.
- If the cold water inlet temperature drops to  $<32\text{ }^{\circ}\text{F}$  ( $<0\text{ }^{\circ}\text{C}$ ), there is a risk the tubes could crack and damaging leaking could occur. To prevent this, turn off the shut-off valve on tube (J), then turn on the faucet and drain any remaining water out of the filtration system.

## Filter Replacement Schedule

Filter Type	Replacement Schedule	Function
PCB Composite Filter (PAC and Carbon)	12 months	Removes mud, sand, rust, suspended solids, residual chlorine, and unpleasant residual tastes.
RO Filter	24 months	Removes up to 99% of contaminants including arsenic, lead, fluoride, heavy metals, and more.

## Replacing the Filters

When one or both of your filter indicator lights begin to flash, the filter(s) needs to be replaced. To change a filter:

1. Unplug the unit from the power source, then turn off the shut-off valve on tube (J).
2. Carefully pry off filter compartment cover (C).
3. Flip up the bracket (15) of the expired filter, then grasp the handle (16) and remove the expired filter.
4. Insert a new filter and flip down the bracket (15) to lock the filter into place.
5. Snap the filter compartment cover (C) back onto the unit.
6. Turn on the shut-off valve on tube (J), then plug the unit back into the power source.
7. Touch and hold the Reset button until the filter indicator light stops flashing (approximately 3 seconds).
8. Flush the new filter. (See “Flushing the Filters” on page 13.)

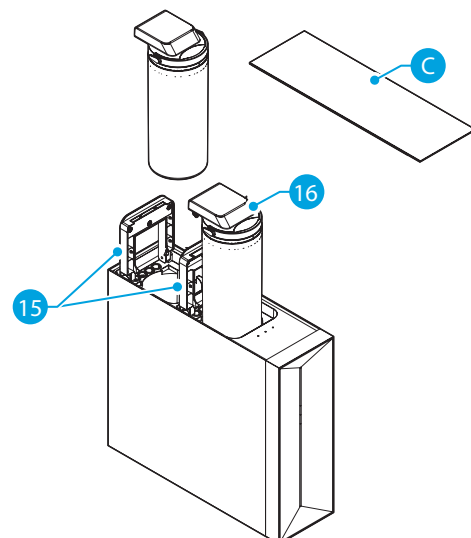

## Flushing the Filters

Always flush new filters before using. Do not drink the water while flushing.

1. Turn on the faucet and allow water to run for 10 minutes.
2. Turn off the faucet and wait 30 minutes.
3. Turn on the faucet and allow water to run for another 10 minutes.

## Troubleshooting

Problem	Probable Cause	Solution
The filters are generating a light noise during operation.	The filters may generate a light noise during operation.	This is normal.
The water output volume has dropped.	<ul style="list-style-type: none"><li>• One or both of the filters need to be replaced or reinstalled.</li><li>• Tubing is leaking.</li><li>• Tubing is crimped.</li><li>• The water temperature is low.</li><li>• The water pressure is low.</li><li>• The shut-off valve on the water inlet tube is not completely open.</li></ul>	<ul style="list-style-type: none"><li>• Replace or reinstall one or both the filters. (See “Replacing the Filters” on page 12.)</li><li>• Check system tubing to make sure it has been installed correctly and there are no leaks.</li><li>• If a tube is being pinched, adjust it so water can flow efficiently.</li><li>• Be sure the cold water temperature is between 39 °F and 100 °F (4 °C and 38 °C).</li><li>• Check and confirm water pressure is between 15 and 100 PSI.</li><li>• Ensure the shut-off valve is open.</li></ul>
The water quality is poor.	<ul style="list-style-type: none"><li>• A filter needs to be replaced.</li><li>• The filtration system has not been used in more than 3 days.</li><li>• The quality of the source water is low.</li></ul>	<ul style="list-style-type: none"><li>• Replace one or both filters. (See “Replacing the Filters” on page 12.)</li><li>• Turn on the faucet and flush for 3–5 minutes.</li><li>• Ensure your water source is municipal tap water.</li></ul>
The filter indicator light on the unit is flashing.	<ul style="list-style-type: none"><li>• A filter needs to be replaced.</li></ul>	<ul style="list-style-type: none"><li>• Replace one or both filters. (See “Replacing the Filters” on page 12.)</li></ul>

Problem	Probable Cause	Solution
The filtration system leaks water.	A component in the filtration system has failed.	Immediately shut off the main water supply and unplug the unit from power source. Contact customer service for assistance.
There is no water output after replacing a filter.	There is an air jam.	When replacing a filter, it is important to shut off the power followed by the water supply, and then turn on the water supply followed by the power supply in that order. (See “Replacing the Filters” on page 12.)

# Warranty

Brio (“Vendor”) warrants to the original purchaser of the Brio Water Filtration System (the “Product”), and to no other person, that if the Product is assembled and operated in accordance with the printed instructions accompanying it, then for a period of one (1) year from the date of purchase, all parts in the Product shall be free from defects in material and workmanship. This Limited Warranty shall be limited to repair or replacement of parts, which prove defective under normal use and service and which Vendor shall determine in its reasonable discretion upon examination to be defective. To take advantage of this Limited Warranty, please follow these steps:

1. Please retain your sales slip or invoice, as Vendor may require reasonable proof of your date of purchase.
2. Contact Vendor’s Customer Service Department using the contact information listed below.
3. Return parts to Vendor, per Vendor’s instructions, at your cost and expense.
4. Upon receipt by Vendor, Vendor shall advise you in writing whether a defect covered by this Limited Warranty exists in any returned part and whether your claim has been approved or denied.
5. Upon Vendor’s approval of your claim, Vendor will replace such defective part without charge to you.

**WHAT THIS LIMITED WARRANTY DOES NOT COVER:** This Limited Warranty does not cover any failures or operating difficulties of the Product due to accident, abuse, misuse, alteration, misapplication, improper installation or improper maintenance or service by you or any third party, or failure to perform normal and routine maintenance on the Product, as set out in the User’s Manual. In addition, this Limited Warranty does not cover damages to the finish, such as scratches, dents, discoloration or rust after purchase.

This Limited Warranty is the only express warranty given on the Product and is in lieu of all other express warranties. Vendor disclaims all warranties for products that are purchased from seller other than authorized retailers or distributors. THIS LIMITED WARRANTY RESTRICTS THE DURATION OF ANY AND ALL IMPLIED WARRANTIES, INCLUDING WITHOUT LIMITATION, THE IMPLIED WARRANTY OF MERCHANTABILITY AND FITNESS FOR A PARTICULAR PURPOSE TO THE ONE (1) YEAR TERM OF THIS LIMITED WARRANTY. UPON THE EXPIRATION OF THE ONE (1) YEAR TERM OF THIS LIMITED WARRANTY, VENDOR DISCLAIMS ANY AND ALL IMPLIED WARRANTIES, INCLUDING WITHOUT LIMITATION THE IMPLIED WARRANTIES OF MERCHANTABILITY AND FITNESS FOR A PARTICULAR PURPOSE, THE PRODUCT BEING THUS SOLD AS-IS, WITH ALL FAULTS. FURTHER, VENDOR SHALL HAVE NO LIABILITY WHATSOEVER TO PURCHASER OR ANY THIRD PARTY FOR ANY SPECIAL, INDIRECT, PUNITIVE, INCIDENTAL, OR CONSEQUENTIAL DAMAGES. OTHER THAN THIS LIMITED WARRANTY, THERE ARE NO WARRANTIES WHICH EXTEND BEYOND THE DESCRIPTION ON THE FACE HEREOF. Vendor assumes no responsibility for any defects caused by third parties. This Limited Warranty gives you specific legal rights, and you may have other rights which vary from state to state. State law may also override statements in this Limited Warranty regarding the restriction on the duration of implied warranties. Some jurisdictions do not allow exclusion or limitation of special, incidental or consequential damages, or limitations on how long a warranty lasts, so the above exclusion and limitations may not apply to you.

**Brio**<sup>®</sup>

**Contact Us**

**Call: +1 844-257-4103**