

CALIBRE CORNER WRAP GRAB RAIL

STOCK CODE(S)

Mod 32mm 600mm x 600mm - NRCR3290W

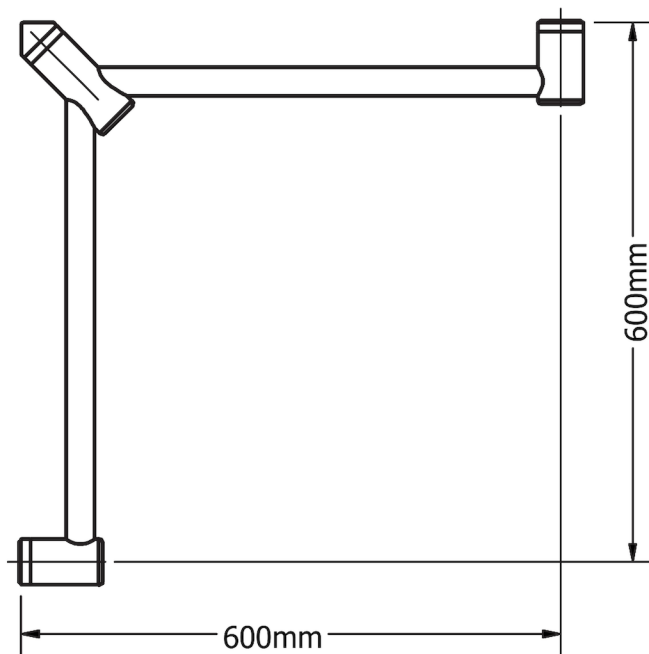

TOP

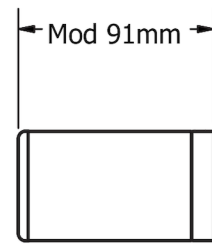

SIDE

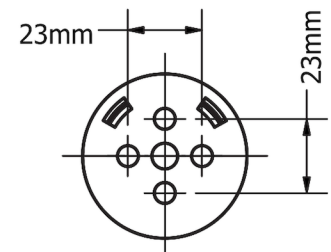

WALL BRACKET

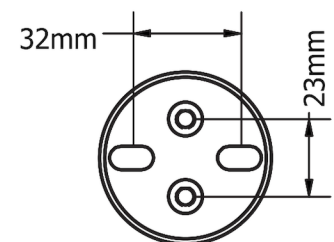

CORNER BRACKET

AVAIL QUALITY DESIGNS

- Australian Owned and Designed
- The wrap around rail is a great option for showers as you turn and bend to wash
- Available in over 7 finishes including Living Brass, Chrome, Matt Black, Gunmetal, Brushed Nickel, Bronze, Gold
- Modular design, the rail to be cut down to suit your bathroom
- 150 kg capacity for all 32mm diameter calibre grab rails
- Mod 32mm diameter rails are approved for standard AS1428.1 requirements in DDA bathrooms

Installation Instruction

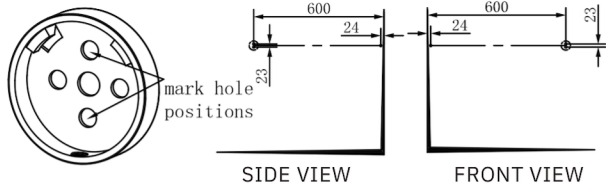

1. Locate wall studs, install into at least one stud. Place wall seal/mounting bracket on wall at correct height over centre of stud and mark hole positions on wall (minimum 2 supplied screws per bracket).

Tip: Rail height is 790mm above the ground

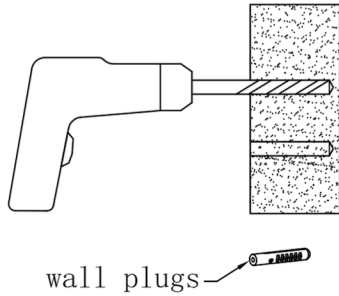

2. Drill pilot holes into wall stud approximately 60mm deep to suit mounting screws (and wall plugs if required).

Tip: 3mm hole for screws into timber or 8mm hole for wall plugs.

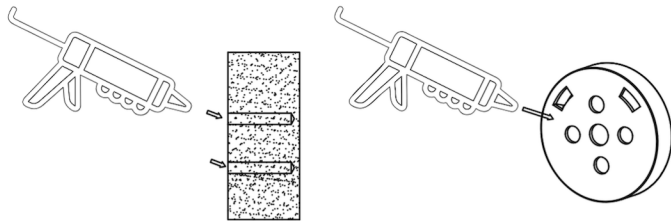

3. Apply small amount of silicon to mounting bracket and wall in and around the screw holes.

WALL BRACKET

CORNER BRACKET

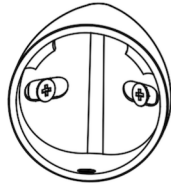
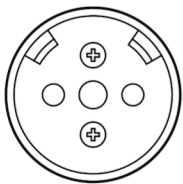

4. Install mounting brackets by screwing onto wall. Wall bracket and corner bracket is different.

Tip: Use appropriate mounting screws for the wall stud material, supplied screws are for timber wall studs.

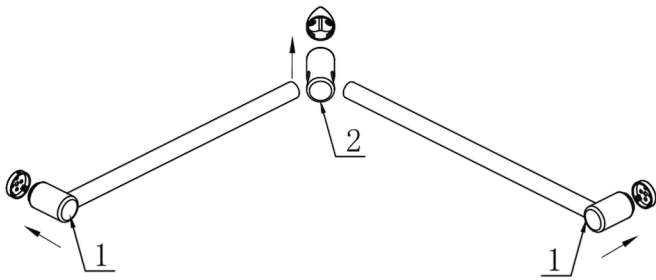

5. Slide rail tube into end bracket and push onto wall brackets, refer to left picture.

Tip: Rail length can be cut down to a smaller size, simply use an angle grinder, hacksaw or pipe cutter then deburr the end with a file or grinder and reinsert into the end bracket.

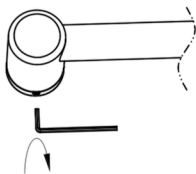

6. Tighten grub screws with Allen key.

Tip: If rail rattles, loosen end bracket, twist slightly and tighten.

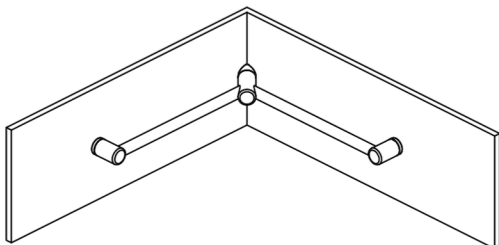

7. Finish.