

NEURONIC

Get started with the Neuradiant 1070

Fitting Guide

Remove the helmet and components from the case. Take the velcro strips from the adhesive paper and apply onto the inside of the helmet as shown in the diagram.

Apply the sponges or foam headpiece onto the velcro so the unit is fitted during use.

Do not place any velcro on the clear plastic inside the helmet.

Bottom View

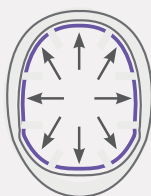

Velcro

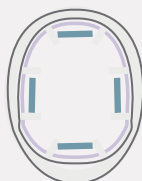

Sponges

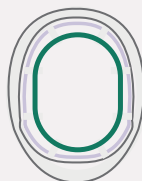

Foam Headpiece

Turning on the Device

Connect the helmet with the controller, connect the controller with the power adapter.

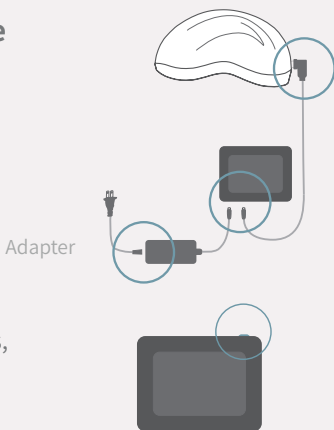

After connecting the cables, you can turn on the device via the **button** on the **top right**.

Selecting a Program

Select one of our 4 programs as shown above for general wellness.

Custom Program:

To be used when instructed by a clinician. Contact us at support@neuronic.online for more information.

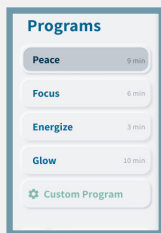

Clinical Protocol Passcode:

4

4

6

6



As natural as greeting the sun **twice a day**. Using the device twice daily is recommended.



Starting a Program

Now that you have selected your program, click the start button when the helmet is placed on your head.

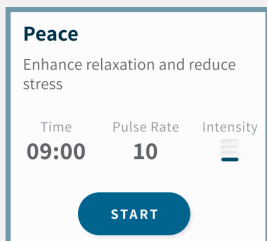

Our product cannot guarantee the same effects on each individual. There are no known side effects of using our device. Still, we advise you to consult us or your local doctor and conduct your independent research before using the device.

Please note this is not a medical device, we do not claim to treat, cure, prevent or diagnose diseases.

