

ICE1
Fully Manual Belt-Drive Turntable



USER MANUAL

Customer Service Support: support@theaudiokeeper.com
www.theaudiokeeper.com

INSTRUCTION

Thank you for purchasing this "Audio Keeper" product.

Before using this product, please read the user manual of this product thoroughly to ensure the correct use of this product. Please also keep this manual in a safe place for future reference.

This product is intended for use only in the country/region where it is sold.

Please make sure that the operating voltage and plug of the AC adapter for this product are suitable for the country/region where you live.

PACKAGE CONTENT

Before using this product, please make sure that all of the included items listed below are included in the package.

If any items are missing or damaged, please contact our after-sales email support@theaudiokeeper.com



turntable lid



turntable unit



Counterweight



turntable platter

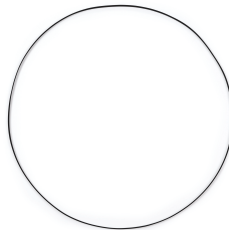

drive belt



slip mat



user manual



45RPM adapter



stylus



9V/2.0A DC adapter



RCA cable



PC link cable

After purchase, we recommend that you save all packing materials for future storage, moving or shipping.

SAFETY INSTRUCTION

Although this product is designed for safety, accidents may still occur if it is used improperly. To ensure safety, please heed all warnings and cautions when using this product. Read and understand the entire manual before using this product.

Keep these instructions for future reference.

1. Do not use this product near water.
2. This product should be operated only by the type of power source indicated on the marking label or in this instruction manual.
3. Do not defeat the safety purpose of the polarized plug. A polarized plug has two blades with one blade wider than the other. This plug will fit into the power outlet only one way. If you are unable to insert the plug fully into the outlet try reversing the plug. If the plug should still fail to fit, contact your electrician.

4. Protect the power cord from being walked on or pinched particularly at plugs, convenient receptacles, and the point where they exit from the product.
5. Do not overload wall outlets, extension cords, or integral convenient receptades as this can result in a risk of fire or electric shock.
6. Never push objects of any kind into this product through openings as they may touch dangerous voltage points or short-out parts that could result in a fire or electric shock. Never spil liquid of any kind on the product.
7. Do not attempt to service this product yourself as opening or removing covers may expose you to dangerous voltageor other hazards. Refer all servicing to qualified service personnel.
8. Changes or modifications to this unit not expressly approved by the party responsible for compliance could void the user's authority to operate the equipment.
9. Do not use attachments not recommended by the product manufacturer ad they may cause hazards.
10. A product and cart combination should be moved with care. Quick stops, excessive force, and uneven surfaces may cause the product and cart combination to overturn.
11. Slots and openings in the cabinet are provided for ventilation and to ensure reliable operation of the product and to protect it from overheating. Do not block or cover these openings.
12. Unplug the product during lightning storm or when unused for long periods of time.
13. This product can be used only in countries where the product is sold. Make sure that the operating voltage and the plug of AC the adapter of the product are correct for the country you live in.

Precautions for use

1) Turntable base:

- Do not place and use this product in places that are extremely hot, humid, dirty, or subject to severe vibration.
- This product should be placed on a flat, level surface.
- When closing the dust cover it should be fully closed. Do not open the dust cover during playback.
- Read the user manual of the Bluetooth receiver device.

2) Cartridge

- Attach the included protective cap to the cartridge when the product is not in use.
- Do not touch the stylus of the cartridge with your fingers.
- Do not strike the stylus against the platter, felt pad or edge of the record.

PRODUCT STRUCTURE AND COMPONENT

- 1) Motor Pulley
- 2) Drive Belt
- 3) Turntable Spindle
- 4) Turntable Platter
- 5) Lid Hinge
- 6) Counterweight
- 7) Tonearm Rest
- 8) Tonearm Lift Lever
- 9) Tonearm Clip
- 10) Stylus Cartridge
- 11) Cover
- 12) Ground Connector
- 13) Phono & Line Out Jacks
- 14) Phono/BT Out/Line
- 15) USB Port for PC Link
- 16) 33 1/3 / 45 RPM Selector
- 17) Auto Stop Selector
- 18) Pitch
- 19) Power Cord Jack
- 20) Power Switch

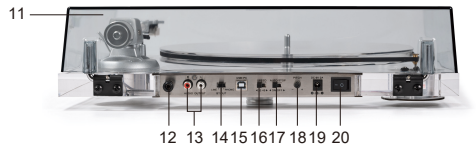
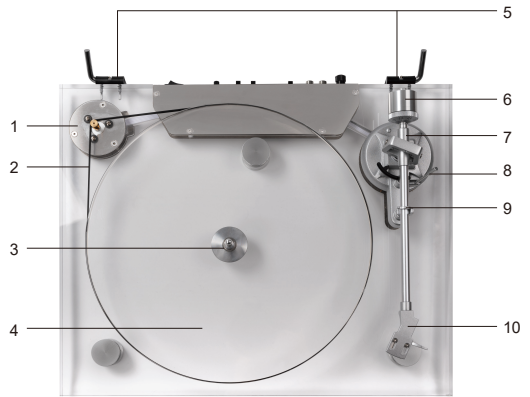

Package List

Before using the turntable, check the package contents to ensure all parts below are included.

- 1* Turntable unit
- 1* Turntable lid
- 1* Mat
- 1* Turntable platter
- 1* Tonearm counterweight
- 1* 45RPM adapter
- 1* Drive belt
- 1* 9V/2.0A DC adapter
- 1* PC link cable
- 1* RCA cable
- 1* User manual

TURNTABLE SIZE

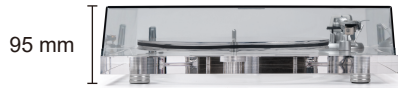
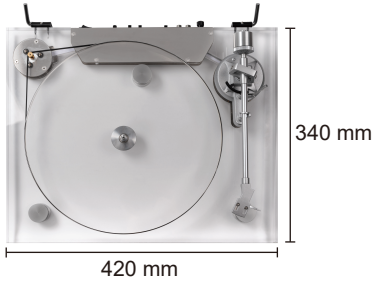

Turntable Specifications

| | |
|---------------------------|---------------|
| Item model | ICE1 |
| Drive system | Belt Drive |
| Rated voltage | 100-240v |
| Speed | 33 1/3, 45RPM |
| Bluetooth Input | No |
| Bluetooth Output | Yes |
| Bluetooth effective range | ≤10m |
| Frequency response range | 120Hz-16kHz |
| Adaptor | DC 9.0V, 2A |

TURNTABLE SET UP

Turntable Installation

Mount the product on a level surface.

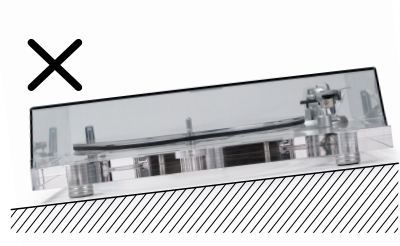

Lid Installation

Insert the hinge pockets of the lid onto the hinge of the turntable.

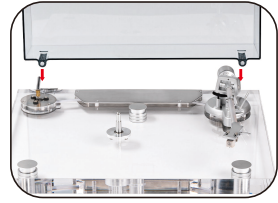

Turntable Platter and Belt Setup

1. Loop the belt onto the sub-platter.



2. Carefully place the main platter to the spindle located in the middle of the turntable.



3. Loop the belt onto the motor pulley.



4. Slowly rotate the platter 10 times in the direction of the arrow for resetting the auto mechanism to avoid any twists in the belt and make sure the belt rides smoothly along the drive rim on the underside of the platter.



Cartridge Tracking Force Adjustment

The counterweight supplied is suitable for cartridge weighing between 1.6-3.5g

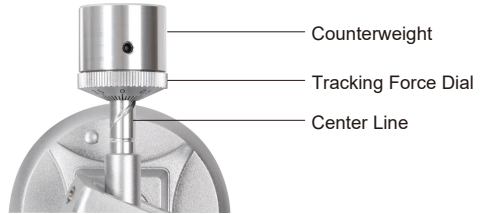

1. Gently push and turn the counterweight onto the rear of the tonearm (with the dial facing toward the front of the turntable)

2. Pull the protector straight forward to remove it.

Notes:

Applying a downward force may cause the stylus to come off the body. Only low volume is output if the stylus has come off, or is about to come off, so refer to "Replacing the Stylus" to reattach the stylus correctly.

3. Remove the tie-wrap and unlock and tonearm.

4. Lower the tonearm life lever and position the cartridge in the space between the tonearm rest and platter.

5. Carefully rotate the counterweight until the tonearm achieves a neutral balance. The tonearm should return to this balanced position if it is moved up or down. The adjustment must be done carefully.

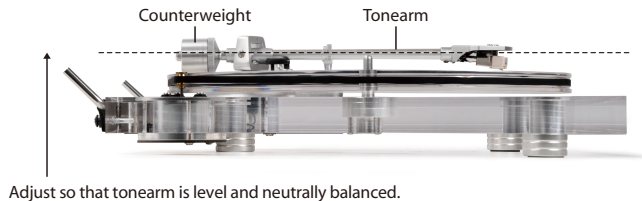
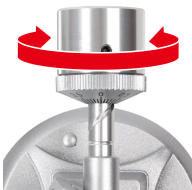
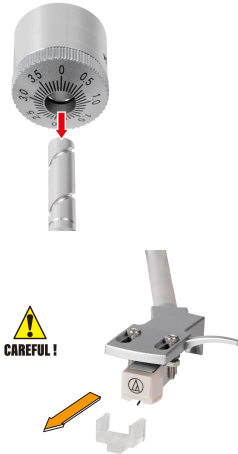

6. Once the tonearm is correctly balanced, return the tonearm to its rest. Hold the counterweight without moving it, and gently rotate the tracking force dial until the zero is in line with black center line on the real of the tonearm. Check to make sure the tonearm is still neutrally balanced.



7. Rotate the counterweight (as seen from the front) to adjust the tracking force according to the cartridge manufacturer's recommendations.

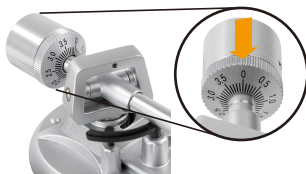

Notes:

Each mark on the scale represents 0.05g. The recommended tracking force for the factory-installed cartridge is $3.0g \pm 0.5g$. The cartridge tracking force only goes up to 2g for one rotation of the tracking force dial. You will need to make more than one rotation to reach 3.5g.

Speed Alignment

1. The Pitch Adjust Control is made to adjust the turntable speed lightly. To check if the speed of a record that is playing correctly, and if it need to be adjusted. do the following:
2. Usually, the strobe dots is in the middle between "-" and "+"
3. For faster speed, slowly turn the Pitch Adjust Control in the "+" direction. For slower speed, slowly turn the Pitch Adjust Control in the "-" direction.

Connection to External Amplifier with RCA Audio Cable

If you wish to use your amplifier or external speakers, please follow the instruction below:

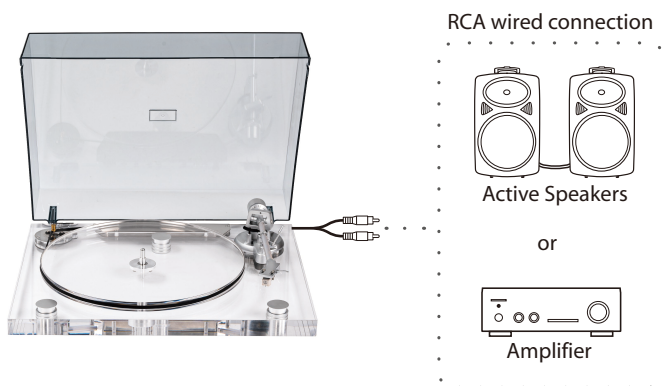

1.1 Setting pre-amplifier selector switch

This product has a built-in phono equalizer function. You can use the product even if you do not have a phono amplifier or connectable equipment with a built-in phono amplifier.

Use the pre-amplifier selector switch to set the output, as shown below:

| Connectable equipment being used | Position of pre-amplifier selector switch | Where to connect RCA audio cable |
|----------------------------------|---|---|
| Device with phono input | PHONO | Phono input jack and ground (earth) terminal of connectable equipment |
| Device without phono input | LINE | AUX or line input jack of connectable equipment |

Notes:

The RCA Jacks are not designed to be connected directly to the passive/unpowered speakers on LINE mode. If connected to the passive speakers, there will be no sound.

1.2 Connecting the device

Align the settings for the pre-amplifier selector switch and connect the RCA audio cable to an input jack that is compatible with the connectable equipment you are using (amplifier, active speakers, etc.)

- The RCA audio cable's red jack is for the right (R) channel, and the white jack is for the left (L) channel.

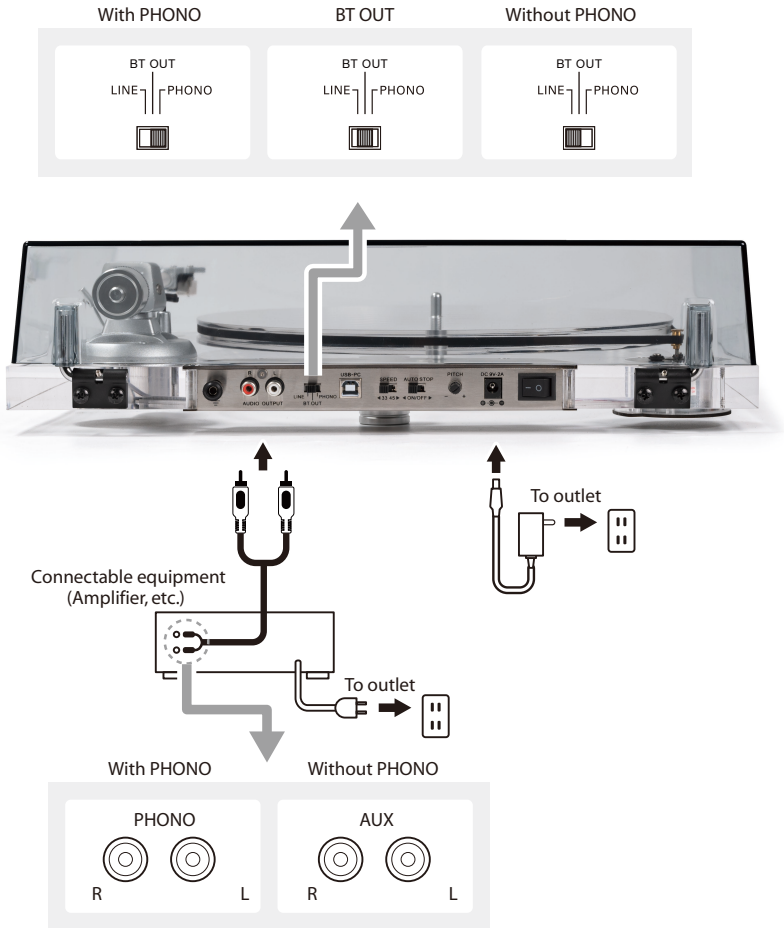

Main Power Connection

1. Insert the DC plug of the AC adapter cord into the DC INPUT Jack at the back of the turntable.
2. Plug the AC adapter into a normal power outlet.

Notes:

Do not plug the AC power adapter outlet before all turntable assembly is completed. Before turning on turntable power, re-check all connections to make sure they are correct and secure. Always turn off the turntable before connecting or disconnecting from power.

OPERATION

Play a record

1. Before playing a record

1.1 Pull the protector straight forward to remove it.

Notes: Applying a downward force may cause the stylus to come off the body. Only low volume is output if the stylus has come off, or is about to come off, so refer to “Replacing the stylus” to reattach the stylus correctly.

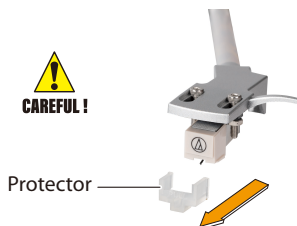

1.2 Place the record on the felt mat so that the center hole aligns with the spindle.



If playing a 45 RPM record with a large center hole, attach the 45 RPM adapter.

2. Turntable Operation

1.1 Turn on the power switch knob.

2.2 Place a record on the turntable platter and select the desired speed(33/45) according to the record. NOTE: when playing a 45RPM record, use the included 45RPM adapter.

3.3 Remove the white needle protector and open the tonearm clip to release the tonearm. Push the lift lever backward to raise the tonearm and gently move the tonearm towards the desired position over the record. Push the lift lever forward to lower the tonearm slowly onto the desired position on the record

4.4 Choose PHONO mode to start playing

Notes:

1. The turntable don't have built in speakers, so please connect your external speakers via RCA cable when in PHONO mode
2. Light will be red in PHONO mode

Bluetooth Transmission

This unit support Bluetooth Transmitter,which gives you the option to play your records/songs and listen to them wirelessly through an external Bluetooth speaker system.

This can only be done if the external speaker has a built-in Bluetooth Receiver. The range is approximately 10 metres.

- 1.Switch on your external Bluetooth speaker/speaker system first.
- 2.Turn on the turntable and choose BT OUT.
- 3.Although the ICE1 does not have a Bluetooth indicator, you can determine whether a Bluetooth connection was successfully established by the indication on your connected Bluetooth device.

When the ICE1 is successfully paired and connected to your Bluetooth device, your Bluetooth device will usually display a "Connected" or voice prompt.

At this point, you can start playing music and control music playback by connecting your device.

- 4.Starts playback of your records / songs

Notes:

1. The Bluetooth transmission option is on the LINE&BT OUT&PHONE () switch at the back of the turntable,press the switch middle to set up the Bluetooth transmission (When Bluetooth output working, RCA socket has no audio signal output).
2. This turntable only support Bluetooth Output,not support Bluetooth input.

Record the vinyl to your computer

Please follow the below steps to set up Audacity to record from the USB audio device. For more details, please refer to the BRIEF INTRODUCTION OF AUDACITY at https://manual.audacityteam.org/man/recording_with_usb_turntables.html

1. Download the Audacity software and complete installation

1.1 Ensure your Audacity software is up to date version from <http://www.audacityteam.org/download/>

1.2 Follow the instructions to complete installation. You can download the current

2. Set up Audacity to record from the USB audio device

2.1 Connect the USB device

Use the supplied USB cable to connect your turntable and your computer. No extra driver is required.

2.2 System settings needed for Windows and Mac

Windows:

1. By the system clock, right-click over the **Speaker icon** select **Sounds** then the **Recording** tab, and then click on the **USB device** in the list and click **Properties** . Click the **Advanced** tab set your required bit rate and sample rate from the **Default Format** dropdown (normally " **2 channel 16-bit 44100 Hz** ").
2. On the Advanced tab, in the "Default Format" section, make sure the dropdown menu is set to " **2 channel 16-bit 44100 Hz** " .

For a more detailed walk-through of the above steps for Windows (*or if that does not work for your version of Windows*), see **Windows: accessing the Windows Sound controls**.

Mac:

1. From **Apple Menu > System Preferences** select "Sound" and click on the **Input** tab
2. Select "USB Audio CODEC" or similar as the input device and verify the **Recording Meter** shows input.
3. If the recording meter in the Sound preferences panel does not show input:
 1. From the Finder, select **Go > Utilities** and open **Audio MIDI Setup** .
 2. If the *Audio Devices* window is not visible, select **Window > Show Audio Devices**.
 3. Select your USB input device in the list in the left pane of the Audio Devices window.
 4. Set the Format to "**44100.0 Hz**" and "**2ch-16bit**".

For a more detailed walk-through of the above steps for Mac , see *Mac and USB input devices* on the Audacity Wiki.

2.3 Launch Audacity.

If Audacity was already running when you connected the cable, choose **Transport >Rescan Audio Devices** or restart Audacity.

2.4 Project Rate

Set the Audacity Project Rate in **Selection Toolbar** at the bottom left of the Audacity screen to **44100 Hz**:



2.5 Devices

Use **Device Toolbar** to set the recording and playback devices and to set the recording channels to "2 (Stereo) Recording Channels", as in the below example on Windows 10:

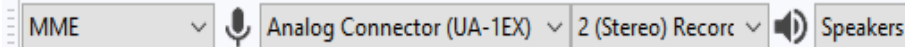

- The Recording Device is set to the USB device (in this case the device name, but often called or including the phrase "USB Audio CODEC").
- Recording Channels is set to stereo.
- The Playback Device is set to the named speakers of the built-in computer sound device. (**Note: Please choose computer built-in sound device output, otherwise, there will be no sound from computer output when replaying**)
- These settings can also be changed in **Devices Preferences**.

Windows calls most USB external devices "microphones". Some higher-end USB recording interfaces may appear as their explicit manufacturer's name.

3. Software Playthrough

Use **Transport > Transport Options > Software Playthrough (on/off)** and click "**Software Playthrough**" to turn it "on" (the checkmark is shown when it is "on"). This setting can also be enabled or disabled in **Recording Preferences**. Software Playthrough lets you hear the turntable through the computer speakers when recording. It also lets you hear the turntable *without* recording if you turn on monitoring (see the next section below).

Note: TPLs choose computer built-in sound device output, otherwise, there will be no sound from computer output when replaying

4. Monitoring

Enable monitoring to set the recording level

- Turn monitoring on by clicking once on the microphone icon in the **Recording Meter**.

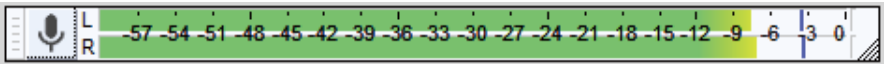

- In **Mixer Toolbar**, turn up the left-hand playback volume slider (by the speaker icon).

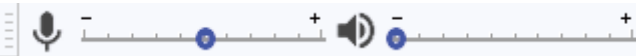

- The right-hand recording volume slider (by the microphone icon) can often be used to vary the loudness of the recording, but it may not function with all turntables. If it does not, try adjusting the output level on the turntable (often, there is a gain control under the chassis).

Alternatively, you may be able to adjust the input level on Windows and Linux only, usually by looking for the speaker icon by the system clock. On **Windows, right-**

click over the speaker icon > "Recording Devices". Then right-click over USB Audio Codec, choose "Properties" and click the *Level* tab.

- Try to aim for a maximum peak of around -6 dB, which corresponds to around 0.5 on the **waveform**. You can always boost the level later with **Effect > Amplify...** or **Effect > Normalize...** after you have completed editing.

5. Recording

Then, ignoring any instructions in the manufacturer's guide to select "stereo mix", simply press the **Record** button  in Transport Toolbar to start recording from the turntable.

6. Recording, editing and exporting

Once your USB turntable is set up and working properly, go to the **Basic Recording, Editing and Exporting** section of Audacity's **Tutorial - Copying tapes, LPs or MiniDiscs to CD** for instructions on how to:

- make and edit your recording
- export it to an audio file
- import it to iTunes or Windows Media Player
- burn it to CD

Audacity's reference links

- **Basic Recording, Editing and Exporting:** https://manual.audacityteam.org/man/basic_recording_editing_and_exporting.html
- **Tutorial - Copying tapes, LPs or MiniDiscs to CD:** https://manual.audacityteam.org/man/tutorial_copying_tapes_lps_or_minidisks_to_cd.html

CARE

Turntable Body

- When the turntable body is dirty or dusty, first disconnect the AC adapter, and then wipe off the dirt and dust with a soft, dry cloth.
- Do not use benzenes, thinners, etc.
- When storing the product for a long time, disconnect the AC adapter from the outlet and wrap the product in plastic; do not allow it to become damp; the drive belt should be removed to prevent unequal stretching.

Stylus Tip

- If dirt and grime are stuck to the stylus tip, clean it with a commercially sold brush.
- We recommend using a stylus cleaner (not included) if the stylus tip is considerably dirty. Clean the stylus tip by moving the brush from the rear to the front of the stylus tip.

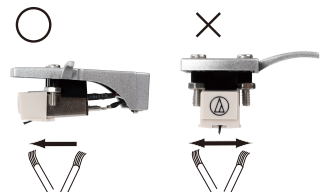

Replacing the Stylus

It's suggested to replace the stylus after 400 hours of use.

Removing the Stylus

- In addition to the deterioration of sound quality, records may also be damaged as the cartridge's stylus tip wears down.
- Be sure to disconnect the product's AC adapter from the outlet.

1. When replacing the stylus, hold the headshell and the cartridge body tightly. Rotate the front of the stylus in a forward and down motion.
2. Mount the new replacement stylus to the cartridge.
3. Lift the stylus up until you hear a click.
4. Make sure there is no gap between the headshell and the cartridge.



When the Turntable is Moved

Using the product's original packing materials, wrap the turntable in the reverse order from when you unwrapped it. If you do not have the packaging materials, take the following measures:

- After disconnecting the AC adapter from the outlet, remove the felt mat and platter, and then wrap them so that they do not get damaged.
- Attach the protector to the cartridge.
- Use a string or something similar to tie the tonearm to the rest so that it does not move.
- Wrap the turntable body with paper or a soft cloth so that it does not get damaged.

TECH SUPPORT

After-sales service email: support@theaudiokeeper.com

Website: www.theaudiokeeper.com

SHARE YOUR THOUGHTS!

Your feedback is more worth to us than you know. Connect with our pages.



Audio Keeper Facebook



Audio Keeper Instagram



Audio Keeper YouTube



Audio Keeper website

Contact us! We would love to help you get what you paid for!