

# Assembly Instructions



**Quality Fabricators®**  
**ZRACKS.COM**

**1-877-637-3712**

## PARTS LIST

### Medium Duty Z Rack (Double Rail)

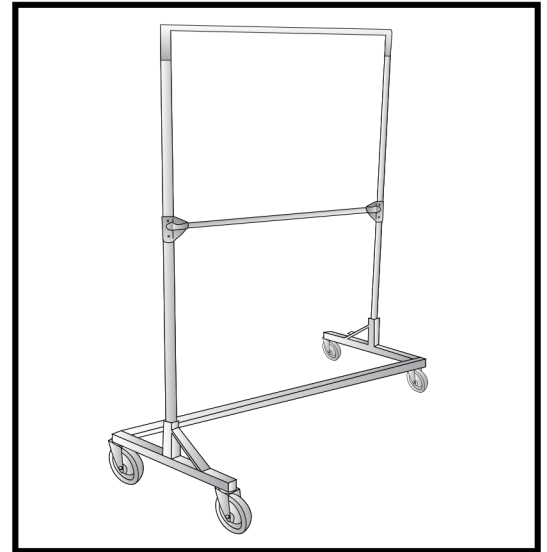

1. Horizontal Hanging Bar (x1)
2. Vertical Support Bar (x2)
3. Frame Cross-Bar (x1)
4. End Frame (x2)
5. Caster (x4)
6. Caster Bumper (x4)
7. Nut (x4)
8. Bolt (x4)
9. Washer (x8)
10. 1 3/4 Carriage Bolts (x4)
11. Kep Nut (x4)
12. Brace Clamp (x2 / 4 pieces)
13. Middle Hang Rail (x1)
14. 10" Extensions (x2)

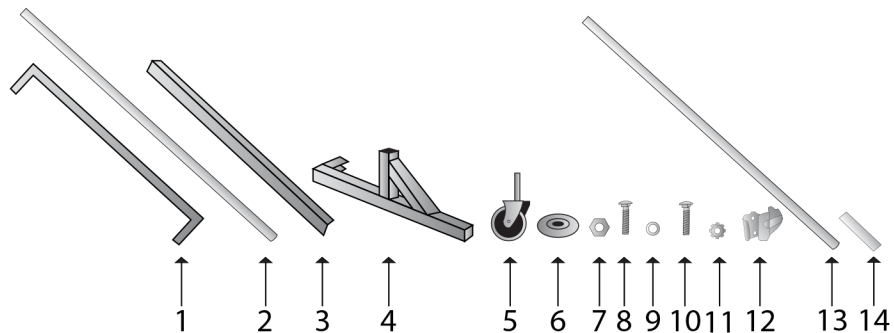

## ASSEMBLY INSTRUCTIONS

1. Remove the included washers and bolts from the frames, using the included Allen wrench. (Figure 1)
2. Slide the frame and the frame cross-bar together, aligning the bolt holes. (Figure 2)
3. Insert bolts into aligned bolt holes, placing the washers between the frame and bolt. Tighten using the included Allen wrench. (Figure 3)
4. Place rubber bumpers on casters with concave side toward caster.
5. Align and insert casters with rubber bumpers. Tighten bolt on opposite side using included wrench. (Figure 4)

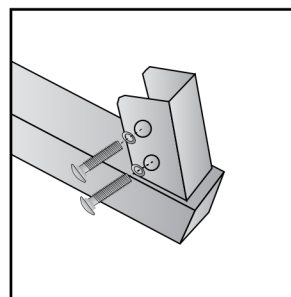

Figure 1

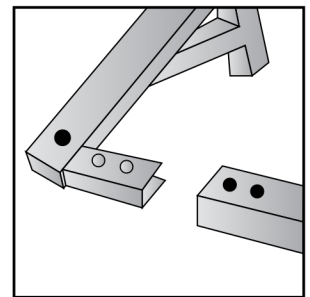

Figure 2

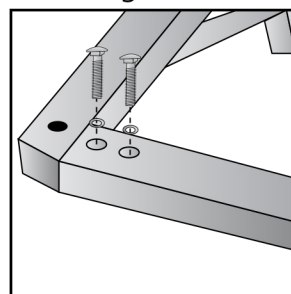

Figure 3

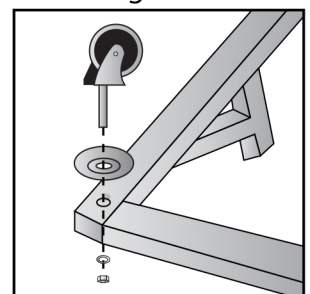

Figure 4

Continues onto back →