

36" Wall Cabinet

8336 Wall Cabinet

- Wall cabinet with 2 doors and 1 adjustable shelf
- Durable, easy-clean, thermofoil surfaces
- No front facing seams
- Unit is pre-assembled to save installation time
- Cabinet easily mounts with hook and rail mounting system
- Fully adjustable, concealed, soft-close hinges
- Smart looking, easy-clean, satin chrome pulls
- Choose from 4 contemporary finishes

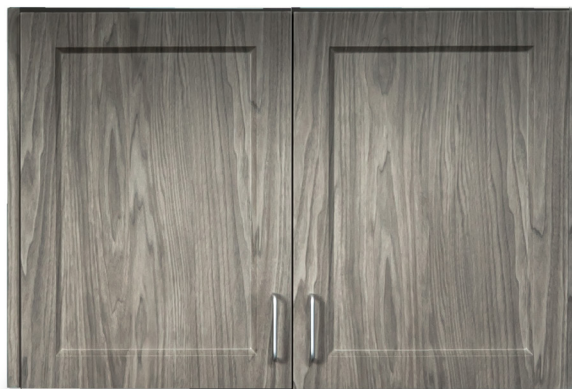

fashionfinish
CASEWORK BY CLINTON



8336 SPECIFICATIONS

36" W x 12" D x 24" H

California residents please be advised of the following, pursuant to Proposition 65:

! **WARNING:** This product can expose you to chemicals, including chromium, which is known to the State of California to cause cancer or reproductive toxicity. For more information go to www.P65Warnings.ca.gov.

Options



055 Door Locks

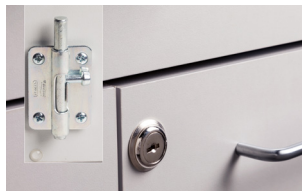

066 Door Locks & Latch Combo

Finishes



Chestnut Hill



Twilight



Arctic White



Metropolis Gray