

# Correct

## Mounting using legs

When using the mounting legs with the bar, make sure you mount the legs to the bar first. Then mark your mounting holes before you drill. When bolting the legs down make sure the legs are straight (90 degrees from bar)



Legs must be 90 degrees to bar

## Mounting using legs and clamps

When using the mounting legs and clamps with the bar, make sure you mount the legs and clamps to the bar first. When tightening the clamps down on the roll bar make sure the legs are straight (90 degrees from bar)



Legs must be 90 degrees to bar

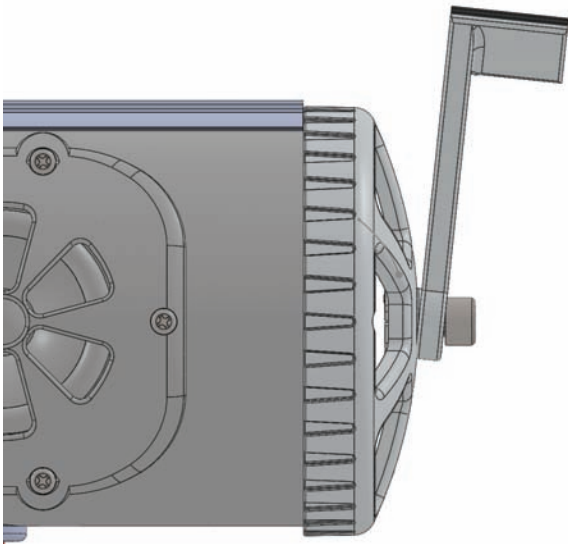

# Incorrect

Legs must not be mounted at an angle. This can cause the leds in the grills to short out