

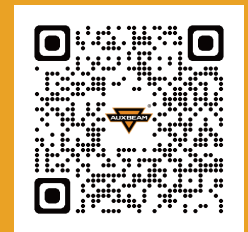

EMERGENCY STROBE LIGHT BAR USER MANUAL

LIGHT THE WAY



SCAN QR CODE TO OBTAIN SUPPORTING
CUSTOMER@AUXBEAM.COM

THANK YOU

FOR CHOOSING
AUXBEAM PRODUCTS

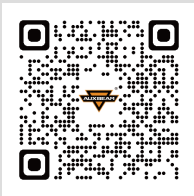

If you have any questions,
please to contact our customer service.

CUSTOMER@AUXBEAM.COM

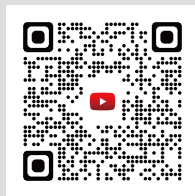

Please scan the QR code on YouTube to
access more **installation & operation**
videos for the light bar.

CONTENTS

EMERGENCY STROBE LIGHT BAR

02 / LED Rooftop Strobe
Light Bar

08 / Dual Visor
Strobe Light Bar

10 / Dual Windshield
Dash Strobe Light Bar

12 / Dual Traffic
Advisor Light Bar

14 / Customer
Service

LED ROOFTOP STROBE LIGHT BAR

PRODUCT DISPLAY



17 INCH



21.5 INCH



31.5 INCH



38.5 INCH



47 INCH



CONTROL METHOD INSTRUCTIONS

BUTTON CONTROL (17 Inch)



- ① Lighted power switch to turn on and off
- ② To change between 23 different patterns

SWITCH PANEL A (21.5 & 31.5 Inch)

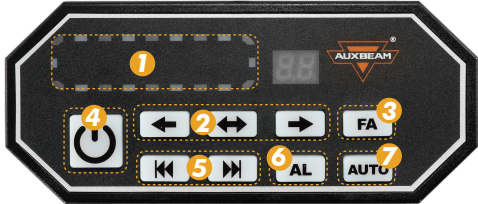

- ① Pattern Display
- ② Quick-select Directional Buttons
- ③ Save Your Favorite Pattern
- ④ On/Off(with memory function)
- ⑤ Previous Mode Select Button / Next Mode Select Button
- ⑥ Alternate Flashing Button
- ⑦ Auto Cycle Mode Button(from 1-20 patterns)

SWITCH PANEL B (38.5 & 47 Inch)

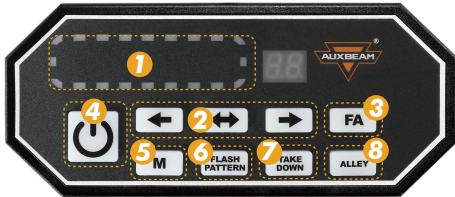

- ① Pattern Display
- ② Quick-select Directional Buttons
- ③ Save Your Favorite Pattern
- ④ On/Off (with memory function)
- ⑤ Pause Flash (Take down & Alley function is not affected)
- ⑥ Select Pattern Button
- ⑦ Steady White Light Front and Back
- ⑧ Steady White Light Both Sides

INSTALLATION INSTRUCTIONS

BRACKET INSTALLATION (31.5&38.5&47 Inch)

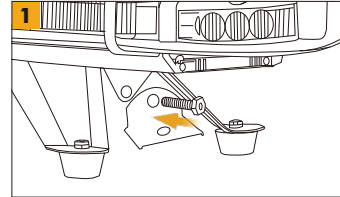

1. Insert the bolt into the short bracket, then insert it into the bottom holes of the light bar.

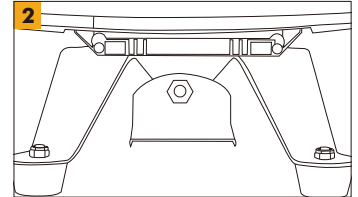

2. Secure them tightly with a nut.

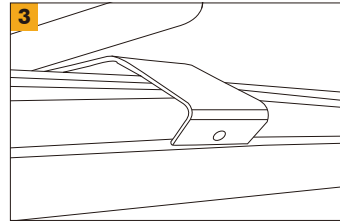

3. Fix the long bracket in the gap at the top of the car door.

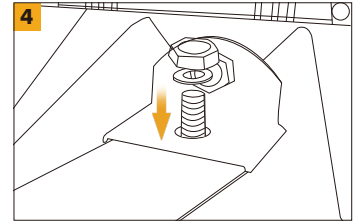

4. Insert the bolts into the overlapping holes of the two brackets.

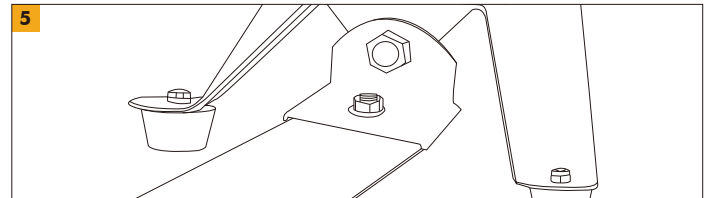

5. Add the nut to hold the light bar on the vehicle firmly.

MAGNET INSTALLATION (17&21.5 Inch)



Attach the strobe light bar directly to the roof of car.

WIRING INSTRUCTIONS

CIGARETTE ADAPTER (17&21.5 Inch)

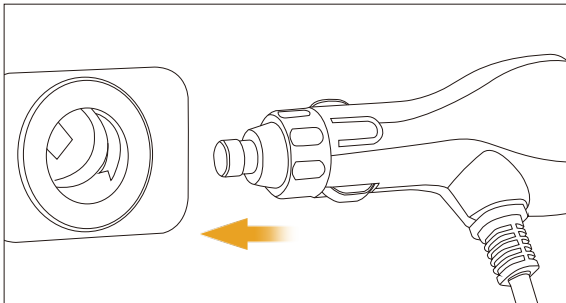

POWER LINE ACCESS BATTERY (31.5&38.5&47 Inch)

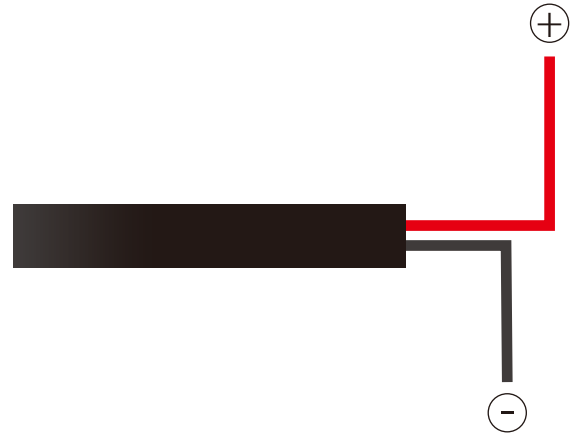

Black Cable: (- Negative), Red Cable: (+ Positive)"

DUAL VISOR STROBE LIGHT BAR

LIGHT BAR

PRODUCT DISPLAY



CONTROL METHOD INSTRUCTIONS

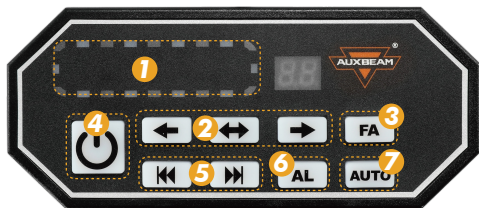

- ① Pattern Display
- ② Quick-select Directional Buttons
- ③ Save Your Favorite Pattern
- ④ On/Off(with memory function)
- ⑤ Previous Mode Select Button / Next Mode Select Button
- ⑥ Alternate Flashing Button
- ⑦ Auto Cycle Mode Button (from 1-20 patterns)

INSTALLATION INSTRUCTIONS

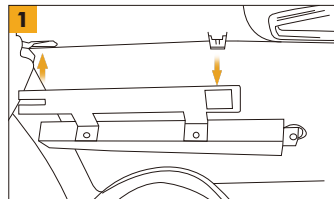

1. Determine the best location for the light bar on vehicle visor.

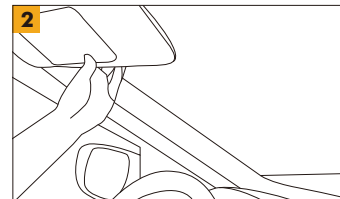

2. Clean the surface of the vehicle visor to ensure that it is free of any dirt or debris.

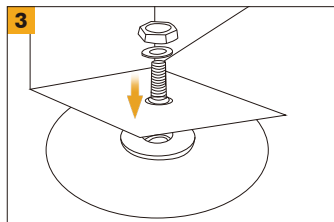

3. Attach the suction cups to the light bar.

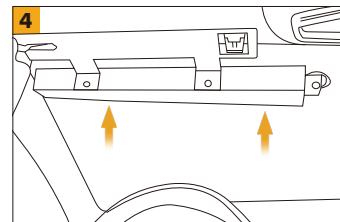

4. Place the light bar on the vehicle visor and press it firmly.

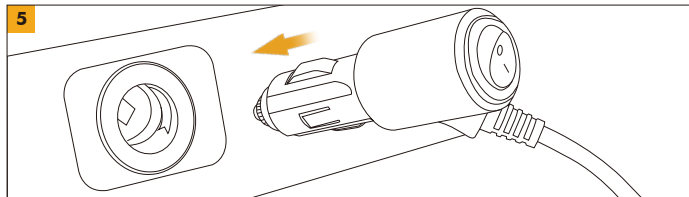

5. Connect the cigarette adapter harness to your vehicle's electrical system.

DUAL WINDSHIELD DASH STROBE LIGHT BAR

PRODUCT DISPLAY



CONTROL METHOD INSTRUCTIONS

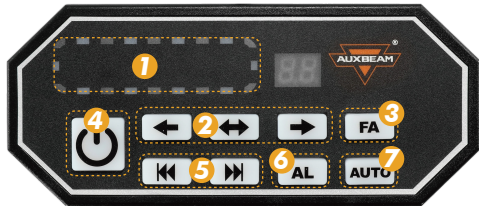

- ① Pattern Display
- ② Quick-select Directional Buttons
- ③ Save Your Favorite Pattern
- ④ On/Off(with memory function)
- ⑤ Previous Mode Select Button / Next Mode Select Button
- ⑥ Alternate Flashing Button
- ⑦ Auto Cycle Mode Button (from 1-20 patterns)

INSTALLATION INSTRUCTIONS

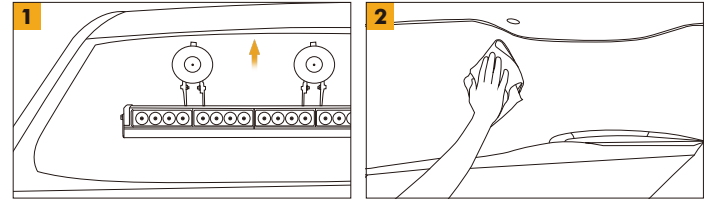

- 1. Determine the best location for the light bar on your windshield.
- 2. Clean the area where you plan to install the light bar with water and dry it with a rag.

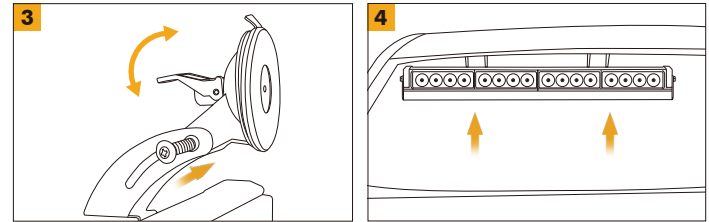

- 3. Attach the suction cups to the light bar.
- 4. Place the light bar onto the windshield and press down firmly.

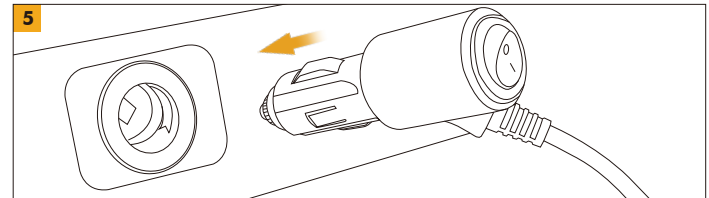

- 5. Connect the cigarette adapter harness to your vehicle's electrical system.

DUAL TRAFFIC ADVISOR LIGHT BAR

LIGHT BAR

PRODUCT DISPLAY



CONTROL METHOD INSTRUCTIONS

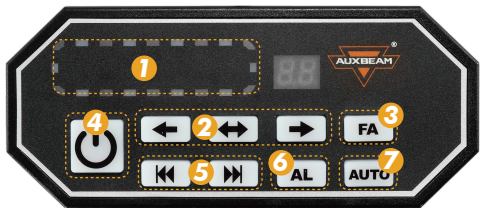

- ① Pattern Display
- ② Quick-select Directional Buttons
- ③ Save Your Favorite Pattern
- ④ On/Off(with memory function)
- ⑤ Previous Mode Select Button / Next Mode Select Button
- ⑥ Alternate Flashing Button
- ⑦ Auto Cycle Mode Button (from 1-20 patterns)

INSTALLATION INSTRUCTIONS

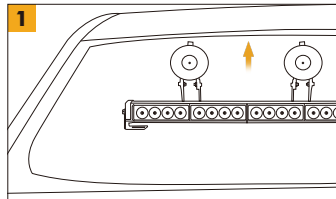

1. Determine the best location for the light bar on your windshield.

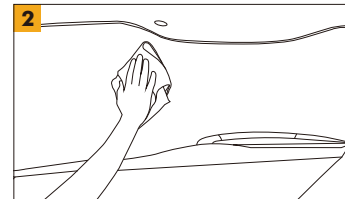

2. Clean the area where you plan to install the light bar with water and dry it with a rag.

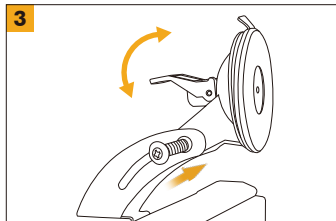

3. Attach the suction cups to the light bar.

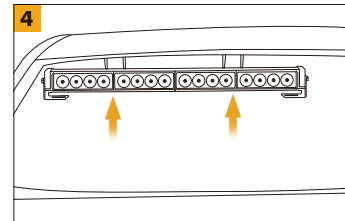

4. Place the light bar onto the windshield and press down firmly.

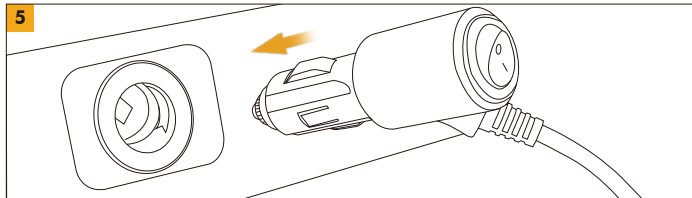

5. Connect the cigarette adapter harness to your vehicle's electrical system.

CUSTOMER SERVICE

CONTACT US

 CUSTOMER@AUXBEAM.COM



@auxbeam



@auxbeam



@auxbeam



auxbeamledlight

