

Goldair™



Operating Instructions

40cm Electronic Pedestal Fan with Wifi



Model: GCPF170

General Care and Safety Guide

Thank you for choosing this Goldair product. This Goldair appliance has been designed and manufactured to high standards of engineering and with proper use and care, as described in this leaflet, will give you years of useful service. Please read these instructions carefully and keep them for future reference.

1. This appliance is not intended for use by persons (including children) with reduced physical, sensory or mental capabilities, or lack of experience and knowledge, unless they have been given supervision or instruction concerning use of the appliance by a person responsible for their safety.
2. Children should be supervised to ensure that they do not play with the appliance.
3. If the supply cord is damaged, it must be replaced by the manufacturer, its service agent or similarly qualified persons in order to avoid a hazard.
4. Ensure that the fan is switched off from the supply mains before removing the guard.
5. Use only the voltage specified on the rating plate of the appliance.
6. Keep all objects at least 1 Metre from the front, sides and rear of the appliance
7. This appliance is intended for household use only and not for commercial or industrial use.
8. Use this appliance only as described in this manual. Any other use is not recommended by the manufacturer and may cause fire, electric shock or injury.
9. The common cause of overheating is deposits of dust or fluff in the appliance. Ensure these deposits are removed regularly by unplugging the appliance and vacuum cleaning the air vents and grills.
10. Always unplug appliance when not in use.
11. When the appliance has been unpacked, check it for transport damage and ensure all parts have been delivered. If parts are missing or the appliance has been damaged, contact the Goldair Customer Services Team.
12. If your appliance does not work, or is not working properly, contact the place of purchase. Repair work on the appliance by unqualified persons can cause serious risk to the user.
13. Ensure hands are dry before handling the plug or the main unit.
14. Carry out regular checks of the supply cord to ensure no damage is evident.
15. Ensure that the cord is fully extended (not coiled) while in use.
16. Avoid contact with the moving parts. Keep hands, hair, clothing, away from blade of the fan during operation to reduce the risk of injury to person and/or damage to the unit.
17. Switch off and use handles provided when moving.
18. It is recommended that this fan is plugged directly into the wall socket.
19. A correctly specified, undamaged extension cord may be used with this fan provided it is used in a safe manner.

General Care and Safety Guide

20. Never place appliance close to radiant heat source.
21. Never operate in areas where petrol, paint or other flammable liquids are used or stored.
22. Never use the appliance to dry clothes.
23. Never insert or allow foreign objects to enter any ventilation or exhaust opening, as this may cause an electric shock, fire or damage to the appliance.
24. Never use abrasive cleaning products on this appliance. Clean with a damp cloth (not wet) rinsed in hot soapy water only. Always remove plug from the mains supply before cleaning.
25. Never connect the appliance to mains supply until completely assembled and adjusted.
26. Never remove plug from power socket until the appliance has been switched off.
27. Never remove plug from power socket by pulling cord – always grip plug.
28. Never twist, kink or wrap the cord around the appliance, as this may cause the insulation to weaken and split. Always ensure that all cord has been removed from any cord storage area and is unrolled before use.
29. Never use this appliance in the immediate surrounds of a bath, a shower, or a swimming pool or other liquids. The appliance must not be immersed in any liquids.
30. Due to the risk of injury, never use this appliance for any purpose other than its intended use. This appliance is intended for use in household and similar applications such as staff kitchen areas in shops, offices and other working environments; farm houses, by clients in hotels, motels, bed and breakfast type environments and other residential type environments
31. Never use this appliance outdoors.
32. Never operate the appliance with a damaged cord or plug, after it malfunctions, or if it has been damaged in any manner. Have the appliance checked and repaired by a qualified electrician if repair is necessary.
33. Never place the unit in wardrobes or other enclosed spaces as this may cause fire hazards.

Goldair	
Model No: GCPF170	
Supply: 220-240VAC 50-60Hz	
Wattage: 50W	
Approval No: GMA-512834-EA	
MADE IN CHINA	
QC Passed: PO#-WWYY	
CUSTOMER SUPPORT	
NEW ZEALAND PH: 0800 232 633	
AUSTRALIA PH: 1300 465 324	

General Care and Safety Guide

The remote control supplied with this device uses a CR2032 coin type battery.



DANGER IF SWALLOWED

Keep batteries out of reach of children. Swallowing may lead to serious injury or death in as little as 2 hours due to internal burns.

If swallowed, go straight to a hospital emergency room.

Dispose of used batteries immediately.

WARNING!



DANGER IF SWALLOWED

Keep batteries out of reach of children. Swallowing may lead to serious injury or death in as little as 2 hours due to internal burns.

If swallowed, go straight to a hospital emergency room.

Dispose of used batteries immediately.

Components

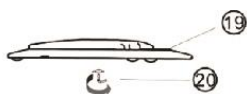
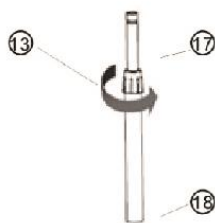
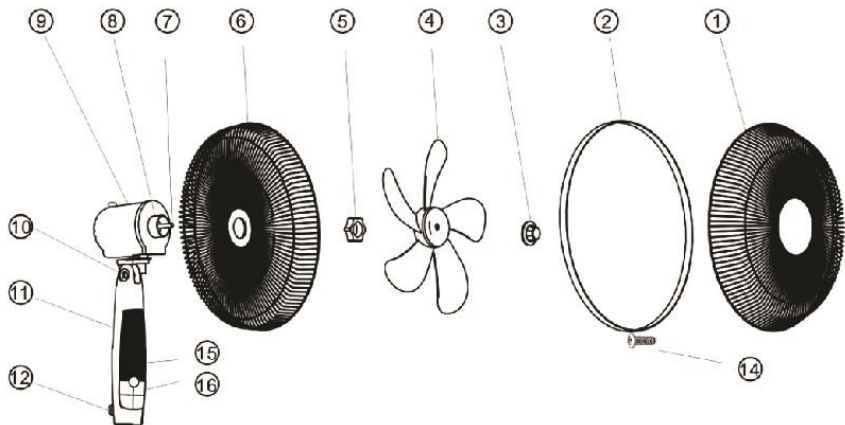

Remote Control

- | | |
|------------------------------|-----------------------------|
| 1. Front Grill | 11. Control Box |
| 2. Grill Ring | 12. Locknut For Control Box |
| 3. Fasten Nut For Fan Blades | 13. Locknut For Adjusting |
| 4. Fan Blades | 14. Grill Ring Screw |
| 5. Fasten Nut For Back Grill | 15. Control Panel |
| 6. Back Grill | 16. Touch Switch |
| 7. Motor Shaft | 17. Adjustable Pole |
| 8. Motor Shaft Pin | 18. Main Pole |
| 9. Fan Head | 19. Base |
| 10. Connection Pole | 20. Base Nut. |

Warning: Never operate the fan without all components assembled correct. The fan must only operate in the up-right position.

Assembly

Assembling this fan

Step 1: Unpack the fan from its packaging and ensure you have identified all components required.

Step 2: Place the main pole (18) in to the base (19) and secure in place using the base nut (20).

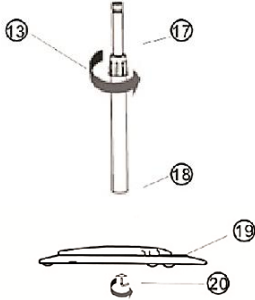

Step 3: Place the control box (11) on to the adjustable pole (17) and secure in place with the locknut for the control box (12).

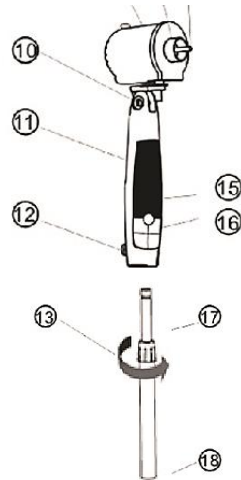

Step 4: Adjust the fan head to a suitable position to install the grill and then tighten the fasten screw (10).

Step 5: Place the back grill (6) on the fan head (9) and secure in place by tightening the fasten nut (5).

Step 6: Place the fan blades (4) on to the motor shaft (7) and secure in place by tightening the fasten nut (3).

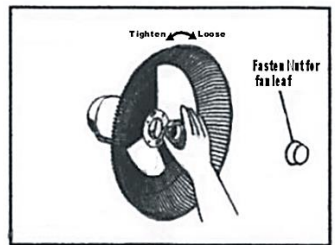

Step 6: Place the front grill (1) on to the back grill (6) and carefully secure in place by placing the grill ring (2) around the two grills. Secure in place by tightening the grill ring screw (14).

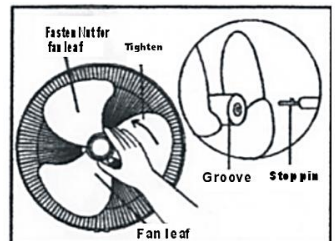

Operating your Fan

Always choose a safe location for the fan, keeping in mind the safety precautions outlined. Ensure all packaging has been removed from the unit before use. This appliance requires no installation, it should be used solely as a portable appliance.

WARNING: Keep all objects at least 1 metre from the front, sides and rear of the appliance.

IMPORTANT! NEVER COVER THIS APPLIANCE!

Place the fan on a dry, level and sturdy surface.

Ensure the fan speed control is on the OFF position before plugging the power cord into the socket.

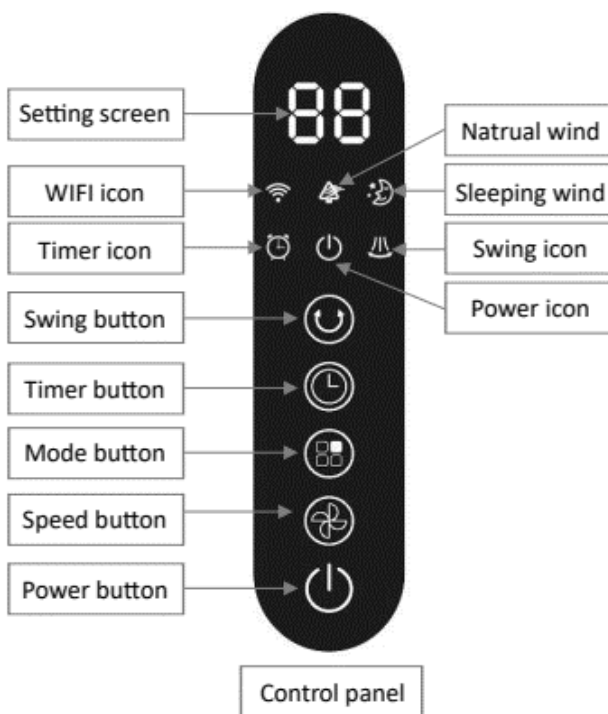

FAN CONTROL

The fan can be operated by the control panel or by the remote control.

POWER: Press to turn fan ON/OFF

SPEED: You can adjust the fan speed to the desired level low (I), medium (II), or high (III)

SWING: Turn horizontal oscillation ON/OFF

Operating your Fan

MODE: Pressing the ' **MODE**' button will set the FAN into NORMAL , NATURAL or SLEEP mode.

- **NORMAL Mode:** the fan will work at any speed you set up.
- **NATURAL Mode:** the fan will start work at high speed for 15 seconds, medium speed for 15 seconds and low speed for 15 seconds then cycle back up to high speed and back down again.
- **SLEEP Mode:** if you set the mode at high speed, fan will work at high speed at 30 mins, then transfer to middle speed at 30 mins and transfer to low speed until fan stop working.

TIMER: The fan is equipped with a timer that allows you to set its length of operation from 1 hour to 24 hours in 1 hour increments.

WIFI: Hold down the Power button for 5 seconds and the Wifi icon will begin to flash. The fan is now in pairing mode. See Wifi instructions further on in this manual for how to download our app and pair your device.

REMOTE CONTROL

The remote requires a line-of-sight path to allow for the signal to be received by the unit. Position the unit so the receiver lens is visible from the remote control.

The symbols on the remote correspond to the symbols on the main unit.

The remote control supplied with this heater uses a CR2032 coin type battery.

DANGER IF SWALLOWED

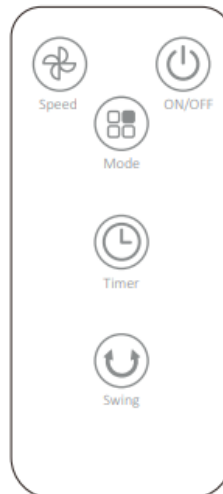
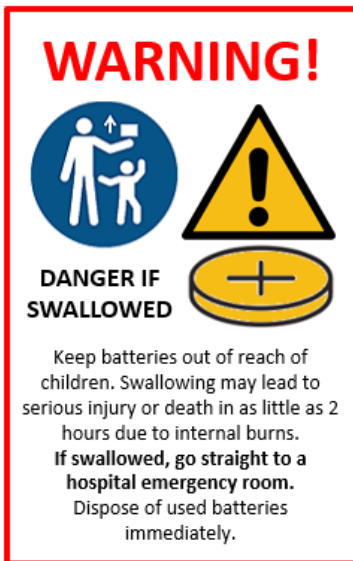

WiFi – Downloading and Setting up APP

This APP is supported only on 2.4GHz Wi-Fi channels. Please ensure your phone is 2.4GHz capable

Note this device will only work within your home WIFI system.

This does not operate on 3G or 4G internet connections.

You will need a connection to your home Wi-Fi.



Download Goldair mobile APP

- Open the APP Store or Google Play on your mobile phone.
- Open 'Search' and enter 'Goldair'
- Click 'GET' and begin to download and install.

Once downloaded to your phone open the APP

- Tap REGISTER near the bottom of the screen.
- Read and agree to the Privacy Policy.
- Add your email address.
- Tap 'Obtain verification code'

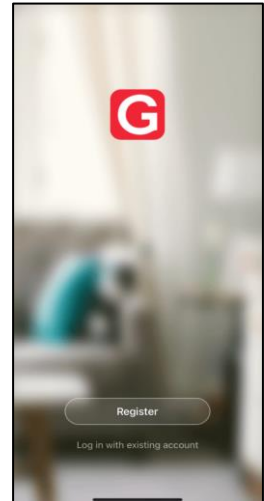

You will then receive an email with a verification code.

- Enter the verification code from your email.
- Create a password.
- Then tap confirm.

If you haven't received a verification code via email, tap the resend button and when the verification code is received follow above steps.

Your APP is now registered and ready for pairing to your device.

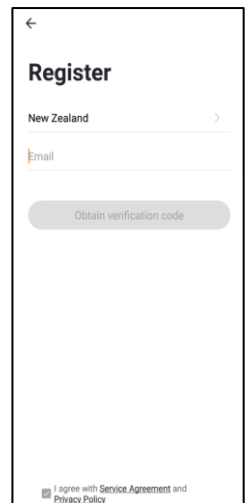
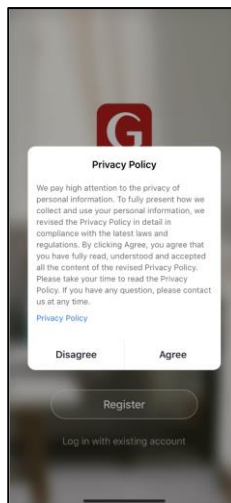

Pairing APP to Device

Details for pairing this heater to the Goldair App can be found at the below website link.

Either scan the QR code below or enter the website into your browser.

New Zealand Products



<https://www.goldair.co.nz/goldair-app>

Australia Products



<https://www.goldair.com.au/goldair-app>

Pairing Mode

To connect to the Goldair app you must ensure that your device is in pairing mode which is where the Wifi Icon is flashing.

Most products will be in pairing mode after switching the device on but if it is not:

- Put device on STAND-BY mode (ON at the wall but device is OFF)
- Hold down "POWER" for around 5 seconds or until the Wifi icon begins to flash.

Quick Connection

- Turn your phone's Bluetooth ON
- Ensure your device is in Pairing Mode (see instructions above)
- Tap the + on the top right corner to navigate to the main device screen. Tap 'Auto Scan' – your device will appear. Tap the device and follow the instructions.
- If Quick Connection does not work, follow the manual via the QR Code above

Operating your Fan

Always choose a safe location for the fan, keeping in mind the safety precautions outlined. Ensure all packaging has been removed from the unit before use. This appliance requires no installation, it should be used solely as a portable appliance.

WARNING: Keep all objects at least 1 metre from the front, sides and rear of the appliance.

IMPORTANT! NEVER COVER THIS APPLIANCE!

Place the fan on a dry, level and sturdy surface.

Check that the fan control switch is set to the off position before plugging into the mains supply.

OPERATION

Press the  button to start the fan.

Press SPEED button to set Low, Middle or High speed.

Press MODE button to set normal, natural or silent mode.

In Silent mode, the fan will operate at a predetermined speed and the  symbol will be illuminated.

In Natural mode the air flow changes from high to low in a rhythmic pattern. The  symbol will be illuminated.

Press TIMER button to start timer from 30 minutes to 7.5 hours. Each time you press button time will increase in 30 minutes until 7.5 hours.

Press SWING button to active oscillation function.

Tilt adjustment: air flow can be adjusted by moving the fans head up or down.

REMOTE CONTROL

All functions on the fan can be activated from the remote control.

The remote control requires 2 x AAA batteries (supplied). If the remote control stops working, replace the batteries.



Cleaning

The fan requires regular cleaning to ensure trouble free operation.

Ensure that the fan is switched off from the supply mains before removing the guard.

Unplug the fan from the mains supply before cleaning.

Use a damp cloth (not wet) to wipe the exterior of the fan to remove dust and dirt.

Use a vacuum cleaner to remove dust and fluff from around the grills.

Ensure the fan is dry before plugging back into the mains supply.

Do not attempt to dismantle the fan. There are no user serviceable parts. For service or repair, contact an authorised electrical service technician.

PROOF OF PURCHASE

To receive warranty retain receipt as proof of purchase. (Refer to back of booklet).

Goldair[™]

Goldair – New Zealand

Monday – Friday 8am-5pm
Phone +64 (0)9 917 4000
Phone 0800 232 633
info@cdb.co.nz

SUPPORT AND TECHNICAL ADVICE

Goldair – Australia

Monday – Friday 8am-5pm
Phone +61 (0)3 9365 5100
Phone 1300 465 324
info@cdbgoldair.com.au



One Year Warranty

Thank you for purchasing this Goldair product. Your product is warranted against faults and manufacture when used in normal domestic use for a period of **one year**. In non-domestic use Goldair limits the voluntary warranty to **three months**.

Goldair undertake to repair or replace this product at no charge if found to be defective due to a manufacturing fault during the warranty period.

This warranty excludes damage caused by misuse, neglect, shipping accident, incorrect installation, or work carried out by anyone other than a qualified electrical service technician.

PLEASE KEEP YOUR RECEIPT AS THIS WILL HELP VERIFY YOUR WARRANTY.

The benefits to you given by this warranty are in addition to other rights and remedies available to you under a law in relation to the goods or services to which this warranty relates.

In Australia, our goods come with guarantees that cannot be excluded under the Australian Consumer Law. You are entitled to a replacement or refund for a major failure and compensation for any other reasonably foreseeable loss or damage. You are also entitled to have the goods repaired or replaced if the goods fail to be of acceptable quality and the failure does not amount to a major failure.

In New Zealand this warranty is additional to the conditions and guarantees of the Consumers Guarantee Act (1993).

Goldair – New Zealand

CDB Goldair
PO Box 100-707
N.S.M.C
Auckland, 0745

Phone +64 (0)9 917 4000

Phone 0800 232 633

www.goldair.co.nz

Goldair – Australia

CDB Goldair Australia Pty
PO Box 574
South Morang
Victoria, 3752

Phone +61 (0)3 9365 5100

Phone 1300 GOLDAIR (1300 465 324)

www.goldair.com.au

Goldair One Year Warranty (IMPORTANT: Please complete and retain this warranty card)

Name _____

Address _____

Place Of Purchase _____ Date of Purchase _____

Name Of Product _____ Model Number _____

Attach a copy of the purchase receipt to this warranty card

Due to continual design improvements, the product illustrated in this User Manual may differ slightly from the actual product.

Goldair™



CDB  Goldair™

New Zealand
PO Box 100707,
North Shore Mail Centre,
Auckland, 0745
www.goldair.co.nz

Australia
PO Box 574,
South Morang,
Victoria, 3752
www.goldair.com.au