



12/19/06

**05'-UP FORD SUPER DUTY
4WD DUAL SHOCK KIT**

P/N: 10-32305,

PN: 10-32605,

&

P/N: 10-32805

INSTALLATION INSTRUCTIONS

NOTE: Each lift kit, and options to lift kits, are packaged separately. Therefore installation procedures are covered in separate instructions. Familiarize yourself with each specific set of instructions before beginning.

Part List

| <u>Item</u> | <u>Description</u> | <u>Qty.</u> | <u>Illus.</u> |
|--------------------|----------------------------|--------------------|----------------------|
| 10-32305 | | | |
| Box 1 of 1 | | | |
| 20-32305-1 | Upper Shock Hoop (Drvr) | 1 | |
| 20-32305-2 | Upper Shock Hoop (Pass) | 1 | 2, 3 |
| 20-32305-3 | Lower Shock Mount (Drvr) | 1 | |
| 20-32305-4 | Lower Shock Mount (Pass) | 1 | 1, 3 |
| 20-70811 | Hardware Pack | | |
| 13-21430-Z | Bolt, 1/2" x 2-3/4" Gr. 8 | 8 | 3 |
| 13-21456-Z | Bolt, 1/2" x 1-1/2" Gr. 8 | 4 | 2 |
| 13-30382-Z | Flat Washer, 1/2" Hrdn. | 24 | 2, 3 |
| 13-10514-Z | TopLoc Nut, 1/2" | 12 | 2, 3 |
| 13-22938-Z | Bolt, 3/8" x 1-1/4" Gr. 8 | 4 | 2 |
| 13-30408-Z | Flat Washer, 3/8" Hrdn. | 8 | 2 |
| 13-10553-Z | TopLoc Nut, 3/8" | 4 | 2 |
| 13-23679-Z | Bolt, 14mm x 60mm Gr. 10.9 | 2 | 1 |
| 13-30160-Z | Flat Washer, 14mm Hrdn. | 2 | 1 |
| 15-11213 | End Cap | 4 | 2 |

10-32605

Box 1 of 2 Same as 10-32305 box 1

Box 2 of 2

| | | | |
|-----------|---|---|---|
| AK7110R04 | Reservoir Shock, Front Dual, 10" Travel | 4 | 3 |
| 13-91075 | RCD Billet Aluminum Reservoir Clamp | 8 | 3 |

10-32805

Box 1 of 2 Same as 10-32305 box 1

Box 2 of 2

50-BE5-6245-H5 Shock, Front Dual

INTRODUCTION

Installation by a professional mechanic is recommended. Use of the appropriate tools, a Ford service manual, and a shop hoist can greatly reduce installation time.

Prior to installation, carefully inspect the vehicle's steering and drive train systems, paying close attention to the tie-rod ends, rack & pinion unit, ball joints and wheel bearing preload. Also check steering-to-frame and suspension-to-frame attachment points for stress cracks. The overall vehicle must be in excellent working condition; repair or replace worn parts.

Read instructions carefully and study illustrations before attempting installation. **RCD Suspension** is not responsible for damage, failure or injury resulting from improper installation or parts substitution of this kit.

Check parts and hardware against the parts list to assure that your kit is complete. Report any shortages to RCD Suspension at (1-619-588-4723). The parts and hardware supplied are of high-grade material and must not be replaced by inferior parts or failure may result. Do not begin installation if parts are missing.

Separate parts according to the areas they will be used. Placing the hardware with brackets before you begin will save installation time.

This kit is supplied as a bolt-on assembly. Do not weld anything to the components and do not weld the components to the vehicle.

All components in this kit come with a protective coating. Do not plate (i.e. chrome, cadmium, zinc etc.) or otherwise alter the finish in any way. This could decrease the structural strength of the components.

Secure and properly block vehicle prior to beginning installation.

Always wear safety glasses when using power tools.

Foot-Pound torque readings are listed on the Torque Specifications chart at the end of the instructions unless specifically stated in an instruction. **DO NOT USE AN IMPACT WRENCH TO TIGHTEN ANY OF THE BOLTS.**

Front Installation Instructions

1. Raise the vehicle. If working without a shop hoist, put vehicle in gear, set parking brake and block rear wheels, in front and behind tires. Loosen the front lug nuts. Lift vehicle with floor jack and place safety jack stands under frame rails, behind front wheel wells, and lower onto stands. Remove the front tire/wheel assemblies.
2. Place jack under front axle and raise till tension is just off of shocks. Remove shocks. Disconnect front sway bar links. Lower front axle till springs are free. Be careful not to let axle hang by brake lines. Remove springs.

3. Remove bolts securing brake line and ABS wire to lower spring seat. Remove the bolt securing lower spring seat to axle, and remove spring seat. Install RCD lower shock mounts (20-32305-3, 20-32305-4) using 14mm hardware provided. Re-attach ABS wire, but not brake line.

(Illustration 1) Passenger side shown. Torque the 14mm bolt to 111 lb./ft.

4. With the spring removed, place the RCD Upper Shock Hoop on frame. The rear mounting boss will line up with an existing hole in the frame, and the plate at the top will fit around the spring cup, up against the frame. With it in this position mark the two 3/8" holes, and the 1/2" hole to be drilled. Remove the hoop. **(See Illustration 2)**
5. Drill each of the locations marked with the appropriate drill.

Illustration 1

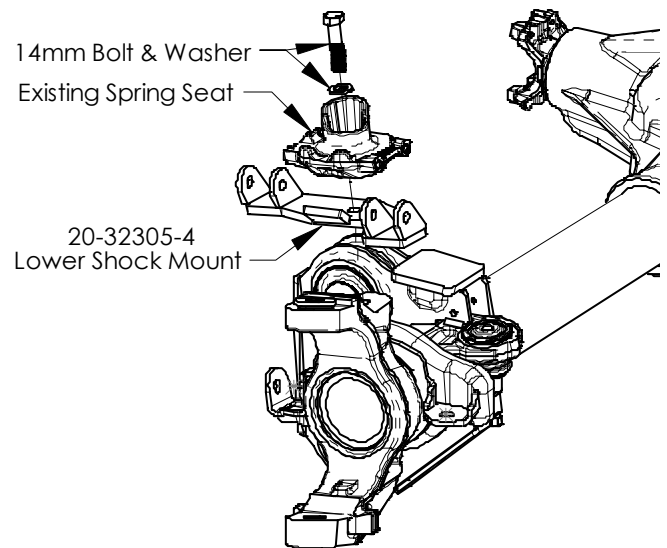
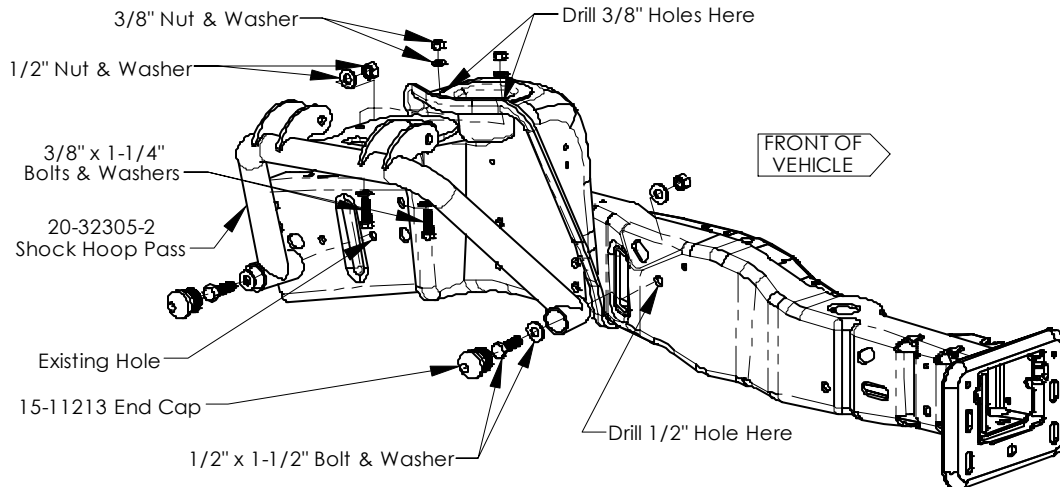

Illustration 2



6. Install the hoop using the hardware provided. Torque all 3/8" hardware to 35 lb./ft. Torque all 1/2" hardware to 90 lb./ft. **(Illustration 2)**
7. It will be necessary to remove the mounting bracket from the middle of the brake line at this time, as it will interfere with the shock.
8. **Repeat steps 4-6 on opposite side of vehicle.**

9. Install shocks with bodies facing up, using 1/2" x 2-3/4" bolts and hardware provided. Bolt heads should be facing outwards as looking into wheel well. Only install the top bolts at this time. **(Illustration 3)**

10. Install spring and raise axle until you can get the lower shock bolts in. Be sure the brake line goes around the outside of the shock.

Illustration 3

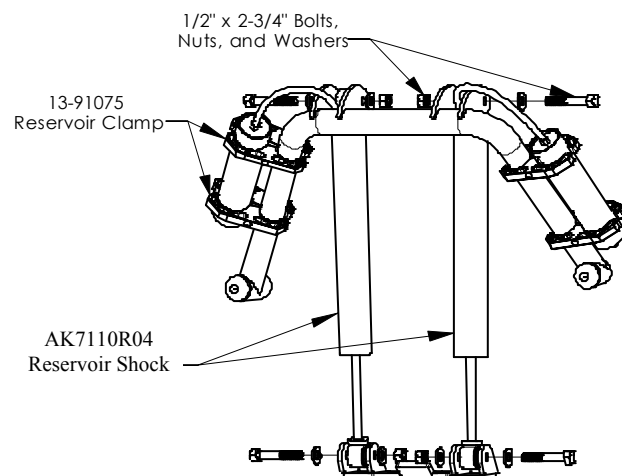

NOTE: If using reservoir shocks, install shocks with hoses facing outward and clamp reservoirs to hoop on the outside of the tube. Be sure to check mounting position of reservoirs, clamps, and hoses as to not interfere with wheel and tire assembly.

11. Reconnect the sway bar. Tie up brake lines so they won't contact shock or wheel.
12. Install Front Tire/Wheel Assemblies, raise vehicle to remove safety stands, and lower the vehicle.

Some Final Notes

After installation is complete, double check that all nuts and bolts are tight. Refer to the torque specifications chart on the last page.

If new tires are installed that are more than 10% taller than original tires, the speedometer must be recalibrated for the Anti-Lock Brake System to function properly. Contact an Authorized Ford dealer for details on recalibration.

With vehicle on the floor, cycle the steering lock to lock and inspect steering, suspension and driveline systems for proper operation, tightness and adequate clearance. Recheck brake/hose fitting for leaks. Be sure all hoses are long enough.

Realign front end to factory specifications. Be sure vehicle is at desired ride height prior to realignment.

General Torque Specifications:

| | |
|-------|--------------|
| 5/16" | 20 ft. lbs. |
| 3/8" | 35 ft. lbs. |
| 7/16" | 60 ft. lbs. |
| 1/2" | 90 ft. lbs. |
| 9/16" | 160 ft. lbs. |
| 5/8" | 175 ft. lbs. |
| 3/4" | 250 ft. lbs. |

| | |
|-----|--------------|
| M6 | 9 ft. lbs. |
| M8 | 23 ft. lbs. |
| M10 | 45 ft. lbs. |
| M12 | 75 ft. lbs. |
| M14 | 120 ft. lbs. |
| M16 | 165 ft. lbs. |
| M18 | 220 ft. lbs. |