



12/17/07

**2007 CHEVROLET/GMC  
TAHOE/YUKON  
AVALANCHE/SUBURBAN  
2WD/4WD  
6" SUSPENSION SYSTEMS  
Without Delphi AutoRide**

***P/N: 10-41007 (4WD) or 10-41107 (2WD)***

***INSTALLATION INSTRUCTIONS***

**NOTE:** Each lift kit, and options to lift kits, are packaged separately. Therefore installation procedures are covered in separate instructions. Familiarize yourself with each specific set of instructions before beginning.

## Part List

<u>Item</u>	<u>Description</u>	<u>Qty.</u>	<u>Illus.</u>
<b>Box 1 of 5 (41007 ONLY)</b>			
20-51007-1	Front Crossmember	1	9, 11
20-51007-2	Rear Crossmember	1	10, 11, 17
<b>Box 1 of 5 (41107 ONLY)</b>			
20-51207-1	Front Crossmember	1	
20-51207-2	Rear Crossmember	1	
<b>Box 2 of 5 (ALL KITS)</b>			
20-51007-5D	Front Spindle (Drvr.)	1	13
20-51007-6P	Front Spindle (Pass.)	1	
<b>Box 3 of 5 (ALL KITS)</b>			
20-51007-12	Lateral Compression Struts	2	17
20-51099-22	Bracket, Strut Mount	2	17
20-67889	Hardware Pack (Bushings)		
15-11148	Bushing, Red	8	17
20-830918	Sleeve, 3/4" x 2-3/4" Lg.	4	17
20-832738	Sleeve, 3/4" x 1.03" Lg.	2	
20-70837	Hardware Pack (Bolts)		
13-21404-Z	Hex Bolt, 1/2"-13 x 4-1/2"	2	17
13-20069-Z	Hex Bolt, 1/2"-13 x 4"	4	17
13-30034-Z	Flat Washer, 1/2" SAE	12	17
13-10038-Z	Nyloc Nut, 1/2"-13	6	17
<b>Box 4 of 5 (41007 ONLY)</b>			
20-51007-3	Bracket, Differential Drop (Drvr.)	1	8, 11, 14
20-51007-4	Bracket, Differential Drop (Pass.)	1	8, 14
20-51007-7	Skidplate, Differential	1	11
20-51007-9	Front Strut Spacer	2	12
20-70850	Hardware Pack (Axle Spacers)		
13-23705-Z	Hex Bolt, 10mm x 55mm	12	14
13-30642-Z	Flat Washer, 10mm	12	14
13-90490	Loctite Compound	1	
20-51007-20	Spacer, Drive Axle	2	14

20-70863	Hardware Pack (Diff Drops)		
13-22665-Z	Hex Bolt, 9/16"-12 x 1-3/4" Gr. 8	2	8
13-30395-Z	Flat Washer, 9/16" Hrdn.	4	8
13-10397-Z	Top Lock Nut, 9/16"-12	2	8
13-22964-Z	Hex Bolt, 12mm-1.75 x 40mm	2	8
13-30356-Z	Flat Washer, 12mm	6	8
13-10696-Z	Top Lock Nut, 12mm	2	8
13-23562-Z	Hex Bolt, 12mm-1.75 x 35mm	2	8
13-30460-Z	Lock Washer, 12mm	2	8
20-70876	Hardware Pack (F/R Crossmember)		
13-22028-Z	Hex Bolt, 5/8"-11 x 4-1/2" Gr. 8	2	9
13-21950-Z	Hex Bolt, 5/8"-11 x 5-1/2" Gr. 8	2	10
13-30369-Z	Flat Washer, 5/8" Hrdn.	8	9, 10
13-10345-Z	Top Lock Nut, 5/8" -11	4	9, 10
20-70889	Hardware Pack (Sway Bar Drop)		
20-51007-8	Spacer, Sway Bar Drop	2	15
13-22236-Z	Hex Bolt, 10mm-1.5 x 80mm	4	15
13-30642-Z	Flat Washer, 10mm	4	15
20-70902	Hardware Pack (Skid Plate)		
13-22249-Z	Hex Bolt, 1/2"-13 x 3-1/2" Gr. 8	1	11
13-22938-Z	Hex Bolt, 3/8" -16 x 1-1/4" Gr. 8	4	11
13-30382-Z	Flat Washer, 1/2" Hrdn.	2	11
13-30408-Z	Flat Washer, 3/8" Hrdn.	6	11
13-30151-Z	Lock Washer, 3/8"	2	11
13-10514-Z	Top Lock Nut, 1/2" -13	1	11
13-10553-Z	Top Lock Nut, 3/8" -16	2	11
15-11174	Bushing, Small Red	2	11
20-832257	Sleeve, 3/4" x 1.52" Lg.	1	11
20-70125	Hardware Pack (Sway Bar Extension)		
20-833882	Sway Bar Extension (6-1/2")	2	16
13-22743-Z	Button Head Bolt, 1/2"-13 x 3"	2	16
13-30694-Z	Washer, Bushing Retainer 1-1/4"	6	16
13-10878-Z	Nyloc Nut, 1/2"-20	2	16
15-11616	Bushing, Swaybar Link Inner	2	16
15-11629	Bushing, Swaybar Link Outer	2	16
15-11746	Bushing, Swaybar Flex Joint	4	16
20-70915	Hardware Pack (Front Shock Spacer)		
13-10553-Z	Top Lock Nut, 3/8" -16	6	
13-30408-Z	Flat Washer, 3/8" Hrdn.	6	
20-70941	Hardware Pack (Front Brake Lines)		
50-5107-1	Brakeline Assembly (Drvr.)	1	
50-5107-2	Brakeline Assembly (Pass.)	1	
20-68305	Hardware Pack (Universal)		
13-20447-Z	Unslot Hex, #10 x 1/2"	4	
15-10966	Clamp, 3/8" x 3/8" x .203"	4	
15-11395	Wire Tie, 6"	4	
15-11447	Wire Tie, 8"	2	
15-11460	Wire Tie, 11"	2	

**Box 4 of 5 (41107 ONLY)**

20-51007-9	Front Strut Spacer	2	12
20-70876	Hardware Pack (F/R Crossmember)		
13-22028-Z	Hex Bolt, 5/8"-11 x 4-1/2" Gr. 8	2	9
13-21950-Z	Hex Bolt, 5/8"-11 x 5-1/2" Gr. 8	2	10
13-30369-Z	Flat Washer, 5/8" Hrdn.	8	9, 10
13-10345-Z	Top Lock Nut, 5/8" -11	4	9, 10
20-69917	Hardware Pack (Sway Bar Extension)		
20-833739	Sway Bar Extension (9-1/2")	2	16
13-22743-Z	Button Head Bolt, 1/2"-13 x 3"	2	16
13-30694-Z	Washer, Bushing Retainer 1-1/4"	6	16
13-10878-Z	Nyloc Nut, 1/2"-20	2	16
15-11616	Bushing, Swaybar Link Inner	2	16
15-11629	Bushing, Swaybar Link Outer	2	16
15-11746	Bushing, Swaybar Flex Joint	4	16
20-70915	Hardware Pack (Front Shock Spacer)		
13-10553-Z	Top Lock Nut, 3/8" -16	6	
13-30408-Z	Flat Washer, 3/8" Hrdn.	6	
20-70941	Hardware Pack (Front Brake Lines)		
50-5107-1	Brakeline Assembly (Drvr.)	1	
50-5107-2	Brakeline Assembly (Pass.)	1	
20-68305	Hardware Pack (Universal)		
13-20447-Z	Unslot Hex, #10 x 1/2"	4	
15-10966	Clamp, 3/8" x 3/8" x .203"	4	
15-11395	Wire Tie, 6"	4	
15-11447	Wire Tie, 8"	2	
15-11460	Wire Tie, 11"	2	

**Box 5 of 5 ( ALL KITS)**

20-52131-1	Spring Spacer (3.5" Rear)	2	20
20-51001-2	Control Arm, Lower (Rear)	2	
20-51001-6	Bracket, Rear Trac-Bar Drop	1	22
20-51001-8	Sway Bar Link (Rear)	2	23
20-51001-9	Bumpstop Extension (Rear)	2	19
20-51001-14	Rear Shock Mount (Pass)	1	21
20-51001-15	Rear Shock Mount (Drvr)	1	21
20-68955	Hardware Pack (Rear Trac Bar)		
13-23107-Z	Hex Bolt, 9/16"-12 x 4" Gr. 8	1	22
13-21456-Z	Hex Bolt, 1/2"-13 x 1-1/2" Gr. 8	2	22
13-30395-Z	Flat Washer, 9/16" Hrdn.	2	22
13-30382-Z	Flat Washer, 1/2" Hrdn.	4	22
13-10397-Z	Top Lock Nut, 9/16"-12	1	22
13-10514-Z	Top Lock Nut, 1/2"-13	2	22
11-15144	Spacer Tube, 1" x .219 x .31"	1	22
20-51001-7	Trac Bar Drop Stiffener Plate	1	22

20-68968	Hardware Pack (Rear Spring Spacer)		
13-21703-Z	Hex Bolt, 1/2"-13 x 3" Gr. 8	2	20
13-30028-Z	Lock Washer, 1/2"	2	20
13-30382-Z	Flat Washer, 1/2" Hrdn.	2	20
20-51001-10	Cap, Spring Spacer	2	20
20-69007	Hardware Pack (Rear Sway Bar)		
13-21027-Z	Hex Bolt, 12mm-1.75 x 70mm	2	23
13-30694-Z	Flat Washer, 1-1/4" x 1/2" x 14 Ga.	2	23
13-10696-Z	Top Lock Nut, 12mm-1.75	2	23
15-11083	Bushing, 5/8" Hourglass	4	23
20-831451	Sleeve, .62" x 12mm x 1.48"	4	23
20-69020	Hardware Pack (Rear Bumpstop)		
13-22938-Z	Hex Bolt, 3/8"-16 x 1-1/4" Gr. 8	4	19
13-30408-Z	Washer, 3/8" Hrdn.	8	19
13-10553-Z	Top Lock Nut, 3/8"-16	4	19
20-69059	Hardware Pack (Brakeline Extension)		
20-51001-11	Extension, Rear Brakeline Bracket	1	
13-20425-Z	Hex Bolt, 5/16"-18 x 1-1/4"	1	
13-30187-Z	Washer, 5/16" SAE	2	
13-10155-Z	Nyloc Nut, 5/16"-18	1	
20-69072	Hardware Pack (Rear Control Arm)		
15-10979	Bushing, Red Tapered	8	
20-833128	Sleeve, .875" x .156 x 2.58"	4	
20-69280	Hardware Pack (Rear Shock Mount)		
13-23211-Z	Hex Bolt, 9/16"-12 x 3" Gr. 8	2	21
13-22847-Z	Hex Bolt, 1/2"-13 x 3-1/4" Gr. 8	2	21
13-30395-Z	Flat Washer, 9/16" Hrdn.	4	21
13-30382-Z	Flat Washer, 1/2" Hrdn.	4	21
13-10397-Z	Top Lock Nut, 9/16"-12	2	21
13-10514-Z	Top Lock Nut, 1/2"-13	2	21

## **INTRODUCTION**

Installation by a professional mechanic is recommended. Use of the appropriate tools, a GM service manual, and a shop hoist can greatly reduce installation time.

Prior to installation, carefully inspect the vehicle's steering and drive train systems, paying close attention to the tie-rod ends, rack & pinion unit, ball joints and wheel bearing preload. Also check steering-to-frame and suspension-to-frame attachment points for stress cracks. The overall vehicle must be in excellent working condition; repair or replace worn parts.

Read instructions carefully and study illustrations before attempting installation. **RCD Suspension** is not responsible for damage, failure or injury resulting from improper installation or parts substitution of this kit.

Check parts and hardware against the parts list to assure that your kit is complete. Report any shortages to RCD Suspension at (1-619-588-4723). The parts and hardware supplied are of high-grade material and must not be replaced by inferior parts or failure may result. Do not begin installation if parts are missing.

Separate parts according to the areas they will be used. Placing the hardware with brackets before you begin will save installation time.

This kit is supplied as a bolt-on assembly. Do not weld anything to the components and do not weld the components to the vehicle.

All components in this kit come with a protective coating. Do not plate (i.e. chrome, cadmium, zinc etc.) or otherwise alter the finish in any way. This could decrease the structural strength of the components.

Secure and properly block vehicle prior to beginning installation.

Always wear safety glasses when using power tools.

Foot-Pound torque readings are listed on the Torque Specifications chart at the end of the instructions unless specifically stated in an instruction. **DO NOT USE AN IMPACT WRENCH TO TIGHTEN ANY OF THE BOLTS.**

## **PLEASE NOTE**

### **WARNING: DO NOT USE WHEEL SPACERS**

Front-end realignment is necessary.

Speedometer recalibration is necessary if larger tires (10% more than stock diameter) are installed.

Brake system will need to be bled by a professional brake technician.

System is designed to work with factory "Stabilitrac" systems. Stabilitrac systems may be more sensitive than stock under certain driving conditions.

System will not work on vehicles with electronic and / or air ride suspension systems.

System is designed to accommodate up to a 35" x 12.50" tire on a wheel size of 17x 9" with a maximum of 4.5" backspacing.

Trimming of the bumper, fender, and inner fender will be required to accommodate oversize tires & wheels.

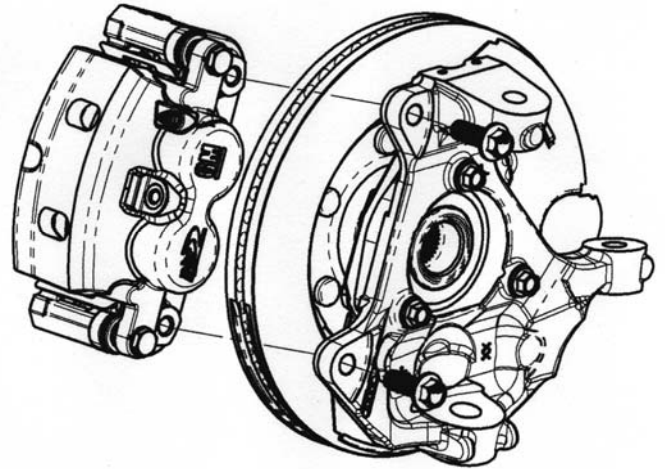
Special tools are required for safe removal and installation of the ball joints, and tie-rods. These tools can be purchased from your GM Dealer.

Ball Joint Separator Tool # J43631  
Steering Linkage Puller Tool # J24319

## **Front Installation Instructions**

1. Raise the vehicle. If working without a shop hoist, support vehicle with suitable safety jack stands. Put vehicle in gear, set emergency brake and block rear wheels, both in front and behind tires. Loosen front wheel lug nuts. Place floor jack under the lower control arm's front crossmember and raise vehicle. Place safety jack stands under frame rails, behind front wheel wells, and lower the frame onto the stands. Once securely on jack stands remove floor jack. Remove front wheels.

**Illustration 1**



2. Remove any chassis skidplates (if equipped) including front splash shield.
3. Beginning with the Driver's side, unclip the ABS sensor line, and disconnect at the frame. Remove the screw attaching the brakeline to the upper control arm.
4. Remove the bolts holding the Caliper Anchor Bracket to the Steering Knuckle (**Illustration 1**). Pull the Bracket and Caliper assembly away from the Brake Rotor and hang out of the way with a length of wire, careful not to damage the brake lines. **DO NOT let the Caliper hang from the brake line.**
5. Remove the Brake Rotor from the Hub and set aside.
6. Remove the Axle-to-Wheel Hub Nut (**Illustration 2**).
7. Remove the nut from the steering Tie Rod. Separate the Tie Rod from the Steering Knuckle.



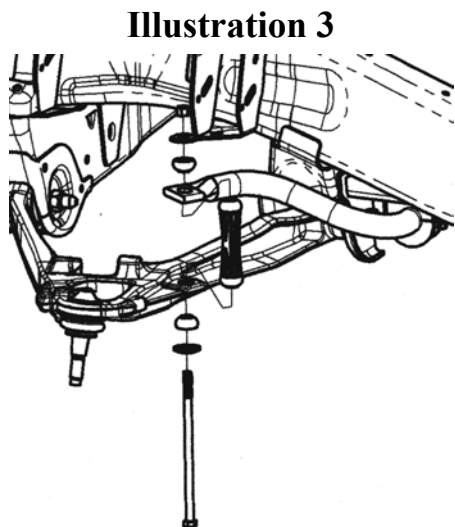
8. Remove the nut from the Upper Ball Joint. Separate the Upper Ball Joint from the Steering Knuckle.

9. Remove the nut from the Lower Ball Joint. Separate the Lower Ball Joint from the Steering Knuckle and set the Steering Knuckle aside.

10. Mark the differential flange and drive axle flange for installation reference.

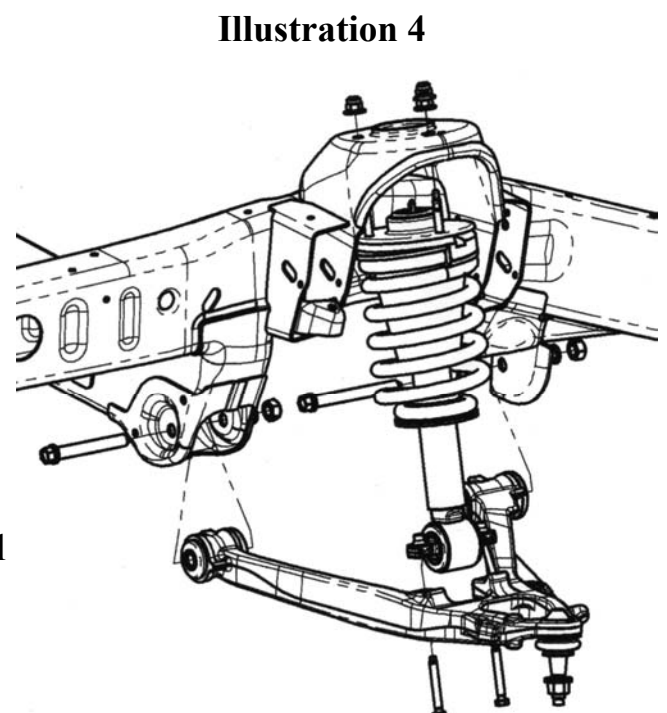
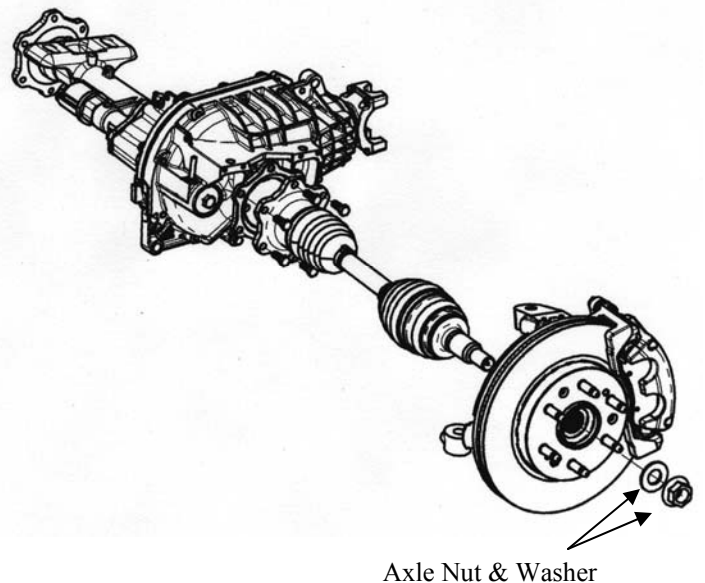
11. Remove six existing bolts fastening drive axle to differential and remove axle (**Illustration 2**).

12. Remove anti-sway bar extensions connecting bar body to lower control arms (**Illustration 3**).



13. Disconnect Front Strut from lower control arm and frame and remove (**Illustration 4**).

**Illustration 2**



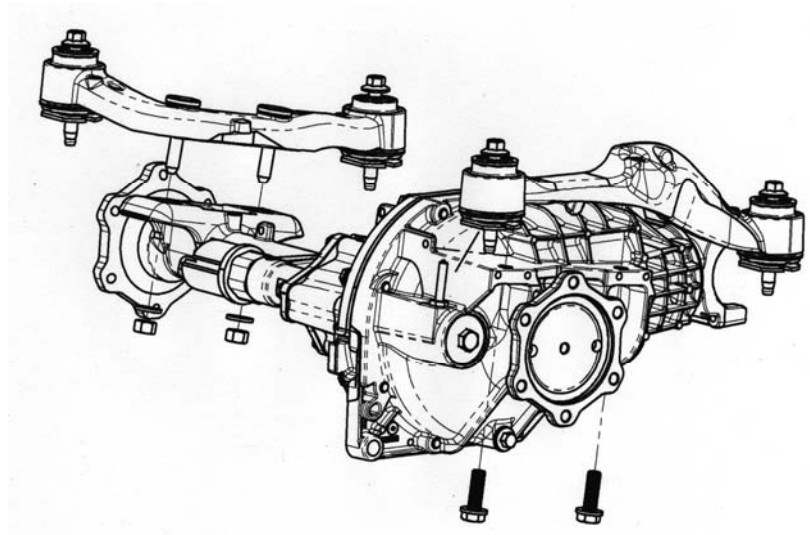
14. Remove the lower control arm pivot bolts and remove lower control arm (**Illustration 4**).

15. Repeat steps 3 thru 14 on opposite side.

16. Locate the front drive shaft U-joint to differential yoke. Place an index mark for installation reference on both the drive shaft U-joint and differential yoke. Remove the hardware from the yoke and slide the shaft rearward to disengage. Tape the bearing cap assemblies and secure the shaft out of the way.

**Illustration 5**

17. Remove the Anti-sway Bar from the frame and set aside.  
**Note: On 2wd models, this will not be necessary.**

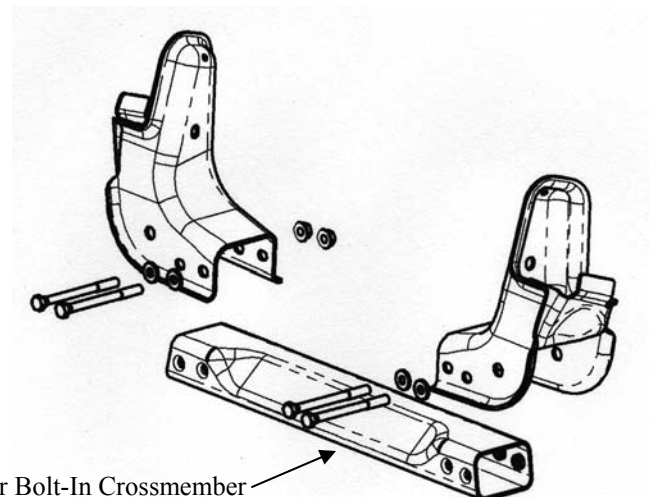


18. Disconnect the electrical connector and vent hose from differential assembly.

19. Support front differential assembly with a floorjack. Remove the two bolts on the drivers side and the two nuts on the passenger side (**Illustration 5**). Slowly remove the differential assembly from vehicle, and lower it to the floor.

**Illustration 6**

20. Remove the rear bolt-in crossmember (**Illustration 6**).

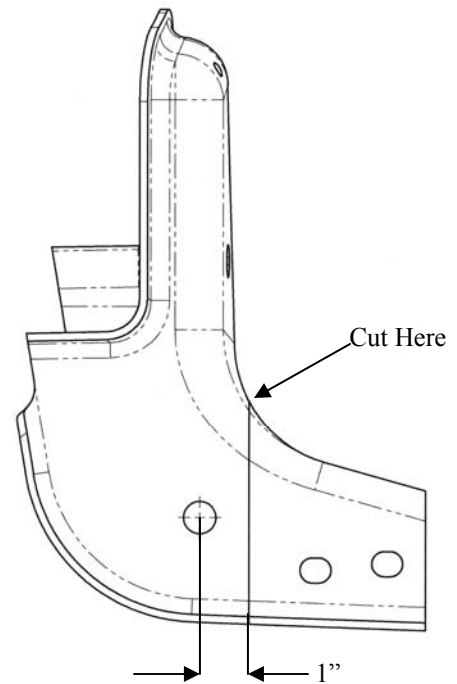


21. Using a suitable cutting tool, cut off the rear lower control arm mount bracket (driver's side), per diagram (Illustration 7). **Note: On 2wd models cutting will not be necessary.**

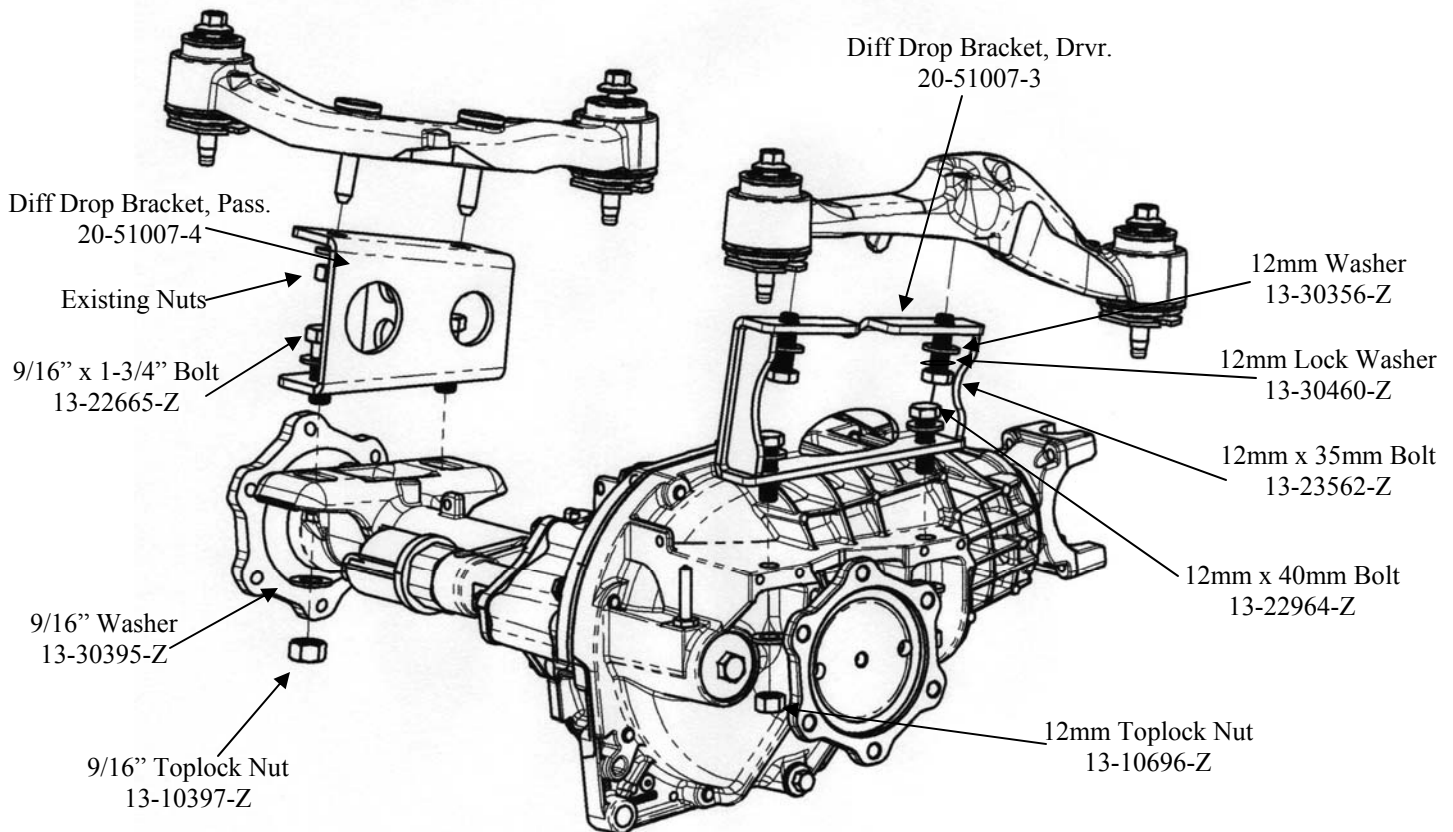
22. Loosely attach the Differential Drop Brackets (20-51007-3, 20-51007-4), to the differential axle. Use hardware provided (Illustration 8).

23. Raise Front Differential Assembly into position and attach with hardware provided on drivers side, and original hardware on the passengers side. Tighten all Differential hardware at this time.

**Illustration 7**

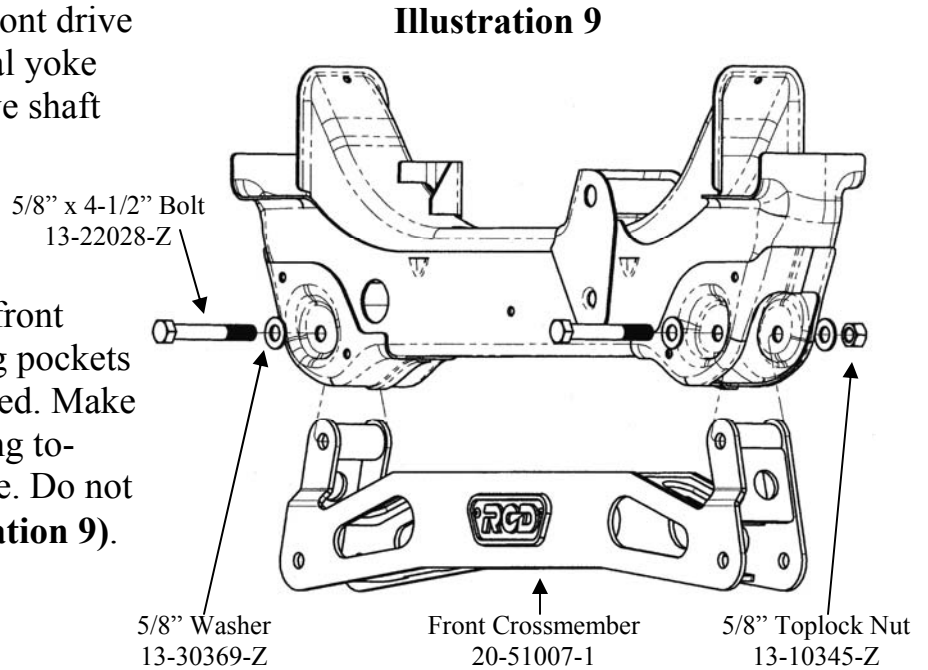


**Illustration 8**

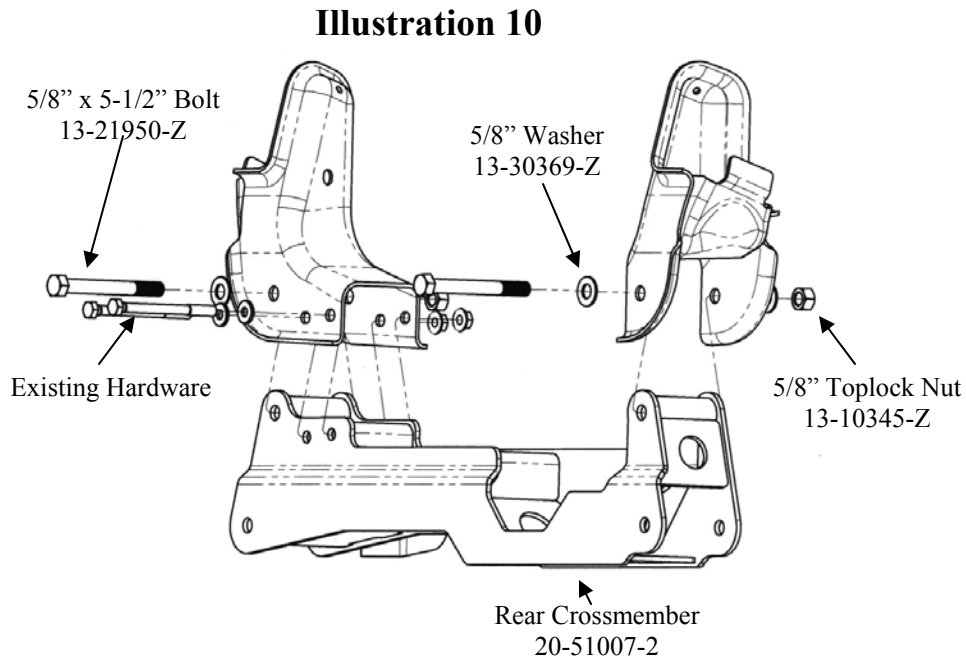


24. Align marks made on the front drive shaft U-joint and differential yoke and reconnect the front drive shaft to the differential.

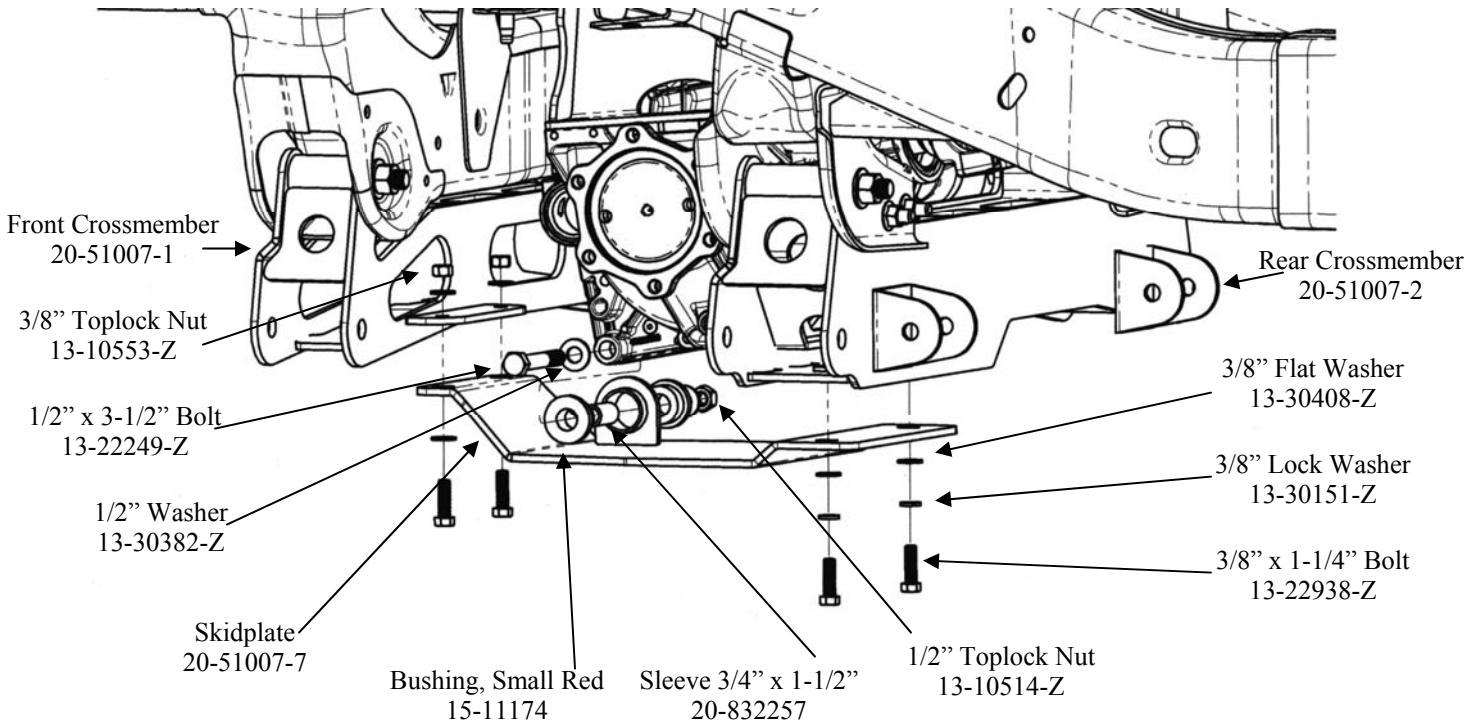
25. Install Front Crossmember (20-51007-1) into existing front lower control arm mounting pockets using 5/8" hardware provided. Make sure the bolt heads are facing toward the front of the vehicle. Do not tighten at this time (**Illustration 9**).



26. Install Rear Crossmember (20-51007-2) into existing rear lower control arm mounting pockets, use the 5/8" hardware provided. Make sure the bolts heads are facing toward the front of the vehicle. Do not tighten at this time (**Illustration 10**).



## Illustration 11



27. Insert Bushings (15-11174) and Sleeve (20-832257) into Front Differential Skid Plate, and install Skid Plate using hardware provided (**Illustration 11**).

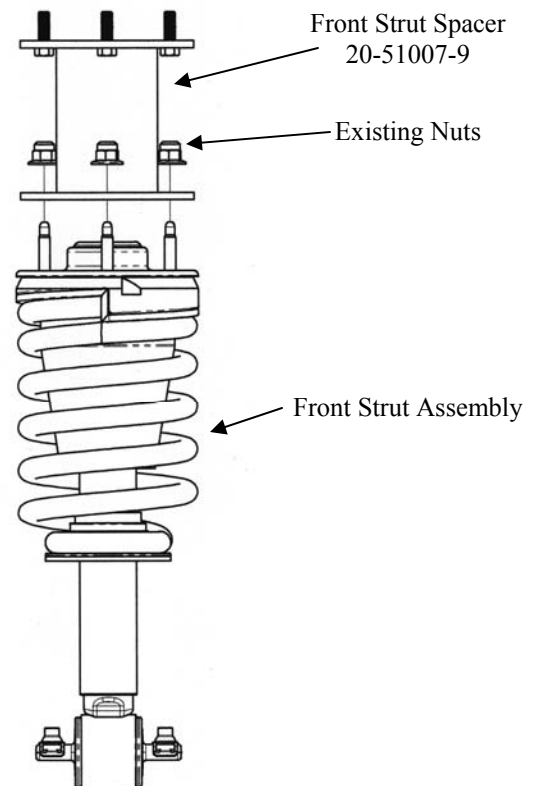
## Illustration 12

28. Connect the differential vent hose and electrical connector.

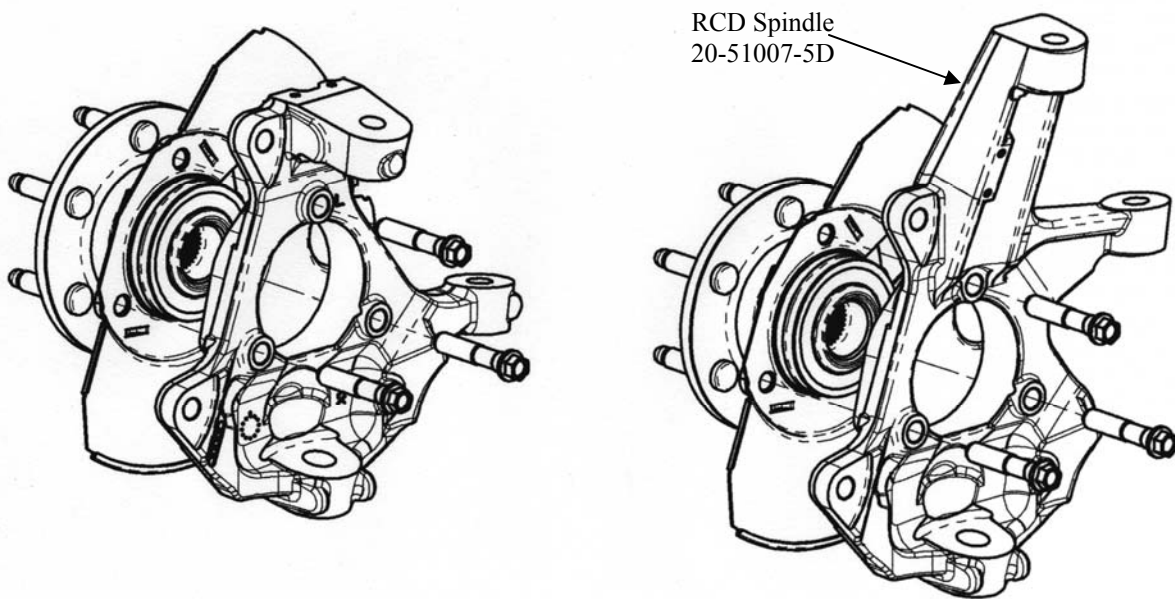
29. Install lower control arms into the front and rear crossmembers using existing hardware previously removed. Do not tighten at this time.

30. Install Front Strut Spacer to Front Strut using original hardware (**Illustration 12**).

31. Install Front Strut Assembly to frame and lower control arm using hardware provided on the top, and original hardware on the bottom.



### Illustration 13



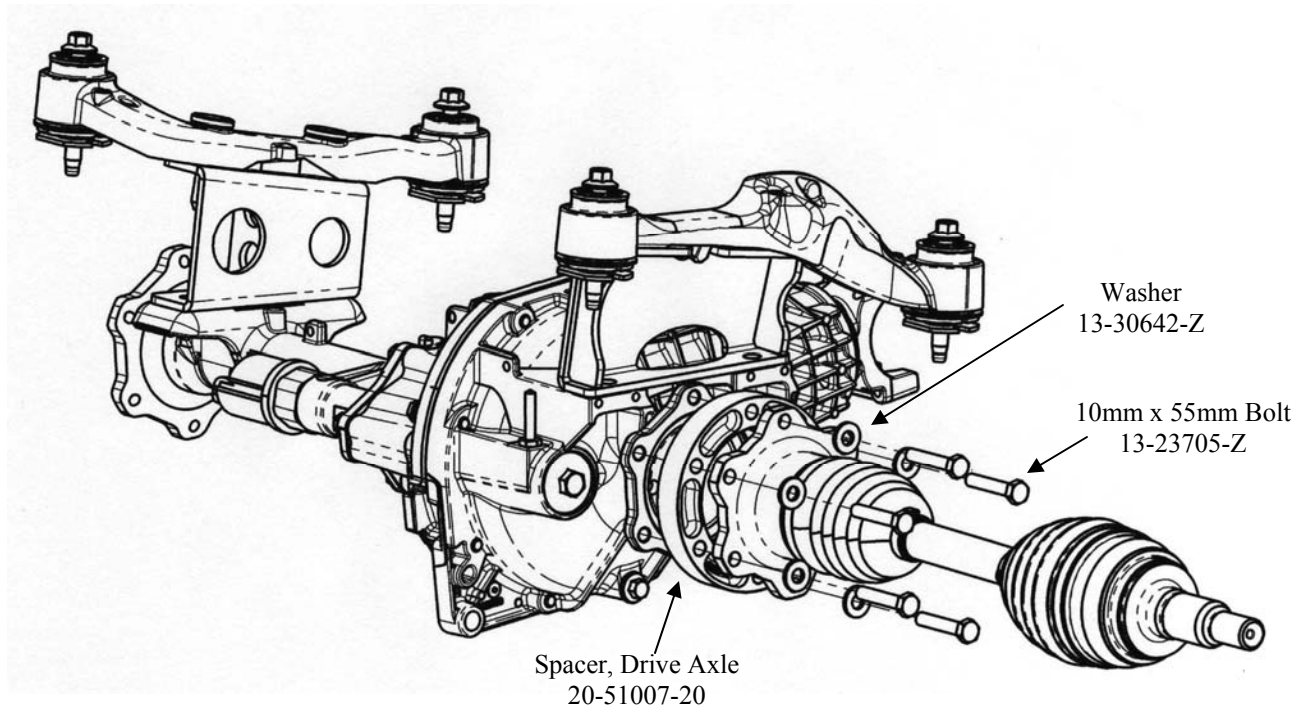
32. Remove the splash shield, hub and bearing assembly from existing front spindles. Reinstall the splash shield, hub and bearing assembly to new Front Spindles (20-51007-5D Drvr. and 20-51007-6P Pass.) (**Illustration 13**).

**NOTE: Make sure that hub and bearing assemblies are reinstalled on the same side they were removed from. Apply Loctite compound to existing hardware. Torque bolts to 133 ft. lbs.**

33. Connect driver side front spindle assembly to the upper and lower control arm ball joints. Torque upper ball nut to 37 ft lbs. Torque lower ball joint nut to 74 ft. lbs.

34. Rotate tierod so that stud is pointing down and attach the tire rod to the front spindle. Torque nut to 46 ft. lbs.

## Illustration 14



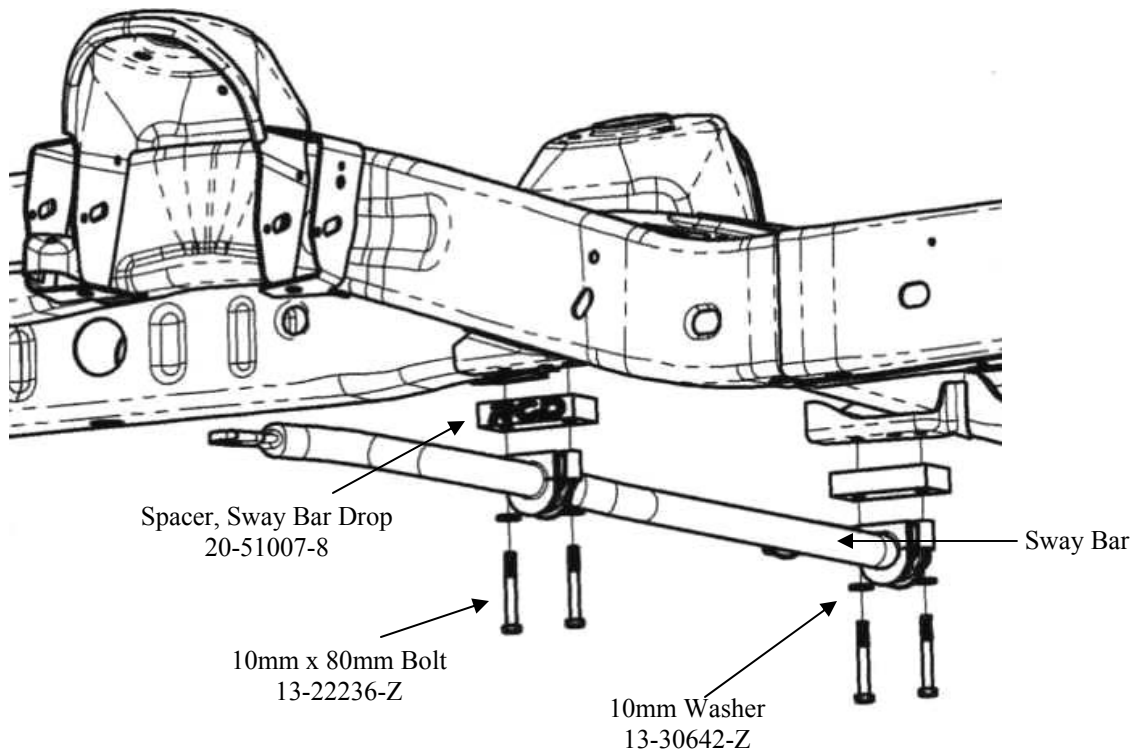
35. Re-install the drive axle into front spindle, using hardware previously removed. NOTE: Do not lubricate the drive axle splines and front spindle with grease.
36. Place Drive Axle Spacer (20-51007-20), against the differential flange (**Illustration 14**). Align the reference marks on the axle flange and differential flange, making sure all mounting holes are aligned with each other. Attach using Loctite compound and hardware provided, torque bolts to 58 ft. lbs.
37. Torque axle hub to 165 ft. lbs.
38. Install brake rotor. Reattach the front caliper with existing hardware. Torque caliper mounting bracket hex bolts (to spindle) to 129 ft. lbs.
39. Remove the brake hose, and replace it with the new Driver's Side Stainless Steel Braided Brake Line (50-5107-1). Note that the Driver and Passenger's Side Brake Lines are not interchangeable. Reinstall the Banjo Bolt at the Caliper with two new crush washers (50-5700-4) and torque to 20 ft. lbs. Secure the upper end of the new Brake Line using the original clip. Reinstall the hard

brake line to the new Stainless Steel Braided Brake Line (at the frame bracket) and torque to 14 ft. lbs. Cycle the suspension and steering to make sure the new brake lines do not interfere with any moving parts, and are secured with the supplied plastic Zip-ties. Also secure the Speed Sensor Line at this time.

40. Repeat steps 33 thru 39 on opposite side.

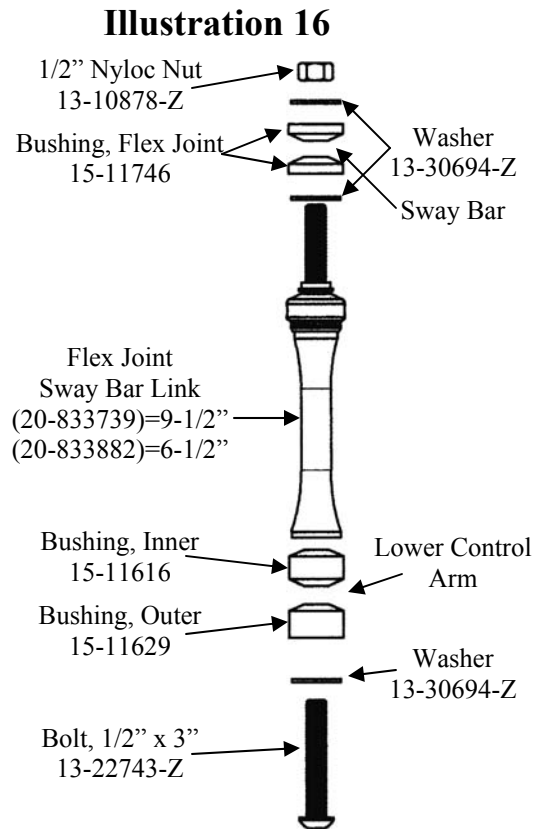
41. Install Anti-sway bar to frame using Sway Bar Drops (20-51007-8) and hardware provided (**Illustration 15**). **Note: On 2wd models, this step will not be necessary.**

**Illustration 15**





42. Install Sway Bar End Links (20-833882 on 4wd, 20-833739 on 2wd) using hardware provided (**Illustration 16**).

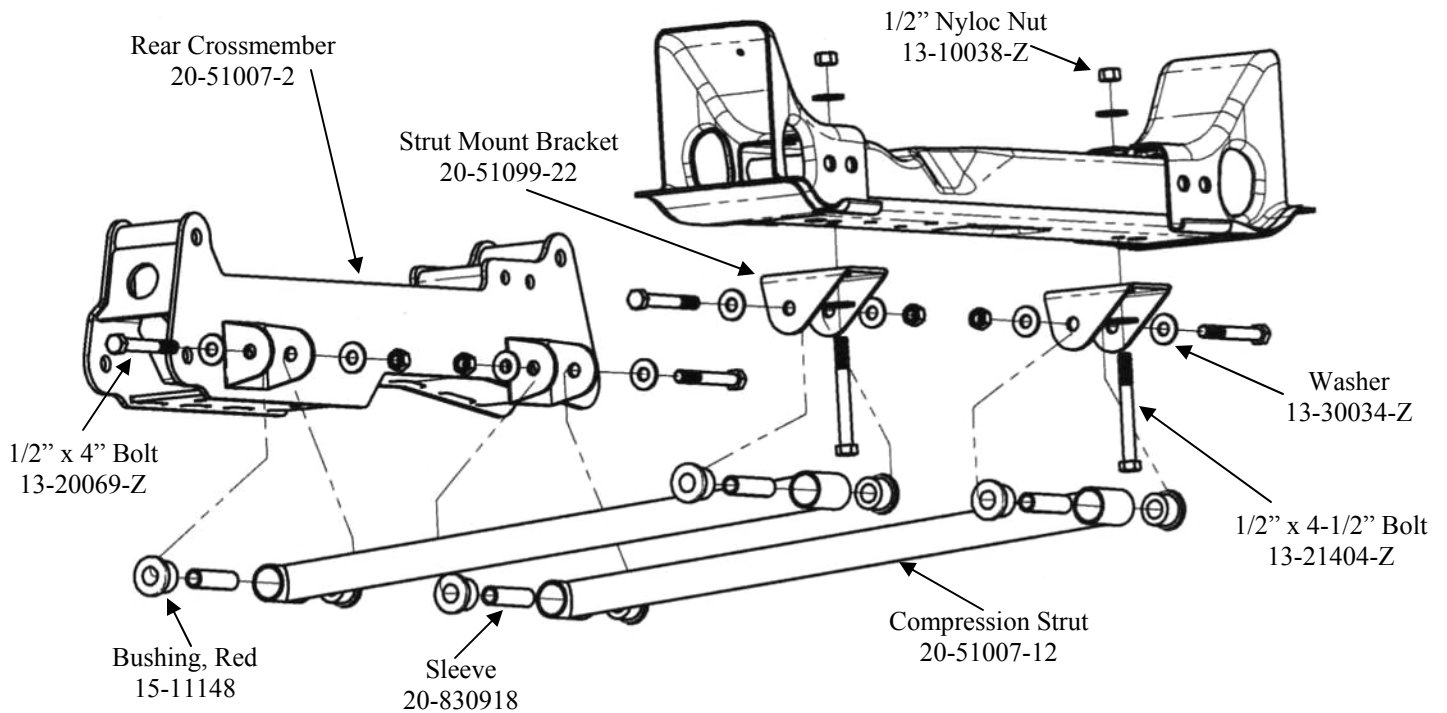


43. Install Bushings (15-11148) and Sleeves (20-830918) into both ends of the Lateral Compression Struts (20-51007-12). Attach Lateral Compression Strut to Strut Mount bracket located on rear crossmember using hardware provided (**Illustration 17**). Do not tighten at this time.

44. Remove transfer case skid plate, if equipped.

45. Attach Strut Mount Bracket (20-51099-22) to opposite end of the compression strut. Rotate the compression strut assembly upward until bracket contacts the bottom of the transmission crossmember. Use the bracket as a guide to mark and then center punch the mounting hole locations. Drill 1/2" hole at each of the marked locations. Install using the 1/2" hardware provided. Torque the nuts to 65 ft. lbs.

**Illustration 17**



46. If vehicle is equipped with a transfer case skid plate, notch the skid plate for clearance of the strut mount bracket. Reinstall the skid plate using existing hardware.

47. Bleed the brakes, checking for leaks at the newly installed fittings. Install the wheels and tires, and lower the vehicle to the ground. Torque lug nuts to 140 ft-lbs.

48. When the vehicle is at ride height, torque the lower control arm to front and rear crossmember pivot nuts to 121 ft. lbs.

49. Torque Sway Bar Extension 1/2"-13 x 3" Button Head bolts to 66 ft. lbs.

## **Rear Installation Instructions**

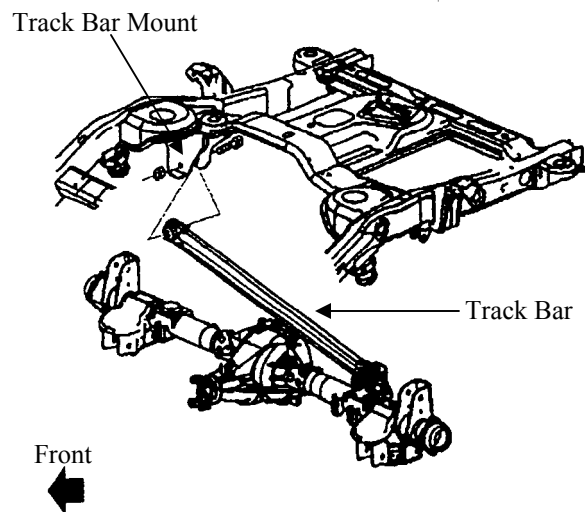
1. Raise the vehicle. If working without a shop hoist, support vehicle with suitable safety stands. To do this put vehicle in gear, block front wheels, both in front and behind tires, then disengage emergency brake. Place floor jack underneath rear axle and raise vehicle. Place safety jack stands under frame to support vehicle and lower vehicle onto safety stands. Remove rear tire/wheel assemblies.

**Illustration 18**

2. Use a floor jack to raise the rear axle just enough to relieve tension from the shock absorbers.

3. Remove nut securing both of the sway bar links to ends of sway bar. Remove nut from sway bar to frame bracket and remove links.

4. On passenger's side of vehicle remove upper track bar mount bolt (**Illustration 18**). Pull track bar from frame mount.



5. Remove emergency brake cable hanger from passenger's side of vehicle.
6. Remove differential bolt securing brake line bracket to differential.
7. Remove upper and lower mounting bolts from rear shock. Remove shocks and secure shock to frame with mechanics wire so shock does not hang by electrical connectors (if equipped).
8. Remove the lower control arm forward mounting bolt from the frame mount. Remove rear bolt to axle mount and remove control arm.

9. Repeat steps 7 & 8 on opposite side of vehicle.

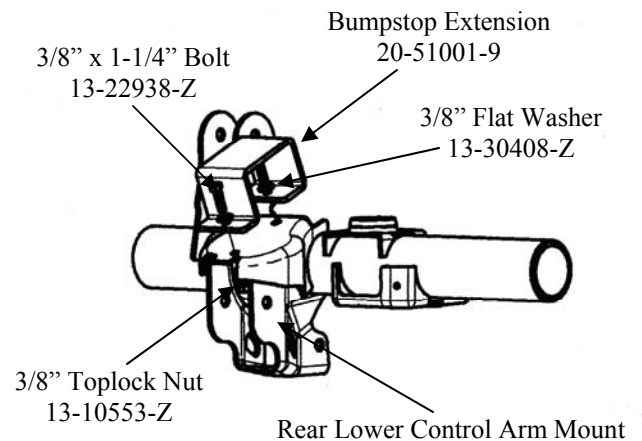
10. Carefully lower axle and remove coil spring. Keep rubber isolators for installation.

**Note: Make sure axle does not hang on brake line or hoses.**

11. Align rear hole of Bumpstop Extension (20-51001-9) to existing hole on axle bumpstop pad (**Illustration 19**). Mark front mounting hole location. Remove Extension and drill 3/8" mounting hole.

Install Extension to axle pad using 3/8"-16x 1-1/4" Hex Bolt with Flat Washers and Top Lock Nuts provided.

**Illustration 19**

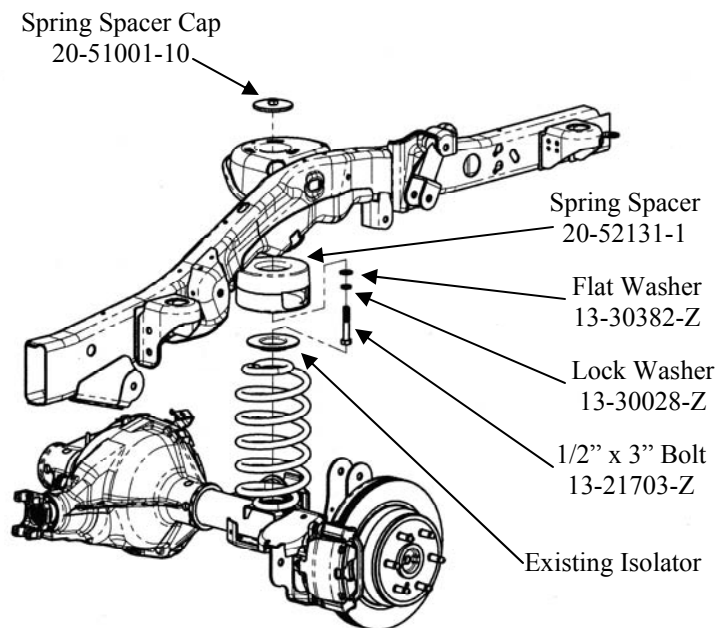


12. Install rear Coil Spring Spacer (20-52131-1) to coil spring pocket using large Spring Spacer Cap (20-51001-10) (**Illustration 20**). Lay Cap on top of existing coil spring pocket washer side down. Insert Coil Spacer (window side down) inside the upper spring pocket. Use socket and extension to insert 1/2"-13 x 3" Hex Bolt with Washers through hole in center of Spacer. Hold Spacer Cap and thread Bolt into Cap.

13. Insert Lower Control Arm (20-51001-2) into frame mount with Arm end gussets facing down. Insert rear of lower control arm into axle mount. Secure arm with existing hardware. Torque bolt to 89 ft. lbs.

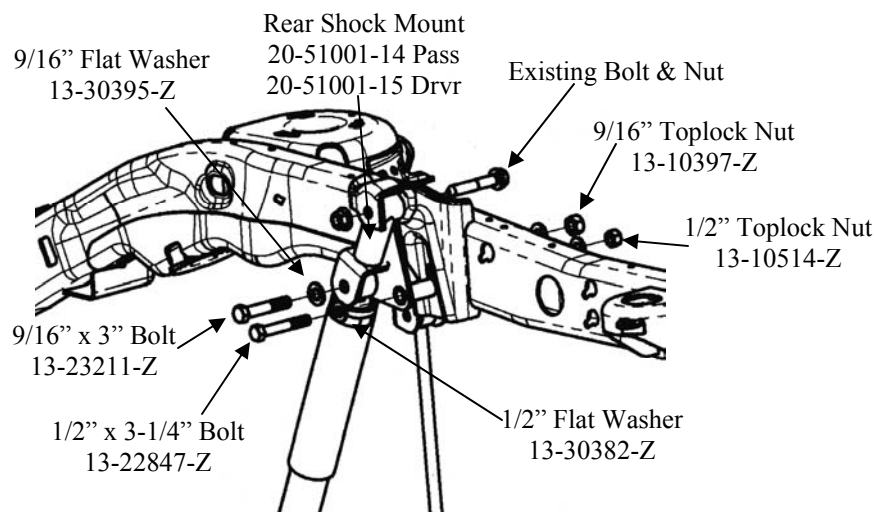
14. Repeat steps 10-13 on Passenger side.

**Illustration 20**



15. Install Passenger Side rear shock mount first. Remove stock E-Brake cable hanger located below the stock rear upper shock mount. Use existing shock bolt and attach top of Rear Shock Relocating Mount (20-51001-14) to stock shock top frame mount (**Illustration 21**). Swing the lower half of the Shock Mount forward so that the shaft points toward the rear differential. Line up the lower bracket mount with the hole from the E-Brake hanger. Using the bracket as a guide drill hole out to 1/2". Install 1/2" bolt and hardware supplied. Install factory shock into bracket using 9/16" bolt and hardware supplied.

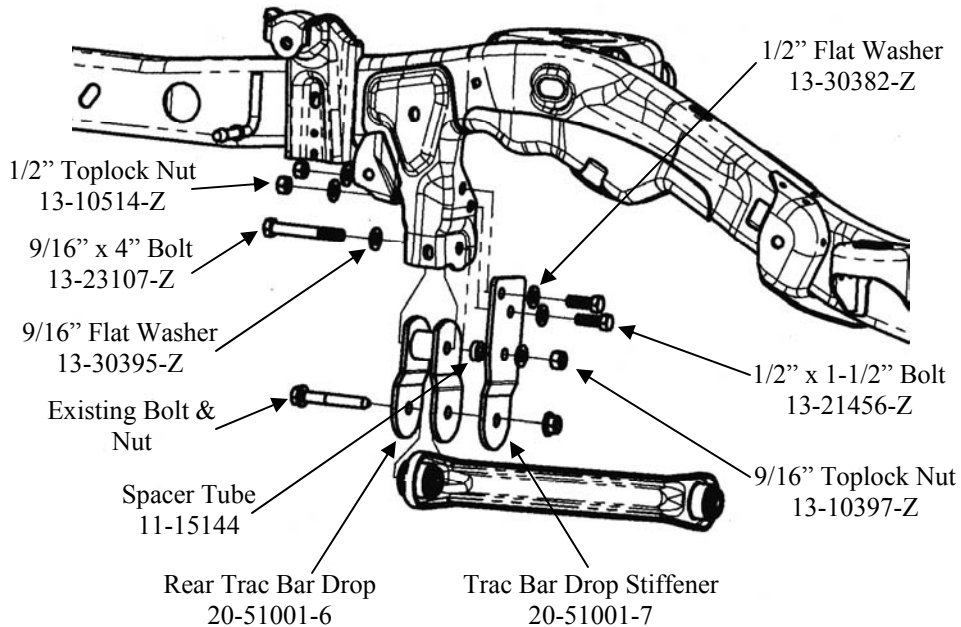
**Illustration 21**



16. Repeat Step 15 on driver side.

17. Insert rear Track Bar Drop (20-51001-6) between mounting tabs of track bar mount (**Illustration 22**). Install Drop with flat edge towards outside of vehicle. Insert 9/16"-12x 4" Hex Bolt through eye of track bar mount and Drop bracket. On forward side of track bar mount insert spacer Tube (11-15144) onto 9/16" Bolt. Insert Track Bar Drop Stiffener (20-51001-7) onto Bolt so radius end matches radius on forward part of Drop bracket. Install 9/16" Flat Washer and Top Lock nut. Do not tighten yet. Raise track bar and insert end into Track Bar Drop. Use existing hardware to attach bar. Do not tighten yet. **NOTE: Final assembly of Track Bar Drop bracket will be finished once vehicle is supporting its own weight.**

**Illustration 22**



18. Install existing coil spring with rubber isolator between top and bottom spring pockets. Raise differential until springs make contact with upper Spring Spacer.

19. **If vehicle is equipped with AutoRide**, disconnect Rear Ride Position Sensor rod from clamp around upper control arm and unscrew ball that sensor was clipped onto.

20. **If vehicle is equipped with AutoRide**, using 1/4" hardware provided, bolt new Ride Position Sensor Bracket in where ball used to be with third upper hole facing front of vehicle. Thread self tapping ball screw removed into remaining hole and reattach Air Ride Position Sensor.

21. **Repeat steps 16 thru 18 on opposite side.**

22. Install emergency brake cable hanger to passenger's side using exiting hardware.

23. Install Brake Line Extension (20-51001-11) to differential using 5/16"-18 x 1-1/4" hardware provided. Torque differential bolt to 30 ft. Ibs.

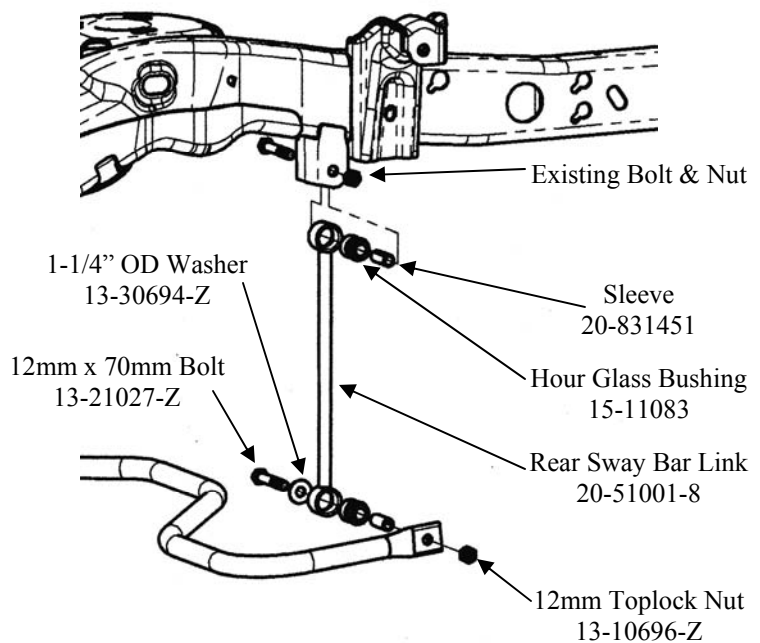
24. Press Bushing (15-11083) and Sleeve (20-831451) into ends of Sway Bar Links (20-51001-8) (**illustration 23**). Install Links on both sides of vehicle to existing mounting tabs using existing hardware on top mount and 12mm-1.75x70mm Hex Bolt, large Flat Washer (13-30694-Z) and 12mm-1.75 Top Lock nut. Install large Washer on Link Bushing side. Torque 12mm nuts to 75 ft. lbs. Torque existing link nut to 48 ft. Ibs.

**Illustration 23**

25. Install rear tire/wheel assemblies and lower vehicle.  
Torque lug nuts to 140 ft. Ibs.

26. After the rear lift is complete, final ride height adjustment should be performed. Manually bounce the front and rear of the vehicle to pre-settle the bar and springs. Evenly adjust the torsion bar bolts until the front of the vehicle is approximately 1/2" above the final desired ride height. Bars will settle slightly after vehicle is driven.

**Each bar may require slightly different adjustment to level vehicle side to side.**



**NOTE:**

27. Ensure rear wheels are aligned in fender well and attach Trac Bar Drop bracket. With the Track Bar Drop bracket hanging straight down, locate and drill the two remaining 1/2" mounting holes for Stiffener. Install 1/2"-13 x 1-1/2" Hex Bolt with Flat Washers and Nyloc Nuts provided. Torque 1/2" nuts to 90 ft. lbs. Torque 9/16" nut to 130 ft. Ibs.

## **SOME FINAL NOTES**

- After installation is complete, double check that all nuts and bolts are tight. Refer to the torque specifications chart on last page.
- If new tires are installed that are more than 10% taller than original tires, the speedometer must be recalibrated for the Rear Wheel Anti-Lock Brake System to function properly. Contact an Authorized GM dealer for details on recalibration.
- With vehicle on the floor, cycle steering lock to lock and inspect steering, suspension and driveline systems for proper operation, tightness and adequate clearance. Recheck brake/hose fitting for leaks. Be sure all hoses are long enough.
- Have headlights readjusted to proper setting.
- Realign front end to factory specifications. Be sure vehicle is at desired ride height prior to realignment.



## **Torque Specifications**

### **General Torque Specifications:**

<b>5/16"</b>	<b>20 ft. lbs.</b>	<b>M6</b>	<b>9 ft. lbs.</b>
<b>3/8"</b>	<b>35 ft. lbs.</b>	<b>M8</b>	<b>23 ft. lbs.</b>
<b>7/16"</b>	<b>60 ft. lbs.</b>	<b>M10</b>	<b>45 ft. lbs.</b>
<b>1/2"</b>	<b>90 ft. lbs.</b>	<b>M12</b>	<b>75 ft. lbs.</b>
<b>9/16"</b>	<b>160 ft. lbs.</b>	<b>M14</b>	<b>120 ft. lbs.</b>
<b>5/8"</b>	<b>175 ft. lbs.</b>	<b>M16</b>	<b>165 ft. lbs.</b>
<b>3/4"</b>	<b>250 ft. lbs.</b>	<b>M18</b>	<b>220 ft. lbs.</b>

### **Existing Hardware Torque Specifications:**

Wheel Hub-to-Wheel Knuckle Bolts	133 ft. lbs.
Front Differential Mounting Nuts, Pass. Side	75 ft. lbs.
Front Differential Mounting Bolts 12mm	87 ft. lbs.
Front Driveshaft/Front Differential Pinion Flange Bolts	19 ft. lbs.
Sway Bar to Frame Mounting Bolts	50 ft. lbs.
Lower Control Arm Mounting Bolts	129 ft. lbs.
Lower Ball Joint Nut	94 ft. lbs.
Axle Nut	148 ft. lbs.
Upper Ball Joint Nut	37 ft. lbs.
Tie Rod Nut	37 ft. lbs.
Caliper Mount to Steering Knuckle Bolts	129 ft. lbs.
Front Brakeline Banjo Bolts	26 ft. lbs.
Hard Brake Line to Brake Hose Fitting	13 ft. lbs.
Front Shock, Upper Mount Nuts	37 ft. lbs.
Front Shock, Lower Mount Bolts	37 ft. lbs.
Wheel Lug Nuts	140 ft. lbs.
Front Halfshaft to Differential Bolts	58 ft. lbs.
Rear Lower Control Arm Bolts	129 ft. lbs.
Rear Trac Bar Bolt	140 ft. lbs.
Rear Shock, Upper and Lower Mount Nuts	52 ft. lbs.