

SAMEBIKE

PRODUCT INSTRUCTION MANUAL



XD26

**PRODUCT
INSTRUCTION
MANUAL**



<http://www.gzsamebike.com>

SAMEBIKE

Electric Mountain Bicycle

User Manual

Production license No: (粤)xk16-002-01025

Model:XD26



The Catalogue of Electric Mountain Bicycle

1.Important warning	3
2. Unpacking and product specs ----	4
3. Product components	5
4.Method of product assembly	6
4.2 Assemble the fender and headlight	6
4.3 Installing the front wheel	6
4.4 Assemble the rear fender.....	7
4.5 Mounting pedal	7
4.6 Seat installation.....	7
5.Product instruction	8
5.1 Charging method	8
5.2 LCD Display (functional instruction)	8
6.Preparation before riding	11
7.Warranty policy	11

1.Important warning

This manual include important safety performance information and service information. Please make sure you have read the following warning content before the first time you use our product.

If you borrow your electric bicycle to other people, please let the user read this manual, it could help to decrease the risk of accident.

Please wear a suitable and safe helmet before riding, please wear the clothes with fluorescent and reflective stripes when you ride at night Don't exceed speed limit, it is a main reason of traffic accident, we should abide by the traffic rule, we shouldn't exceed the speed limit.

Don't touch the charging hole on the bike, or use metal touch it, otherwise, the accident will be caused by the transient short circuit of the current.

Zero starting, braking frequent, driving against the wind, carrying people or anything, insufficient air pressure on the tires. All of these will use much electric energy, and then reduce the endurance mileage. If you want the best endurance mileage, please do something as follows :

- 1) please use assist mode;
- 2) on the premise of safety, don't brake frequently or use zero starting;
- 3) Don't overload;
- 4) Before riding, please check the pressure of the tire and supply enough pressure.

Our Ebike should avoid prolonged exposure to the sun or rain, avoid storage in places with high temperature or corrosive gas, so as to avoid electroplating parts and paint surface by chemical corrosion and electrical parts damage, resulting in operational failure and accidents.

Your current insurance business may not cover the situation you may encounter when riding an electric bike, please contact your insurance company or insurance broker for relevant consultation.

If you use our ebike in your country, pls refer to the local laws and regulation. For example in China, riding an electric bicycle must reach the age of 16.

Bicycles are vehicles with certain risk fact factor, please be sure to abide by the traffic rules. At the same time, when emergency braking, brake the rear wheel first, then brake the front wheel, when cycling speed is too fast. There is a danger of tipping over if you brake the front wheel suddenly, please ride carefully.

2. Unpacking and product specs

Remove all package material, then inspect each item for any accident damage that may have occurred during shipping. You should find each of these items in your box:



ELECTRIC BIKE



TOOLS:
large wrench*2
allen wrenches*4
screwdriver*1



BATTERY CHARGER

ITEM	SPECIFICATIONS
Model	XD26
Product Dimensions	1760x670x1000 (mm)
Package Dimensions	1360x240x720 (mm)
Max Load	220.4 lbs (100kg)
Package Weight	63.9 lbs (29KG)
E Bike Weight	56.2 lbs (25.5kg)
Max Speed	25 km/h
Battery/Charger	input 100-240V 50/60Hz AC Plug; Output 54.6V2A DC2.1
Pedal-Assist Mode	Approx 56-62 miles (90-100km)
Pure Electric Mode	Approx 28-31 miles (45-50km)
Max Angle of Climb	25 degrees
Charging Time	4-8 hours
Tire Pressure	According to the actual information on the tire
Bell/Horn	Electric Horn Installed
USB Charging Port	Output Voltage 5V1A
Frame Material	6061 Aluminum Alloy
IP Level	Ip54

3. Product components



1. Handlebar

2. Display

3. LED Front light

4. Suspension Fork

5. Disc brake

6. Tire

7. Battery

8. Pedal

9. Crankset

10. Chain

11. Motor

12. Flywheel

13. Seatpost

14. Saddle

4.Method of product assembly

4.1 Adjust handlebar and stem



Rotate the stem and Suspension Fork by 180° until it faces forward



Unscrew the four screws and set aside



Install the handlebar to adjust the direction



Tighten 4 screws to fix the handlebar

4.2 Assemble the fender and headlight



Loosen the set screw counter clockwise

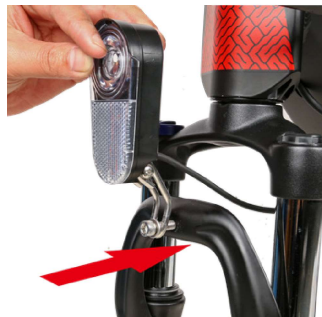

Put in and tighten the headlights



Put in and tighten front fender



Put in and tighten the nut

4.4 Assemble the rear fender



Loosen the set screw counter clockwise



Put in and tighten the rear fender



Tighten the set screw clockwise



Complete the installation

4.3 Installing the front wheel



Take out the Quick Release Lever and the front wheel



Insert the quick release Lever, tighten the spring and nut to the screw



Fasten the quick release Lever in the direction of the arrow



Installation the disc brake of front wheel



Tighten the disc brake clockwise

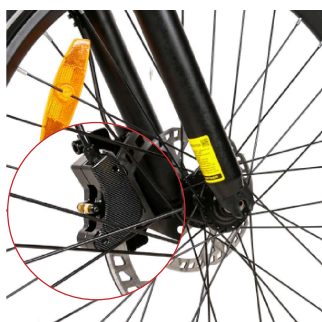

Finish installation

4.5 Mounting pedal



Prepare to pedal left and right

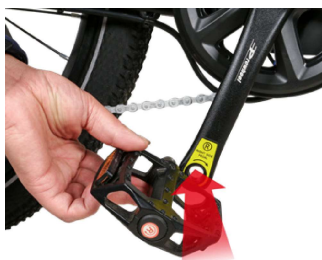

The pedal "R" is installed on one side of the chainring, according to the sticker



"L" is opposite to the chainring.



Tighten the pedal

4.6 Seat installation



Loosen the quick release lever according to the direction



Insert the seat tube in the direction



Lock the quick release lever



Complete the seat installation

5. Product instruction

5.1 Charging method

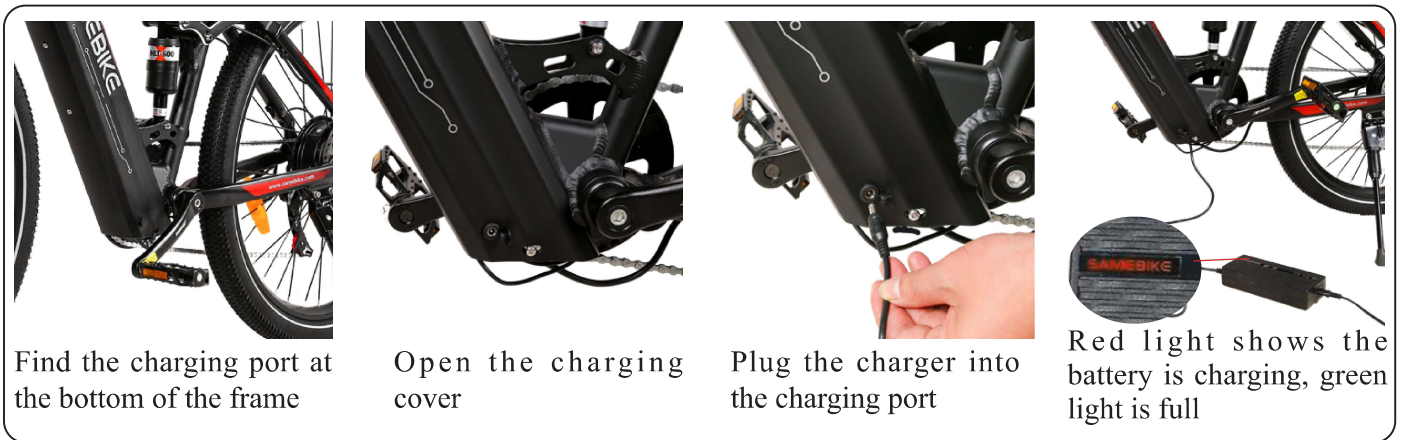

5.2 LCD Display (functional instruction)

Functions

XD26 meter offers a variety of features to meet your cycling needs, including:

- Intelligent electric power display
- Gear display
- Motor power indicator
- Speed display (including real-time speed, maximum speed, average speed)
- Mileage display (including single mileage and total mileage)
- Assist pushing control and display
- Cruise indication
- Highlight Control and Display
- Error code display
- USB connection indicator
- Bluetooth connection indicator
- Multiple parameter settings (such as: wheel diameter, speed limit, battery power setting and assist parameter setting, etc.)

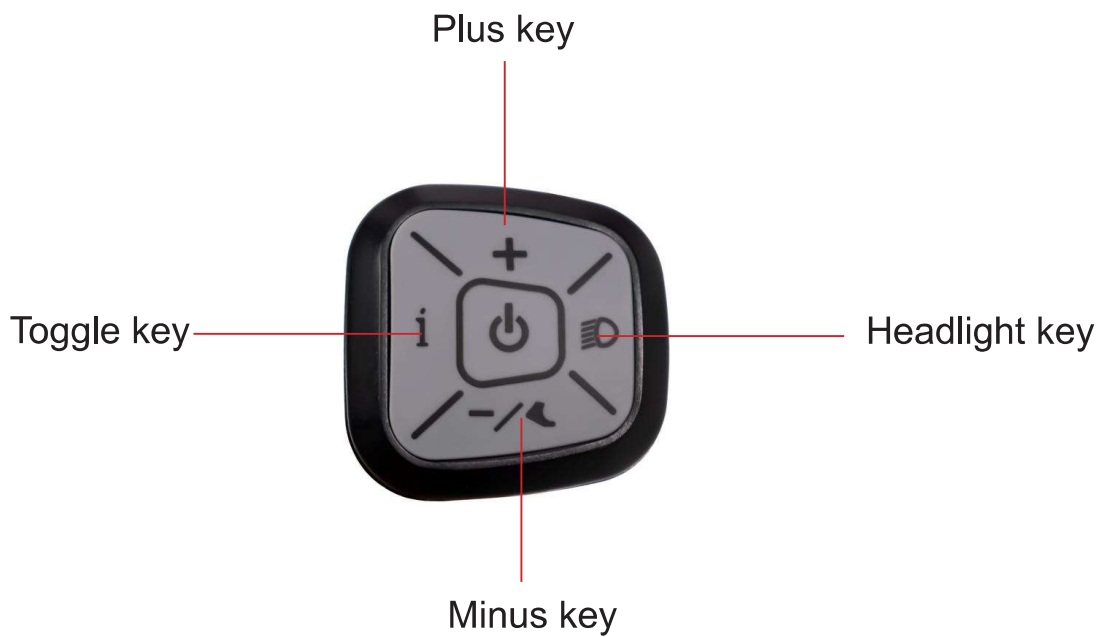

Power on/off

After long pressing the power on/off button , the meter starts to work and turn on the working power of the controller. In the power-on state, long press the power-on/off button to turn off the power. In the off state, the meter no longer uses the battery power, and the leakage current of the meter is less than 1uA. If the electric bike is not used for more than 10 minutes, the meter will automatically shut down.

Assist pushing mode

Press and hold the Minus button, and after 2 seconds, the electric bike will enter the state of electric assist pushing mode. Electric bike travel at a speed of less than 6 kilometers per hour. At the same time, the screen displays "  ". Release the Minus button, the electric bike will stop the power output immediately and return to the state before assist pushing mode.

Headlight control

Short press Headlight button, make the controller turn on the headlights, dim the instrument backlight, and the screen display  , short press Headlight button again, to make the controller turn off the headlights, and the instrument backlight to return to brightness.

Power gear selection

Short press Plus or Minus button to switch the power gear of the electric bike and change the output power of the motor. The default output power range of the meter is 0-5, 0 is stop power output, 1 is the lowest power, 5 is the highest power. When reaching the 5th gear, press the Plus button again, the meter screen will still display 5, and flash 5 to indicate that the current is the highest gear. After the power-assisted downshift reaches the 0th gear, short press the Minus button again, the meter screen still displays 0, and 0 flashes to indicate that the current is the lowest gear. Meter startup default gear is 1.

Display interface switching

After the instrument is powered on, the instrument will display real-time speed (km/h) and total mileage (km) by default. Short press the Toggle key to switch between the total mileage (km), single mileage (km), maximum speed (km/h) and average speed (km/h)

Error code display

When the electric bike electronic control system fails, the meter will display automatically. For the detailed definition of the error code, see attached Table 1.

(Cautions: When the error code is displayed, please troubleshoot the fault in time. After the fault occurs, the electric bike will not run normally.)

6.Preparation before riding

- 1.Before riding, please read the <User Manual> carefully. Please check whether the parts in good condition to ensure the safety of your riding.
- 2.Please check the status of the vehicle. Please check the brake, wheel, handlebar, folding buckle, quick release part of the electric bike to make sure the electric bike has good status.
- 3.Please check the electrical system :To know whether the battery power is enough. If it is not enough, you need to charge it as soon as possible.
- 4.Please check whether the brake system works properly. If it doesn't work properly, please stop using it, please contact the official customer service person.

7.Warranty policy

1. Users should operate in accordance with the product manual. In case of any performance fault caused by production quality, the company shall perform the obligations of the three guarantees in accordance with the provisions of relevant laws and regulations of the state.
2. The company is still responsible for the after-sales service of the faults beyond three guarantees and the major components in the Three guaran-tees, but there will be a cost for repair.
3. If the battery replacement over the warranty time , our company will besupply the battery by factory price. To ensure safety and not to pollute theenvironment the battery must be 1:1 recycling and return to the battery manufacturer.

EPAC EN 15194



**GUANGZHOU SAMEWAY ELECTRIC
BICYCLE CO., LTD**

Address: No. 32, bi cun north road, Xinhua
industrial zone, Yingbin avenue west,
Huadu district, Guangzhou Guangdong,
China 510812

MADE IN CHINA

AFTER SALES PROBLEMS
SCAN THE QR CODE



(Pre-sales, after-sales and installation videos)

GUANGZHOU SAMEWAY ELECTRIC BICYCLE CO.,LTD

-  Add : No. 32, bi cun north road, Xinhua industrial zone, Yingbin avenue west, Huadu district, Guangzhou Guangdong, China 510812
-  Official website: www.gzsamebike.com
-  Please contact for after-sales questions
E-mail: sameway@gzsamebike.com
-  <https://www.youtube.com/channel/UCDDjd4TNvZE1-Jb0bPkdONvQ>