

Snow Master

36 Months - 72 Months

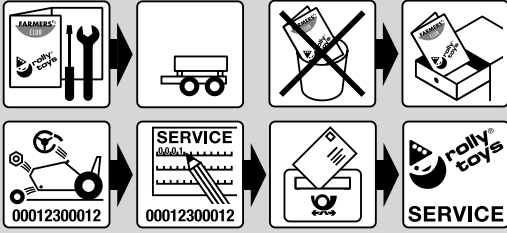

D

rolly toys Service:

Tel: +49 (0) 95-68-/-85-61-46
 Fax: +49 (0) 95-68-/-85-61-83
 e-mail: service@rollytoys.de

2007/04

961.000.800.00

A

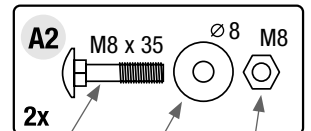
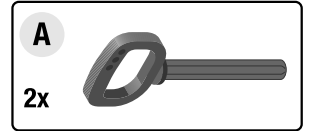
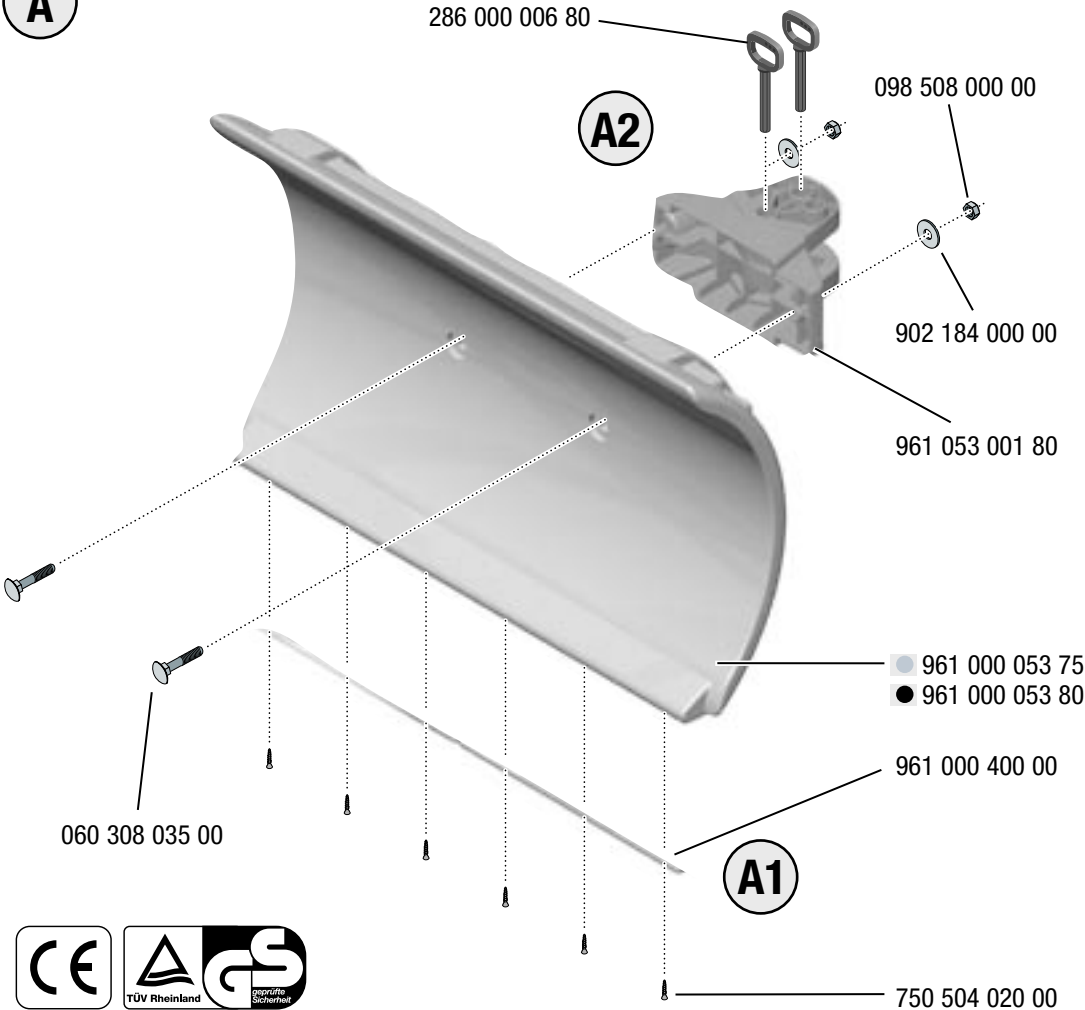

060 308 035 00
 902 184 000 00
 098 508 000 00

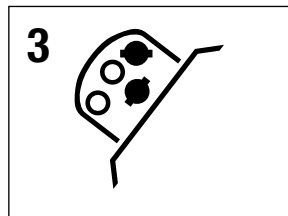
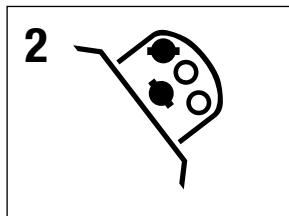
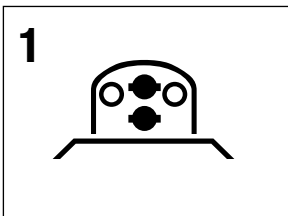

----- USA only -----

180 days warranty

From the date of purchase + guaranteed spare part service

The warranty does not cover damages caused by improper use or neglect

Vertretungen • Representatives abroad • Agences • Rappresentanti all'estero

A Handelsagentur Kundegrabner
 Tel. 0 22 30 / 79 0 79; Fax 0 22 30 / 79 0 80

AUS John Deere Ltd.
 Tel. 07 3802 / 3222; Fax 07 3803 / 6555

B/L QUAX N.V.
 Tel. 09 386 / 23 30; Fax 09 386 / 93 50

CH Sombo AG
 Tel. 0 62 / 887 74 74; Fax 0 62 / 887 74 57

CY Costakis D. Koureas & Son LTD
 Tel. 025 71 13 08; Fax 025 71 13 32

CZ OLYMPtoy s.r.o.
 Tel. 0284 822 716; Fax 0284 822 341

DK/N Grandprix Aps, Bjarne Boie
 Tel. 049 17 / 60 78; Fax 049 17 / 60 70

Service (DK/N/SE): Funnyland / Supertoy
 Tel. 075 61 / 10 70; Fax 075 61 / 10 95

F Claude Piveteau, Agence Commerciale
 Tel. 04 68 68 40 10; Fax 04 68 68 40 11

FIN Hot-Toys OY
 Tel. 0 19-688 4765; Fax 0 19-688 4880

GB Robbie Toys Ltd.
 Tel. 01 843 / 60 44 48; Fax 01 843 / 60 35 05

GR John Hellas Ltd.
 Tel. 023 10 68 86 54; Fax 023 10 68 89 10

GY Farfan and Mendes Limited
 Tel. 592 226 8130; Fax: 592 225 8651

HR domi
 Tel. 01240 84 20; Fax: 01240 96 96

I Rolly Toys Italiana S.R.L.
 Tel. 0438 4466; Fax: 0438 27372

IRL Banaghan & Co. Ltd.
 Tel. 067 / 338 88; Fax 067 / 334 33

N ATEC AS (agricultural market)
 Tel. 051 77 07 30; Fax 051 77 07 40

NL Born Agenturen
 Tel. 035 64 68 299; Fax 035 64 68 298

PL Brimarex
 Tel. 061 / 862 07 00; Fax 061 / 867 93 23

RO RT CENTER SRL
 Tel. 0040 742 141 585; Fax 0040 269 212 099

RU OOO „JOHN-RUS“
 Tel. 095 785 3993; Fax 095 369 6629

SC Cobraplast d.o.o.
 Tel. +381 15 301240; Fax: +381 15 301242

SE SpeedGame AB
 Tel. 042 23 86 85; Fax 042 23 86 95

SK Tinako
 Tel. 00421 2 4594 4626; Fax: 00421 2 4594 4628

SLO Moko d.o.o.
 Tel. 01 729 51 20; Fax: 01 729 51 27

USA Kettler USA
 Tel. 001 757 427 24 00; Fax 001 757 427 01 83

ZA Jeffrey Stein Sales (PTY) Ltd.
 ZA-8001 Cape Town

Franz Schneider GmbH & Co KG

P.O.Box 1460
 D-96459 · Neustadt bei Coburg · Germany

Tel.: +49 (0) 95 68 / 8 56-0

Fax.: +49 (0) 95 68 / 8 56-190

www.rollytoys.com · e-mail: service@rollytoys.de

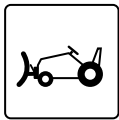

B Adapter 1

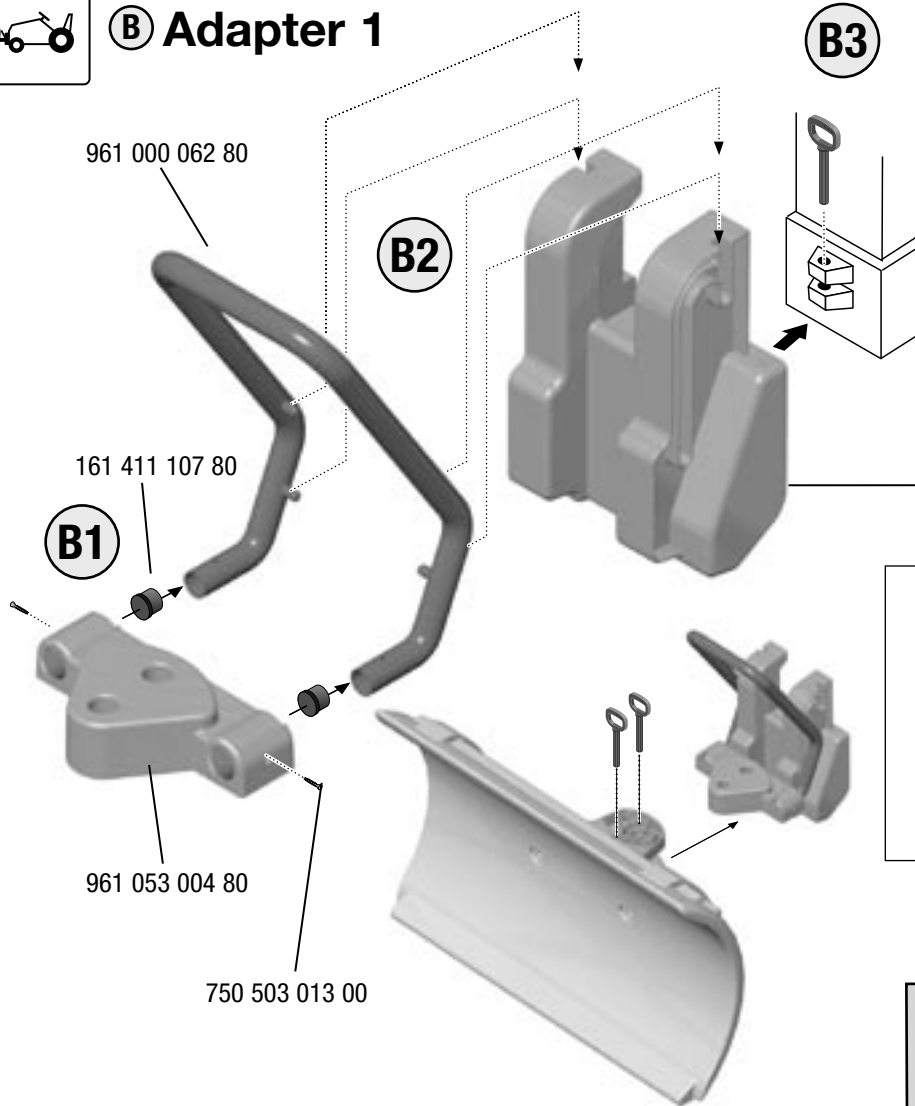

B1 2x 3 x 13
2x 3 x 13

B3 1x

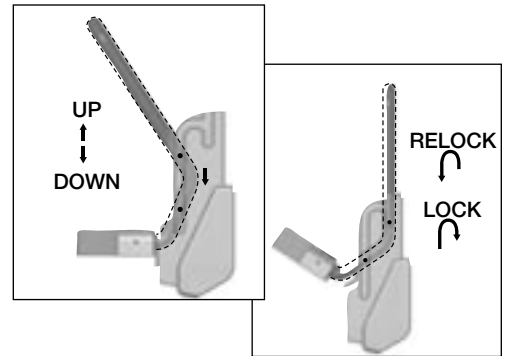

C Adapter 2

Maxi Lader + Adapter 2

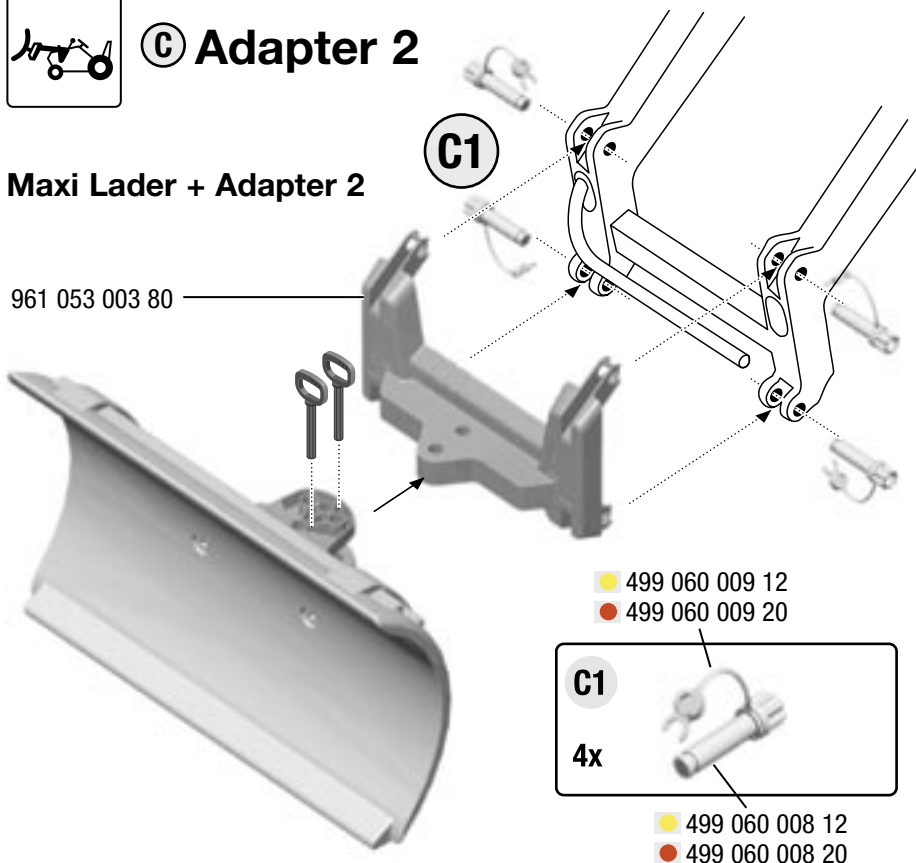

- 499 060 009 12
- 499 060 009 20

C1 4x

- 499 060 008 12
- 499 060 008 20

! WARNING

- **CHOKING HAZARD:** Small parts. Danger of being swallowed. Contains small parts in non assembled state. Must be assembled by adults.
- Adult supervision required.
- Never use near steps, slopes, driveways, hills, roadways, alleys or swimming pool areas.
- Always wear shoes.
- Never allow more than one rider.
- The use of protective gear and a safety helmet is highly recommended.



Achtung, verschluckbare Teile!
Contains small parts, danger of being swallowed!
Contient des petites pieces detachables
pouvent être avalées!

